

SENSITIVE AREA PRE-SCREENING SITE ASSESSMENT

Clean Water Services File Number

1. **Jurisdiction:** _____

2. **Property Information** (example: 1S234AB01400)

Tax lot ID(s): _____

OR Site Address: _____

City, State, Zip: _____
 Nearest cross street: _____

3. **Owner Information**

Name: _____
 Company: _____
 Address: _____
 City, State, Zip: _____
 Phone/fax: _____
 Email: _____

4. **Development Activity** (check **all** that apply)

- Addition to single family residence (rooms, deck, garage)
- Lot line adjustment Minor land partition
- Residential condominium Commercial condominium
- Residential subdivision Commercial subdivision
- Single lot commercial Multi lot commercial
- Other _____

4. **Applicant Information**

Name: _____
 Company: _____
 Address: _____
 City, State, Zip: _____
 Phone/fax: _____
 Email: _____

6. **Will the project involve any off-site work?** Yes No Unknown

Location and description of off-site work: _____

7. **Additional comments or information that may be needed to understand your project:** _____

This application does NOT replace Grading and Erosion Control Permits, Connection Permits, Building Permits, Site Development Permits, DEQ 1200-C Permit or other permits as issued by the Department of Environmental Quality, Department of State Lands and/or Department of the Army COE. All required permits and approvals must be obtained and completed under applicable local, state, and federal law.

By signing this form, the Owner or Owner's authorized agent or representative, acknowledges and agrees that employees of Clean Water Services have authority to enter the project site at all reasonable times for the purpose of inspecting project site conditions and gathering information related to the project site. I certify that I am familiar with the information contained in this document, and to the best of my knowledge and belief, this information is true, complete, and accurate.

Print/type name _____

Print/type title _____

Signature [ONLINE SUBMITTAL](#) _____

Date _____

FOR DISTRICT USE ONLY

- Sensitive areas potentially exist on site or within 200' of the site. **THE APPLICANT MUST PERFORM A SITE ASSESSMENT PRIOR TO ISSUANCE OF A SERVICE PROVIDER LETTER.** If Sensitive Areas exist on the site or within 200 feet on adjacent properties, a Natural Resources Assessment Report may also be required.
- Based on review of the submitted materials and best available information sensitive areas do not appear to exist on site or within 200' of the site. This Sensitive Area Pre-Screening Site Assessment does NOT eliminate the need to evaluate and protect water quality sensitive areas if they are subsequently discovered. This document will serve as your Service Provider Letter as required by Resolution and Order 19-5, Section 3.02.1, as amended by Resolution and Order 19-22. All required permits and approvals must be obtained and completed under applicable local, State and federal law.
- Based on review of the submitted materials and best available information the above referenced project will not significantly impact the existing or potentially sensitive area(s) found near the site. This Sensitive Area Pre-Screening Site Assessment does NOT eliminate the need to evaluate and protect additional water quality sensitive areas if they are subsequently discovered. This document will serve as your Service Provider Letter as required by Resolution and Order 19-5, Section 3.02.1, as amended by Resolution and Order 19-22. All required permits and approvals must be obtained and completed under applicable local, state and federal law.
- THIS SERVICE PROVIDER LETTER IS NOT VALID UNLESS _____ CWS APPROVED SITE PLAN(S) ARE ATTACHED.**
- The proposed activity does not meet the definition of development or the lot was platted after 9/9/95 ORS 92.040(2). **NO SITE ASSESSMENT OR SERVICE PROVIDER LETTER IS REQUIRED.**

Reviewed by Nicholas Crossett _____

Date _____

Once complete, email to: SPLReview@cleanwaterservices.org • Fax: (503) 681-4439

OR mail to: SPL Review, Clean Water Services, 2550 SW Hillsboro Highway, Hillsboro, Oregon 97123

**FIRE CODE / LAND USE / BUILDING REVIEW
APPLICATION**



North Operating Center
11945 SW 70th Avenue
Tigard, OR 97223
Phone: 503-649-8577

South Operating Center
8445 SW Elligsen Rd
Wilsonville, OR 97070
Phone: 503-649-8577

REV 6-30-20

Project Information

Applicant Name: NW Precision Design
Address: 17407 SW Inkster Dr
Phone: 503-680-6444
Email: Darin@NW-Precision.com
Site Address: 20861 SW Olds Place
City: Sherwood
Map & Tax Lot #: 2S129A03400
Business Name: Nelmun Management, LLC
Land Use/Building Jurisdiction: Sherwood
Land Use/ Building Permit # _____

Choose from: Beaverton, Tigard, Newberg, Tualatin, North Plains, West Linn, Wilsonville, Sherwood, Rivergrove, Durham, King City, Washington County, Clackamas County, Multnomah County, Yamhill County

Project Description

The applicant proposes to construct a new metal building with a footprint of approximately 13,000 SF including Industrial Use and Warehouse Space.

Permit/Review Type (check one):

- Land Use / Building Review - Service Provider Permit
- Emergency Radio Responder Coverage Install/Test
- LPG Tank (Greater than 2,000 gallons)
- Flammable or Combustible Liquid Tank Installation (Greater than 1,000 gallons)
 - * Exception: Underground Storage Tanks (UST) are deferred to DEQ for regulation.
- Explosives Blasting (Blasting plan is required)
- Exterior Toxic, Pyrophoric or Corrosive Gas Installation (in excess of 810 cu.ft.)
- Tents or Temporary Membrane Structures (in excess of 10,000 square feet)
- Temporary Haunted House or similar
- OLCC Cannabis Extraction License Review
- Ceremonial Fire or Bonfire (For gathering, ceremony or other assembly)

For Fire Marshal's Office Use Only

TVFR Permit # 2023-0026
Permit Type: SPP-Sherwood
Submittal Date: 3-6-23
Assigned To: DEM Arn
Due Date: NA
Fees Due: Ø
Fees Paid: Ø

Approval/Inspection Conditions
(For Fire Marshal's Office Use Only)

This section is for application approval only

[Signature] _____ Date _____
Fire Marshal or Designee
Conditions: See attached FS plans.

See Attached Conditions: Yes No
Site Inspection Required: Yes No

This section used when site inspection is required

Inspection Comments:

Final TVFR Approval Signature & Emp ID _____ Date _____

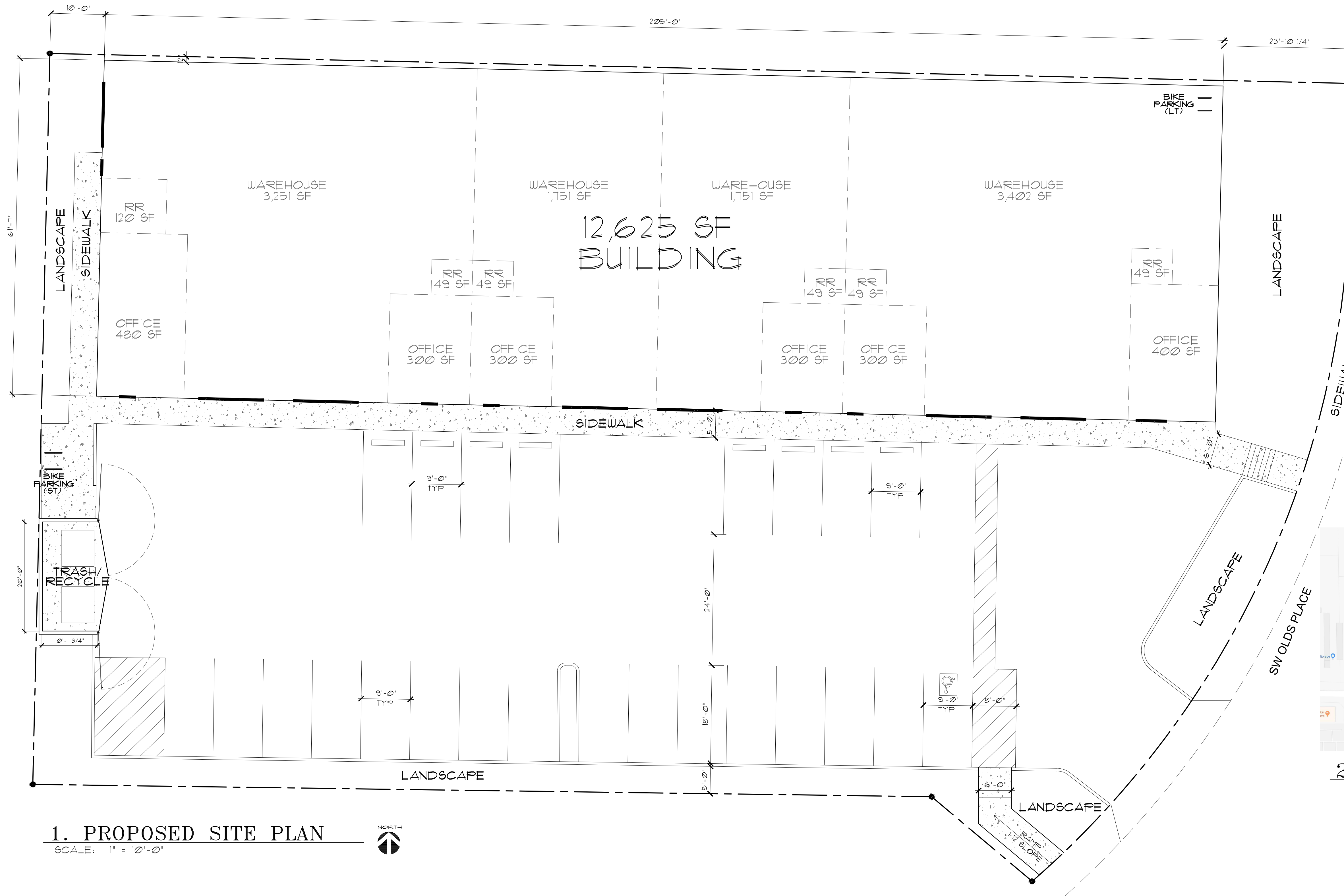

1. PROPOSED SITE PLAN

SCALE: 1" = 10'-0"

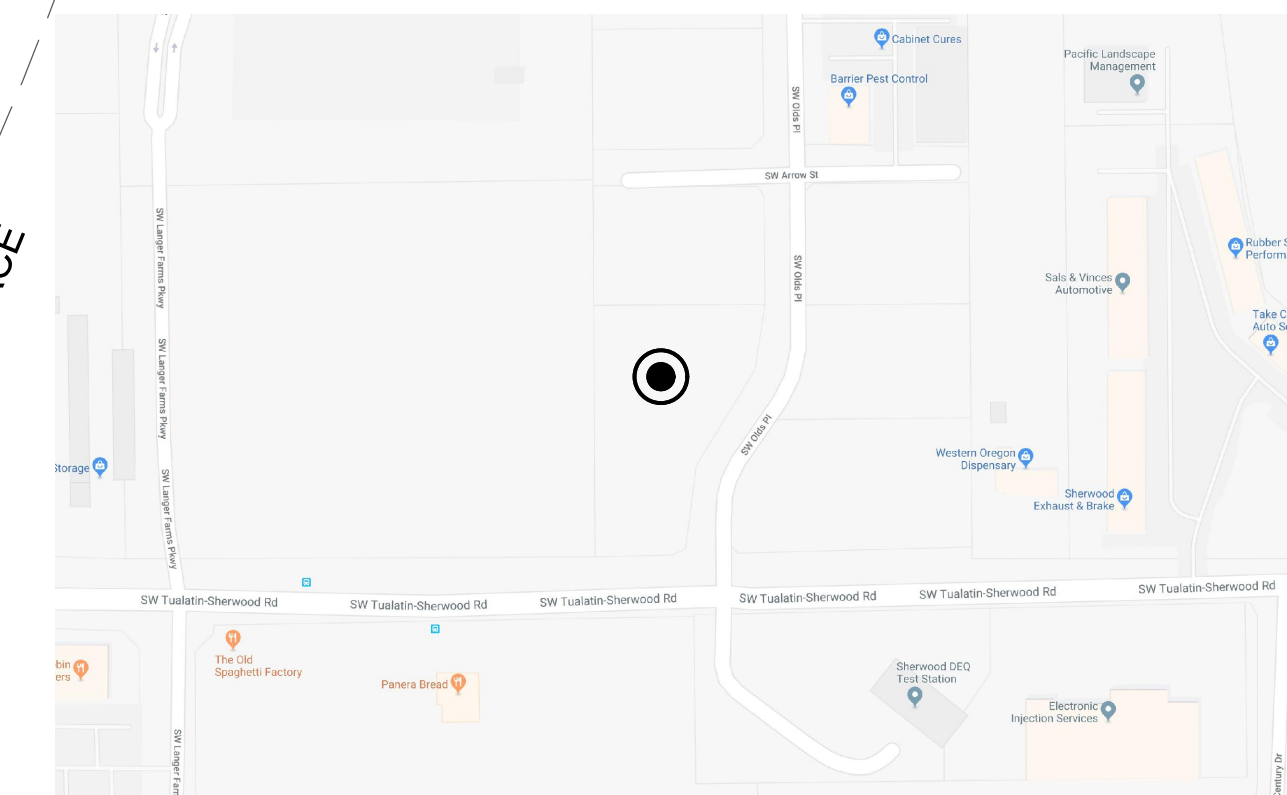

2. VICINITY



SUMMARY

ZONE: LIGHT INDUSTRIAL - (LI)
 PROPOSED LOT SIZE: .12 ACRES (31,145 SF.)
 BUILDING: 12,625 SF.
 TAX LOT: 25129A00-3400

PROPOSED DEVELOPMENT

NEW 12,625 SF, SINGLE STORY BUILDING

PROPOSED USE: INDUSTRIAL

PARKING - OFF STREET

WAREHOUSE = 10,155 SF. (16/1000 = 17)
 OFFICE = 2,080 SF. (2.7/1000 = 6)
 BATHROOMS = 365 SF.
 REQUIRED OFF-STREET PARKING = 23 (24 PROVIDED)

LANDSCAPE

LANDSCAPE = 5,020 SF. 16.1%

Revisions:

4/7/23

Project Number:

File Number:
 NUPM001A

Date: 11/2/2018

DRAWING SET NO.

A0.1