

WASHINGTON COUNTY OREGON
 SE 1/4 SECTION 29 T2S R1W W.M.
 SCALE 1" = 200'

36	31	32	33	34	35	36	31
1	6	5	4	3	2	1	6
12	7	8	9	10	11	12	7
13	18	17	16	15	14	13	18
24	19	20	21	22	23	24	19
25	30	29	28	27	26	25	30
36	31	32	33	34	35	36	31
1	6	5	4	3	2	1	6

FOR ADDITIONAL MAPS VISIT OUR WEBSITE AT
www.co.washington.or.us

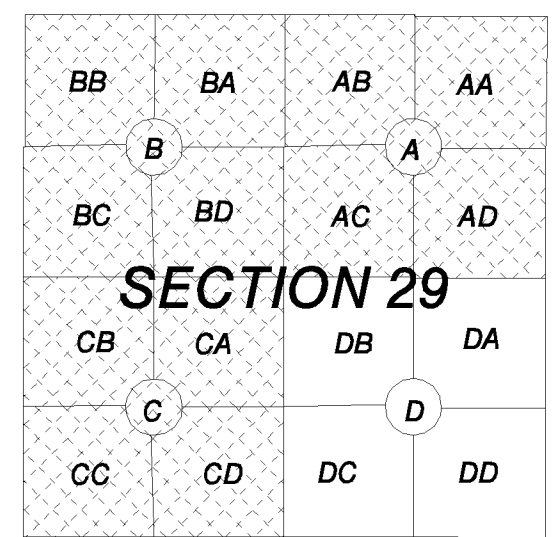

Cancelled Taxlots For: 2S129D
 401,402,500-A1,104,200,400,403,501,101,102,500,
 700,800,900,1000,1100,100,601,

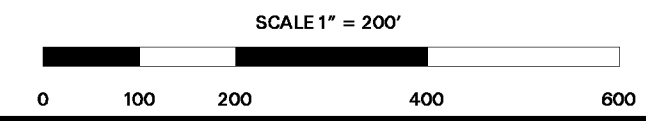

WASHINGTON COUNTY OREGON
Assessment
CARTOGRAPHY
 Taxation

PLOT DATE: August 02, 2016
FOR ASSESSMENT PURPOSES
ONLY - DO NOT RELY ON
FOR OTHER USE

Map areas delineated by either gray shading or a cross-hatched pattern are for reference only and may not indicate the most current property boundaries. Please consult the appropriate map for the most current information.