

Open Space Tree Removal

November 2, 2015

Sander's Tree Report Notes

- One (1) 75' Cottonwood Tree
 - Causing damage to neighbor's landscape/ hardscape
 - Neighbor's grade causing flooding in yard
 - Drops large limbs in neighbor's yard
 - Concern of additional damage to property, roof/gazebo, etc.
 - Arborist cannot do root barrier and recommends tree removal
- Recommend Removal of Tree and Grinding of Stump and Replanting

Sander's Cottonwood-Roots



Large Diameter
Roots growing
into neighbors
yard, causing
localized flooding,
removal of tree
needed

Storm Water Quality Facility
(SWQF)
Woodhaven 1-A
(behind LaSalle Court)

November 2, 2015

Woodhaven SWQF 1A-CIP

- Removal of approximately 25 volunteer Cottonwood trees
- Removal of various Willow and downed/dead trees in bottom of pond causing storm system to back up and not drain
- Core-out and regrade facility for storm system to operate properly
- Planting of approximately 240 shrubs and trees on side slope of SWQF, in addition to sedges and grasses in bottom of wet pond

Woodhaven SWQF-1A Capital Improvement Project

Blocked inlet, storm
system under water
downed trees, overgrown



Tree growing
into outlet,



Woodhaven SWQF-1A

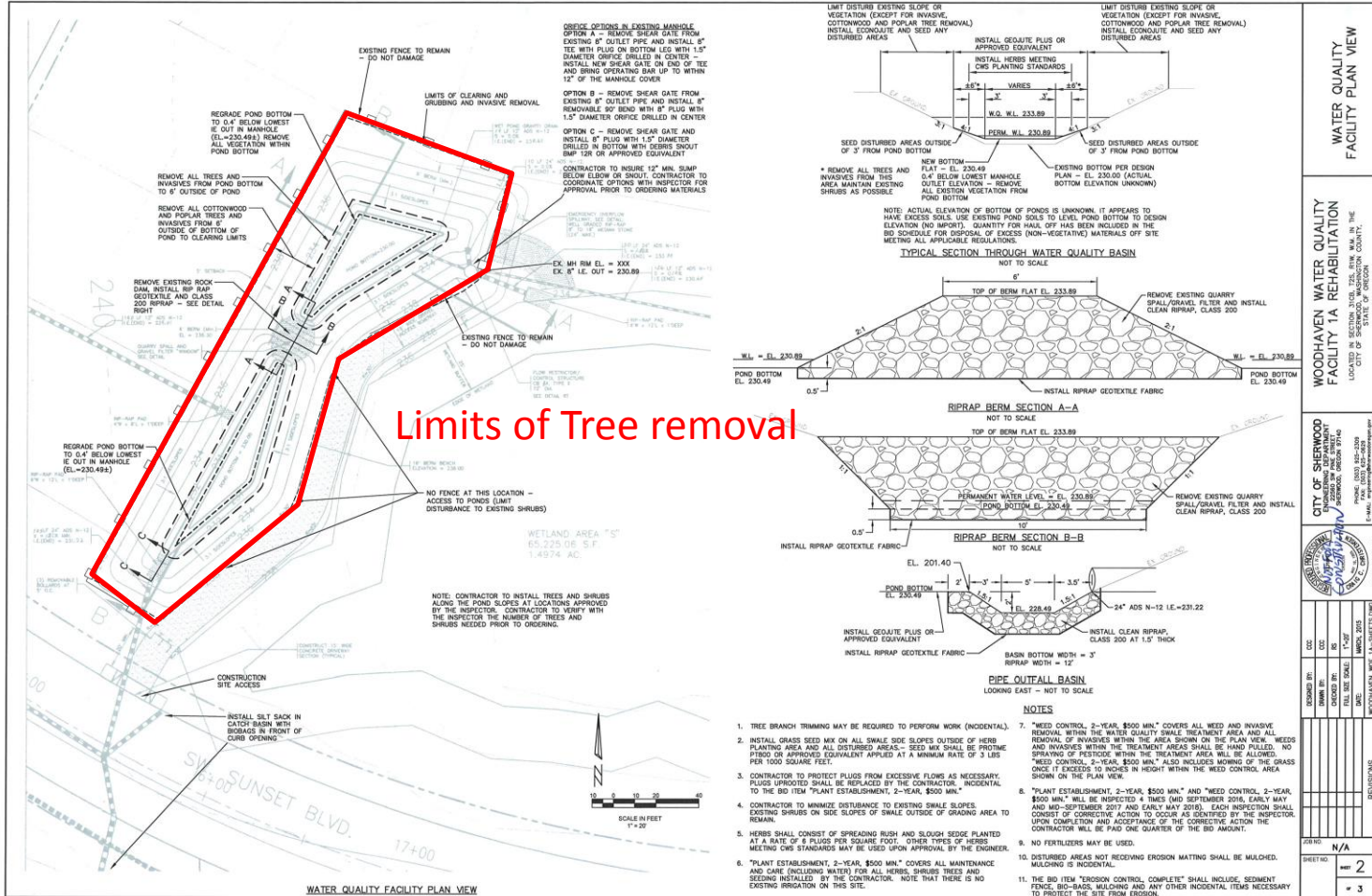

Limits of Tree removal

WATER QUALITY FACILITY PLAN VIEW	
WOODHAVEN WATER QUALITY FACILITY 1A REHABILITATION	
CITY OF SHERWOOD UNIVERSITY MICROFILMS SERIALS ACQUISITION 300 N ZEEB RD ANN ARBOR MI 48106 PHONE: (313) 937-2326 E-MAIL: umi@umdlib.com	
CITY OF SHERWOOD UNIVERSITY MICROFILMS SERIALS ACQUISITION 300 N ZEEB RD ANN ARBOR MI 48106 PHONE: (313) 937-2326 E-MAIL: umi@umdlib.com	
DATE:	NOV 2015
DESIGNED BY:	
DRAWN BY:	
CHECKED BY:	
DATE:	
PROJECT NO.:	WOODHAVEN WQF 1A-SHEETS-01E
SHEET NO.:	2
TOTAL SHEETS:	3

Tree Removal at Snyder Park

November 2, 2015



Tree Removal

Walnut tree at Snyder needs to be removed due to very large cavity located in main trunk



Tree Removal

Two Birch Trees need to be removed and replaced.

Tree Removal/Replacement at Sherwood Center for the Arts

November 2, 2015



Tree Removal

Replace dead tree at Cultural Arts Facility with two (2) trees to match existing.

Tree Removal at Langer Park

November 2, 2015



Tree Removal

Removal of three trees at Langer Park

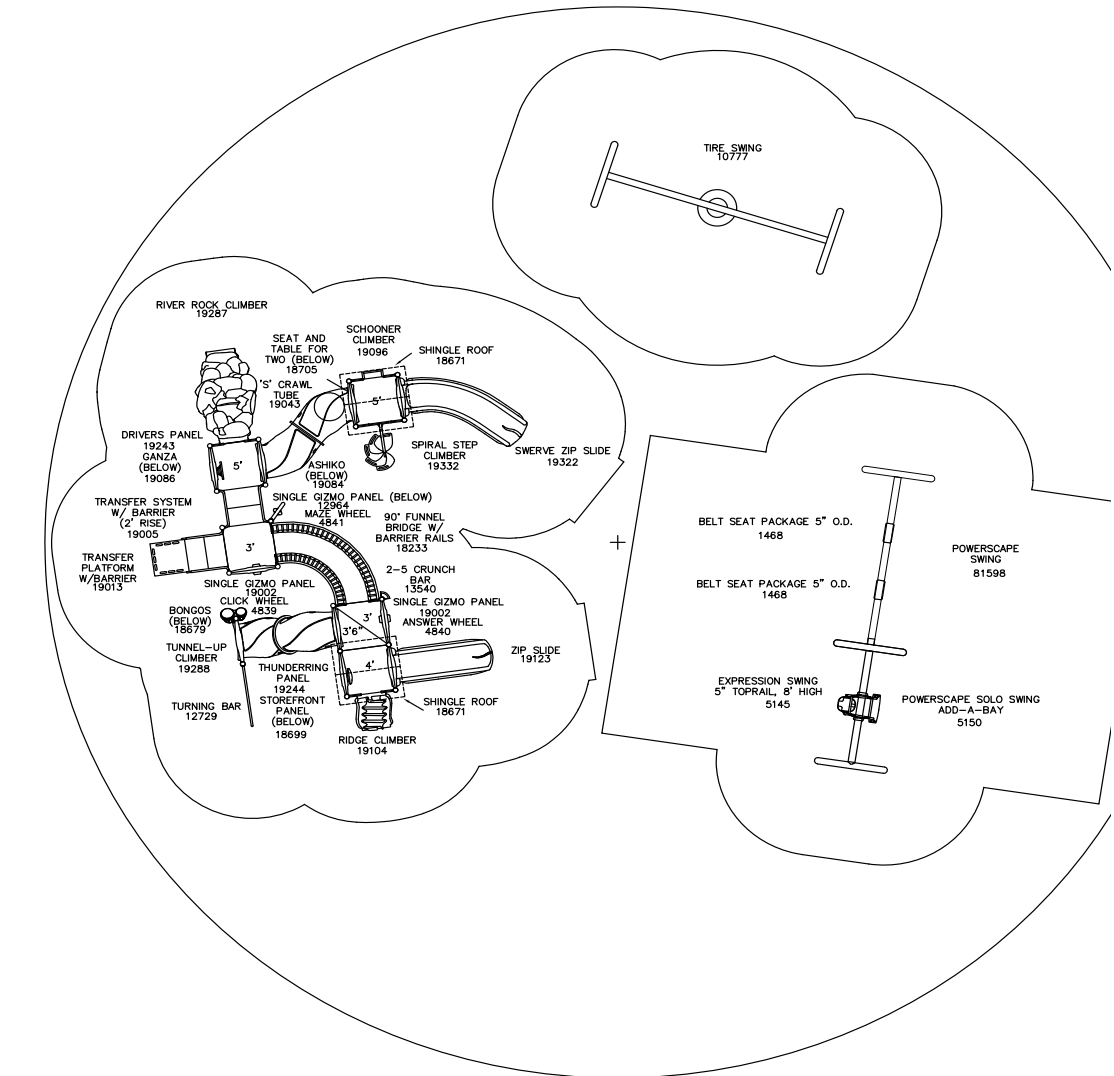

150 PlayCore Drive SE
 Fort Payne, AL 35967
 www.gametime.com

Langer Park
 Sherwood OR

Representative
 MRC

This play equipment is recommended for children ages 5-12

Minimum Area Required:
 Scale: 1" = 5'-0"
 This drawing can be scaled only when in an 18" x 24" format

IMPOI should follow equipment critical factors consum ASTM