



ORDINANCE 2021-010

AMENDING SECTIONS OF THE SHERWOOD ZONING AND COMMUNITY DEVELOPMENT CODE FOR RESIDENTIAL DESIGN STANDARDS

WHEREAS, the Sherwood Planning Commission had discussed the need for residential design standards for many years; and

WHEREAS, the Sherwood Planning Commission identified the adoption of residential design standards as part of the Sherwood 2040 project; and

WHEREAS, the community's desire for residential design standards were reinforced through the Visual Preference Survey and Virtual Open House; and

WHEREAS, the proposed amendments are for clear and objective design standards that would allow the development community a clear path in meeting the required design standards, making it feasible for more housing construction; and

WHEREAS, the Planning Commission (acting as the Advisory Committee for this project) have conducted 15 Planning Commission work sessions on the proposed Residential Design Standards.

WHEREAS, Sherwood City Council held two work session briefings on the proposed Residential Design Standards.

WHEREAS, at its meeting on October 26, 2021, the Planning Commission conducted a public hearing, considered proposed clear and objective Residential Design Standards, and recommended that the City Council adopt the proposed amendments; and

WHEREAS, the City Council held the first public hearing on the proposed amendments on November 16, 2021.

NOW, THEREFORE, THE CITY OF SHERWOOD ORDAINS AS FOLLOWS:

Section 1. After full and due consideration of the application, the Planning Commission recommendation, the record, and evidence presented at the public hearings, the City Council adopts the findings of fact contained in the Planning Commission recommendation, which is included as Attachment 1 to the staff report for this Ordinance, finding that the text of the indicated sections of the Sherwood Zoning and Community Development Code shall be amended to read as documented in Exhibit 1, attached to this Ordinance.

Section 2. The proposed amendments to the Sherwood Zoning and Community Development Code in Exhibit 1, attached to this Ordinance, are hereby **APPROVED**.

Section 3. This Ordinance shall become effective 30 days from its adoption

Duly passed by the City Council this 7th day of December, 2021.



Keith Mays, Mayor

12/7/2021

Date

Attest:



Sylvia Murphy, MMC, City Recorder

	<u>AYE</u>	<u>NAY</u>
Scott	<input checked="" type="checkbox"/>	_____
Griffin	<input checked="" type="checkbox"/>	_____
Brouse	<input checked="" type="checkbox"/>	_____
Young	<input checked="" type="checkbox"/>	_____
Garland	<input checked="" type="checkbox"/>	_____
Rosener	<i>Absent</i>	_____
Mays	<input checked="" type="checkbox"/>	_____

Title 16

ZONING AND COMMUNITY DEVELOPMENT CODE

Proposed Amendments

This document presents the “Clean” copy of the proposed Residential Design Standards code amendments.

The proposed amendments are organized by code chapter. Only those sections of the code that are proposed to be amended are included in the document.

TABLE OF CONTENTS

Division I. – GENERAL PROVISIONS

Chapter 16.02 - INTRODUCTION*

16.02.010 - Title

16.02.020 - Purpose

16.02.030 - Conformance Required

16.02.040 - Violations

16.02.050 - Interpretation

16.02.060 - Savings Clause

16.02.070 - Conflicting Ordinances

16.02.080 - Regional, State and Federal Regulations

16.02.090 - Community Development Plan

Chapter 16.04 - ESTABLISHMENT OF ZONING DISTRICTS*

16.04.010 - Districts

16.04.020 - Official Map

16.04.030 - Zoning District Boundaries

16.04.040 - Urban Growth Area

Chapter 16.06 - PLANNING COMMISSION*

16.06.010 - Appointment and Membership

16.06.020 - Officers, Minutes, and Voting

16.06.030 - Conflicts of Interest

16.06.040 - Powers and Duties

Chapter 16.08 - HEARINGS OFFICER

16.08.010 - Appointment

16.08.020 - Minutes

16.08.030 - Conflicts of Interest

16.08.040 - Powers and Duties

Chapter 16.10 - DEFINITIONS

16.10.010 - Generally

16.10.020 - Specifically

Division II. - LAND USE AND DEVELOPMENT

Chapter 16.12 - RESIDENTIAL LAND USE DISTRICTS

16.12.010 - Purpose and Density Requirements

16.12.020 - Allowed Residential Land Uses

16.12.030 - Residential Land Use Development Standards

16.12.040 - Community Design

16.12.050 - Flood Plain

16.12.060 - Amateur Radio Towers/Facilities

Chapter 16.14 – RESIDENTIAL BUILDING DESIGN

16.14.010 – Residential Building Design Standards for all housing types except for Multi-family housing

16.14.020 – Additional Townhome Design Standards

16.14.030 – Additional Triplex and Quadplex Design Standards

16.14.040 – Additional Cottage Cluster Development and Design Standards

Chapter 16.22 - COMMERCIAL LAND USE DISTRICTS

16.22.010 - Purpose

16.22.020 - Uses

16.22.030 - Development Standards

16.22.040 - Community Design

16.22.050 - NC Special Criteria

16.22.060 - Floodplain

Chapter 16.31 - INDUSTRIAL LAND USE DISTRICTS

16.31.010 - Purpose

16.31.020 - Uses

16.31.030 - Development Standards

16.31.040 - Special Standards Hospitality and Lodging Uses Within the Light Industrial Zone

16.31.050 - Employment Industrial (EI) Restrictions

16.31.060 - Tonquin Employment Area (TEA) Commercial Nodes Use Restrictions

16.31.070 - Community Design

16.31.080 - Floodplain

Chapter 16.36 - INSTITUTIONAL AND PUBLIC (IP) LAND USE DISTRICT

16.36.010 - Purpose

16.36.020 - Permitted Uses

16.36.050 Dimensional Standards

16.36.060 - Community Design

16.36.070 - Floodplain

Chapter 16.38 - SPECIAL USES

16.38.010 - General Provisions

16.38.020 - Medical Marijuana Dispensary

16.38.030 - Recreational Marijuana Facilities

Chapter 16.40 - PLANNED UNIT DEVELOPMENT (PUD)*

- 16.40.010 - Purpose
- 16.40.020 - Preliminary Development Plan
- 16.40.030 - Final Development Plan
- 16.40.040 - General Provisions
- 16.40.050 - Residential PUD
- 16.40.060 - Non-Residential (Commercial or Industrial) PUD

Chapter 16.42 - HOME OCCUPATIONS

- 16.42.010 - Purpose
- 16.42.020 - Authority
- 16.42.030 - Exemptions
- 16.42.040 - Class A and Class B Home Occupations
- 16.42.050 - General Definition and Criteria for Home Occupations
- 16.42.060 - Class B Home Occupation Criteria Defined
- 16.42.070 - Class A Home Occupation Permit Criteria Defined
- 16.42.080 - Prohibited Uses
- 16.42.090 - Permit Procedures for Class A Home Occupations
- 16.42.100 - Expiration and Revocation of Home Occupation Permits
- 16.42.110 - Appeals

Chapter 16.44 - TOWNHOMES* (Deleted per Ordinance 2022-_____)

Chapter 16.46 - MANUFACTURED HOMES*

- 16.46.010 - Manufactured Homes on Individual Residential Lots
- 16.46.020 - Manufactured Home Parks
- 16.46.030 - Miscellaneous Uses of Manufactured Homes

Chapter 16.48 - NON-CONFORMING USES*

- 16.48.010 - Purpose
- 16.48.020 - Exceptions
- 16.48.030 - Non-Conforming Lots of Record
- 16.48.040 - Non-Conforming Uses of Land
- 16.48.050 - Non-Conforming Structures
- 16.48.060 - Non-Conforming Uses of Structures
- 16.48.070 - Permitted Changes to Non-Conformities
- 16.48.080 - Conditional Uses

Chapter 16.50 - ACCESSORY STRUCTURES, ARCHITECTURAL FEATURES AND DECKS

- 16.50.010 - Standards and Definition
- 16.50.020 - Conditional Uses

16.50.030 - Conflicts of Interpretation

16.50.040 - Accessory Structure Exemptions

16.50.050 - Architectural Features

16.50.060 - Decks

16.50.070 - In Ground Pools

Chapter 16.52 - ACCESSORY DWELLING UNITS

16.52.010 - Purpose

16.52.020 - Requirements for all accessory dwelling units

Chapter 16.54 - ADULT ENTERTAINMENT

16.54.010 - Adult Entertainment

Chapter 16.56 - OTHER LAND USE ACTIONS

16.56.010 - Other Land Use Actions

Chapter 16.58 - VISION CLEARANCE AND FENCE STANDARDS

16.58.010 - Clear Vision Areas

16.58.020 - Fences, Walls and Hedges.

Chapter 16.60 - YARD REQUIREMENTS

16.60.010 - Through Lots

16.60.020 - Corner Lots

16.60.030 - Yards

16.60.040 - Lot Sizes and Dimensions

Chapter 16.62 - CHIMNEYS, SPIRES, ANTENNAS, AND SIMILAR STRUCTURES*

16.62.010 - Heights

16.62.020 - Permit Required

16.62.030 - Parapets

Chapter 16.66 - TRANSPORTATION FACILITIES AND IMPROVEMENTS

16.66.010 - Generally

Chapter 16.68 - INFILL DEVELOPMENT STANDARDS*

16.68.010 - Purpose and Intent

16.68.020 - Lot Sizes and Dimensions for Infill

16.68.030 - Building Design on Infill Lots

16.68.040 - Height

16.68.050 - Yard Requirements for Infill Development

16.68.060 - Public Notice

Division III. - ADMINISTRATIVE PROCEDURES

Chapter 16.70 - GENERAL PROVISIONS

- 16.70.010 - Pre-Application Conference
- 16.70.020 - Neighborhood Meeting
- 16.70.030 - Application Requirements
- 16.70.040 - Application Submittal
- 16.70.050 - Availability of Record for Review
- 16.70.060 - Application Resubmission

Chapter 16.72 - PROCEDURES FOR PROCESSING DEVELOPMENT PERMITS

- 16.72.010 - Generally
- 16.72.020 - Public Notice and Hearing
- 16.72.030 - Content of Notice
- 16.72.040 - Planning Staff Reports
- 16.72.050 - Conduct of Public Hearings
- 16.72.060 - Notice of Decision
- 16.72.070 - Registry of Decisions
- 16.72.080 - Final Action on Permit or Zone Change

Chapter 16.74 - APPLICATION FEES*

- 16.74.010 - Fees
- 16.74.020 - Exceptions

Chapter 16.76 - APPEALS*

- 16.76.010 - Generally
- 16.76.020 - Appeal Deadline
- 16.76.030 - Petition for Review
- 16.76.040 - Appeal Authority Action

Division IV. - PLANNING PROCEDURES

Chapter 16.80 - PLAN AMENDMENTS

- 16.80.010 - Initiation of Amendments
- 16.80.020 - Amendment Procedures
- 16.80.030 - Review Criteria

Chapter 16.82 - CONDITIONAL USES*

- 16.82.010 - Generally
- 16.82.020 - Permit Approval

Chapter 16.84 - VARIANCES

- 16.84.010 - Purpose
- 16.84.020 - Applicability
- 16.84.030 - Types of Variances

Chapter 16.86 - TEMPORARY USES

16.86.010 - Purpose

16.86.020. - Temporary Uses - No Permits Required

16.86.030 - Temporary Uses - Requiring Permits

Chapter 16.88 - INTERPRETATION OF SIMILAR USES

16.88.010 - Generally

16.88.020 - Application Content

16.88.030 - Approvals

16.88.040 - Uses

Chapter 16.89 – RESIDENTIAL DESIGN CHECKLIST AND RESIDENTIAL DESIGN REVIEW

16.89.010 – Purpose and Overview

16.89.020 – Residential Design Checklist Review or Residential Design Review Required

16.89.030 - Residential Design Review.

Division V. - COMMUNITY DESIGN

Chapter 16.90 - SITE PLANNING*

16.90.010 - Purpose

16.90.020 - Site Plan Review

16.90.030 - Site Plan Modifications and Revocation

Chapter 16.92 - LANDSCAPING

16.92.010 - Landscaping Plan Required

16.92.020 - Landscaping Materials

16.92.030 - Site Area Landscaping and Perimeter Screening Standards

16.92.040 - Installation and Maintenance Standards

Chapter 16.94 - OFF-STREET PARKING AND LOADING

16.94.010 - General Requirements

16.94.020 - Off-Street Parking Standards

16.94.030 - Off-Street Loading Standards

Chapter 16.96 - ON-SITE CIRCULATION

16.96.010 - On-Site Pedestrian and Bicycle Circulation

16.96.020 Minimum - Residential standards

16.96.030 - Minimum Non-Residential Standards

16.96.040 - On-Site Vehicle Circulation

Chapter 16.98 - ON-SITE STORAGE*

16.98.010 - Recreational Vehicles and Equipment

16.98.020 - Solid Waste and Recycling Storage

16.98.030 - Material Storage

16.98.040 - Outdoor Sales and Merchandise Display

Chapter 16.100 - PERMANENT SIGNS

16.100.010 - Common Regulations

16.100.015 Sign - Related definitions

16.100.020 - Prohibited Signs

16.100.030 - Sign Regulations by Zone

Chapter 16.102 - TEMPORARY, PORTABLE AND BANNER SIGNS

16.102.010 - Temporary and Portable Signs—Purpose

16.102.020 - Temporary and Portable Signs—General Regulations

16.102.030 - Temporary Sign Regulations

16.102.040 - Portable Sign Regulations

16.102.050 - Banner Sign Regulations

16.102.060 - Violations to Temporary, Portable and Banner Sign Standards

Division VI. - PUBLIC INFRASTRUCTURE

Chapter 16.104 - GENERAL PROVISIONS

16.104.010 - Purpose

16.104.020 - Future Improvements

16.104.030 - Improvement Procedures

Chapter 16.106 - TRANSPORTATION FACILITIES

16.106.010 - Generally

16.106.020 - Required Improvements

16.106.030 - Location

16.106.040 - Design

16.106.060 - Sidewalks

16.106.070 - Bike Lanes

16.106.080 - Traffic Impact Analysis (TIA)

16.106.090 - Rough Proportionality

Chapter 16.108 - IMPROVEMENT PLAN REVIEW

16.108.010 - Preparation and Submission

16.108.020 - Construction Permit

16.108.030 - Construction

16.108.040 - Acceptance of Improvements

Chapter 16.110 - SANITARY SEWERS*

16.110.010 - Required Improvements

16.110.020 - Design Standards

16.110.030 - Service Availability

Chapter 16.112 - WATER SUPPLY*

16.112.010 - Required Improvements

16.112.020 - Design Standards

16.112.030 - Service Availability

Chapter 16.114 - STORM WATER*

16.114.010 - Required Improvements

16.114.020 - Design Standards

16.114.030 - Service Availability

Chapter 16.116 - FIRE PROTECTION*

16.116.010 - Required Improvements

16.116.020 - Standards

16.116.030 - Miscellaneous Requirements

Chapter 16.118 - PUBLIC AND PRIVATE UTILITIES

16.118.010 - Purpose

16.118.020 - Standard

16.118.030 - Underground Facilities

16.118.040 - Exceptions

16.118.050 - Private Streets

Division VII. - LAND DIVISIONS, SUBDIVISIONS, PARTITIONS, LOT LINE ADJUSTMENTS AND MODIFICATIONS

Chapter 16.120 - SUBDIVISIONS

16.120.010 - Purpose

16.120.020 - General Subdivision Provisions

16.120.030 - Approval Procedure-Preliminary Plat

16.120.040 - Approval Criteria: Preliminary Plat

16.120.050 - Final Subdivision Plat

16.120.060 - Improvement Agreement

16.120.070 - Bond

16.120.080 - Filing and Recording of Final Subdivision Plat

Chapter 16.122 - LAND PARTITIONS

16.122.010 - Generally

16.122.020 - Approval Criteria: Preliminary Plat

16.122.030 - Final Partition Plat

16.122.040 - Future Subdivision Compliance

16.122.050 - Filing and Recording Requirements

Chapter 16.124 - PROPERTY LINE ADJUSTMENTS AND LOT CONSOLIDATIONS

16.124.010 - Approval Process

16.124.020 - Approval Criteria

16.124.030 - Filing and Recording Requirements

Chapter 16.126 - REPLATTING, LOT CONSOLIDATIONS AND VACATION OF PLATS

16.126.010. - Generally

16.126.020 - Basis for Denial

16.126.030. - Timing of Vacations

16.126.040 - After Sale of Lots

16.126.050 - Lot Consolidations

Chapter 16.128 - LAND DIVISION DESIGN STANDARDS

16.128.010 - Blocks

16.128.020 - Pedestrian and Bicycle Ways

16.128.030 - Lots

Division VIII. - ENVIRONMENTAL RESOURCES

Chapter 16.132 - GENERAL PROVISIONS

16.132.010 - Purpose

Chapter 16.134 - FLOODPLAIN (FP) OVERLAY

16.134.010 - Generally

16.134.020 - Purpose

16.134.030 - Greenways

16.134.040 - Development Review and Floodplain Administrator Duties

16.134.050 - Permitted Uses

16.134.060 - Conditional Uses

16.134.070 - Prohibited Uses

16.134.080 - Floodplain Development

16.134.090 - Floodplain Structures

16.134.100 - Additional Requirements

Chapter 16.136 - PROCEDURES*

16.136.010 - Applicability

16.136.020 - Conformance

16.136.030 - Additional Information

16.136.040 - Referenced Statutes and Rules

16.136.050 - Exceptions

Chapter 16.138 - MINERAL RESOURCES*

16.138.010 - Permitted Activities

16.138.020 - Special Conditions

Chapter 16.140 - SOLID WASTE*

16.140.010 - Solid Waste Facilities

16.140.020 - Solid Waste Incinerators

16.140.030 - Accessory Use Solid Waste Facilities

16.140.040 - Multiple Purpose Solid Waste Facility

16.140.050 - Temporary Solid Waste Facility

16.140.060 - Application Contents

16.140.070 - Review Procedures and Burden of Proof

16.140.080 - Conditions of Approval and Enforcement

16.140.090 - Site Improvement

Chapter 16.142 - PARKS, TREES AND OPEN SPACES

16.142.010 - Purpose

16.142.020 - Multi-Family Developments

16.142.030 - Single-Family or Duplex Residential Subdivisions

16.142.040 - Visual Corridors

16.142.050 - Park Reservation

16.142.060 - Street Trees

16.142.070 - Trees on Property Subject to Certain Land Use Applications

16.142.080 - Trees on Private Property — not subject to a land use action

16.142.090 - Recommended Street Trees

Chapter 16.144 - WETLAND, HABITAT AND NATURAL AREAS*

16.144.010 - Generally

16.144.020 - Standards

16.144.030 - Exceptions to Standards

Chapter 16.146 - NOISE*

16.146.010 - Generally

16.146.020 - Noise Sensitive Uses

16.146.030 - Exceptions

Chapter 16.148 - VIBRATIONS*

16.148.010 - Generally

16.148.020 - Exceptions

Chapter 16.150 - AIR QUALITY*

16.150.010 - Generally

16.150.020 - Proof of Compliance

16.150.030 - Exceptions

Chapter 16.152 - ODORS*

16.152.010 - Generally

16.152.020 - Standards

16.152.030 - Exceptions

Chapter 16.154 - HEAT AND GLARE*

16.154.010 - Generally

16.154.020 - Exceptions

Chapter 16.156 - ENERGY CONSERVATION*

16.156.010 - Purpose

16.156.020 - Standards

16.156.030 - Variance to Permit Solar Access

Division IX. - HISTORIC RESOURCES

Chapter 16.158 - GENERAL PROVISIONS*

16.158.010 - Purpose

Chapter 16.160 - SPECIAL RESOURCE ZONES*

16.160.010 - Generally

Chapter 16.162 - OLD TOWN (OT) OVERLAY DISTRICT*

16.162.010 - Purpose

16.162.020 - Objectives

16.162.030 - Permitted Uses

16.162.040 - Conditional Uses

16.162.050 - Prohibited Uses

16.162.060 - Dimensional Standards

16.162.070 - Community Design

16.162.080 - Standards for All Commercial, Institutional and Mixed-Use Structures in the Old Cannery Area.

16.162.090 - Old Town Smockville Design Standards

16.162.100 - Architectural Guidelines.

Chapter 16.164 - LANDMARK REVIEW*

16.164.010 - GENERALLY

Chapter 16.166 - LANDMARK DESIGNATION*

16.166.010 - Generally

16.166.020 - Effect of Designation

16.166.030 - Procedures

16.166.040 - Standards

Chapter 16.168 - LANDMARK ALTERATION*

16.168.010 - PROCEDURES

16.168.020 - ALTERATION STANDARDS

16.168.030 - VARIANCES TO ALTERATION STANDARDS

Chapter 16.170 - LANDMARK DESIGNATION INCENTIVES*

16.170.010 - Generally

16.170.020 - Incentives

Division I. - GENERAL PROVISIONS

Chapter 16.10 - DEFINITIONS

[...]

16.10.020 - Specifically

The following terms shall have specific meaning when used in this Code:

Common Courtyard: A common area for use by residents of townhomes, multi-family developments. A common courtyard may function as a community yard. Hard and soft landscape features may be included in a common courtyard, such as pedestrian paths, lawn, groundcover, trees, shrubs, patios, benches, or gazebos.

Common-Wall Dwelling: Dwelling units with shared walls such as two-family, and multi-family dwellings. The common wall must be shared for at least 25 percent of the length of the side of the building of the dwelling units. The common wall may be any wall of the building, including the walls of attached garages

Driveway Approach: The edge of a driveway where it abuts a public right-of-way.

Dwelling Types:

- **Accessory Dwelling Unit:** An interior, attached, or detached dwelling unit that is used in connection with, or that is accessory to, a single dwelling on a single lot or parcel. Also known as an ADU.
- **Duplex:** Two (2) attached dwelling units, in any configuration, located on a single lot or parcel.
- **Dwelling, Single-Family Detached:** A detached structure on a lot or parcel that is comprised of a single dwelling unit.
- **Dwelling, Single-Family Attached:** A single structure on two lots, containing two individual dwelling units, but with a common wall and a common property line. Otherwise identical to a two-family dwelling.
- **Dwelling, Two-Family or Duplex:** A single structure on one lot containing two individual dwelling units, sharing a common wall, but with separate entrances.
- **Dwelling, Townhome or Row House:** A single-family dwelling unit which is attached on one or both sides to a similar adjacent unit(s) on similar lot(s). The attachment is made along one or more common walls which are jointly owned. The units may either be on individual platted lots or may be located on a single lot as individual condominium units. The units are distinct from each other by scale, color, massing, or materials.
- **Dwelling, Multi-Family:** A single structure containing five (5) or more dwelling units that share common walls or floor/ceilings with one or more units. The land underneath the structure is not divided into separate lots. Multi-dwellings include structures commonly called garden apartments, apartments and condominiums.
- **Townhome:** A dwelling unit that is part of a row of two (2) or more attached dwelling units, where each unit is located on an individual lot or parcel and shares at least one common wall with an adjacent dwelling unit.
- **Townhome Block:** A unit of a townhome development consisting of no less than two (2) and no more than six (6) townhomes.
- **Townhome Project:** One or more townhouse structures constructed, or proposed to be constructed, together with the development site where the land has been divided, or is proposed to be divided, to reflect the townhome property lines and the any commonly owned property.

Dwelling Unit: Any room, suite of rooms, enclosure, building or structure designed or used as a residence for one household as defined by this Code, and containing sleeping, kitchen and bathroom facilities.

Entrance, Main: The entrance to a dwelling or building that most pedestrians are expected to use. Typically, this is the front door of a dwelling unit. Each dwelling may have a main entrance from the outside, or multiple dwellings may share one main entrance. In multi-dwelling or multitenant buildings, main entrances open directly into the building's lobby or principal interior ground-level circulation space. When a multi-dwelling or multitenant building does not have a lobby or common interior circulation space, each dwelling unit or tenant's outside entrance is a main entrance.

Façade, Street-Facing: The wall planes of a structure that are visible from, and at an angle of 45 degrees or less to, a front lot line or street side lot line. Angle measurements for curved front or street side lot lines shall be based on a straight line connecting the opposing lot corners of the front or street side lot line.

Family: Any-number of individuals living together regardless of familial or non-familial relationship.

Floor area: The total area of all floors of a building. Floor area is measured for each floor from the exterior faces of a building or structure. Floor area includes stairwells, ramps, shafts, chases, and the area devoted to garages and structured parking. Floor area does not include the following (see Figure 1):

- Areas where the elevation of the floor is 4 feet or more below the adjacent right-of way;
- Roof area, including roof top parking;
- Roof top mechanical equipment; and
- Roofed porches, exterior balconies, or other similar areas, unless they are enclosed by walls that are more than 42 inches in height for 75 percent or more of their perimeter.

Figure 1. Areas Excluded from Floor Area Calculation

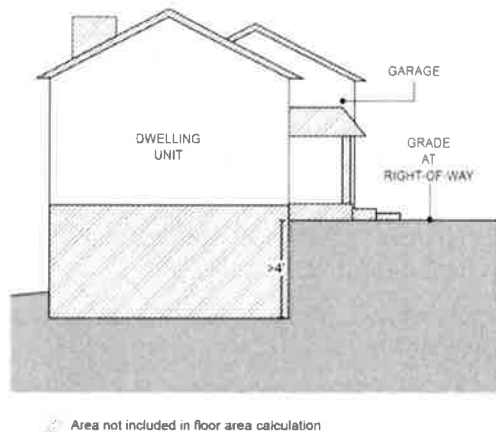

Floor area ratio (FAR): The amount of floor area of a building or structure in relation to the amount of site area, expressed in square feet. For example, a floor area ratio of 0.7 to 1 means 0.7 square feet of floor area for every one square foot of site area. FAR is calculated by dividing the total floor area of all buildings on a site by the total site area (See Figure 2).

Figure 2. Floor Area Ratio (FAR) Calculation

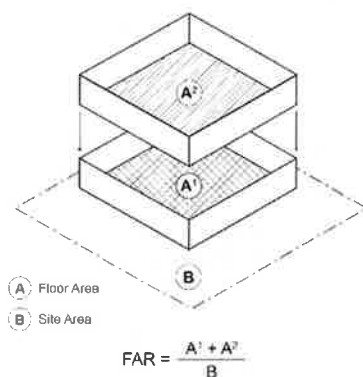

Household: One person living alone or a group of people living together as a single unit, excluding occupants of a boardinghouse, fraternity, hotel, accessory dwelling unit, or similar use.

Open Space, Common: Private open space provided within a development which is provided for, and which is permanently accessible to, all residents/tenants of the development.

Porch: A roofed shelter, usually open at the sides, projecting from the face of a building and used to protect the entrance to a building; a carport is not considered a porch.

Street: A public or private road, easement or right-of-way that is created to provide access to one (1) or more lots, parcels, areas or tracts of land. Categories of streets include:

- A. Alley: A narrow street, typically abutting to the rear lot or property line. [Figure 8-3a of the Transportation System Plan illustrates the alley cross-section]

- B. **Arterial:** Arterial streets provide connectivity at a regional level, but are not State routes. [Figure 8-2 of the Transportation System Plan illustrates arterial cross-sections.]
- C. **Bikeway:** Any road, path or way that is in some manner specifically open to bicycle travel, regardless of whether such facilities are designated for the exclusive use of bicycles or are shared with other transportation modes. Bikeways may include:
 - (1) **Multi-use Path.** A paved way (typically eight (8) to twelve (12) feet wide) separate from vehicular traffic; typically shared with pedestrians, skaters, and other non-motorized users.
 - (2) **Bike Lane.** A portion of the street (typically four (4) to six (6) feet wide) that has been designated by permanent striping and pavement markings for the exclusive use of bicycles.
 - (3) **Shoulder Bikeway.** The paved shoulder of a street that does not have curbs or sidewalks that is four feet or wider and is typically shared with pedestrians.
 - (4) **Shared Roadway.** A travel lane that is shared by bicyclists and motor vehicles. Also called "bike route."
 - (5) **Multi-use Trail.** An unpaved path that accommodates all-terrain bicycles; typically shared with pedestrians (NOTE: Figure 8-6 of the Transportation System Plan illustrates the multiuse path and trail cross-sections).
- D. **Common Green:** A street that provides for pedestrian and bicycle access, but not vehicle access, to abutting property and generally provides a common area for use by residents. A common green may function as a community yard. Hard and soft landscape features may be included in a common green, such as groundcover, trees, shrubs, surfaced paths, patios, benches, or gazebos.
- E. **Collector:** Collectors are streets that provide citywide or district-wide connectivity. Collectors are primarily used or planned to move traffic between the local street system, and onto major streets, but may also accommodate through traffic. [Figure 8-4 of the Transportation System Plan illustrates collector cross-sections.]
- F. **Cul-de-Sac:** A short street that terminates in a vehicular turnaround. See Section 16.108.060.
- G. **Half Street:** A portion of the width of a street, usually along the edge of a development, where the remaining portion of the street has been or could be provided by another development.
- H. **Local Street:** Local streets provide the highest level of access to adjoining land uses. Local streets do not provide through connection at any significant regional, citywide or district level. [Figures 8-5a and 8-5b of the Transportation System Plan illustrate local street cross-sections.]
- I. **Marginal Access Street (frontage or backage road):** A minor street parallel and adjacent to a principal arterial or arterial street providing access to abutting properties, but protected from through traffic. [Figure 8-5a of the Transportation System Plan illustrates the cross-sections of a frontage or backage road.]
- J. **Neighborhood Route:** Neighborhood routes are streets that provide connections within or between neighborhoods, but not citywide. Neighborhood routes are primarily used or planned to move traffic between the local street system, and onto collectors and arterials. [Figure 8-5a of the Transportation System Plan illustrates the neighborhood route cross-section.]
- K. **Principal Arterial:** Principal arterials are streets that provide connectivity at a regional level, and are typically State routes. [Figures 8-2 and 8-3b in the Transportation System Plan illustrates the principal arterial cross-section].

Townhome: See "Dwelling Types: Townhome"

Window area: The aggregate area of the glass within each window, including any interior grids, mullions, or transoms.

Division II. - LAND USE AND DEVELOPMENT

Chapter 16.12 - RESIDENTIAL LAND USE DISTRICTS

The residential districts are intended to promote the livability, stability and improvement of the City's neighborhoods.

16.12.010 - Purpose and Density Requirements

A. Very Low Density Residential (VLDR)

1. Standard Density

The VLDR zoning district provides for low density, larger lot single-family housing and other related uses in natural resource and environmentally sensitive areas that warrant preservation but are otherwise deemed suitable for limited development. Standard density in the VLDR zone is 0.7 to 1 dwelling unit per acre.

2. VLDR Planned Unit Development Density Standards

Property in the VLDR zone that is developed through the Planned Unit Development (PUD) process under Chapter 16.40, if all floodplain, wetlands, and other natural resource areas are dedicated or remain in common open space, may develop to a density of 1.4 to 2.0 dwelling units per net buildable acre under the following conditions:

- a. The minimum lot size is not less than 10,000 square feet;
- b. The following areas are dedicated to the public or preserved as common open space: floodplains under Section 16.134.020 (Special Resource Zones); natural resources areas as shown on the Natural Resources and Recreation Plan Map, attached as Appendix C, or as specified in Chapter 5 of the Community Development Plan; and wetlands defined and regulated under current Federal regulation and Division VIII of this Code; and
- c. The higher density development will better preserve natural resources as compared to one (1) unit per acre.

3. Southeast Sherwood Master Planned Unit Development

- a. Property in the VLDR zone that is developed through the Planned Unit Development process under Chapter 16.40 and is based on, and generally conforms to the concepts, goals and objectives of the SE Sherwood Master Plan may develop to a maximum density of four (4.0) dwelling units per net buildable acre.
- b. Development under Section 16.12.010.A.3 must generally follow the development pattern shown as Alternative B/C in the SE Sherwood Master Plan (2006) and address the following factors:
 - (1) Varied lot sizes are allowed with a minimum lot area of 10,000 square feet if it can be shown that adequate buffering exists adjacent to developed properties with screening, landscaping, roadways or open space.
 - (2) The open space areas as required by Chapter 16.40 (Planned Unit Development), where feasible, should include parks and pathways that are located within the general vicinity of Alternative B/C in the SE Sherwood Master Plan.
 - (3) There is a pedestrian-friendly transportation system that links the site with nearby residential developments, schools, parks, commercial areas and other destinations.
 - (4) The unique environmental opportunities and constraints identified in the SE Sherwood Master Plan.
 - (5) The view corridors identified in the SE Sherwood Master Plan.

(6) The housing design types that are compatible with both surrounding and existing development.

- c. A density transfer under Chapter 16.40.050.C.2. is not permitted for development under this Section 16.12.010.A.3.
- d. The Planning Commission will consider the specific housing design types identified and the preservation of the identified view corridors at the time of final development review to ensure compatibility with the existing and surrounding development.

B. Low Density Residential (LDR)

The LDR zoning district provides for single-family housing and other related uses with a density of 3.5 to 5 dwelling units per acre. Minor land partitions shall be exempt from the minimum density requirement.

C. Medium Density Residential (MDRL)

The MDRL zoning district provides for single-family and duplex housing, manufactured housing and other related uses with a density of 5.6 to 8 dwelling units per acre. Minor land partitions shall be exempt from the minimum density requirements.

D. Medium Density Residential High (MDRH)

The MDRH zoning district provides for a variety of medium density housing , including single-family, duplex housing, manufactured housing, multi-family housing, and other related uses with a density of 5.5 to 11 dwelling units per acre. Minor land partitions are exempt from the minimum density requirement.

E. High Density Residential (HDR)

The HDR zoning district provides for housing and other related uses with density of 16.8 to 24 dwelling units per acre. Minor land partitions shall be exempt from the minimum density requirement.

(Ord. No. 2015-003, § 2, 3-17-2015; Ord. No. 2013-003, § 2, 9-3-2013; Ord. No. 2011-003, § 2, 4-5-2011)

16.12.020 - Allowed Residential Land Uses

A. Residential Land Uses

The table below identifies the land uses that are allowed in the Residential Districts. The specific land use categories are described and defined in Chapter 16.10.

USES	VLDR	LDR	MDRL	MDRH	HDR
RESIDENTIAL					
• Single Family Detached Dwellings	P	P	P	P	P
* Duplex	N	N	P	P	P
• Multi-Family Dwellings	N	N	N	P	P
• Townhomes	N	N	N	P	P

• Planned Unit Developments (PUDs)-subject to Chapter 16.40	P	P	P	P	P
• Manufactured Homes on Individual Lots	P	P	P	P	P
• Manufactured Home Park-subject to Chapter 16.46	N	N	P	P	N
• Accessory Dwelling Unit-subject to Chapter 16.52	P	P	P	P	P
• Group Homes ¹	P	P	P	P	P
Whereas P=Permitted, C=Conditional, N=Not Allowed					

¹ Group homes not to exceed five (5) unrelated persons in residence provided such facilities are substantially identical, in the city's determination, in physical form to other types of housing allowed in the zoning district.

- B. Any use not otherwise listed that can be shown to be consistent or associated with the permitted uses or conditionally permitted uses identified in the residential zones or contribute to the achievement of the objectives of the residential zones will be allowed or conditionally permitted using the procedure under Chapter 16.88 (Interpretation of Similar Uses).
- C. Any use that is not permitted or conditionally permitted under this zone that cannot be found to be consistent with the allowed or conditional uses identified as in B. is prohibited in the residential zone using the procedure under Chapter 16.88 (Interpretation of Similar Uses).

(Ord. No. 2012-006, § 2, 3-6-2012; Ord. No. 2011-003, § 2, 4-5-2011)

16.12.030 - Residential Land Use Development Standards

A. Generally

No lot area, setback, yard, landscaped area, open space, off-street parking or loading area, or other site dimension or requirement, existing on, or after, the effective date of this Code shall be reduced below the minimum required by this Code. Nor shall the conveyance of any portion of a lot, for other than a public use or right-of-way, leave a lot or structure on the remainder of said lot with less than minimum Code dimensions, area, setbacks or other requirements, except as permitted by Chapter 16.84. (Variance and Adjustments)

B. Development Standards

Except as modified under Chapter 16.68 (Infill Development), Section 16.144.030 (Wetland, Habitat and Natural Areas), or as otherwise provided, required minimum lot areas, dimensions and setbacks shall be provided in the following table.

Creation of new lots or parcels as part of a townhome development is subject to the applicable land division or Planned Unit Development approval process.

C. Development Standards per Residential Zone

Development Standard by Residential Zone-	VLDR	VLDR-PUD	LDR	MDRL	MDRH	HDR
Minimum Lot areas:(in square ft.)						
• Single Family Detached	40,000	10,000	7,000	5,000	5,000	5,000
• Duplex	40,000	10,000	7,000	5,000	5,000	5,000
• Townhome ¹ :	Average of 1,500 SF per unit	Average of 1,500 SF per unit	Average of 1,500 SF per unit	Average of 1,500 SF per unit	Average of 1,500 SF per unit	Average of 1,500 SF per unit
• Multi-Family-Dwelling: for the first 2 units	X	X	X	10,000	8,000	8,000
• Multi-Family-Dwelling: each additional unit after first 2	X	X	X	X	3,200	1,500
Minimum Lot width at front property line: (in feet)	25	25	25	25	25	25
Minimum Lot width at front property line: (in feet) – Townhomes only	20	20	20	20	20	20
Minimum Lot width at building line ²² : (in feet)						
• Single Family Detached; Duplex;	60	60	60	50	50	50
• Townhome	20	20	20	20	20	20
• Multi-Family dwelling	X	X	X	X	60	60
Lot Depth	80	80	80	80	80	80
Maximum Height (in feet) ²³						

²¹ Minimum lot width at the building line on cul-de-sac lots may be less than that required in this Code if a lesser width is necessary to provide for a minimum rear yard.

Development Standard by Residential Zone-	VLDR	VLDR-PUD	LDR	MDRL	MDRH	HDR
• All other dwelling types	30 feet or 2 stories	30 feet or 2 stories	30 feet or 2 stories	30 feet or 2 stories	35 feet or 2.5 stories	40 feet or 3 stories
• Amateur Radio Tower	70	70	70	70	70	70
• Chimneys, Solar or Wind Devices, Radio and TV aerials ²⁴	50	50	50	50	55	60
Setbacks (in feet)						
• Front yard ⁵	30	20	20	14	14	14
• Face of garage	35	20	20	20	20	20
• Interior side yard ⁶						
• Single-Family Detached; Duplex	5	5	5	5	5	5
• Townhome	0	0	0	0	0	0
• Multi-Family Dwelling						
• 18 ft. or less in height	X	X	X	X	5	5
• Between 18—24 ft. in height	X	X	X	X	7	7
• If over 24 ft. in height	X	X	X	X	§ 16.68 Infill	§ 16.68 Infill
• Corner lot street side						
• Single-Family Detached; Duplex; Townhome	20	20	20	15	15	15

Development Standard by Residential Zone-	VLDR	VLDR-PUD	LDR	MDRL	MDRH	HDR
• Multi-Family Dwelling	X	X	X	X	20	30
• Rear yard	20	20	20	20	20	20

Footnote: If the lot is an irregular shape see definition for Lot Line, Rear, Section 16.10 Definitions

Notes:

1. For townhomes, interior units may have different lot sizes than exterior or corner units, as long as the average of all lots is not greater than 1,500 square feet.
2. Minimum lot width at the building line on cul-de-sac lots may be less than that required in this Code if a lesser width is necessary to provide for a minimum rear yard.
3. Maximum height is the lesser of feet or stories.
4. Some accessory structures, such as chimneys, stacks, water towers, radio or television antennas, etc. may exceed these height limits with a conditional use permit, per Chapter 16.62 (Chimneys, Spires, Antennas and Similar Structures).
5. Reductions in front yard setbacks for architectural features as described in 16.50.050 are not permitted in the MDRL, MDRH, or HDR zoning districts.
6. Adjustments and Variances to interior side-yard setbacks for all housing types are not allowed.

(Ord. No. 2018-007, § 2, 10-2-2018; Ord. No. 2015-003, § 2, 3-17-2015; Ord. No. 2014-006, § 2, 3-4-2014; Ord. No. 2012-006, § 2, 3-6-2012; Ord. No. 2011-003, § 2, 4-5-2011)

16.12.040 - Community Design

- A. Residential garages shall meet the minimum design standards listed on the table below:

	Minimum Width	Minimum Depth	Minimum Garage Door Width
One (1) Car Garage	12 ft.	20 ft.	8 ft.
Two (2) Car Garage	18 ft.	20 ft.	16 ft.
Three (3) Car Garage	26 ft.	20 ft.	Single Door – 8 ft. Double Door – 16 ft.

- B. The vehicle parking area(s) shall be functional based on the minimum design standards listed on the table above, 16.12.040.A. Furnaces, stairs, etc. shall not be located within the garage designated parking areas.
- C. Residential Front-Yard Landscaping – the front-yard area of a lot shall be fully landscaped excluding paved off-street parking areas, paved pedestrian paths, and utility areas. Landscaping materials shall meet standards identified in Section 16.92.020 Landscaping Materials.

D. For additional standards relating to off-street parking and loading, energy conservation, historic resources, environmental resources, landscaping, access and egress, signs, parks and open space, on-site storage, and site design, see Divisions V, VIII, IX.

(Ord. No. 2011-003, § 2, 4-5-2011)

Chapter 16.14 - RESIDENTIAL BUILDING DESIGN

16.14.010 – Residential Building Design Standards for all housing types except for Multi-family housing that is subject to the provisions of Chapter 16.90 Site Planning.

A. Purpose

The following standards are intended to create walkable residential neighborhoods that are visually interesting, compatible with existing development, and avoid monotony in design.

The standards in this section are intended to be clear and objective to allow a streamlined review process per the Residential Design Checklist provisions of Chapter 16.89. Each standard has an associated guideline that provides flexibility for discretionary Design Review by the Planning Commission per Chapter 16.89, Residential Design Review if necessary or desired by the applicant. Adjustments or variances to the standards below can be requested through one of the review processes described in B below.

B. Review Process. The following review processes can be used to review those housing types that are subject to these standards per 16.14.010.C and 16.89.020.A through D. The applicable review process depends on the level of compliance with the clear and objective standards in this section.

1. If all applicable standards from this section are met, Residential Design Checklist review is applied per Chapter 16.89.
2. If any standards of Table 16.14-1 - A, B or C are not met outright, a Type I Adjustment or Type II Class B Variance is required, in addition to the Residential Design Checklist, per Chapter 16.89. The Detailed Design standards of Table 16.14-1.D cannot be adjusted.
3. If the applicant chooses to meet the design guidelines instead of the design standards, a Type IV Design Review is required, per Chapter 16.89.

C. Applicability

1. The standards in this section apply to all new residential development, unless otherwise indicated per the subsections below or per applicable overlay zones. Manufactured home parks and manufactured homes on individual residential lots are subject to the provisions of Chapter 16.46 Manufactured Homes. Additional standards are located in 16.14.020. Multi-family development is subject to the provisions of Chapter 16.90 Site Planning.
2. Expansions and conversions of residential structures in Chapter 16.14. The standards in this section apply to expansions of existing residential structures or conversions of existing single detached dwellings into a duplex, triplex, quadplex or townhome that add more than 50 percent of area to any building elevation(s) adjacent to a public right-of-way or public accessway, as follows:
 - a. The expansion or conversion shall include design elements from Table 16.14-1 below that bring the overall building elevation(s) adjacent to a public right-of-way or public accessway closer to conformance with applicable standards; and
 - b. The expansion or conversion shall not bring the overall building elevation(s) adjacent to a public right-of-way or public accessway further out of conformance with applicable standards. Elements of the existing building elevation(s) adjacent to a public right-of-way or public accessway that are currently out of conformance shall not be made more non-conforming. Elements of the existing building elevation(s) adjacent to a public right-of-way or public accessway that are currently in conformance shall not be made non-conforming.

Table 16.14-1. Residential Design Standards

Design Standard (Objective Process)	Design Guideline (Discretionary Process: Residential Design Review)
A. Entry location and orientation	
<p>These standards apply to all new residential development, except for Multi-family, at the time of building permit submittal. At least one main entrance for each residential structure, or each townhome unit, must meet the following standards.</p> <ol style="list-style-type: none"> 1. The entrance must be within 8 feet of the longest street-facing wall of the dwelling unit. 2. The entrance must either: <ol style="list-style-type: none"> a. Face the street; or b. Be at an angle of up to 45 degrees from the street; or c. Face a common open space that is adjacent to the street and is abutted by dwellings on at least two sides; or d. Open onto a porch. If the entrance opens onto a porch, the porch must: <ol style="list-style-type: none"> 1) Be at least 25 square feet in area with a minimum four-foot depth; 2) Have at least one porch entry facing the street; 3) Have a roof that is no more than 12 feet above the floor of the porch; and 4) Have a roof that covers at least 30% of the porch area. 	<p>Building elevations facing streets, shared courts, and common greens should include pedestrian oriented entrances. Special attention should be given to designing a primary building entrance that is both attractive and functional. Primary entrances should incorporate changes in mass, surface, or finish to emphasize the entrance.</p>
Additional provisions:	None
B. Garages and Off-Street Parking Areas	
<p>These standards apply to all residential housing development except for townhomes and Multi-family development.</p> <p>Where one or more garages face a street, all of the following standards apply:</p> <ol style="list-style-type: none"> 1. The front elevation of the garage(s) may not extend in front of the longest, street-facing elevation of the primary dwelling structure. 	<p>Garages should not be a dominant feature of the front residential elevation. Garage doors should be articulated to reduce their visual impact.</p>

Design Standard (Objective Process)	Design Guideline (Discretionary Process: Residential Design Review)
<p>2. The width of all garages on the street-facing elevation shall not exceed 60 percent of the total width of that elevation. The width of the garage shall be measured from the edges of the finished exterior garage wall.</p> <p>3. Garages that face a street shall contain at least one of the following design features:</p> <ul style="list-style-type: none"> a. Garage trellis or pergola extending at least 12 inches from the building face b. Windows on 15 percent of the garage door c. Natural wood finish d. A recess of at least three (3) feet behind the primary dwelling e. Use of multiple materials finish or colors 	
Additional provisions:	16.14.020 – Additional Townhome Design Standards
C. Windows and Doors	
<p>These standards apply to all residential housing development except for Multi-family development.</p> <p>A minimum of 15 percent of the area of the primary building elevation adjacent to a public right-of-way must include windows or entrance doors. For side building elevations, adjacent to a public right-of-way or public accessway, a minimum of 10 percent of area is required. Percentage calculation can include window trims and shutters. First floor roof elevations are excluded from the calculations. Elevations separated from the street property line by a dwelling are exempt from meeting this standard. For townhomes, this standard applies on each individual unit.</p>	<p>Building elevations adjacent to streets, shared courts, and common greens should include ample levels of glazing to ensure articulation on the façade, daylighting of interior spaces and visibility into the public realm.</p>
Additional provisions:	None
D. Detailed design¹	
<p>1. All single detached dwellings, and duplexes shall incorporate at least five (5) of the following elements on the primary building elevation adjacent to a public right-of-way. At least one element shall be incorporated from each of Subsections a, b and c</p>	<p>Primary building elevations adjacent to streets, shared courts, and common greens should include pedestrian oriented design elements and other design features that provide articulation, variety, interest and quality.</p>

Design Standard (Objective Process)	Design Guideline (Discretionary Process: Residential Design Review)
<p>below. The other two required elements may come from any subsection (a through e) below.</p> <p>All townhome units shall incorporate at least two (2) of the following elements on the primary building elevation adjacent to a public right-of-way. At least one element shall be incorporated from two (2) of Subsections a, b and c below.</p> <p>For corner lots, this standard applies to both street-facing elevations.</p> <p>a. Porches, entries and other offsets:</p> <ul style="list-style-type: none">i. Covered porch at least 36 square feet with a depth not less than six (6) feet as measured perpendicular from the face of the main building façade to the edge of the porch.ii. Recessed entry area at least two (2) feet deep, as measured horizontally from the face of the main building façade, and at least five feet wide.iii. Offset on the building face of at least 16 inches from one exterior wall surface to the other.iv. Balcony that is at least three (3) feet deep, five (5) feet wide, and accessible from an interior room. <p>b. Roof elements:</p> <ul style="list-style-type: none">i. Roof eaves with a minimum projection of 12 inches from the intersection of the roof and the exterior walls.ii. Roof line offsets of at least two (2) feet from the top surface of one roof to the top surface of the other.iii. Any roofing materials other than asphalt shingles.iv. Gable roof, hip roof, shed roof, or gambrel roof design.v. Dormer that is at least four (4) feet wide.vi. Decorative eave braces. <p>c. Window elements:</p>	

Design Standard (Objective Process)	Design Guideline (Discretionary Process: Residential Design Review)
<ul style="list-style-type: none"> i. Window trim around all windows at least three (3) inches wide and five-eighths (5/8) inches deep. ii. Window recesses, in all windows, of at least three (3) inches as measured horizontally from the face of the building façade. iii. Bay window at least one (1) foot deep and three (3) feet wide. iv. Shutters on the exterior of ground floor windows. v. Window Grids. d. Garage elements: <ul style="list-style-type: none"> i. Attached garage width, as measured between the edges of the exterior finished garage wall, of 30 percent or less of the total width of that elevation. ii. A balcony that extends out over the garage and includes columns. iii. Two separate doors for two car garages instead of one large door. iv. Decorative windows on the garage door. v. Decorative details on the garage door. Standard squares on a garage door will not qualify as a decorative detail. e. Building materials: <ul style="list-style-type: none"> i. Horizontal lap siding between three (3) to eight (8) inches wide (the visible portion once installed). ii. Brick, cedar shingles, stucco, or other similar decorative materials covering at least 40 percent of the street-facing façade. iii. Vertical board and batting siding three (3) to eight (8) inches wide (the visible portion once installed). iv. Belly band trim v. Four (4) Paint Color Scheme 	

Design Standard (Objective Process)	Design Guideline (Discretionary Process: Residential Design Review)
Additional provisions:	None
E. Building Materials	
Prohibited building materials include: <ol style="list-style-type: none"> 1. Aluminum 2. Vinyl 3. T-111 siding 	Residential buildings should utilize durable and high-quality exterior building materials that create a visually appealing façade.
F. Limitation on parking	
Off-street parking is not allowed within the front yard of a dwelling except within a designated driveway or garage or per the provisions of 16.14.020.	Parking is located in a manner that does not overwhelm the street-facing façade.
G. House plan variety	
This standard applies to new residential subdivisions and townhome developments only. <ol style="list-style-type: none"> 1. No two directly adjacent or opposite dwellings in a single dwelling detached development of more than four units may have the same front or street-facing facade. This standard is met when front or street-facing facades differ from one another by at least three of the elements listed in subsections (3) through (8) below. Where facades repeat on the same block face, they must have at least three intervening lots between them that meet this standard. 2. No two directly adjacent or opposite townhome blocks in a development of more than two (2) townhome blocks may have the same front or street-facing façade. <ol style="list-style-type: none"> a. For this standard a townhome block is the entire structure of attached townhome units. b. This standard does not apply to individual units within the townhome block. c. This standard is met when front or street-facing facades differ from one townhome block to another by at least three of the elements listed in subsections (3) through (8) below. 3. Materials. The plans specify different exterior cladding materials, a different combination of materials, or different dimensions, spacing, or arrangement of the 	New residential developments should provide a variety of house styles and means of articulation along the front façade to avoid repetitive facades along a block face.

Design Standard (Objective Process)	Design Guideline (Discretionary Process: Residential Design Review)
<p>same materials. This standard does not require or prohibit any combination of materials; it only requires that plans not repeat or mirror one another.</p> <p>4. Articulation. The plans have different offsets, recesses, or projections; or the front building elevations break in different places. For example, a plan that has a stoop entry (recess) varies from one that has an entry under a front porch (projection). For this standard to apply, a recess must have a minimum depth of four (4) feet and a projection or offset must be at least four (4) feet in depth.</p> <p>5. Variation in roof elevation. The plans have different roof forms (e.g., gable versus gambrel or hlp), different roof height (by at least 10 percent), different orientation (e.g., front-facing versus side-facing gable), different roof projections (e.g., with and without dormer or shed, or different type of dormer or shed), or different roof pitch by more than 2 feet of vertical rise to 12 feet of horizontal run.</p> <p>6. Entry or porch. The plans have different configuration or detailing of the front porch or covered entrance.</p> <p>7. Fenestration. The plans have different placement, shape, or orientation of windows or different placement of doors.</p> <p>8. Height. The elevation of the primary roofline (along the axis of the longest roofline) changes by not less than four (4) feet from building to building, or from dwelling unit to dwelling unit, on abutting lots, as applicable. Changes in finished grade of eight (8) feet or more from one lot to the adjacent lot are counted toward change in height for purposes of evaluating facade variation.</p>	
Additional provisions:	16.14.020 – Additional Townhome Design Standards

Notes:

1. The Detailed Design standards in Subsection D of Table 16.14-1 cannot be adjusted through an Adjustment or Variance per Chapter 18.64. If a Detailed Design standard from Subsection D cannot be met for a development, then the development should utilize another option from the list.

D. Illustrations

Figure 3. Entry Location and Orientation – Main Entrance

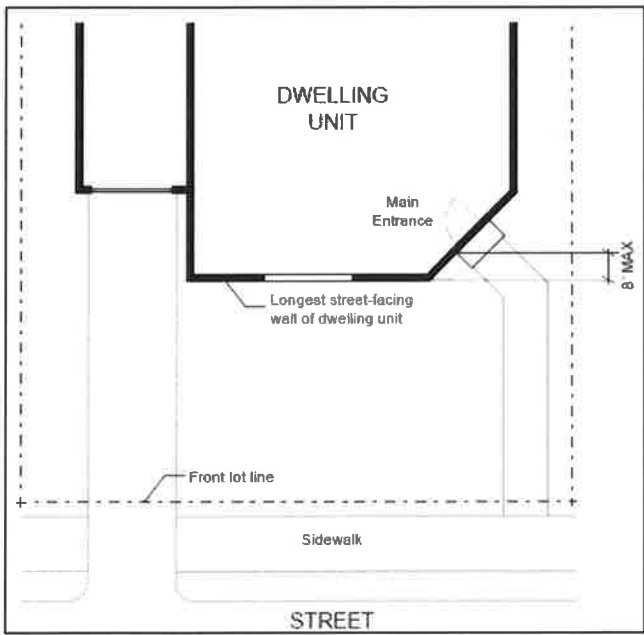
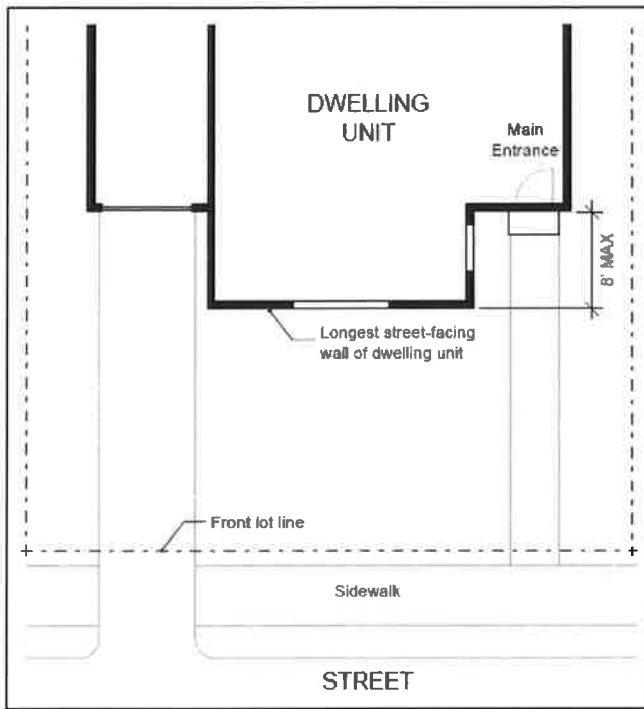

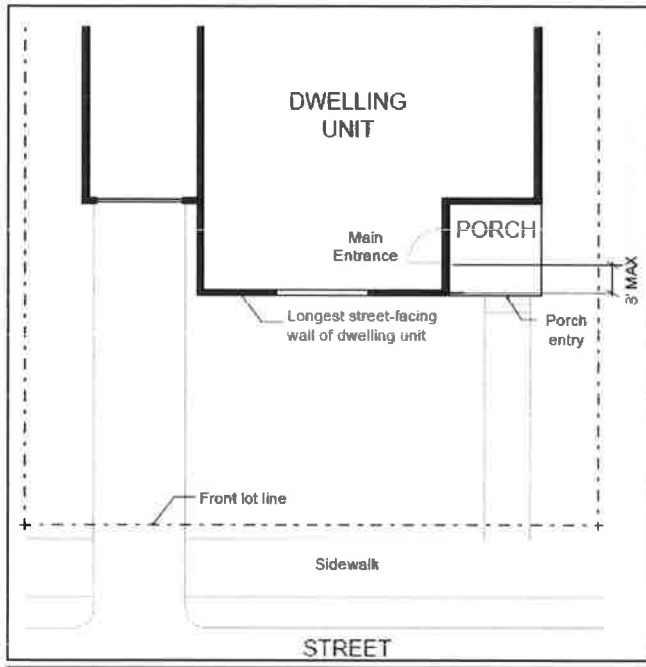

Figure 4. Entrance Location and Orientation – Triplex and Quadplex with Attached Interior Units

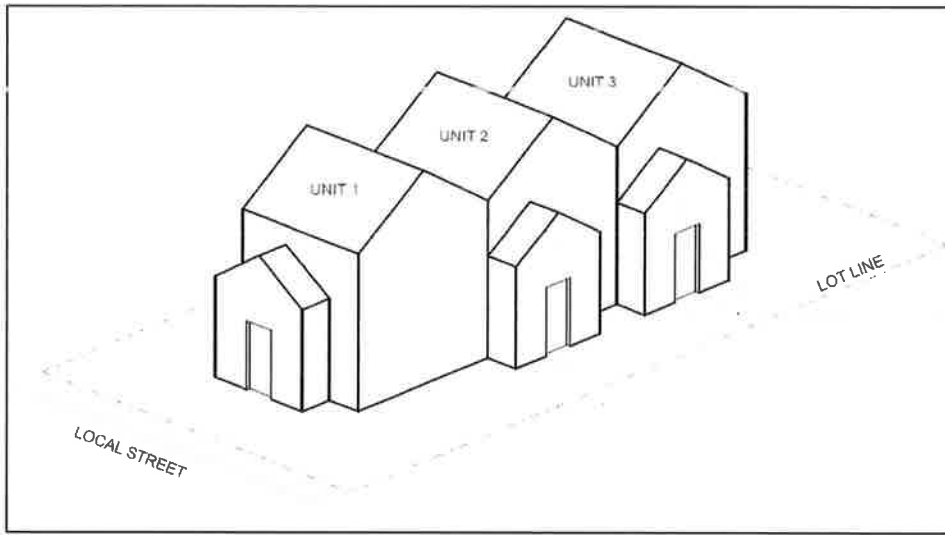

Figure 5. Example Entrance Location and Orientation – Side-by-Side or Stacked Units

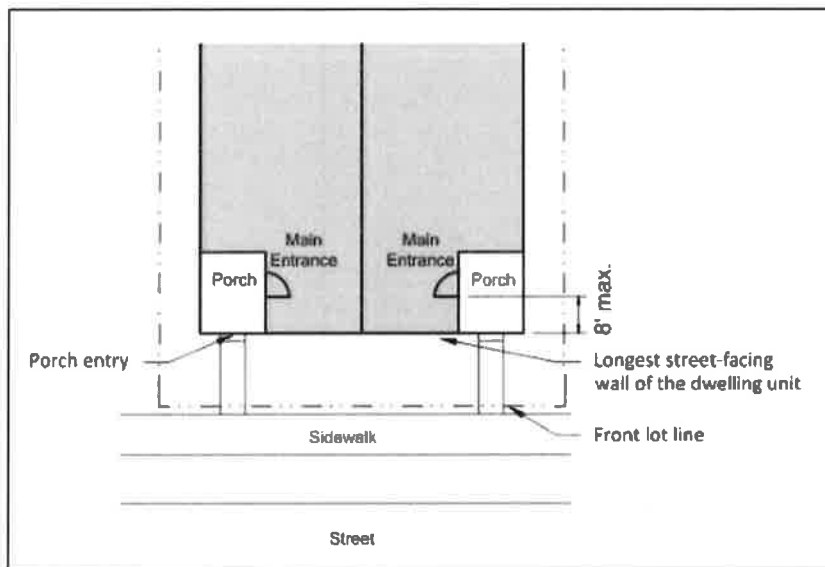

Figure 6. Window Coverage Calculations



Figure 7. Example of Detailed Design – Single Detached (5 elements required)

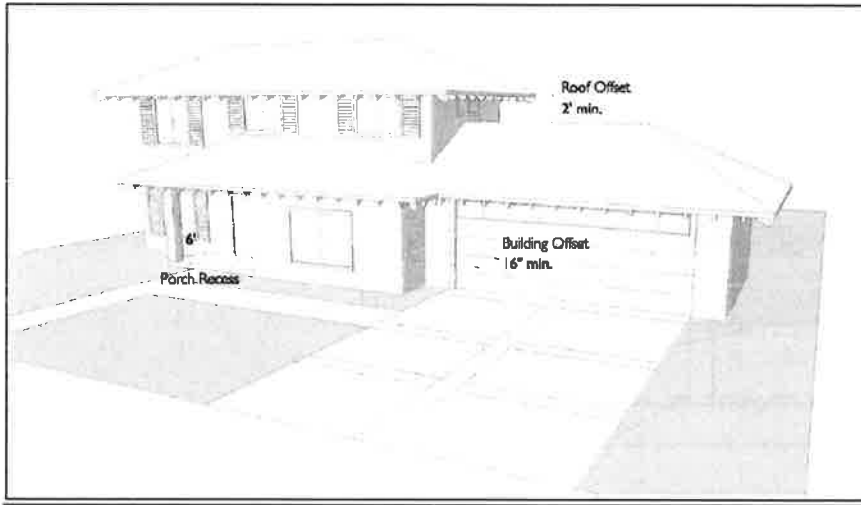

Figure 8. Example of Detailed Design -Townhome (2 elements required)



Figure 9. House Plan Variety – Single Detached



16.14.020 – Additional Townhome Design Standards

A. Generally

Townhomes are located in groups known as "townhome blocks," which consist of no less than two (2) attached dwellings and no more than six (6) attached dwellings on their own lots.

B. Building Mass

The minimum number of attached townhomes is two (2); the maximum number of consecutively attached townhomes shall not exceed six (6) units. Each of these groups is a Townhome Block.

C. Garages

Townhomes with frontage on a public street shall meet the following standards:

1. Garages on the front façade of a townhome, off-street parking areas in the front yard, and driveways in front of a townhome are prohibited unless the following standards are met.
 - a. Each townhome lot has a street frontage of at least 20 feet on a street.
 - b. A maximum of one (1) driveway approach is allowed for every townhome. Driveways may be shared.
 - c. Outdoor on-site parking and maneuvering areas do not exceed 12 feet wide on any lot.
 - d. The garage width does not exceed 12 feet, as measured from the inside of the garage door frame.

D. Designation of Access/Alleys: Townhomes shall receive vehicle access only from the front or rear lot line exclusively, not both. If alleys are used for access they shall be created at the time of subdivision approval and built to City standards as illustrated in the Transportation System Plan.

1. Alley loaded garages shall be set back a minimum five feet to allow a turning radius for vehicles and provide a service area for utilities.
2. If garages face the street, the garage doors shall be recessed behind the front elevation (living area, covered porch, or other architectural feature) by a minimum of one (1) foot.

E. Vehicular Circulation: All streets shall be constructed in accordance with applicable City standards in the Transportation System Plan.

(Ord. No. 2017-001, § 1, 4-4-2017; Ord. No. 2011-009, § 2, 7-19-2011; Ord. 2002-1126, § 2)

Figure 10. Townhome Garages

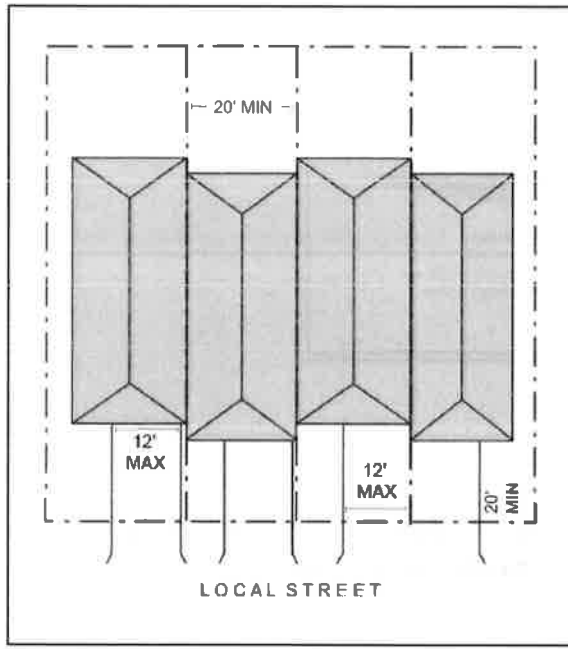

Chapter 16.22 - COMMERCIAL LAND USE DISTRICTS

[...]

D. Additional limitations for specific uses are identified in the footnotes of this table.

	OC	NC ¹	RC	GC
RESIDENTIAL				
<ul style="list-style-type: none"> Multi-Family dwelling housing, subject to the dimensional requirements of the High Density Residential (HDR) zone in 16.12.030 when located on the upper floors, in the rear of, or otherwise clearly secondary to commercial buildings. 	P	P	P	P

Chapter 16.40 - PLANNED UNIT DEVELOPMENT (PUD)*

16.40.010 - Purpose

- A. PUDs integrate buildings, land use, transportation facilities, utility systems and open space through an overall site design on a single parcel of land or multiple properties under one or more ownerships. Applicants are not required to use the PUD process in this Chapter and can instead use the clear and objective processes available through other chapters of this Code. The PUD process is intended to be an alternative option an applicant may select in lieu of the clear and objective processes in order to allow creativity and flexibility in site design and review which cannot be achieved through a strict adherence to existing zoning and subdivision standards. As such, approval of a PUD is based on discretionary standards.
- B. The PUD process is intended to achieve the following objectives:
1. Encourage efficient use of land and resources that can result in savings to the community, consumers and developers.
 2. Preserve valuable landscape, terrain and other environmental features and amenities as described in the Comprehensive Plan or through site investigations.
 3. Provide diversified and innovative living, working or neighborhood shopping environments that take into consideration community needs and activity patterns.
 4. Achieve maximum energy efficiency in land uses.
 5. Promote innovative, pedestrian-friendly, and human scale design in architecture and/or other site features that enhance the community or natural environment.

(Ord. No. 2008-015, § 1, 10-7-2008; Ord. 2001-1119, § 1; Ord. 86-851, § 3)

16.40.020 - Preliminary Development Plan

A. Generally

A PUD Preliminary Development Plan shall be submitted for the review and approval in accordance with Chapter 16.72. PUDs may be considered only:

1. On sites that are unusually constrained or limited in development potential, as compared to other land with the same underlying zoning designation, because of:
 - a. Natural features such as floodplains, wetlands, and extreme topography, or
 - b. Man-made features, such as parcel configuration and surrounding development, but not including man-made features on or resulting from other parcels owned by any owner of the property subject to the PUD application;
2. On parcels of land within an Urban Renewal District where flexibility and creativity in design may result in greater public benefit than strict adherence to the code; or
3. In other areas deemed appropriated by Council during the adoption of a concept plan required by a Metro UGB expansion.

B. Content

The Preliminary Development Plan application shall include the following documentation:

1. Existing conditions map(s) showing: All properties, existing uses, and zoning districts within three hundred (300) feet, topography at five (5) foot intervals, floodplain, significant natural vegetation and

features, private and public facilities including but not limited to utilities, streets, parks, and buildings, historic and cultural resources, property boundaries, lot lines, and lot dimensions and area.

2. Listing of all property owners adjacent to the proposed PUD as per Section 16.72.020, including names and addresses, and a listing of all persons, including names and addresses, with an interest in the property subject to the PUD application.
3. Proposal map(s) showing: Alterations to topography, floodplain, natural vegetation, trees and woodlands, and other natural features, all streets, utility alignments and easements, parks and open space, historic and cultural resources, other public and utility structures, and any other dedicated land features or structures, the parceling, lot consolidation, adjustments, or subdivision of land including basic parcel dimensions and areas, the phasing of the PUD, siting and orientation of proposed new structures, including an identification of their intended use.
4. Narrative describing: the intent of the PUD and how general PUD standards as per this Chapter are met, details of the particular uses, densities, building types and architectural controls proposed, form of ownership, occupancy and responsibility for maintenance for all uses and facilities, trees and woodlands, public facilities to be provided, specific variations from the standards of any underlying zoning district or other provisions of this Code, and a schedule of development.
5. If the PUD involves the subdivision of land, the proposal must also include a preliminary subdivision plat and meet all requirements of Chapter 16.120. The preliminary subdivision will be processed concurrently with the PUD.
6. Architectural Pattern Book: A compendium of architectural elevations, details, and colors of each building type shall be submitted with any PUD application. The designs shall conform to the site plan urban design criteria in Section 16.90.020(G) or any other applicable standards in this Code. A pattern book shall act as the architectural control for the homeowner's association or the commercial owner. An Architectural Pattern Book shall address the following:
 - a. Illustrative areas within the development application covered by the pattern book.
 - b. An explanation of how the pattern book is organized, and how it is to be used.
 - c. Define specific standards for architecture, color, texture, materials, and other design elements.
 - d. Include a measurement or checklist system to facilitate review of the development for conformity with the pattern book.
 - e. Include the following information for each building type permitted outright or conditionally proposed in the PUD:
 - (1) Massing, facades, elevations, roof forms, proportions, materials, and color palette.
 - (2) Architectural relevance or vernacular to the Pacific Northwest.
 - (3) Doors, windows, siding, and entrances, including sash and trim details.
 - (4) Porches, chimneys, light fixtures, and any other unique details, ornamentation, or accents.
 - (5) A fencing plan with details that addresses the relationship between public space and maintaining individual privacy subject to Section 16.58.020.

16.40.030 - Final Development Plan

A. Generally

Upon approval of the PUD overlay zoning district and preliminary development plan by the Council, the applicant shall prepare a detailed Final Development Plan as per this Chapter, for review and approval of the

Commission. The Final Development Plan shall comply with all conditions of approval as per Section 16.40.020. In addition, the applicant shall prepare and submit a detailed site plan for any non-single-family dwelling structure or use not addressed under Section 16.40.020(B)(6), for review and approval, pursuant to the provisions of Chapter 16.90. The site plan shall be processed concurrently with the Final Development Plan.

[...]

16.40.050 - Residential PUD

A. Permitted Uses

The following uses are permitted outright in Residential PUD when approved as part of a Final Development Plan:

1. Varied housing types, including but not limited to single family detached dwellings, duplexes, townhomes, zero-lot line housing, and multi-family dwellings.
2. Related NC uses which are designed and located so as to serve the PUD district and neighborhood.
3. All other uses permitted within the underlying zoning district in which the PUD is located.

C. Development Standards

3. Minimum Lot Size and Setbacks

The minimum lot size and setbacks shall be consistent with the provisions in the underlying zone with the exceptions listed below:

- a) Where there are multiple zones within a single PUD, lot sizes and setbacks shall meet the following:
 - 1) Lots on the perimeter boundary of the PUD shall be consistent with the underlying zone.
 - 2) All remaining lots, not on the perimeter boundary of the PUD, may utilize the provision of average lot size of the underlying zones.

Chapter 16.44 - TOWNHOMES* (Deleted per Ordinance 2022-...)

Chapter 16.52 - ACCESSORY DWELLING UNITS

16.52.010 - Purpose

An accessory dwelling unit (ADU) is a habitable living unit that provides the basic requirements for shelter, heating, cooking and sanitation. The purpose of an ADU is to provide homeowners with a means of obtaining rental income, companionship and security. ADUs provide Sherwood residents another affordable housing option and a means to live independently.

(Ord. No. 2019-003, § 2, 3-5-2019; Ord. 2000-1108, § 3)

16.52.020 - Requirements for all accessory dwelling units

All accessory dwelling units must meet the following standards:

- A. Creation: One accessory dwelling unit per single-family detached dwelling may only be created through the following methods:
 1. Converting existing living area, attic, basement or garage;
 2. Adding floor area;
 3. Constructing a detached ADU on a site with an existing house;
 4. Constructing a new house with an internal or detached ADU.
- B. Location of entrances: The entrance to a detached ADU shall not be visible from the street that the primary residence is addressed from.
- C. Parking: No off-street parking is required for an Accessory Dwelling Unit. ¹
- D. Floor area: The maximum gross habitable floor area (GHFA) of the ADU shall not exceed 800 square feet.
- E. Setbacks and dimensional requirements: The ADU shall comply with the setback and dimensional requirements of the underlying zone. A detached ADU shall only be located in the rear yard or above a detached garage.
- F. Design and appearance:
 - Height: The height of a detached ADU shall be no higher than the primary residence.

A detached and attached ADU shall meet the following standards for design and appearance.

Design and appearance standards: Detached ADUs must meet one option from each row below:

Exterior finish materials	Must be the same or visually match in type, size and placement, the exterior finish material of the primary structure	OR	Siding made from wood or composite boards. Horizontal lap siding between three (3) to eight (8) inches wide (the visible portion once installed).
Roof pitch	Predominant roof pitch must be the same as the predominant roof pitch of the primary structure	OR	Roof pitch must be at least 6/12

Trim	Must be the same in type, size, and location as the trim used on the primary structure	OR	All window trim must be at least 3 inches wide
Eaves	Same projection distance as primary structure	OR	All eaves project at least 12 inches from the building walls

¹ Per 2017 Senate Bill 1051 and 2019 House Bill 2001

Chapter 16.60 - YARD REQUIREMENTS

[...]

16.60.040 - Lot Sizes and Dimensions

- A. If a lot or parcel, or the aggregate of contiguous lots or parcels, recorded or platted prior to the effective date of this Code, has an area or dimension which does not meet the requirements of this Code, the lot or aggregate lots may be put to a use permitted outright, subject to the other requirements of the zone in which the property is located.
- B. Exceptions
 - 1. Residential uses are limited to the number of dwelling units consistent with the density requirements of the zone. However, a dwelling cannot be built on a lot with less area than thirty-two hundred (3,200) square feet, except for townhomes, and as provided in Chapter 16.68.
 - 2. Yard requirements of the underlying zone may be modified for infill developments as provided in Chapter 16.68 (Infill Development).

(Ord. No. 2015-003, § 2, 3-17-2015; Ord. No. 2011-003, § 2, 4-5-2011)

Chapter 16.64 - DUAL USE OF REQUIRED SPACE* (Deleted per Ordinance 2021-____)

Division III. - ADMINISTRATIVE PROCEDURES

Chapter 16.70 - GENERAL PROVISIONS

16.70.030 - Application Requirements

A. Form

Any request for a land use action shall be made on forms prescribed and provided by the City and shall be prepared and submitted in compliance with this Code. A land use application shall be reviewed against the standards and criteria effective at the time of application submittal. Original signatures from all owners or their legal representative must be on the application form.

B. Copies

To assist in determining the compliance of proposed land use actions with the Comprehensive Plan and provisions of this Code, applicants shall submit one (1) complete electronic copy of the full application packet, one reduced (8½ × 11) copy of the full application packet and the required number of hard copies as outlined on the applicable forms prescribed and provided by the City.

C. Content

1. In addition to the required application form, all applications for Residential Design Checklist approval must include the following:
 - a. Residential Design Checklist.
 - b. Building elevations including enough detail to confirm conformance with the design standards of Chapter 16.14.
2. In addition to the required application form, all applications for Type I approval must include the following:
 - a. Appropriate fee(s) for the requested land use action required based on the City of Sherwood Fee Schedule.
 - b. Tax Map showing property within at least 300 ft. with scale (1" = 100' or 1" = 200'), north arrow, date, and legend
 - c. Vicinity Map
3. In addition to the required application form, all applications for Type II-V land use approval must include the following:
 - a. Appropriate fee(s) for the requested land use action required based on the City of Sherwood Fee Schedule.
 - b. Documentation of neighborhood meeting per 16.70.020.
 - c. Tax Map showing property within at least 300 feet with scale (1" = 100' or 1" = 200') north point, date and legend.
 - d. Two (2) sets of mailing labels for property owners of record within 1,000 feet of the subject site, including a map of the area showing the properties to receive notice and a list of the property owners, addresses and tax lots. Ownership records shall be based on the most current available information from the Tax Assessor's office.
 - e. Vicinity Map showing a minimum radius of 500 feet around the property and the closest intersection of two Principal Arterial, Arterial, Collector or Neighborhood roads.
 - f. A narrative explaining the proposal in detail and a response to the Required Findings for Land Use Review for the land use approval(s) being sought.

- g. Two (2) copies of a current preliminary title report.
- h. Existing conditions plan drawn to scale showing: property lines and dimensions, existing structures and other improvements such as streets and utilities, existing vegetation, any floodplains or wetlands and any easements on the property.
- i. Proposed development plans sufficient for the Hearing Authority to determine compliance with the applicable standards. Checklists shall be provided by the City detailing information typically needed to adequately review specific land use actions.
- j. A traffic study, if required by other sections of this Code.
- k. Other special studies or reports that may be identified by the City Manager or his or her designee to address unique issues identified in the pre-application meeting or during project review including but not limited to:
 - 1) Wetland assessment and delineation;
 - 2) Geotechnical report;
 - 3) Traffic study;
 - 4) Verification of compliance with other agency standards such as CWS, DSL, Army Corps of Engineers, ODOT, PGE, BPA, Washington County.
- l. Plan sets must have:
 - 1) The proposed name of the development. If a proposed project name is the same as or similar to other existing projects in the City of Sherwood, the applicant may be required to modify the project name.
 - 2) The name, address and phone of the owner, developer, applicant and plan producer.
 - 3) North arrow,
 - 4) Legend,
 - 5) Date plans were prepared and date of any revisions
 - 6) Scale clearly shown. Other than architectural elevations, all plans must be drawn to an engineer scale.
 - 7) All dimensions clearly shown.
- 2. Exemptions can be made when items in 16.70.030.C.1 are not necessary in order to make a land use decision, such as for text amendments to the development code. Additional written documentation may be necessary to adequately demonstrate compliance with the criteria.

(Ord. No. 2018-007, § 2, 10-2-2018; Ord. No. 2015-003, § 2, 3-17-2015; Ord. No. 2010-015, § 2, 10-5-2010; Ord. 91-922, § 3)

Chapter 16.72 - PROCEDURES FOR PROCESSING DEVELOPMENT PERMITS

16.72.010 - Generally

A. Classifications

Except for Final Development Plans for Planned Unit Developments, which are reviewed per Section 16.40.030, all ministerial, administrative, and quasi-judicial development permit applications and legislative land use actions shall be classified as one of the following:

1. Residential Design Checklist Review

The Community Development Director, or designee, without public notice and without a public hearing, makes ministerial decisions through the Residential Design Checklist Review procedure. Ministerial decisions are those where City standards and criteria do not require the exercise of discretion (i.e., they are clear and objective standards).

The Community Development Director, or designee, reviews proposals for all residential housing types, except for multi-dwelling development that are subject to Section 16.90, requiring a clear and objective review using the Residential Design Checklist. The Residential design Checklist is a preliminary review that is intended to ensure a project proposal meets the basic requirements of Chapter 16.14 before more detailed plans are prepared and before the City authorizes the Building Official to issue a building permit.

2. Type I

The following administrative actions shall be subject to a Type I review process:

- a. Signs;
- b. Property line adjustments;
- c. Interpretation of similar uses;
- d. Temporary uses;
- e. Final subdivision and partition plats;
- f. Final site plan review;
- g. Time extensions of approval, per Sections 16.90.020; 16.124.010;
- h. Class A home occupation permits;
- i. Interpretive decisions by the city manager or his/her designee;
- j. Tree removal permit—Street trees over five inches DBH, per section 16.142.050.B.2 and 3;
- k. Adjustments;
- l. Re-platting, lot consolidations and vacations of plats;
- m. Minor modifications to approved site plans;
- n. Accessory dwelling units;
- o. Residential Design Checklist Review with Adjustment

3. Type II

The following administrative actions shall be subject to a Type II review process:

- a. Land Partitions (creation of 3 or fewer lots within 1 calendar year)
 - b. Expedited Land Divisions - The Community Development Director shall make a decision based on the information presented, and shall issue a development permit if the applicant has complied with all of the relevant requirements of the Zoning and Community Development Code. Conditions may be imposed by the Community Development Director if necessary to fulfill the requirements of the adopted Comprehensive Plan, Transportation System Plan or the Zoning and Community Development Code.
 - c. "Fast-track" Site Plan review, defined as those site plan applications which propose less than 15,000 square feet of floor area, parking or seating capacity of public, institutional, commercial or industrial use permitted by the underlying zone, or up to a total of 20% increase in floor area, parking or seating capacity for a land use or structure subject to a Conditional Use Permit, except as follows: auditoriums, theaters, stadiums, and those applications subject to Section 16.72.010.A.4.
 - d. "Design Upgraded" Site Plan review, defined as those site plan applications which propose between 15,001 and 40,000 square feet of floor area, parking or seating capacity and which propose a minimum of eighty percent (80%) of the total possible points of design criteria in the "Commercial Design Review Matrix" found in Section 16.90.020.D.6.d.
 - e. Industrial "Design Upgraded" projects, defined as those site plan applications which propose between 15,001 and 60,000 square feet of floor area, parking or seating capacity and which meet all of the criteria in Section 16.90.020.D.7.b.
 - f. Homeowner's association street tree removal and replacement program extension.
 - g. Class B Variance
 - h. Street Design Modification
 - i. Subdivisions between 4—10 lots
 - j. Medical marijuana dispensary permit
 - k. Residential Design Checklist Review with Class B Variance
4. Type III
- The following quasi-judicial actions shall be subject to a Type III review process:
- a. Conditional Uses
 - b. Site Plan Review — between 15,001 and 40,000 square feet of floor area, parking or seating capacity except those within the Old Town Overlay District, per Section 16.72.010.A.
 - c. Subdivisions between 11—50 lots.
5. Type IV
- The following quasi-judicial actions shall be subject to a Type IV review process:
- a. Site Plan review and/or "Fast Track" Site Plan review of new or existing structures in the Old Town Overlay District.
 - b. All quasi-judicial actions not otherwise assigned to a Hearing Authority under this section.
 - c. Site Plans — Greater than 40,000 square feet of floor area, parking or seating capacity.
 - d. Site Plans subject to Section 16.90.020.D.6.f.
 - e. Industrial Site Plans subject to Section 16.90.020.D.7.b.

- f. Subdivisions — over 50 lots.
- g. Class A Variance
- h. Residential Design Review

6. Type V

The following legislative actions shall be subject to a Type V review process:

- a. Plan Map Amendments
- b. Plan Text Amendments
- c. Planned Unit Development — Preliminary Development Plan and Overlay District.

B. Hearing and Appeal Authority

1. The Hearing and Appeal Authorities shall be as follows:

- a. The Residential Design Checklist review authority is the Community Development Director or their designee. The decision is final on the date it is signed by the Community Development Director. It is not a land use decision as defined by ORS 197.015, and therefore is not subject to local appeal or appeal to the state Land Use Board of Appeals (LUBA).
- b. The Type I Hearing Authority is the Community Development Director and the Appeal Authority is the Planning Commission.
 - (1) The Community Development Director's decision shall be made without public notice or public hearing. Notice of the decision shall be provided to the applicant.
 - (2) The applicant may appeal the Community Development Director's decision.
- c. The Type II Hearing Authority is the Community Development Director and the Appeal Authority is the Planning Commission.
 - (1) The Community Development Director's decision shall be made without a public hearing, but not until at least fourteen (14) days after a public notice has been mailed to the applicant and all property owners within 1,000 feet of the proposal. Any person may submit written comments to the Community Development Director which address the relevant approval criteria of the Zoning and Development Code. Such comments must be received by the Planning Department within fourteen (14) days from the date of the notice.
 - (2) Any person providing written comments may appeal the Community Development Director's decision.
- d. The Type III Hearing Authority is the Hearings Officer and the Appeal Authority is the Planning Commission.
 - (1) The Hearings Officer shall hold a public hearing following public notice in accordance with Sections 16.72.020 through 16.72.080.
 - (2) Any person who testified before the Hearings Officer at the public hearing or submitted written comments prior to the close of the record may appeal the Hearings Officer's decision.
- e. The Type IV Hearing Authority is the Planning Commission and the Appeal Authority is the City Council.
 - (1) The Planning Commission shall hold a public hearing following public notice in accordance with Sections 16.72.020 through 16.72.080.

- (2) Any person who testified before the Planning Commission at the public hearing or submitted written comments prior to the close of the record may appeal the Planning Commission's decision.
 - f. The Type V Hearing Authority is the City Council, upon recommendation from the Planning Commission and the Appeal Authority is the Land Use Board of Appeals (LUBA).
 - g. Review by Council
 - (1) Review of a decision by a Hearing Authority may be initiated by the City Council when the Council determines that:
 - a. The matter involves important issues of policy; and
 - b. The original decision likely involves errors of law or was not supported by substantial evidence.
 - (2) Review by Council must be initiated by resolution of the City Council within fourteen (14) calendar days after the date of mailing of the final written decision of the Hearing Authority. Any City Council resolution calling a decision up for review shall specify whether the City Council will review the decision called up on the record or de novo and whether it intends to limit the issues on review to certain specified issues.
 - (3) Approval of such a resolution shall stay the original decision until the decision on review has become final. No right or benefit accorded by the original decision may be exercised until the decision on review has become final.
 - (4) Review shall include a public hearing conducted by the City Council. Except as otherwise provided in this Section, the public notice and hearing procedures shall be the same as the procedures used in initially taking the action which is being reviewed.
 - (5) The City Council may act to affirm, reverse, remand, or amend the action being reviewed. The action of the City Council shall be the final City of Sherwood action on the application, unless remanded to the Hearing Authority. Upon remand, the decision of the Hearing Authority shall be the final City of Sherwood action. The decision upon Council review shall become final on the date when written notice of the decision is mailed to persons entitled to notice of the decision.
 2. Each quasi-judicial development permit application shall potentially be subject to two (2) levels of review, with the first review by a Hearing Authority and the second review, if an appeal is filed, by an Appeal Authority. The decision of the Hearing Authority shall be the City's final decision, unless an appeal is properly filed within fourteen (14) days after the date on which the Hearing Authority took final action. In the event of an appeal, the decision of the Appeal Authority shall be the City's final decision.
 3. Each Type V legislative land use action shall be reviewed at a public hearing by the Planning Commission with a recommendation made to the City Council. The City Council shall conduct a public hearing and make the City's final decision.
- C. Approval Criteria
1. The approval criteria for each development permit application shall be the approval standards and requirements for such applications as contained in this Code. Each decision made by a Hearing Authority or Appeal Authority shall list the approval criteria and indicate whether the criteria are met. It is the applicant's burden to demonstrate to the Hearing Authority and Appeal Authority how each of the approval criteria are met. An application may be approved with conditions of approval imposed by the

Hearing Authority or Appeal Authority. On appeal, the Appeal Authority may affirm, reverse, amend, refer, or remand the decision of the Hearing Authority.

2. In addition to Section 1 above, all Type IV quasi-judicial applications except Residential Design Review shall also demonstrate compliance with the Conditional use criteria of Section 16.82.020.

(Ord. No. 2019-003, § 2, 3-5-2019; Ord. No. 2015-005, § 2, 5-5-2015; Ord. No. 2015-003, § 2, 3-17-2015; Ord. No. 2011-011, § 1, 10-4-2011; Ord. No. 2011-003, § 2, 4-5-2011; Ord. No. 2011-001, §§ 1, 2, 2-15-2011; Ord. No. 2010-015, § 2, 10-5-2010; Ord. No. 2010-05, § 2, 4-6-2010; Ord. No. 2009-005, § 2, 6-2-2009; Ord. 2003-1148, § 3; 2001-1119; 99-1079; 98-1053)

Chapter 16.76 - APPEALS*

16.76.010 - Generally

[...]

16.76.020 - Appeal Deadline

Land use actions taken pursuant to this Code shall be final unless a petition for review is filed with the Community Development Director not more than fourteen (14) calendar days after the date on which the Hearing Authority took final action on the land use application, and written notice of the action has been mailed to the address provided by the person in the record. If the person did not provide a mailing address, then the appeal must be filed within fourteen (14) calendar days after the notice has been mailed to persons who did provide a mailing address.

(Ord. 2003-1148, § 3; 2001-1119; 91-922)

Division IV. - PLANNING PROCEDURES

Chapter 16.84 - VARIANCES

[...]

16.84.030 - Types of Variances

As provided in this Section, there are three types of variances: Adjustments, Class A variance and Class B variance; the type of variance required depends on the extent of the variance request and the discretion involved in the decision making process.

A. Adjustments

1. Generally and Approval Process: The following Adjustments and Residential Design Checklist with Adjustment are reviewed using a Type I procedure, as governed by Chapter 16.72, using the approval criteria in Subsection 2, below:
 - a. Front yard setbacks Up to a 10 percent change to the front yard setback standard in the land use district.
 - b. Rear yard setbacks Up to a 10 percent reduction of the dimensional standards for the rear yard setbacks required in the base land use district so long as the three foot setback is maintained based on Building Code requirements where applicable.
 - c. Interior side yard setbacks: Adjustments to interior side yard setbacks for all residential housing types are not allowed.
 - d. Landscape area Up to a 10 percent reduction in landscape area (overall area or interior parking lot landscape area).
 - e. A 5 percent increase or decrease in other Code standards or dimensions not otherwise specifically identified in this section and not applicable at the time of the subdivision or partition approval.
 - f. Up to a 5 percent adjustment to one or more of the residential design standards of Section 16.14, Table 16.14-1.A-C (no adjustments to the Detailed Design standards in 16.14, Table 16.14-1.D are permitted).
2. Approval Criteria: Adjustments subject to the provisions of this section shall be granted if the applicant demonstrates compliance with all of the following criteria:
 - a. The adjustment requested is required due to the lot configuration, or other conditions of the site;
 - b. The adjustment does not result in the removal of trees, or it is proposed in order to preserve trees, if trees are present in the development area;
 - c. The adjustment will not result in violation(s) of any other adopted ordinance or code standard; each code standard to be modified shall require a separate adjustment request.
 - d. An application for an adjustment is limited to one lot or parcel per application.
 - e. No more than three adjustments may be approved for one lot or parcel in 12 months.

B. Class B Variances

1. Generally
 - a. The Class B variance standards apply to individual platted and recorded lots only.
 - b. A variance shall not be approved that would vary the "permitted uses" or "prohibited uses" of a land use zoning district.

- c. Front yard setbacks: Up to a 20 percent change to the front yard setback standard in the land use district.
 - d. Rear yard setbacks: Up to a 20 percent reduction of the dimensional standards for the rear yard setbacks required in the base land use district so long as the three foot setback is maintained if required by the Building Code requirements.
 - e. Interior side yard setbacks: Variances to interior side yard setbacks for all residential housing types are not allowed.
 - f. A 20% or less increase or decrease in other Code standards or dimensions not otherwise specifically identified in this section.
 - g. Between 5 percent and 10 percent adjustment to one or more of the residential design standards of Section 16.14, Table 16.14-1.A-C .
2. Approval Process: Class B variances and Residential Design Checklist with Class B Variance shall be reviewed using a Type II procedure. In addition to the application requirements contained in Chapter 16.72.010, the applicant shall provide a written narrative describing the reason for the variance, why it is required, alternatives considered, and compliance with the criteria in subsection 3.
 3. Approval Criteria (subject to the provisions of this section): The City shall approve, approve with conditions, or deny an application for a Class B Variance based on the following criteria:
 - a. The variance requested is required due to the lot configuration, or other conditions of the site;
 - b. The variance does not result in the removal of trees, or it is proposed in order to preserve trees, if trees are present in the development area;
 - c. The variance will not result in violation(s) of any other adopted ordinance or code standard; each code standard to be modified shall require a separate variance request.
 - d. An application for a Class B variance is limited to three or fewer lots per application.
 - e. The variance will have minimal impact to the adjacent properties.
 - f. The variance is the minimum needed to achieve the desired result and the applicant has considered alternatives.
- C. Class A Variances
1. Generally
 - a. The Class A variance procedure may be used to modify a standard for three (3) or fewer lots, including lots yet to be created through a partition process.
 - b. An applicant who proposes to vary a standard for lots yet to be created through a subdivision process may not utilize the Class A variance procedure. Approval of a Planned Unit Development shall be required to vary a standard for lots yet to be created through a subdivision process, where a specific code section does not otherwise permit exceptions.
 - c. A Class A Variance shall not be approved that would vary the "permitted, conditional or prohibited uses" of a land use district.
 2. Approval Process:
 - a. Class A Variances shall be processed using a Type IV procedure, as governed by Chapter 16.84, using the approval criteria in subsection 3, below.
 - b. In addition to the application requirements contained in Chapter 16.72.010, the applicant shall provide a written narrative describing the reason for the variance, why it is required, alternatives considered, and compliance with the criteria in subsection 3.

3. Approval Criteria: The City shall approve, approve with conditions, or deny an application for a Class A Variance based on the following criteria:
 - a. The proposed variance will not be materially detrimental to the purposes of this Code, to any other applicable policies and standards, and to other properties in the same land use district or vicinity;
 - b. A hardship to development exists which is peculiar to the lot size or shape, topography, or other similar circumstances related to the property over which the applicant has no control, and which are not applicable to other properties in the vicinity (e.g., the same land use district);
 - c. The use proposed will be the same as permitted under this title and City standards will be maintained to the greatest extent that is reasonably possible while permitting reasonable economic use of the land;
 - d. Existing physical and natural systems, such as but not limited to traffic, drainage, natural resources, and parks will not be adversely affected any more than would occur if the development occurred as specified by the subject Code standard;
 - e. The hardship is not self-imposed; and
 - f. The variance requested is the minimum variance that would alleviate the hardship.

(Ord. No. 2015-003, § 2, 3-17-2015; Ord. No. 2011-003, § 2, 4-5-2011)

Chapter 16.88 - INTERPRETATION OF SIMILAR USES

[...]

16.88.040 - Uses

This chapter classifies land uses and activities into use categories on the basis of common functional, product, or physical characteristics. The use categories provide a systematic basis for assignment of present and future uses to zones. The decision to allow or prohibit the use categories in the various zones is based on the goals and policies of the Comprehensive Plan. Uses are assigned to the category whose description most closely describes the nature of the primary use. A primary use is the activity, or combination of activities of chief importance on the site, and the main purposes for which the land or structures are intended, designed, or ordinarily used. Accessory uses are uses or activities which are a subordinate part of a primary use and are clearly incidental to a primary use on site.

A. Residential Use Types

1. Residential uses are intended for habitation by one (1) or more individuals on a wholly or primarily non-transient basis. These uses usually include accommodations for cooking, sleeping, bathing, and similar common areas typically associated with habitation. Residential uses include, but are not limited to the following housing types:
 - (1) Single-family detached - A structure consisting of a single dwelling unit which is for occupancy by one (1) or more persons on a single parcel or lot.
 - (2) Single-family attached - A structure consisting of one (1) or more attached single dwelling unit which is for occupancy by one (1) or more persons on separate parcels or lots. Examples include but are not necessarily limited to townhomes.
 - (3) Duplex - A structure consisting of two (2) dwelling units on the same parcel or lot. Two (2) family homes are commonly referred to as a duplex.
 - (4) Multi-Family dwelling - A structure consisting of five (5) or more dwelling units on the same parcel or lot. Multi-Family-dwelling homes include, but are not limited to garden apartments, apartments, condominiums. Multi-dwellings do not include townhomes, which are located on individual lots.
 - (5) Institutional and residential care facilities — A facility licensed by or under the authority of the Department of Health and Human Services under ORS 443.400 to 443.460 which provides residential care alone or in conjunction with treatment or training or a combination thereof for six (6) to fifteen (15) individuals who need not be related. Examples include residential care homes, group homes, halfway homes, etc.

Chapter 16.89 - RESIDENTIAL DESIGN CHECKLIST AND RESIDENTIAL DESIGN REVIEW

16.89.010 – Purpose and Intent

A. Purpose

The Residential Design Checklist Review and Residential Design Review are intended to provide an opportunity for the City of Sherwood to encourage development of a variety of housing types while providing for a review process that encourages traditional forms commonly found in Sherwood while providing for a variety of design and site-specific situations for these housing types.

This process is designed to provide a streamlined review process to encourage development of housing at a variety of types and scales. The Residential Design Checklist Review is a clear and objective review process and will be implemented at time of Residential Building Permit submittal. For projects seeking additional flexibility, the Residential Design Checklist Review may be paired with either a concurrent Type I Adjustment or Type II Class B Variance process referenced in Section 16.84.030.

For residential projects seeking the highest level of flexibility, the Residential Design Review is a Type IV discretionary review. Projects subject to Residential Design Review are to be reviewed against the design guidelines rather than against the degree of departure from the standard.

B. Intent

The following standards are intended to create walkable residential neighborhoods that are visually interesting, compatible with existing development, and avoid monotony in design. Should the Residential Design Review process be applied, see the design guidelines in Table 16.14-1, Residential Design Standards for design intent for each standard.

16.89.020 – Residential Design Checklist Review or Residential Design Review Required

- A. When Required. Residential Design Checklist Review or Residential Design Review is required prior to new residential development, expansions or conversions that are subject to the design standards of 16.14, or any substantial change to a site or use and is required prior to issuance of building permits for a new residential dwelling, or for substantial alteration of an existing residential dwelling or use. Exemptions noted below.

Either a Residential Design Checklist Review or a Residential Design Review is required for the following housing types (multi-family dwellings are subject to Section 16.90 review):

1. Accessory Dwelling Unit
2. Single detached dwelling
3. Duplex
4. Townhouse

- B. Applicability. For the purposes of Section 16.89.020, the terms "substantial change" and "substantial alteration" mean any development activity as defined by this Code that generally requires a building permit and exhibits one or more of the following characteristics:

1. Construction of new residential dwelling(s).
2. The activity involves changes in the use of a structure, building, or property from a non-residential to a residential use listed above.
3. The activity involves non-conforming uses as defined in Chapter 16.48.
4. The activity is identified as an expansion or conversion per 16.14.010.C.2

C. Exemption to Residential Design Checklist Review Requirement

1. Residential accessory structure subject to Chapter 16.50.

D. Required Standards

1. For the Residential Design Checklist Review application, all of the following are to be met:
 - a. All of the design standards noted in Subsection 16.14.010, Subsection 16.14.040, and/or Chapter 16.52 Accessory Dwelling Units
 - b. For a stand-alone Accessory Dwelling Unit, the standards and criteria in 16.52.020.H shall apply
2. If the standards listed in Subsection D above cannot be met outright, there are two concurrent options with the Residential Design Checklist Review:
 - a. Adjustment. See Section 16.84.030 for a Type I Adjustment for up to 5 percent modifications of the design standards associated with Table 16.14-1, Residential Design Standards, A-C. Applying the Adjustment provision creates a concurrent review that is no longer clear and objective.
 - b. Variance. See Section 16.84.030 for a Type II Class B Variance for 5 to 10 percent modifications of the design standards associated with Table 16.14-1, Residential Design Standards, A-C. Applying the Variance provision, creates a concurrent review that is no longer clear and objective.

E. Time Limits

Residential Design Checklist approvals are void after one (1) year unless construction on the site has begun, as determined by the City. The City may extend approvals for an additional period not to exceed one (1) year, upon written request from the applicant showing adequate cause for such extension, and payment of an extension application fee as per Section 16.74.010.

16.89.030 - Residential Design Review.

As an alternative to meeting the clear and objective standards in Sections 16.89.020.A, an applicant may opt to have a design review hearing before the Planning Commission to demonstrate how the proposed development meets or exceeds the design guidelines of Section 16.14.010.B, Table 16.14-1:

- A. Intent. The intent of this Review is to provide a flexible option for projects which implement the design guidelines rather than the design standards.
- B. Approval Criteria:
 1. The proposed development demonstrates conformance with the applicable design guidelines of Section 16.14.010.B, Table 16.14-1.
 2. The proposed development meets applicable zoning district standards and standards in Division II, and all applicable provisions of Divisions V, VI, VIII and IX unless revised through the Adjustment or Variance process
 3. The proposed development can be adequately served by services conforming to the Community Development Plan, including but not limited to water, sanitary facilities, storm water, solid waste, parks and open space, public safety, electric power, and communications

C. Time Limits

Residential Design Review approvals are void after two (2) years unless construction on the site has begun, as determined by the City. The City may extend approvals for an additional period not to exceed one (1) year, upon written request from the applicant showing adequate cause for such extension, and payment of an extension application fee as per Section 16.74.010.

Division V. - COMMUNITY DESIGN

Chapter 16.90 - SITE PLANNING*

[...]

16.90.020 - Site Plan Review

A. Site Plan Review Required

Site Plan review is required prior to any substantial change to a site or use that is not subject to Residential Design Checklist or Residential Design Review, does not meet the criteria of a minor or major modification per 16.90.030, issuance of building permits for a new building or structure, or for the substantial alteration of an existing structure or use. Exemptions noted below.

Site Plan Review is required for the following development:

1. Multi-dwelling
2. Commercial
3. Industrial
4. Mixed-use

For the purposes of Section 16.90.020, the terms "substantial change" and "substantial alteration" mean any development activity as defined by this Code that generally requires a building permit and may exhibit one or more of the following characteristics:

1. The activity alters the exterior appearance of a structure, building or property and is not considered a modification.
2. The activity involves changes in the use of a structure, building, or property from residential to commercial or industrial and is not considered a modification.
3. The activity involves non-conforming uses as defined in Chapter 16.48.
4. The activity constitutes a change in a City approved plan, per Section 16.90.020 and is not considered a modification.
5. The activity is subject to site plan review by other requirements of this Code.
6. The activity increases the size of the building by more than 100% (i.e. the building more than doubles in size), regardless of whether it would be considered a major or minor modification.

B. Exemption to Site Plan Requirement

1. Single Family detached developments are exempt from Site Plan Review but are required to complete either a Residential Design Checklist or Residential Design Review per Chapter 16.89, unless otherwise noted.
2. Manufactured homes located on individual residential lots per Section 16.46.010, and including manufactured home parks.

C. Reserved

D. Required Findings

No site plan approval will be granted unless each of the following is found:

1. The proposed development meets applicable zoning district standards and design standards in Division II, and all provisions of Divisions V, VI, VIII and IX.

2. The proposed development can be adequately served by services conforming to the Community Development Plan, including but not limited to water, sanitary facilities, storm water, solid waste, parks and open space, public safety, electric power, and communications.
3. Covenants, agreements, and other specific documents are adequate, in the City's determination, to assure an acceptable method of ownership, management, and maintenance of structures, landscaping, and other on-site features.
4. The proposed development preserves significant natural features to the maximum extent feasible, including but not limited to natural drainage ways, wetlands, trees, vegetation (including but not limited to environmentally sensitive lands), scenic views, and topographical features, and conforms to the applicable provisions of Division VIII of this Code and Chapter 5 of the Community Development Code.
5. For developments that are likely to generate more than 400 average daily trips (ADTs), or at the discretion of the City Engineer, the applicant must provide adequate information, such as a traffic impact analysis (TIA) or traffic counts, to demonstrate the level of impact to the surrounding transportation system. The developer is required to mitigate for impacts attributable to the project, pursuant to TIA requirements in Section 16.106.080 and rough proportionality requirements in Section 16.106.090. The determination of impact or effect and the scope of the impact study must be coordinated with the provider of the affected transportation facility.
6. The proposed commercial, multi-family dwelling, institutional or mixed-use development is oriented to the pedestrian and bicycle, and to existing and planned transit facilities. Urban design standards include the following:
 - a. Primary, front entrances are located and oriented to the street, and have significant articulation and treatment, via facades, porticos, arcades, porches, portal, forecourt, or stoop to identify the entrance for pedestrians. Additional entrance/exit points for buildings, such as a postern, are allowed from secondary streets or parking areas.
 - b. Buildings are located adjacent to and flush to the street, subject to landscape corridor and setback standards of the underlying zone.
 - c. The architecture of buildings are oriented to the pedestrian and designed for the long term and be adaptable to other uses. Aluminum, vinyl, and T-111 siding are prohibited. Street facing elevations have windows, transparent fenestration, and divisions to break up the mass of any window. Roll up and sliding doors are acceptable. Awnings that provide a minimum 3 feet of shelter from rain are required unless other architectural elements are provided for similar protection, such as an arcade.
 - d. As an alternative to the standards in Section 16.90.020.D.6.a—c, the following Commercial Design Review Matrix may be applied to any commercial, multi-family, institutional or mixed use development (this matrix may not be utilized for developments within the Old Town Overlay). A development must propose a minimum of 60 percent of the total possible points to be eligible for exemption from the standards in Section 16.90.020.D.6.a—c. In addition, a development proposing between 15,001 and 40,000 square feet of floor area, parking or seating capacity and proposing a minimum of 80 percent of the total possible points from the matrix below may be reviewed as a Type II administrative review, per the standards of Section 16.72.010.A.2.

Chapter 16.92 - LANDSCAPING

16.92.010 - Landscaping Plan Required

All proposed developments for which site plan review is required pursuant to Section 16.90.020 shall submit a landscaping plan that meets the standards of this Chapter. All areas not occupied by structures, paved roadways, walkways, or patios shall be landscaped or maintained according to an approved site plan.

(Ord. No. 2012-008, § 2, 7-17-2012; Ord. 2006-021; Ord. 86-851, § 3)

[...]

16.92.030 - Site Area Landscaping and Perimeter Screening Standards

A. Perimeter Screening and Buffering

1. Perimeter Screening Separating Residential Zones:

A minimum six-foot high sight-obscuring wooden fence, decorative masonry wall, or evergreen screen, shall be required along property lines separating residential zones from commercial, institutional/public or industrial zones subject to the provisions of Chapter 16.48.020 (Fences, Walls and Hedges).

- a. For new uses adjacent to inventoried environmentally sensitive areas, screening requirements shall be limited to vegetation only to preserve wildlife mobility. In addition, the Review Authority may require plants and other landscaping features in locations and sizes necessary to protect the privacy of residences and buffer any adverse effects of adjoining uses.
- b. The required screening shall have breaks, where necessary, to allow pedestrian access to the site. The design of the wall or screening shall also provide breaks or openings for visual surveillance of the site and security.
- c. Evergreen hedges used to comply with this standard shall be a minimum of thirty-six (36) inches in height at maturity, and shall be of such species, number and spacing to provide the required screening within one (1) year after planting.

2. Perimeter Landscaping Buffer

- a. A minimum ten (10) foot wide landscaped strip comprised of trees, shrubs and ground cover shall be provided between off-street parking, loading, or vehicular use areas on separate, abutting, or adjacent properties.
- b. The access drives to rear lots in the residential zones (i.e. flag lot) shall be separated from abutting property(ies) by a minimum of forty-two-inch sight-obscuring fence or a forty-two-inch to an eight (8) feet high landscape hedge within a four-foot wide landscape buffer. Alternatively, where existing mature trees and vegetation are suitable, Review Authority may waive the fence/buffer in order to preserve the mature vegetation.

3. Perimeter Landscape Buffer Reduction

If the separate, abutting property to the proposed development contains an existing perimeter landscape buffer of at least five (5) feet in width, the applicant may reduce the proposed site's required perimeter landscaping up to five (5) feet maximum, if the development is not adjacent to a residential zone. For example, if the separate abutting perimeter landscaping is five (5) feet, then applicant may reduce the perimeter landscaping to five (5) feet in width on their site so there is at least five (5) feet of landscaping on each lot.

B. Parking Area Landscaping

1. Purpose

The standard is a landscape treatment that uses a combination of trees, shrubs, and ground cover to provide shade, storm water management, aesthetic benefits, and screening to soften the impacts of large expanses of pavement and vehicle movement. It is applied to landscaped areas within and around the parking lot and loading areas.

2. Applicability. The provisions of this section apply to off-street parking areas of more than four (4) parking and/or loading spaces.

3. Definitions

a. Parking Area Landscaping: Any landscaped area on the site that is not required as perimeter landscaping § 16.92.030 (Site Landscaping and Screening).

b. Canopy Factor

(1) Landscape trees are assigned a canopy factor to determine the specific number of required trees to be planted. The canopy factor is calculated based on the following formula:

$$\text{Canopy Factor} = \text{Mature Height (in feet)} \times \text{Canopy Spread (in feet)} \times \text{Growth Rate Factor} \times .01$$

(2) Growth Rate Factor: The growth rate factor is three (3) for fast-growing trees, two (2) for medium growing trees, and one (1) for slow growing trees. The growth rate of a tree is identified in the "Suggested Plant Lists for Required Landscaping Manual."

4. Required Landscaping

There shall be at least forty-five (45) square feet parking area landscaping for each parking space located on the site. The amount of required plant materials are based on the number of spaces as identified below.

5. Amount and Type of Required Parking Area Landscaping

a. Number of Trees required based on Canopy Factor

Small trees have a canopy factor of less than forty (40), medium trees have a canopy factor from forty (40) to ninety (90), and large trees have a canopy factor greater than ninety (90);

(1) Any combination of the following is required:

(i) One (1) large tree is required per four (4) parking spaces;

(ii) One (1) medium tree is required per three (3) parking spaces; or

(iii) One (1) small tree is required per two (2) parking spaces.

(iv) At least five (5) percent of the required trees must be evergreen.

(2) Street trees may be included in the calculation for the number of required trees in the parking area.

b. Shrubs:

(1) Two (2) shrubs are required per each space.

(2) For spaces where the front two (2) feet of parking spaces have been landscaped instead of paved, the standard requires one (1) shrub per space. Shrubs may be evergreen or deciduous.

c. Ground cover plants:

(1) Any remainder in the parking area must be planted with ground cover plants.

- (2) The plants selected must be spaced to cover the area within three (3) years. Mulch does not count as ground cover.

6. Individual Landscape Islands Requirements

- a. Individual landscaped areas (islands) shall be at least ninety (90) square feet in area and a minimum width of five (5) feet and shall be curbed to protect the landscaping.
- b. Each landscape island shall be planted with at least one (1) tree.
- c. Landscape islands shall be evenly spaced throughout the parking area.
- d. Landscape islands shall be distributed according to the following:
 - (1) Residential uses in a residential zone: one (1) island for every eight (8) contiguous parking spaces.
 - (2) Multi or mixed-uses, institutional and commercial uses: one (1) island for every ten (10) contiguous parking spaces.
 - (3) Industrial uses: one (1) island for every twelve (12) contiguous parking spaces.
- e. Storm water bio-swales may be used in lieu of the parking landscape areas and may be included in the calculation of the required landscaping amount.
- f. Exception to Landscape Requirement

Linear raised or marked sidewalks and walkways within the parking areas connecting the parking spaces to the on-site buildings may be included in the calculation of required site landscaping provide that it:

- (1) Trees are spaced a maximum of thirty (30) feet on at least one (1) side of the sidewalk.
- (2) The minimum unobstructed sidewalk width is at least six (6) feet wide.
- (3) The sidewalk is separated from the parking areas by curbs, bollards, or other means on both sides.

7. Landscaping at Points of Access

When a private access-way intersects a public right-of-way or when a property abuts the intersection of two (2) or more public rights-of-way, landscaping shall be planted and maintained so that minimum sight distances shall be preserved pursuant to Section 16.58.010.

8. Exceptions

- a. For properties with an environmentally sensitive area and/or trees or woodlands that merit protection per Chapters 16.142 (Parks, Trees and Open Space) and 16.144 (Wetland, Habitat and Natural Areas) the landscaping standards may be reduced, modified or "shifted" on-site where necessary in order to retain existing vegetation that would otherwise be removed to meet the above referenced landscaping requirements.
- b. The maximum reduction in required landscaping buffer permitted through this exception process shall be no more than fifty (50) percent. The resulting landscaping buffer after reduction may not be less than five (5) feet in width unless otherwise permitted by the underlying zone. Exceptions to the required landscaping may only be permitted when reviewed as part of a land use action application and do not require a separate variance permit.

C. Screening of Mechanical Equipment, Outdoor Storage, Service and Delivery Areas

All mechanical equipment, outdoor storage and manufacturing, and service and delivery areas, shall be screened from view from all public streets and any adjacent residential zones. If unfeasible to fully screen due to policies and standards, the applicant shall make efforts to minimize the visual impact of the mechanical equipment.

D. Visual Corridors

Except as allowed by subsection 6. above, new developments shall be required to establish landscaped visual corridors along Highway 99W and other arterial and collector streets, consistent with the Natural Resources and Recreation Plan Map, Appendix C of the Community Development Plan, Part II, and the provisions of Chapter 16.142(Parks, Trees, and Open Space). Properties within the Old Town Overlay are exempt from this standard.

(Ord. No. 2012-008, § 2, 7-17-2012; Ord. No. 2011-003, § 2, 4-5-2011; Ord. No. 2011-001, §§ 1, 2, 2-15-2011; Ord. No. 2010-015, § 2, 10-5-2010; Ord. 2006-021; Ord. 91-922, § 3; Ord. 86-851 § 3)

[...]

Chapter 16.94 - OFF-STREET PARKING AND LOADING

[...]

E. Location

1. Residential off-street parking spaces:
 - a. Shall be located on the same lot or development as the residential use.
 - b. Shall not include garages or enclosed buildings with the exception of a parking structure in multi-family dwelling developments where three (3) or more spaces are not individually enclosed. (Example: Underground or multi-level parking structures).
2. For other non-residential uses, required off-street parking spaces may include adjacent on-street parking spaces, nearby public parking and shared parking located within five hundred (500) feet of the use. The distance from the parking, area to the use shall be measured from the nearest parking space to a building entrance, following a sidewalk or other pedestrian route. The right to use private off-site parking must be evidenced by a recorded deed, lease, easement, or similar written notarized letter or instrument.
3. Vehicle parking is allowed only on improved parking shoulders that meet City standards for public streets, within garages, carports and other structures, or on driveways or parking lots that have been developed in conformance with this code. Specific locations and types of spaces (car pool, compact, etc.) for parking shall be indicated on submitted plans and located to the side or rear of buildings where feasible.
 - a. All new development with forty (40) employees or more shall include preferential spaces for carpool/vanpool designation. Carpool and vanpool parking spaces shall be located closer to the main employee entrance than all other parking spaces with the exception of ADA parking spaces. Carpool/vanpool spaces shall be clearly marked as reserved for carpool/vanpool only.
 - b. Existing development may redevelop portions of designated parking areas for multi-modal facilities (transit shelters, park and ride, and bicycle parking), subject to meeting all other applicable standards, including minimum space standards.

[...]

I. Parking and Loading Plan

An off-street parking and loading plan, drawn to scale, shall accompany requests for building permits or site plan approvals. A parking and loading plan is not required for all residential housing types, except for Multi-family, on residential lots in a recorded subdivision. The plan shall show but not be limited to:

1. Delineation of individual parking and loading spaces and dimensions.
2. Circulation areas necessary to serve parking and loading spaces.
3. Location of accesses to streets, alleys and properties to be served, and any curb cuts.
4. Landscaping as required by Chapter 16.92.
5. Grading and drainage facilities.
6. Signing and bumper guard specifications.
7. Bicycle parking facilities as specified in Section 16.94.020.C.
8. Parking lots more than one (1) acre in size shall provide street-like features including curbs, sidewalks, and street trees or planting strips.

[...]

16.94.020 - Off-Street Parking Standards

A. Generally

Where square feet are specified, the area measured shall be the gross building floor area primary to the functioning of the proposed use. Where employees are specified, persons counted shall be those working on the premises, including proprietors, during the largest shift at peak season. Fractional space requirements shall be counted as a whole space. The Review Authority may determine alternate off - street parking and loading requirements for a use not specifically listed in this Section based upon the requirements of comparable uses.

Table 1: Minimum and Maximum Parking Standards
 (Metro spaces are based on 1 per 1,000 sq ft of gross leasable area; ADU standards are per OAR Division 46)

	Minimum Parking Standard	Maximum Permitted Parking Zone A ¹	Maximum Permitted Parking Zone B ²
Accessory Dwelling Unit	None	None	None
Single Family detached and manufactured home on lot ³	1 per dwelling unit	None	None
Duplex	1 space per dwelling unit (total of 2 per duplex)	None	None
Townhome	1 space per unit	None	None
Multi-Family-dwelling ⁴	1 per unit under 500 sf 1.25 per 1 bdr 1.5 per 2 bdr 1.75 per 3 bdr	None	None

¹ Parking Zone A reflects the maximum number of permitted vehicle parking spaces allowed for each listed land use. Parking Zone A areas include those parcels that are located within one-quarter (¼) mile walking distance of bus transit stops, one-half (½) mile walking distance of light rail station platforms, or both, or that have a greater than twenty-minute peak hour transit service.

² Parking Zone B reflects the maximum number of permitted vehicle parking spaces allowed for each listed land use. Parking Zone B areas include those parcels that are located at a distance greater than one-quarter (¼) mile walking distance of bus transit stops, one-half (½) mile walking distance of light rail station platforms, or both.

³ If the street on which the house has direct access does not permit on-street parking or is less than twenty-eight (28) feet wide, two (2) off-street parking spaces are required per single-family-detached dwelling (includes a manufactured home on an individual lot) if the abutting street is twenty-eight (28) feet or wider, one (1) standard (9 ft. x 20 ft.) parking space is required.

⁴ Visitor parking in residential developments: Multi-Family dwelling units with more than ten (10) required parking spaces shall provide an additional fifteen (15) percent of the required number of parking spaces for the use of guests of the residents of the development. The spaces shall be centrally located or distributed throughout the development. Required bicycle parking facilities shall also be centrally located within or evenly distributed throughout the development.

B. Dimensional and General Configuration Standards

1. Dimensions For the purpose of this Chapter, a "parking space" means a stall nine (9) feet in width and twenty (20) feet in length. Up to twenty five (25) percent of required parking spaces may have a minimum dimension of eight (8) feet in width and eighteen (18) feet in length so long as they are signed as compact car stalls.

[...]

5. Credit for On-Street Parking

- a. On-Street Parking Credit. Except for residential uses, the amount of off-street parking required shall be reduced by one (1) off-street parking space for every on-street parking space adjacent to the development. On-street parking shall follow the established configuration of existing on-street parking, except that angled parking may be allowed for some streets, where permitted by City standards.
- b. The following constitutes an on-street parking space:
 - (1) Parallel parking, each twenty-four (24) feet of uninterrupted curb;
 - (2) Forty-five (45)/sixty (60) degree diagonal, each with ten (10) feet of curb;
 - (3) Ninety (90) degree (perpendicular) parking, each with eight (8) feet of curb;
 - (4) Curb space must be connected to the lot which contains the use;
 - (5) Parking spaces that would not obstruct a required clear vision area, nor any other parking that violates any law or street standard; and;
 - (6) On-street parking spaces credited for a specific use may not be used exclusively by that use, but shall be available for general public use at all times. No signs or actions limiting general public use of on-street spaces is permitted.

Chapter 16.96 - ON-SITE CIRCULATION

16.96.010 - On-Site Pedestrian and Bicycle Circulation

A. Purpose

On-site facilities shall be provided that accommodate safe and convenient pedestrian access within new subdivisions, multi-family dwelling developments, planned unit developments, shopping centers and commercial districts, and connecting to adjacent residential areas and neighborhood activity centers within one-half mile of the development. Neighborhood activity centers include but are not limited to existing or planned schools, parks, shopping areas, transit stops or employment centers. All new development, (except single-family detached housing), shall provide a continuous system of private pathways/sidewalks.

On-Site Circulation System (Multi-Family-Dwelling Example)

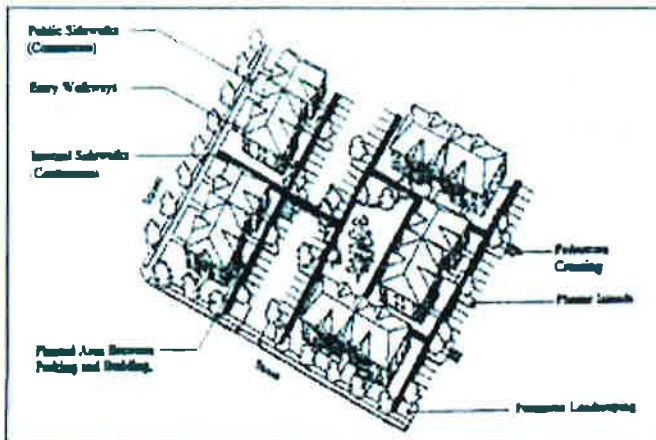
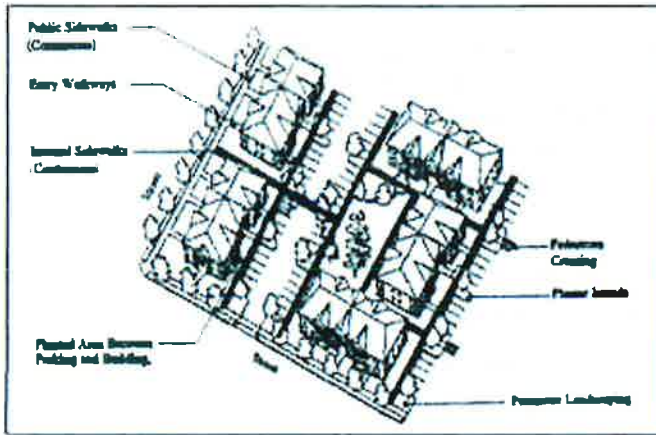

[...]

F. Access to Major Roadways

Points of ingress or egress to and from Highway 99W and arterials designated on the Transportation Plan Map, attached as Appendix C of the Community Development Plan, Part II, shall be limited as follows:

1. Single Family Detached homes, Duplex, Townhomes, and Manufactured homes on individual residential lots developed after the effective date of this Code shall not be granted permanent driveway ingress or egress from Highway 99W and arterial roadways. If alternative public access is not available at the time

of development, provisions shall be made for temporary access which shall be discontinued upon the availability of alternative access.

2. Other private ingress or egress from Highway 99W and arterial roadways shall be minimized. Where alternatives to Highway 99W or arterials exist or are proposed, any new or altered uses developed after the effective date of this Code shall be required to use the alternative ingress and egress.
3. All site plans or Residential Design Checklists for new development submitted to the City for approval after the effective date of this Code shall show ingress and egress from existing or planned local or collector streets, consistent with the Transportation Plan Map and Section VI of the Community Development Plan.

G. Service Drives

Service drives shall be provided pursuant to Section 16.94.030.

(Ord. No. 2012-008, § 2, 7-17-2012; Ord. No. 2010-015, § 2, 10-5-2010; Ord. 2006-021; Ord. 2005-009, § 6; Ord. 86-851)

16.96.020 Minimum - Residential standards

Minimum standards for private, on-site circulation improvements in residential developments:

A. Driveways

1. ADU/Single-Family-Detached: One (1) driveway improved with hard surface pavement with a minimum width of ten (10) feet, not to exceed a grade of 14%.
2. Duplex: One (1) shared driveway improved with hard surface pavement with a minimum width of twenty (20) feet; or two (2) driveways improved with hard surface pavement with a minimum width of ten (10) feet each.
3. Townhome: A maximum of one (1) driveway per unit improved with hard surface pavement with a minimum width of ten (10) feet. See also the provisions of 16.14.020.D.
4. Multi-Family-Dwelling: Improved hard surface driveways are required as follows:

Number of Units	Number of Driveways	One Way Drive Width (Pair)	Two Way Drive Width
5—49	1	15 feet	24 feet
50 or more	2	15 feet	24 feet

5. Permeable surfaces and planting strips between driveway ramps are encouraged in order to reduce stormwater runoff.

B. Sidewalks, Pathways and Curbs

1. Single Family Detached, Duplex, Townhome, and Manufactured Home on Individual Residential Lot: on-site sidewalks and curbs are not required when part of a proposed partition or subdivision.
2. Multi-Family-Dwelling:
 - a. A system of private pedestrian sidewalks/pathways extending throughout the development site shall connect each dwelling unit to vehicular parking areas, common open space, storage areas, recreation facilities, adjacent developments, transit facilities within five hundred (500) feet of the

site, and future phases of development. Main building entrances shall also be connected to one another.

- b. Required private pathways/sidewalks shall extend from the ground floor entrances or the ground floor landing of stairs, ramps or elevators, on one (1) side of approved driveways connecting to the public sidewalk or curb of the public street that provides required ingress and egress. Curbs shall also be required at a standard approved by the Review Authority.
- c. Private Pathway/Sidewalk Design. Private pathway surfaces shall be concrete, brick/masonry pavers, or other durable surface, at least five (5) feet wide and conform to ADA standards. Where the system crosses a parking area, driveway or street, it shall be clearly marked with contrasting paving materials or raised crosswalk (hump).
- d. Exceptions Private pathways/sidewalks shall not be required where physical or topographic conditions make a connection impracticable, where buildings or other existing development on adjacent lands physically preclude a connection now or in the future considering the potential for redevelopment; or pathways would violate provisions of leases, restrictions or other agreements.

(Ord. No. 2012-008, § 2, 7-17-2012; Ord. No. 2010-015, § 2, 10-5-2010; Ord. 2006-021; Ord. 2005-009, §§ 5, 8; 91-922)

Chapter 16.100 - PERMANENT SIGNS

[...]

16.100.015 Sign - Related definitions

- L. **Permanent Residential Development Sign:** Any permanent sign erected within 100-feet of any entrance to a residential subdivision or Planned Unit Development (PUD).

[...]

16.100.030 - Sign Regulations by Zone

A. Residential Zones

No permanent sign requiring a permit shall be allowed in residential zones except for the following:

1. Public/Semi-Public Uses

For churches, schools and other public uses located within a residential or institutional public zone:

- a. One (1) wall sign not exceeding thirty-six (36) square feet shall be permitted on a maximum of two (2) building elevations. Wall signs must be attached flat against the building face.
- b. One (1) free-standing sign per street frontage not exceeding thirty-six (36) square feet per sign face shall be permitted. A minimum setback of fifteen (15) feet from property lines adjacent to public streets is required. The maximum height of any portion of a free-standing sign shall be limited to six (6) feet from ground level at its base.

2. Multi-Family-Dwelling Development Signs

- a. One (1) non-illuminated free-standing sign per street frontage not exceeding thirty-six (36) square feet per sign face shall be permitted, the maximum height of any portion of a free-standing sign shall be limited to six (6) feet from ground level at its base.

3. Non-Residential Signs

- a. One (1) monument sign not more than sixteen (16) square feet in area identifying a permitted use in a residential zone shall be allowed.

[...]

Division VI. - PUBLIC INFRASTRUCTURE

Chapter 16.106 - TRANSPORTATION FACILITIES

16.106.040 - Design

[...]

M. Vehicular Access Management

[...]

2. Roadway Access

No use will be permitted to have direct access to a street or road except as specified below. Access spacing shall be measured from existing or approved accesses on either side of a street or road. The lowest functional classification street available to the legal lot, including alleys within a public easement, shall take precedence for new access points.

[...]

b. Neighborhood Routes:

Minimum spacing between driveways (Point "C" to Point "C") shall be fifty (50) feet with the exception of single family detached dwellings, duplex, and townhomes on residential lots in a recorded subdivision. Such lots shall not be subject to a minimum spacing requirement between driveways (Point "C" to Point "C"). In all instances, access points near an intersection with a Neighborhood Route, Collector or Arterial shall be located beyond the influence of standing queues of the intersection in accordance with AASHTO standards. This requirement may result in access spacing greater than fifty (50) feet.

[...]

d. Arterials and Highway 99W - Points of ingress or egress to and from Highway 99W and arterials designated on the Transportation Plan Map, attached as Figure 1 of the Community Development Plan, Part II, shall be limited as follows:

- (1) Single family-detached dwellings, duplex, townhomes, and manufactured homes on individual residential lots developed after the effective date of this Code shall not be granted permanent driveway ingress or egress from Highway 99W or arterials. If alternative public access is not available at the time of development, provisions shall be made for temporary access which shall be discontinued upon the availability of alternative access.
- (2) Other private ingress or egress from Highway 99W and arterial roadways shall be minimized. Where alternatives to Highway 99W or arterials exist or are proposed, any new or altered uses developed after the effective date of this Code shall be required to use the alternative ingress and egress. Alternatives include shared or crossover access agreement between properties, consolidated access points, or frontage or backage roads. When alternatives do not exist, access shall comply with the following standards:
 - (a) Access to Highway 99W shall be consistent with ODOT standards and policies per OAR 734, Division 51, as follows: Direct access to an arterial or principal arterial will be permitted provided that Point 'A' of such access is more than six hundred (600) feet from any intersection Point 'A' or other access to that arterial (Point 'C').
 - (b) The access to Highway 99W will be considered temporary until an alternative access to public right-of-ways is created. When the alternative access is available the temporary access to Highway 99W shall be closed.

- (3) All site plans or Residential Design Checklists for new development submitted to the City for approval after the effective date of this Code shall show ingress and egress from existing or planned local, neighborhood route or collector streets, including frontage or backage roads, consistent with the Transportation Plan Map and Chapter 6 of the Community Development Plan.

[...]

**Division VII. - LAND DIVISIONS, SUBDIVISIONS, PARTITIONS, LOT LINE
ADJUSTMENTS AND MODIFICATIONS**

Chapter 16.120 - SUBDIVISIONS^[51]

[...]

16.120.040 - Approval Criteria: Preliminary Plat

No preliminary plat shall be approved unless:

- A. Streets and roads conform to plats approved for adjoining properties as to widths, alignments, grades, and other standards, unless the City determines that the public interest is served by modifying streets or road patterns.
- B. Streets and roads held for private use are clearly indicated on the plat and all reservations or restrictions relating to such private roads and streets are set forth thereon.
- C. The plat complies with applicable zoning district standards and design standards in Division II, and all provisions of Divisions IV, VI, VIII and IX. The subdivision complies with Chapter 16.128 (Land Division Design Standards).
- D. Adequate water, sanitary sewer, and other public facilities exist to support the use of land proposed in the plat.
- E. Development of additional, contiguous property under the same ownership can be accomplished in accordance with this Code.
- F. Adjoining land can either be developed independently or is provided access that will allow development in accordance with this Code.
- G. Tree and woodland inventories have been submitted and approved as per Section 16.142.060.
- H. The plat clearly shows the proposed lot numbers, setbacks, dedications and easements.
- i. A minimum of five percent (5%) open space has been provided per Section 16.142.030 (Parks, Open Spaces and Trees-Single-Family Residential Subdivisions), if applicable.

(Ord. No. 2015-003, § 2, 3-17-2015; Ord. No. 2011-011, § 1, 10-4-2011)

Division VIII. - ENVIRONMENTAL RESOURCES

Chapter 16.142 - PARKS, TREES AND OPEN SPACES

[...]

16.142.020 - Multi-Family-Dwelling Developments

A. Standards

Except as otherwise provided, recreation and open space areas shall be provided in new multi-family dwelling residential developments to the following standards:

1. Open Space

A minimum of twenty percent (20%) of the site area shall be retained in common open space. Required yard parking or maneuvering areas may not be substituted for open space.

2. Recreation Facilities

A minimum of fifty percent (50%) of the required common open space shall be suitable for active recreational use. Recreational spaces shall be planted in grass or otherwise suitably improved. A minimum area of eight-hundred (800) square feet and a minimum width of fifteen (15) feet shall be provided.

3. Minimum Standards

Common open space and recreation areas and facilities shall be clearly shown on site development plans and shall be physically situated so as to be readily accessible to and usable by all residents of the development.

4. Terms of Conveyance

Rights and responsibilities attached to common open space and recreation areas and facilities shall be clearly specified in a legally binding document which leases or conveys title, including beneficial ownership to a home association, or other legal entity. The terms of such lease or other instrument of conveyance must include provisions suitable to the City for guaranteeing the continued use of such land and facilities for its intended purpose; continuity of property maintenance; and, when appropriate, the availability of funds required for such maintenance and adequate insurance protection.

(Ord. No. 2011-009, § 2, 7-19-2011; Ord. No. 2010-015, § 2, 10-5-2010; Ord. 91-922, § 3)

16.142.030 – All Residential Subdivisions

A. A minimum of five percent (5%) of the net buildable site (after exclusion of public right-of-way and environmentally constrained areas) shall be maintained as "open space". Open space must include usable areas such as public parks, swimming and wading pools, grass areas for picnics and recreational play, walking paths, and other like space. The following may not be used to calculate open space:

1. Required yards or setbacks.
2. Required visual corridors.
3. Required sensitive areas and buffers.
4. Any area required to meet a standard found elsewhere in this code.

B. Enhanced streetscapes such as "boulevard treatments" in excess of the minimum public street requirements may count toward a maximum of 10,000 square feet of the open space requirement.

1. Example: if a 52-foot-wide right-of-way [ROW] is required for a 1,000 foot-long street and a 62-foot wide ROW with 5-foot additional plantings/meandering pathway is provided on each side of the street, the additional 10-foot-wide area x 1,000 linear feet, or 10,000 square feet, counts toward the open space requirement.
- C. The open space shall be conveyed in accordance with one of the following methods:
1. By dedication to the City as public open space (if acceptable to the City). Open space proposed for dedication to the City must be acceptable to the City Manager or the Manager's designee with regard to the size, shape, location, improvement, environmental condition, and budgetary and maintenance abilities;
 2. By leasing or conveying title (including beneficial ownership) to a corporation, homeowners' association or other legal entity, with the City retaining the development rights to the open space. The terms of such lease or other instrument of conveyance must include provisions (e.g., maintenance, property tax payment, etc.) suitable to the City.
- D. The density of a residential subdivision shall be calculated based on the net buildable site prior to exclusion of open space per this Section.
1. Example: a 40,000 square foot net buildable site would be required to maintain 2,000 square feet (5%) of open space but would calculate density based on 40,000 square feet.
- E. If a proposed residential subdivision contains or is adjacent to a site identified as "parks" on the Acquisition Map of the Parks Master Plan (2006) or has been identified for acquisition by the Sherwood Parks and Recreation Board, establishment of open space shall occur in the designated areas if the subdivision contains the park site, or immediately adjacent to the parks site if the subdivision is adjacent to it.
- F. If the proposed residential subdivision does not contain or is not adjacent to a site identified on the Parks Master Plan map or otherwise identified for acquisition by the Parks and Recreation Board, the applicant may elect to convey off-site park/open space.
- G. This standard does not apply to a residential partition provided that a development may not use phasing or series partitions to avoid the minimum open space requirement. A partition of land that was part of an approved partition within the previous five (5) years shall be required to provide the minimum five percent (5%) open space in accordance with subsection (A) above.
- H. The value of the open space conveyed under Subsection (A) above may be eligible for Parks System Development Charges (SDCs) credits based on the methodology identified in the most current Parks and Recreation System Development Charges Methodology Report.

[...]

D. Required Yard

Visual corridors may be established in required yards, except that where the required visual corridor width exceeds the required yard width, the visual corridor requirement shall take precedence. In no case shall buildings be sited within the required visual corridor.

[...]

16.142.070 - Trees on Property Subject to Certain Land Use Applications

A. Generally

The purpose of this Section is to establish processes and standards which will minimize cutting or destruction of trees and woodlands within the City. This Section is intended to help protect the scenic beauty of the City; to retain a livable environment through the beneficial effect of trees on air pollution, heat and glare, sound, water quality, and surface water and erosion control; to encourage the retention and planting of tree species native to the Willamette Valley and Western Oregon; to provide an attractive visual contrast to the urban environment, and to sustain a wide variety and distribution of viable trees and woodlands in the community over time.

B. Applicability

All applications including a Type II - IV land use review, shall be required to preserve trees or woodlands, as defined by this Section to the maximum extent feasible within the context of the proposed land use plan and relative to other codes, policies, and standards of the City Comprehensive Plan.

[...]

D. Retention requirements

1. Trees may be considered for removal to accommodate the development including buildings, parking, walkways, grading etc., provided the development satisfies of D.2 or D.3, below.
2. Required Tree Canopy – All Residential Developments subject to Type II-V land use review.

Each net development site shall provide a variety of trees to achieve a minimum total tree canopy of 40 percent. The canopy percentage is based on the expected mature canopy of each tree by using the equation πr^2 to calculate the expected square footage of canopy for each tree. The expected mature canopy is counted for each tree regardless of an overlap of multiple tree canopies.

The canopy requirement can be achieved by retaining existing trees or planting new trees. Required street trees can be used toward the total on site canopy required to meet this standard. The expected mature canopy spread of the new trees will be counted toward the needed canopy cover. A certified arborist or other qualified professional shall provide the estimated tree canopy of the proposed trees to the planning department for review.

3. Required Tree Canopy - Non-Residential and Multi-Family Dwelling Developments

Each net development site shall provide a variety of trees to achieve a minimum total tree canopy of 30 percent. The canopy percentage is based on the expected mature canopy of each tree by using the equation πr^2 to calculate the expected square footage of each tree. The expected mature canopy is counted for each tree even if there is an overlap of multiple tree canopies.

The canopy requirement can be achieved by retaining existing trees or planting new trees. Required landscaping trees can be used toward the total on site canopy required to meet this standard. The expected mature canopy spread of the new trees will be counted toward the required canopy cover. A certified arborist or other qualified professional shall provide an estimated tree canopy for all proposed trees to the planning department for review as a part of the land use review process.

	Residential (single family detached & duplex developments) subject to Residential Design Checklist or Type I review	Residential (single family detached & duplex developments) subject to Type II-IV review	Old Town & Infill developments	Commercial, Industrial, Institutional Public and Multi-Family dwelling
--	---	---	--------------------------------	--

Canopy Requirement	N/A	40%	N/A	30%
Counted Toward the Canopy Requirement				
Street trees included in canopy requirement	N/A	Yes	N/A	No
Landscaping requirements included in canopy requirement	N/A	N/A	N/A	Yes
Existing trees onsite	N/A	Yes x2	N/A	Yes x2
Planting new trees onsite	N/A	Yes	N/A	Yes
<p>Mature Canopy in Square Feet Equation πr^2 or $(3.14159 * \text{radius}^2)$ (This is the calculation to measure the square footage of a circle. The Mature Canopy is given in diameter. In gardening and horticulture reference books, therefore to get the radius you must divide the diameter in half.</p>				
<p>Canopy Calculation Example: Pin Oak Mature canopy = 35' $(3.14159 * 17.5^2) = 962$ square feet</p>				

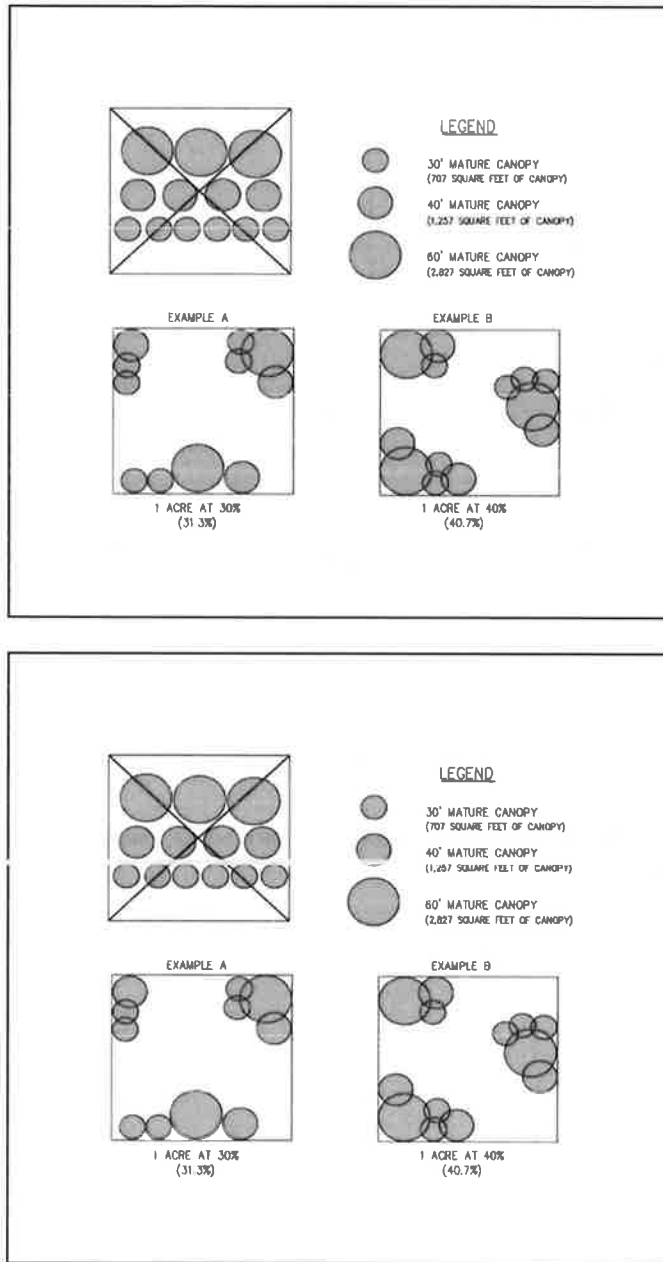

4. The City may determine that, regardless of D.1 through D.3, that certain trees or woodlands may be required to be retained. The basis for such a decision shall include; specific findings that retention of said trees or woodlands furthers the purposes and goals of this Section, is feasible and practical both within the context of the proposed land use plan and relative to other policies and standards of the City Comprehensive Plan, and are:
 - a. Within a Significant Natural Area, 100-year floodplain, City greenway, jurisdictional wetland or other existing or future public park or natural area designated by the City Comprehensive Plan, or

- b. A landscape or natural feature as per applicable policies of the City Comprehensive Plan, or are necessary to keep other identified trees or woodlands on or near the site from being damaged or destroyed due to windfall, erosion, disease or other natural processes, or
 - c. Necessary for soil stability and the control of erosion, for managing and preserving surface or groundwater quantities or quality, or for the maintenance of a natural drainageway, as per Clean Water Services stormwater management plans and standards of the City Comprehensive Plan, or
 - d. Necessary in required buffers between otherwise incompatible land uses, or from natural areas, wetlands and greenways, or
 - e. Otherwise merit retention because of unusual size, size of the tree stand, historic association or species type, habitat or wildlife preservation considerations, or some combination thereof, as determined by the City.
5. Tree retention requirements for properties located within the Old Town Overlay or projects subject to the infill standards of Chapter 16.68 are only subject to retention requirements identified in D.4. above.
 6. The Notice of Decision issued for the land use applications subject to this Section shall indicate which trees and woodlands will be retained as per subsection D of this Section, which may be removed or shall be retained as per subsection D of this Section and any limitations or conditions attached thereto.
 7. All trees, woodlands, and vegetation located on any private property accepted for dedication to the City for public parks and open space, greenways, Significant Natural Areas, wetlands, floodplains, or for storm water management or for other purposes, as a condition of a land use approval, shall be retained outright, irrespective of size, species, condition or other factors. Removal of any such trees, woodlands, and vegetation prior to actual dedication of the property to the City shall be cause for reconsideration of the land use plan approval.

E. Tree Preservation Incentive

Retention of existing native trees on site which are in good health can be used to achieve the required mature canopy requirement of the development. The expected mature canopy can be calculated twice for existing trees. For example, if one existing tree with an expected mature canopy of 10 feet (78.5 square feet) is retained it will count as twice the existing canopy (157 square feet).

F. Additional Preservation Incentives

1. General Provisions. To assist in the preservation of trees, the City may apply one or more of the following flexible standards as part of the land use review approval. To the extent that the standards in this section conflict with the standards in other sections of this Title, the standards in this section shall apply except in cases where the City determines there would be an unreasonable risk to public health, safety, or welfare. Flexibility shall be requested by the applicant with justification provided within the tree preservation and protection report as part of the land use review process and is only applicable to trees that are eligible for credit towards the effective tree canopy cover of the site. A separate adjustment application as outlined in Section 16.84.030.A is not required.
2. Flexible Development Standards. The following flexible standards are available to applicants in order to preserve trees on a development site. These standards cannot be combined with any other reductions authorized by this code.
 - a. Lot size averaging. To preserve existing trees in the development plan for any Land Division under Division VII, lot size may be averaged to allow lots less than the minimum lot size required in the underlying zone as long as the average lot area is not less than that allowed by the underlying zone. No lot area shall be less than 80 percent of the minimum lot size allowed in the zone;
 - b. Setbacks. The following setback reductions will be allowed for lots preserving existing trees using the criteria in subsection (1) below. The following reductions shall be limited to the minimum reduction necessary to protect the tree.

(1) Reductions allowed:

- (a.) Front yard - up to a 25 percent reduction of the dimensional standard for a front yard setback required in the base zone. Setback of garages may not be reduced by this provision.
- (b.) Interior setbacks - up to a 40 percent reduction of the dimensional standards for an interior side and/or rear yard setback required in the base zone.
- (c.) Perimeter side and rear yard setbacks shall not be reduced through this provision.

c. Approval criteria:

- (1.) A demonstration that the reduction requested is the least required to preserve trees; and
 - (2.) The reduction will result in the preservation of tree canopy on the lot with the modified setbacks; and
 - (3.) The reduction will not impede adequate emergency access to the site and structure.
3. Sidewalks. Location of a public sidewalk may be flexible in order to preserve existing trees or to plant new large stature street trees. This flexibility may be accomplished through a curb-tight sidewalk or a meandering public sidewalk easement recorded over private property and shall be reviewed on a case by case basis in accordance with the provisions of the Engineering Design Manual, Street and Utility Improvement Standards. For preservation, this flexibility shall be the minimum required to achieve the desired effect. For planting, preference shall be given to retaining the planter strip and separation between the curb and sidewalk wherever practicable. If a preserved tree is to be utilized as a street tree, it must meet the criteria found in the Street Tree section, 16.142.060.
4. Adjustments to Commercial and Industrial development Standards. [...]

G. Tree Protection During Development

The applicant shall prepare and submit a final Tree and Woodland Plan prior to issuance of any construction permits, illustrating how identified trees and woodlands will be retained, removed or protected as per the Notice of Decision. Such plan shall specify how trees and woodlands will be protected from damage or destruction by construction activities, including protective fencing, selective pruning and root treatments, excavation techniques, temporary drainage systems, and like methods. At a minimum, trees to be protected shall have the area within the drip line of the tree protected from grading, stockpiling, and all other construction related activity unless specifically reviewed and recommended by a certified arborist or other qualified professional. Any work within the dripline of the tree shall be supervised by the project arborist or other qualified professional onsite during construction.

H. Penalties

Violations of this Section shall be subject to the penalties defined by Section 16.02.040, provided that each designated tree or woodland unlawfully removed or cut shall be deemed a separate offense.

(Ord. No. 2012-003, § 2, 5-1-2012; Ord. No. 2011-009, § 2, 7-19-2011; Ord. 2006-021; Ord. 91-922, § 3)

16.142.080 - Trees on Private Property — not subject to a land use action

A. Generally

In general, existing mature trees on private property shall be retained unless determined to be a hazard to life or property. For the purposes of this section only, existing mature trees shall be considered any deciduous tree greater than ten (10) inches diameter at the breast height (dbh) or any coniferous tree greater than twenty (20) inches dbh.

B. Residential (Single Family Detached and Duplex) Standards

In the event a property owner determines it necessary to remove existing mature trees on their property that are not a hazard, they may remove the trees as described below;

1. Removal of up to five (5) trees, or up to 10 percent of the number of trees on site, whichever is greater, within a twelve month period. No review or approval required provided that trees are not located within a wetland, floodplain or protected through prior land use review per section 3.b. (1.) - (5.) below, that the planning department is notified in writing 48 hours prior to removing the tree, including the property address, property owner name and contact information, and provided with the type and size of the tree. Failure to notify the Planning Department shall not result in a violation of this code unless it is determined that the tree removal is located within a wetland, floodplain or protected through prior land use review per section 3.b. (1.) - (5.) below, or in excess of that permitted outright.
2. Removal of six (6) or more trees, or more than 10 percent of the number of trees on site, whichever is greater, within a twelve month period except as allowed in subsection 1, above.
 - a. The applicant shall submit the following;
 - (1.) A narrative describing the need to remove the tree(s),
 - (2.) A statement describing when and how the Homeowner's Association (HOA) was informed of the proposed tree cutting and their response. If there is not an active HOA, the applicant shall submit as statement indicating that there is not a HOA to contact.
 - (3.) A plan showing the location of the tree and
 - (4.) The applicant shall submit a replacement tree plan. Half of the number of trees removed shall be replaced on site with native trees within six months from the date of removal.
3. The City may determine that, regardless of B.1 through B.2, that certain trees or stands of trees may be required to be retained.
 - a. If removal is proposed within a wetland, floodplain or protected through prior land use review per section 3.b. (1.) - (5.) below, the applicant shall submit documentation from a licensed qualified professional in natural resources management such as a wetland scientist, a botanist, or biologist, discussing the proposed tree removal and how it would or would not compromise the integrity of the resource. It shall also discuss the feasibility and practicality of tree removal relative to policies and standards of the City Comprehensive Plan, listed in section 3.b. below.
 - b. The basis for such a City decision shall include; specific findings that retention of said trees or woodlands furthers the purposes and goals of this Section, is feasible and practical relative to other policies and standards of the City Comprehensive Plan, and are:
 - (1.) Within a Significant Natural Area, 100-year floodplain, City greenway, jurisdictional wetland or other existing or future public park or natural area designated by the City Comprehensive Plan, or
 - (2.) A landscape or natural feature as per applicable policies of the City Comprehensive Plan, or are necessary to keep other identified trees or woodlands on or near the site from being damaged or destroyed due to windfall, erosion, disease or other natural processes, or
 - (3.) Necessary for soil stability and the control of erosion, for managing and preserving surface or groundwater quantities or quality, or for the maintenance of a natural drainageway, as per Clean Water Services stormwater management plans and standards of the City Comprehensive Plan, or
 - (4.) Necessary in required buffers between otherwise incompatible land uses, or from natural areas, wetlands and greenways, or

- (5.) Otherwise merit retention because of unusual size, size of the tree stand, historic association or species type, habitat or wildlife preservation considerations, or some combination thereof, as determined by the City.

C. Non-Residential and Multi-family-dwelling Standards

In the event a property owner determines it necessary to remove existing mature trees on their property that are not a hazard, they may remove the trees as described below;

1. Trees required by a land use decision after the effective date of this code can be removed. Any trees removed shall be replaced within six months of removing the tree with an appropriate tree for the area.
2. Trees that were not required by land use or planted prior to the effective date of this code can be removed after receiving approval from the City of Sherwood.
 - a. Removal of up to 25 percent of the trees on site can be removed and replaced through a Type I review process. The applicant shall submit the following;
 - (1.) A narrative describing the need to remove the trees,
 - (2.) A plan showing the location of the trees and
 - (3.) A replacement tree plan. One-half (1/2) of the number of trees removed shall be replaced. The replacement shall take place on site with similar trees within six months from the date of removal.
 - (4.) Exemption to replacement. If less than one-half (1/2) of the trees removed will be replanted due to site crowding and constraints precluding the healthy growth of additional trees, a report from a qualified professional shall describe the site specific crowding or constraints, and provide a report to the City requesting the exemption in order to be exempt from replacing the removed trees.
 - b. Removal of more than 25 percent of the trees on site can be removed and replaced through a type II review process. The applicant shall submit the following;
 - (1.) An arborists report describing the need to remove the trees. The cause for removal must be necessitated by the trees,
 - (2.) A plan showing the location of the tree and
 - (3.) A replacement tree plan. Two-thirds of the number of trees removed shall be replaced on site with similar trees within six months from the date of removal.
 - (4.) Exemption to replacement. If less than one-half (½) of the trees removed will be replanted due to site crowding and constraints precluding the healthy growth of additional trees, a report from a qualified professional shall describe the site specific crowding or constraints, and provide a report to the City requesting the exemption in order to be exempt from replacing the removed trees.
3. The City may determine that, regardless of C.1 through C.2, that certain trees or stands of trees may be required to be retained.
 - a. The applicant shall submit documentation from a licensed qualified professional in natural resources management such as wetland scientist, botanist or biologist, discussing the proposed tree removal within the context of the proposed land use plan and relative to other policies and standards of the City Comprehensive Plan, listed in section 3.b. below.
 - b. The basis for such a City decision shall include; specific findings that retention of said trees or woodlands furthers the purposes and goals of this Section, is feasible and practical both within the context of the proposed land use plan and relative to other policies and standards of the City Comprehensive Plan, and are:

- (1.) Within a Significant Natural Area, 100-year floodplain, City greenway, jurisdictional wetland or other existing or future public park or natural area designated by the City Comprehensive Plan, or
- (2.) A landscape or natural feature as per applicable policies of the City Comprehensive Plan, or are necessary to keep other identified trees or woodlands on or near the site from being damaged or destroyed due to windfall, erosion, disease or other natural processes, or
- (3.) Necessary for soil stability and the control of erosion, for managing and preserving surface or groundwater quantities or quality, or for the maintenance of a natural drainageway, as per Clean Water Services stormwater management plans and standards of the City Comprehensive Plan, or
- (4.) Necessary in required buffers between otherwise incompatible land uses, or from natural areas, wetlands and greenways, or
- (5.) Otherwise merit retention because of unusual size, size of the tree stand, historic association or species type, habitat or wildlife preservation considerations, or some combination thereof, as determined.

(Ord. No. 2012-003, § 2, 5-1-2012; Ord. No. 2011-009, § 2, 7-19-2011; Ord. No. 2011-001, §§ 1, 2, 2-15-2011; Ord. No. 2010-015, § 2, 10-5-2010)

Chapter 16.156 - ENERGY CONSERVATION*

Sections:

16.156.010 - Purpose

This Chapter and applicable portions of Chapter 5 of the Community Development Plan provide for natural heating and cooling opportunities in new development. The requirements of this Chapter shall not result in development exceeding allowable densities or lot coverage, or the destruction of existing trees.

(Ord. 91-922, § 3)

16.156.020 – Applicability

The standards in this Chapter shall apply to any new uses or changes to existing uses in multi-dwelling, commercial, industrial and institutional zones. The standards in this Chapter do not apply to accessory dwelling unit or single detached development in residential zones.

16.156.030 - Standards

- A. Building Orientation - The maximum number of buildings feasible shall receive sunlight sufficient for using solar energy systems for space, water or industrial process heating or cooling. Buildings and vegetation shall be sited with respect to each other and the topography of the site so that unobstructed sunlight reaches the south wall of the greatest possible number of buildings between the hours of 9:00 AM and 3:00 PM, Pacific Standard Time on December 21st.
- B. Wind - The cooling effects of prevailing summer breezes and shading vegetation shall be accounted for in site design. The extent solar access to adjacent sites is not impaired vegetation shall be used to moderate prevailing winter wind on the site.

(Ord. 91-922, § 3)

16.156.040 - Variance to Permit Solar Access

Variances from zoning district standards relating to height, setback and yard requirements approved as per Chapter 16.84 may be granted by the Commission through a Type IV review where necessary for the proper functioning of solar energy systems, or to otherwise preserve solar access on a site or to an adjacent site.

(Ord. 91-922, § 3)

Division IX. - HISTORIC RESOURCES

Chapter 16.162 - OLD TOWN (OT) OVERLAY DISTRICT*

[...]

16.162.030 - Permitted Uses

The following uses are permitted outright, provided such uses meet the applicable environmental performance standards contained in Division VIII:

- A. Uses permitted outright in the RC zone, Section 16.28.020; the HDR zone, Section 16.20.020; and the MDRL zone, Section 16.16.020; provided that uses permitted outright on any given property are limited to those permitted in the underlying zoning district, unless otherwise specified by this Section and Section 16.162.040.

(Ord. 2006-009 § 2)

- B. In addition to the home occupations permitted under Section 16.42.020, antique and curio shops, cabinet making, arts and crafts galleries, artists cooperatives, and bookshops, are permitted subject to the standards of Chapter 16.42 and this Chapter, in either the underlying RC or MDRL zones.
- C. Boarding and rooming houses, bed and breakfast inns, and similar accommodations, containing not more than five (5) guest rooms, in the underlying RC, HDR and MDRL zones.
- D. Motels and hotels, in the underlying RC zone only.
- E. Residential apartments when located on upper or basement floors, to the rear of, or otherwise clearly secondary to commercial buildings, in the underlying RC zone only.
- F. Other similar commercial uses or similar home occupations, subject to Chapter 16.88.
- G. Offices or architects, artists, attorneys, dentists, engineers, physicians, accountants, consultants and similar professional services.
- H. Uses permitted outright in the RC zone are allowed within the HDR zone when limited to the first floor, adjacent to and within 100 feet of, Columbia Street within the Old Town Overlay District.

(Ord. 2002-1128 § 3; 94-990; 92-946; 87-859)

16.162.040 - Conditional Uses

The following uses are permitted as conditional uses, provided such uses meet the applicable environmental performance standards contained in Division VIII, and are approved in accordance with Chapter 16.82:

- A. Uses permitted as conditional uses in the RC zone, Section 16.28.020, HDR zone, Section 16.20.020, and the MDRL zone, Section 16.16.020, provided that uses permitted as conditional uses on any given property are limited to those permitted in the underlying zoning district, unless otherwise specified by Section 16.162.030 and this Section.
- B. Townhouses on property zoned RC in the Old Cannery area subject to HDR standards and Chapter 16.14. In addition, any garages shall use alley access. RC zone setback standards may be used in lieu of other applicable standards.
- C. Public and commercial (non-accessory) parking within residential zoning districts when both of the following apply:
 - 1. On May 1, 2016, no buildings existed on the property where the parking is to be located; and

2. The property has street frontage on an arterial and/or collector street as identified within the Sherwood Transportation System Plan.

(Ord. No. 2017-001, § 1, 4-4-2017; Ord. No. 2016-010, § 2, 6-21-2016; Ord. 2006-009 § 2; Ord. 2002-1128 § 3; 94-990; 92-946; 87-859)

16.162.050 - Prohibited Uses

The following uses are expressly prohibited in the OT overlay zone, notwithstanding whether such uses are permitted outright or conditionally in the underlying RC, HDR or MDRL zones:

- A. Adult entertainment businesses.
- B. Manufactured homes on individual lots.
- C. Manufactured home parks.
- D. Restaurants with drive-through.

(Ord. 2002-1128 § 3; 94-990; 92-946; 87-859)

- E. Stand alone cellular or wireless communication towers and facilities. Co-location of existing legally permitted facilities is acceptable.

(Ord. 2006-009 § 2)

16.162.060 - Dimensional Standards

In the OT overlay zone, the dimensional standards of the underlying RC, HDR and MDRL zones shall apply, with the following exceptions:

- A. Lot Dimensions - Minimum lot area (RC zoned property only): Twenty-five hundred (2,500) square feet.
- B. Setbacks - Minimum yards (RC zoned property only): None, including structures adjoining a residential zone, provided that Uniform Building Code, Fire District regulations, and the site design standards of this Code, not otherwise varied by this Chapter, are met.
- C. Height - The purpose of this standard is to encourage 2 to 4 story mixed-use buildings in the Old Town area consistent with a traditional building type of ground floor active uses with housing or office uses above.

Except as provided in Section 16.162.080, subsection C below, the maximum height of structures in RC zoned property shall be forty (40) feet (3 stories) in the "Smockville Area" and fifty (50) feet (4 stories) in the "Old Cannery Area". Limitations in the RC zone to the height of commercial structures adjoining residential zones, and allowances for additional building height as a conditional use, shall not apply in the OT overlay zone. However, five foot height bonuses are allowed under strict conditions. Chimneys, solar and wind energy devices, radio and TV antennas, and similar devices may exceed height limitations in the OT overlay zone by ten (10) feet.

Minimum height: A principal building in the RC and HDR zones must be at least sixteen (16) feet in height.

(Ord. 2006-009 § 2)

- D. Coverage - Home occupations permitted as per Chapter 16.42 and Section 16.162.030 may occupy up to fifty percent (50%) of the entire floor area of all buildings on a lot.

END OF PROPOSED AMENDMENTS

DEVELOPMENT CODE CROSS REFERENCES TABLE

[Removed from draft]