

March 12, 2024

Sherwood City Of  
22560 SW Pine St  
Sherwood, OR 97140-9933

15895 SW 72ND AVE  
SUITE 200  
PORTLAND, OR 97224  
PHONE: 503.226.1285  
FAX: 503.226.1670  
INFO@CIDAINC.COM  
WWW.CIDAINC.COM

RE: NEIGHBORHOOD REVIEW MEETING  
Proposed Development: Mazatlan – Sherwood Restaurant  
CIDA #: 230128.01

Dear Property Owner/Resident:

You are cordially invited to attend a meeting on March 28<sup>th</sup> at 6 PM at 20941 SW Olds Place. This meeting shall be held to discuss a proposed project located at the above address. The proposal is for a new 5,000SF commercial restaurant on a currently vacant lot.

This is an informational meeting to share the development proposal with interested neighbors. You will have the opportunity to review preliminary plans and identify topics of interest or consideration. Feel free to contact me with any questions or commentary.

Sincerely,

A handwritten signature in black ink that reads "Rebecca Kerr". The signature is fluid and cursive, with the first name being more prominent.

Rebecca Kerr, RA  
Associate Architect

(503) 226-1285 ext. 336  
rebeccak@cidainc.com

ARCHITECTURE  
ENGINEERING  
PLANNING  
INTERIORS



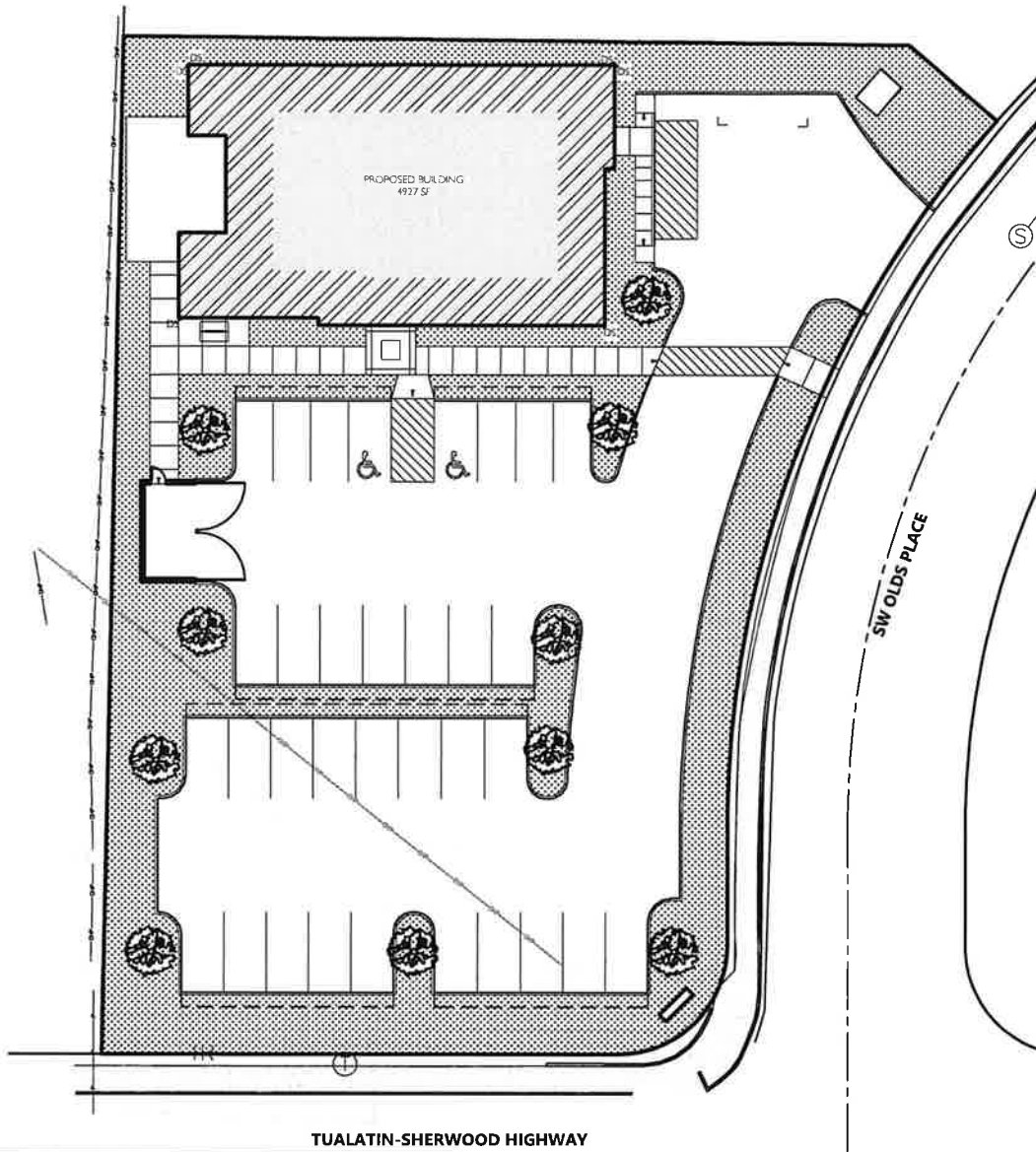

OWNER:  
APPLICANT:

G&T SHERWOOD, LLC  
REBECCA KERR

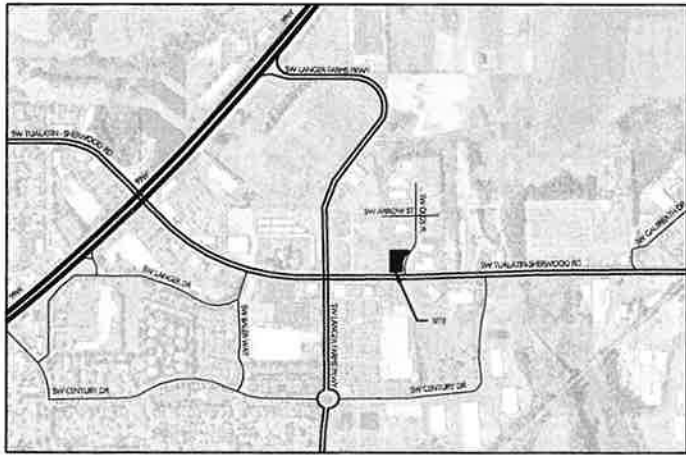

**VICINITY MAP**

NTS



**MAZATLAN RESTAURANT  
SHERWOOD, OREGON**

15895 SW 72ND AVE SUITE 200  
PORTLAND, OREGON 97224  
TEL: 503.226.1285  
FAX: 503.226.1670

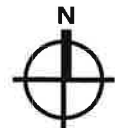

**PROJECT SITE PLAN**

03-13-2024  
KA

1"=40'  
230128.01

# Vicinity Map 20941 SW Olds Place

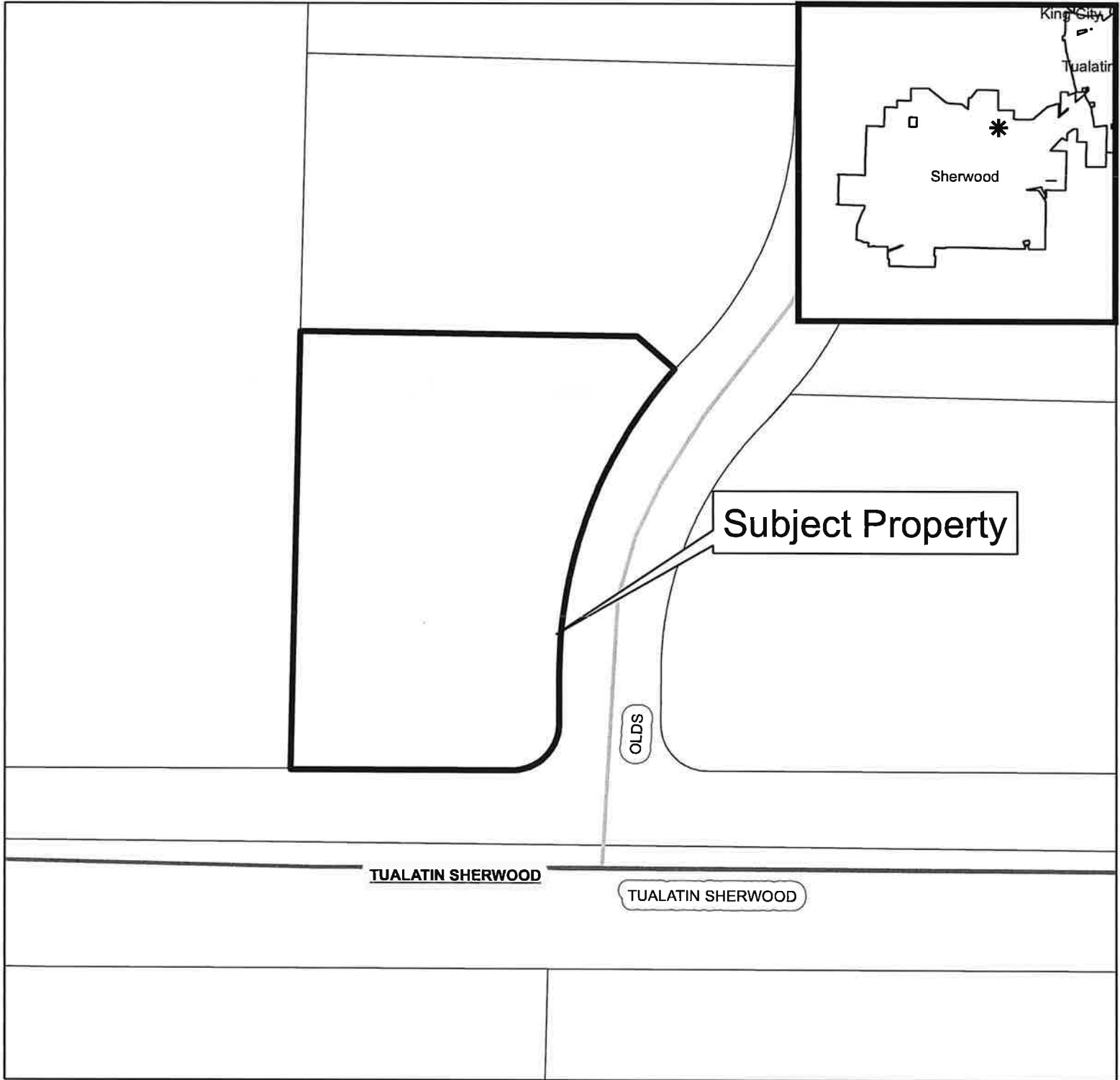







Subject Property

OLDS

TUALATIN SHERWOOD

TUALATIN SHERWOOD

### Legend

-  Subject Property
-  Taxlots
-  City Limits
-  Outside City Limits
-  Major Arterial Highways
-  Streets



N



0.02

0.04