

FOR REFERENCE ONLY

URBAN DESIGN LAYOUT AND PLANTING LEGEND

	MONUMENT A		EXPOSED AGGREGATE IN THE AMENITY ZONE
	MONUMENT B		STAINED CONCRETE-- COLOR EBONY
	LIGHTS		INTEGRAL COLORED CONCRETE
	LIGHTS WITH BANNERS		ROCK WALKWAY BALLAST
	LIGHTS WITH POTS		EXPANSION JOINT
	BANNER POLE		CONTROL JOINT
	BIKE BOLLARD		STEEL EDGER
	TRASH RECEPTACLE		POINT OF BEGINNING
	BENCH		HANDRAIL
	REMOVABLE BOLLARD		DOWN SPOUT CONNECTION
	STREETSCAPE TREE GRATE		
	OREGON STREET TREE GRATE		
	RAILROAD CHAIN LINK FENCE		
	DECORATIVE WALL		
	NEWSPAPER ENCLOSURE		
	ACCESSIBLE PARKING SPACE		
	TRUNCATED DOME PAVERS		
	PARKING PAVING STRIP--PRECAST CONCRETE PAVERS		
	CENTER LINE PAVING STRIP-- PRECAST CONCRETE PAVERS		
	GRANITE PAVING USED IN THE INTERSECTION CORNERS		
	GRANITE PAVING USED IN THE INTERSECTION SQUARE		

NOTES
 1. ALL ITEMS ARE MEASURED TO CENTERLINE UNLESS OTHERWISE ILLUSTRATED.
 2. ALL FLATWORK TO EXTEND TO R.O.W. OR ADJACENT EXISTING IMPROVEMENTS (i.e. WALLS, BUILDINGS, ADJACENT FLATWORK, ETC.)

Computer File Information		Sheet Revisions		Sherwood Downtown Streetscape Improvements--Phase A		As Constructed		URBAN DESIGN LEGEND		Project No./Code	
Creation Date:	09/08/04 Initials: DLL		/ /			No Revisions:	/ /	URBAN DESIGN LEGEND		071668.100	
Last Modification Date:	08/31/05 Initials: FA		/ /			Revised:	/ /	Designer:	WILENSKY	Structure	
Path:	J:_TRANSPORTATION\071668.100\CAD\UD\GENERAL\		/ /			Void:	/ /	Detailer:	HENNINGFELD	Numbers	City of Sherwood CIP #C-41
Drawing File Name:	LAYOUT LEGEND.DWG		/ /					Sheet Subset:		Subset Sheets:	Sheet Number UD00
Acad Ver. R16.0s	Scale: NTS Units: English		/ /								



Engineering Department
 15527 S. W. Wilamette St.
 Sherwood, OR 97140
 Phone: (503) 925-2305
 FAX: (503) 625-0679

Carter-Burgess

707 17th St., Suite 2300
 Denver, CO 80202
 Phone: (303) 820-5240
 FAX: (303) 820-2402

FOR REFERENCE ONLY

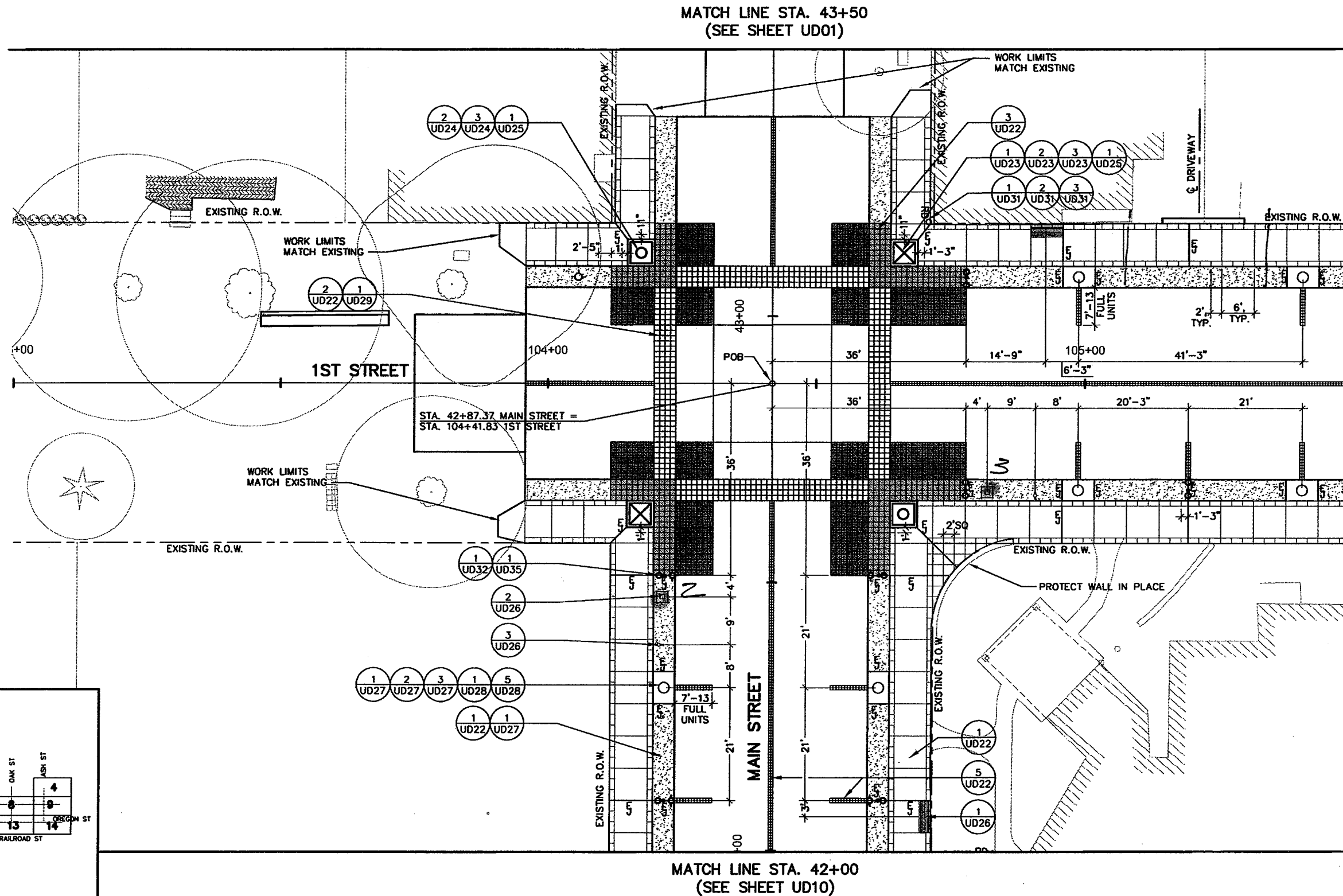
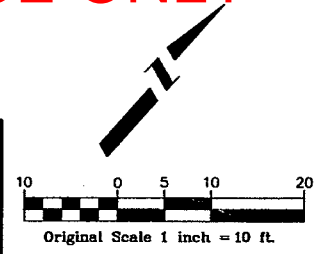

MATCH LINE STA. 105+50
(SEE SHEET UD06)

MATCH LINE STA. 43+50
(SEE SHEET UD01)

MATCH LINE STA. 42+00
(SEE SHEET UD10)

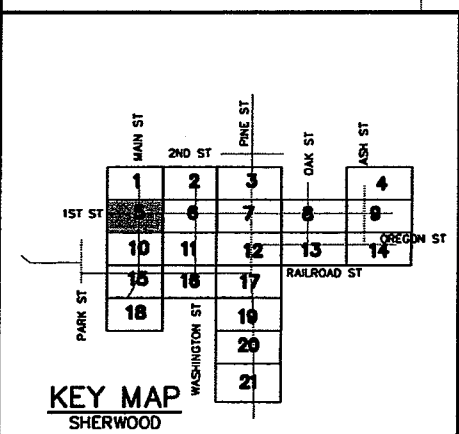
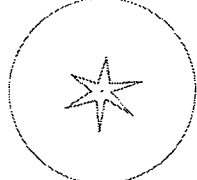

NOTE
1. SEE "CJ" SHEET #01 FOR ROADWAY JOINTING PLAN.

Computer File Information Creation Date: 09/08/04 Initials: OMB Last Modification Date: 08/31/05 Initials: FA Path: J:_TRANSPORTATION\071668.100\CAD\UD\SH\100%\UD\ Drawing File Name: UD05.DWG Acad Ver. R16.0s Scale: 1"=10' Units: English		Sheet Revisions <table border="1"> <tr><td>(R-)</td><td>/ /</td><td></td></tr> <tr><td>(R-)</td><td>/ /</td><td></td></tr> <tr><td>(R-)</td><td>/ /</td><td></td></tr> <tr><td>(R-)</td><td>/ /</td><td></td></tr> <tr><td>(R-)</td><td>/ /</td><td></td></tr> </table>		(R-)	/ /		(R-)	/ /		(R-)	/ /		(R-)	/ /		(R-)	/ /		Sherwood Downtown Streetscape Improvements-Phase A  Engineering Department 15527 S. W. Wilamette St. Sherwood, OR 97140 Phone: (503) 925-2305 FAX: (503) 625-0679		Carter=Burgess 707 17th St., Suite 2300 Denver, CO 80202 Phone: (303) 820-5240 FAX: (303) 820-2402		As Constructed No Revisions: / / Revised: / / Void: / /		URBAN DESIGN PLAN 1ST AND MAIN STREET Designer: WILENSKY Detailer: HENNINGFELD Sheet Subset:		Project No./Code 071668.100 City of Sherwood CIP #C-41 Sheet Number UD05	
(R-)	/ /																											
(R-)	/ /																											
(R-)	/ /																											
(R-)	/ /																											
(R-)	/ /																											

FOR REFERENCE ONLY

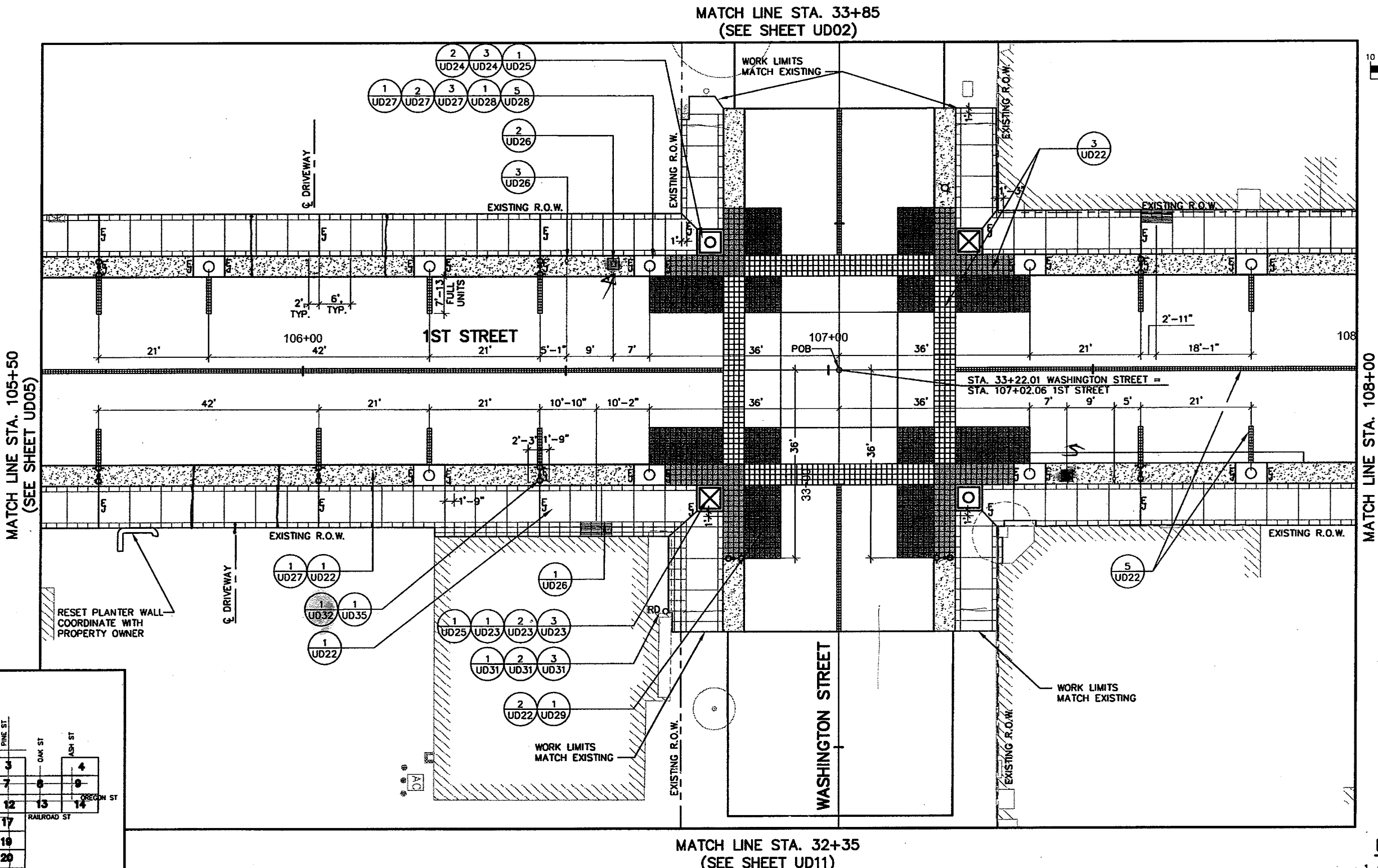
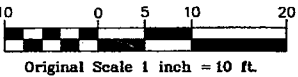

MATCH LINE STA. 105+50
(SEE SHEET UD05)

MATCH LINE STA. 108+00
(SEE SHEET UD07)

MATCH LINE STA. 33+85
(SEE SHEET UD02)

MATCH LINE STA. 32+35
(SEE SHEET UD11)

RESET PLANTER WALL
COORDINATE WITH
PROPERTY OWNER

WORK LIMITS
MATCH EXISTING

WORK LIMITS
MATCH EXISTING

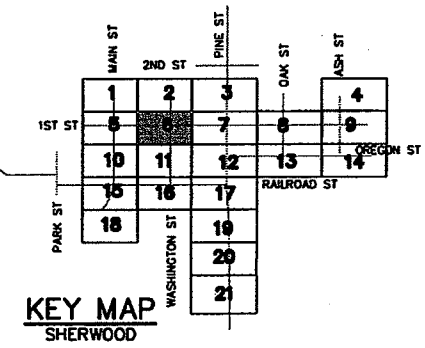

NOTE
1. SEE "CJ" SHEET #02 FOR
ROADWAY JOINTING PLAN.

Computer File Information		Sheet Revisions		Sherwood Downtown Streetscape Improvements-Phase A		As Constructed		URBAN DESIGN PLAN		Project No./Code	
Creation Date:	09/08/04	Initials:	DMB	(R-)	/ /	<p>Engineering Department 15527 S. W. Willamette St. Sherwood, OR 97140 Phone: (503) 925-2305 FAX: (503) 625-0679</p>	<p>Carter-Burgess</p> <p>707 17th St., Suite 2300 Denver, CO 80202 Phone: (303) 820-5240 FAX: (303) 820-2402</p>	No Revisions: / /		071668.100	
Last Modification Date:	08/31/05	Initials:	FA	(R-)	/ /			Revised: / /		Designer: WILENSKY	
Path:	J:_TRANSPORTATION\071668.100\CAD\UD\SH\100%\UD\			(R-)	/ /			Void: / /		Detailer: HENNINGFELD	
Drawing File Name:	UD06.DWG			(R-)	/ /					Structure Numbers	
Acad Ver.	R16.0s	Scale:	1"=10'	Units:	English			Sheet Subset:		City of Sherwood CIP #C-41	
				(R-)	/ /			Subset Sheets:		Sheet Number UD06	

FOR REFERENCE ONLY

MATCH LINE STA. 21+00
(SEE SHEET UD03)

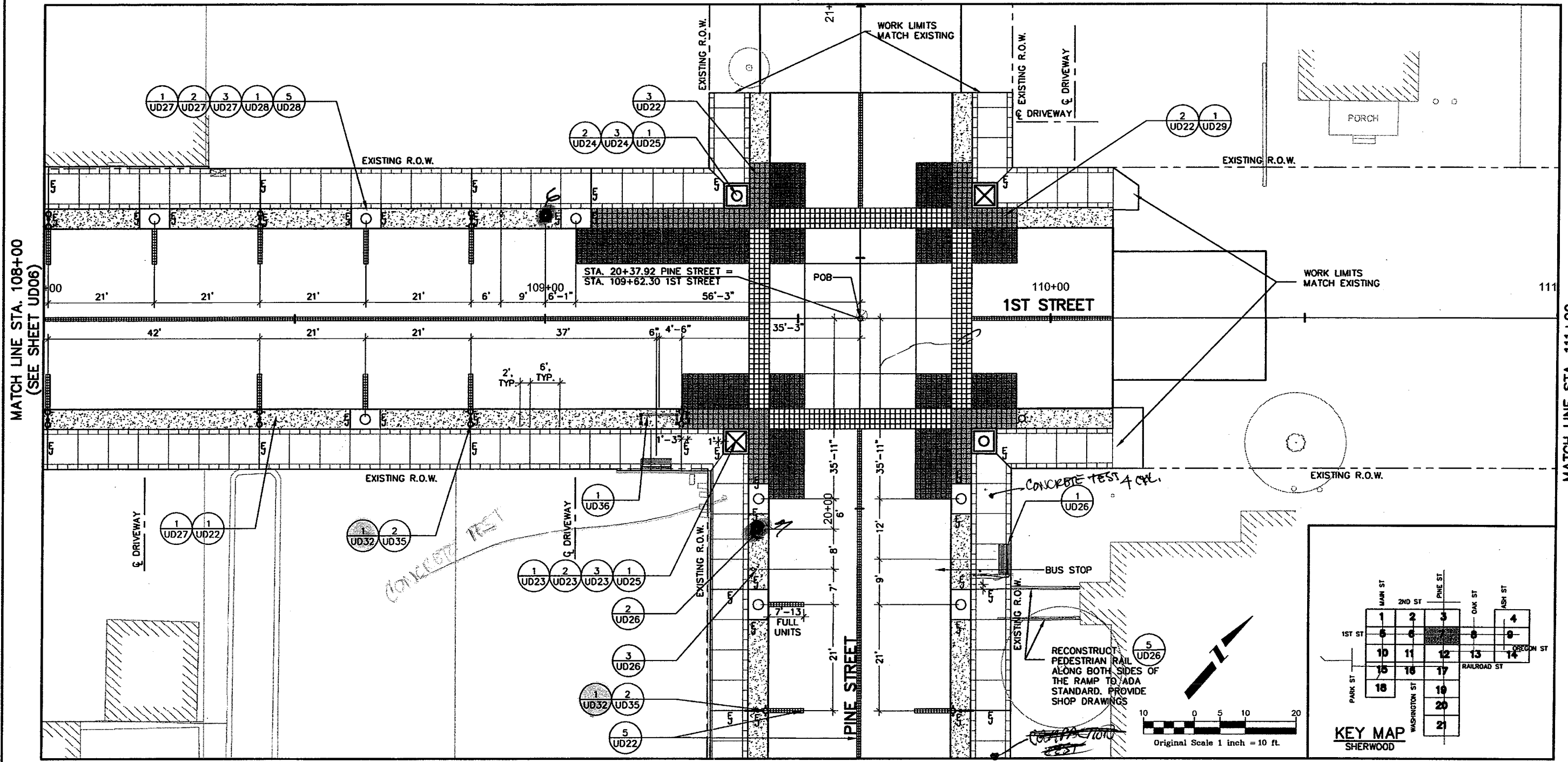

MATCH LINE STA. 19+50
(SEE SHEET UD12)

NOTE

1. SEE "CJ" SHEET #03 FOR ROADWAY JOINTING PLAN.

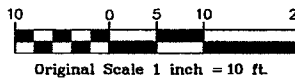
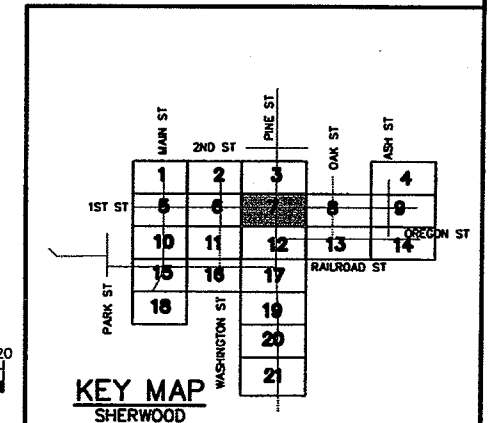

Computer File Information	
Creation Date:	09/08/04 Initials: DMB
Last Modification Date:	08/31/05 Initials: FA
Path:	J:_TRANSPORTATION\071668.100\CAD\UD\SH\100%\UD\
Drawing File Name:	UD07.DWG
Acad Ver.:	R16.0s Scale: 1"=10' Units: English

Sheet Revisions	
(R-)	/ /
(R-)	/ /
(R-)	/ /
(R-)	/ /
(R-)	/ /

Sherwood Downtown Streetscape Improvements-Phase A

Engineering Department
15527 S. W. Wilamette St.
Sherwood, OR 97140
Phone: (503) 925-2305
FAX: (503) 625-0679

Carter-Burgess

707 17th St., Suite 2300
Denver, CO 80202
Phone: (303) 820-5240
FAX: (303) 820-2402

As Constructed	
No Revisions:	/ /
Revised:	/ /
Void:	/ /

URBAN DESIGN PLAN 1ST AND PINE STREET	
Designer:	WILENSKY
Detailer:	HENNINGFELD
Structure Numbers:	
Sheet Subset:	
Subset Sheets:	

Project No./Code	
071668.100	
City of Sherwood CIP #C-41	
Sheet Number	UD07

FOR REFERENCE ONLY

- NOTES**
1. TWO (2) MONUMENTS AT THE INTERSECTION OF OREGON STREET AND PINE STREET SHALL HAVE SHEET NAME PER CITY DIRECTION. SEE SIGNAGE AND GRAPHICS PLAN. FOUR (4) MONUMENTS AT THE INTERSECTION OF 1ST STREET AND ASH STREET SHALL NOT INCLUDE STREET NAME SIGNAGE IN PRE-CAST CONCRETE CAP.
 2. TWO (2) MONUMENTS AT THE INTERSECTION OF OREGON STREET AND PINE STREET SHALL HAVE LIGHTING ADJUSTED TO STREET SIDE AND OPPOSITE SIDE. FOUR (4) MONUMENTS AT THE INTERSECTION OF 1ST STREET SHALL HAVE LIGHTING ADJUSTED TO STREET SIDE(S) ONLY.
 3. ALL CAST-IN-PLACE CONCRETE SHALL BE CLASS '3600' PER ODOT STD. SPECIFICATIONS.
 4. ALL MONUMENT CONCRETE SHALL BE STAINED TO MATCH ALL PIECES WITH SAME COLOR.

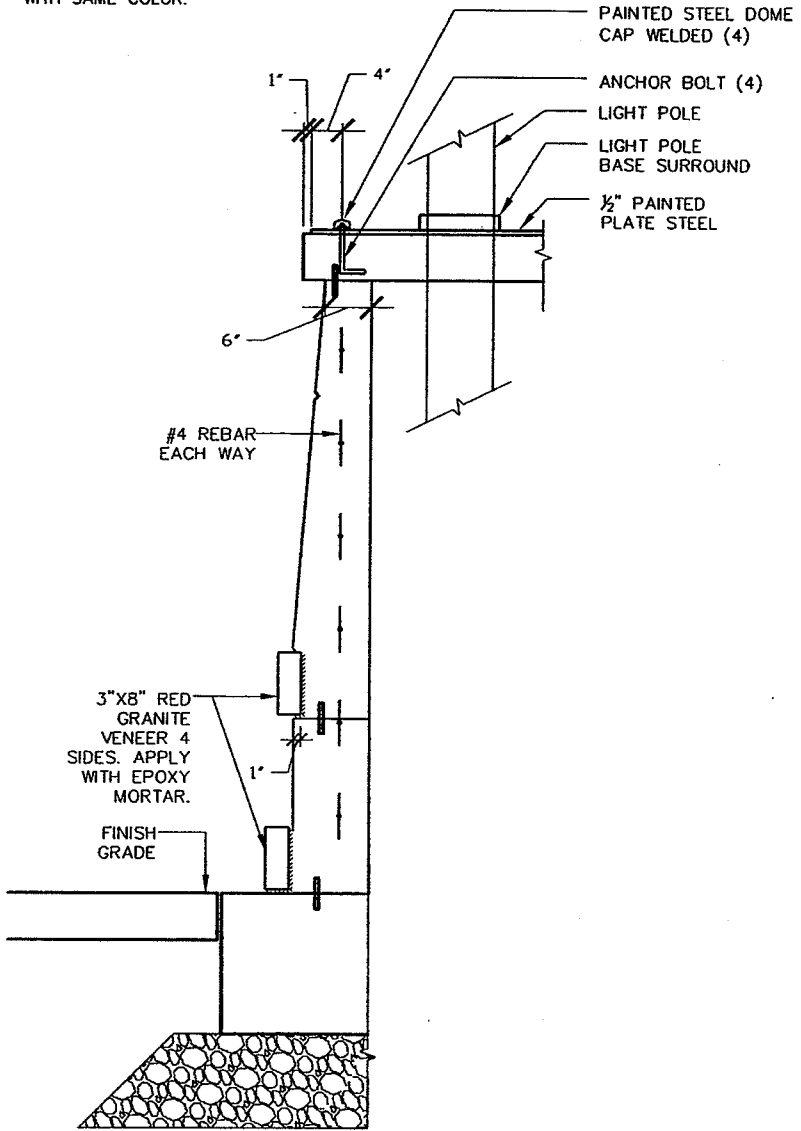
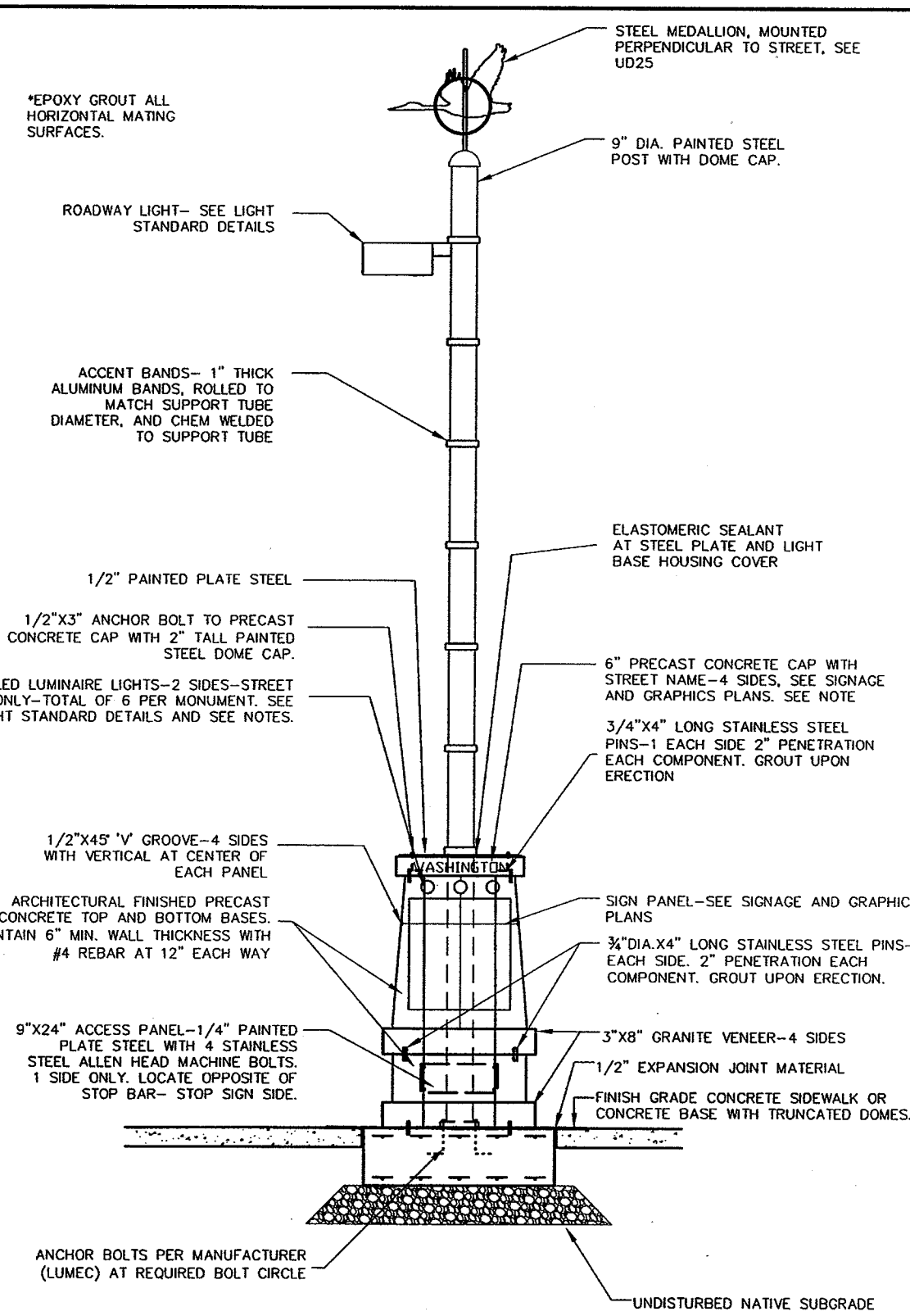
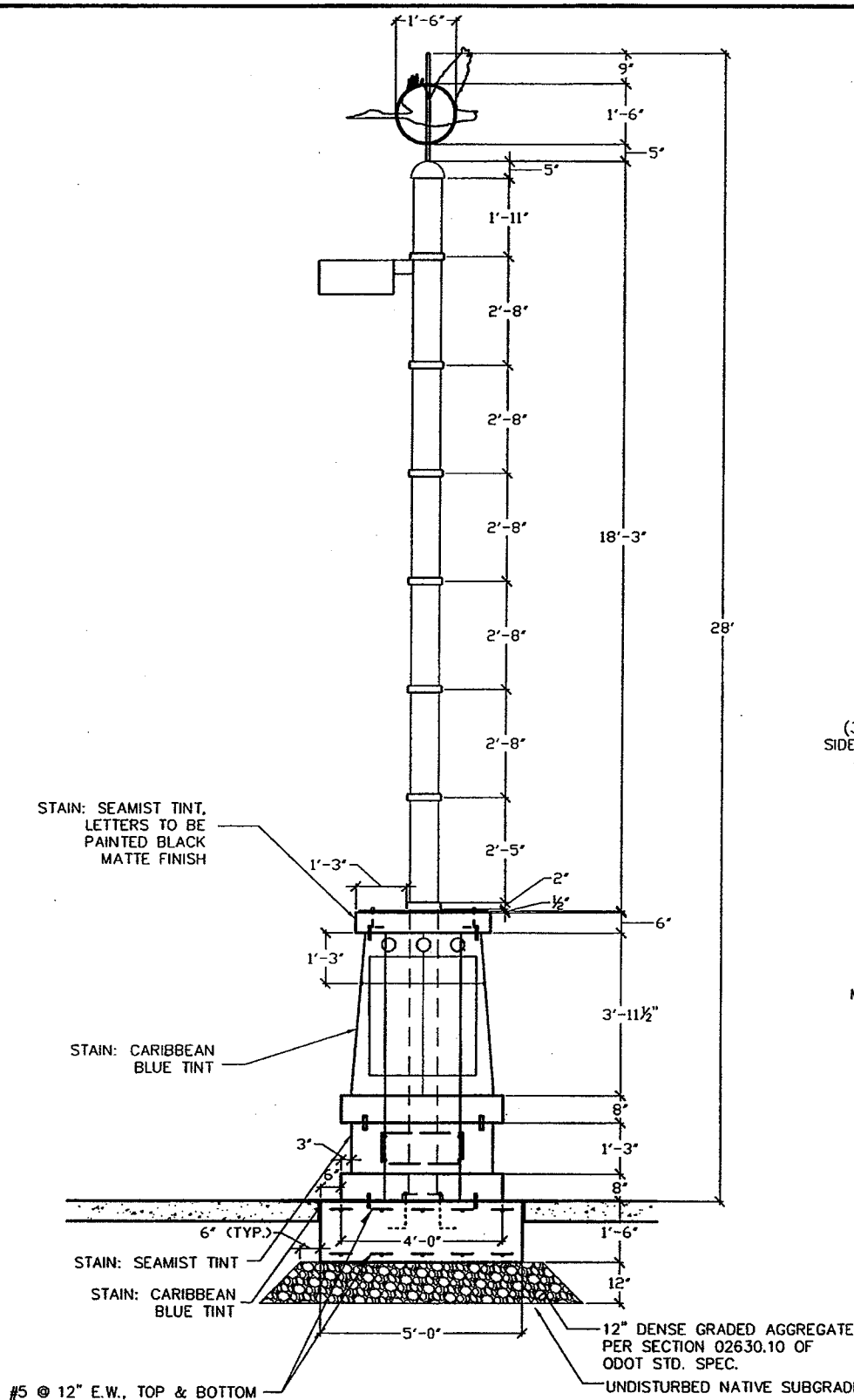

1 ELEVATION OF TYPE A MONUMENT - DIMENSIONS
UD23 SCALE: NOT TO SCALE

2 ELEVATION OF TYPE A MONUMENT - MATERIALS
UD23 SCALE: NOT TO SCALE

3 MONUMENT ENLARGEMENT
UD23 SCALE: NOT TO SCALE

Computer File Information		Sheet Revisions		Sherwood Downtown Streetscape Improvements-Phase A		As Constructed		URBAN DESIGN DETAILS		Project No./Code		
Creation Date:	09/08/04	Initials:	DLL	(R-)	/ /		Carter-Burgess Engineering Department 15527 S. W. Wilamette St. Sherwood, OR 97140 Phone: (503) 925-2305 Fax: (503) 625-0679	No Revisions: / / Revised: / / Void: / /	Designer: WILENSKY Detailer: HENNINGFELD	Structure Numbers Subsets:	Project No./Code	
Last Modification Date:	06/20/05	Initials:	FA	(R-)	/ /						707 17th St., Suite 2300 Denver, CO 80202 Phone: (303) 820-5240 FAX: (303) 820-2402	City of Sherwood CIP #C-41
Path:	J:\TRANSPORTATION\071668.100\CAD\UD\TYPICALS\			(R-)	/ /							Sheet Number
Drawing File Name:	_UD23DETAILS.DWG			(R-)	/ /							UD23
Acad Ver.	R16.0s	Scale:	NTS	Units:	English							

FOR REFERENCE ONLY

- NOTE:
1. MEDALLIONS TO BE "FLOW JET" CUT FROM SINGLE 1/4" PLATE SELF WEATHERING STEEL.
 2. CONTRACTOR TO FURNISH FULL SIZE ARTWORK FOR APPROVAL.
 3. CONTRACTOR TO FURNISH (1) FISH, (1) GOOSE, (1) TREE, AND (1) CATTAIL FULL SIZE, CUT FROM 1/4" PLATE STEEL MOUNTED ON STEEL ROD FOR APPROVAL.
 4. ARTWORK AND ACTUAL SAMPLES SHIPPED TO CARTER BURGESS, DENVER, CO. FOR FINAL APPROVAL PRIOR TO EXECUTION OF PROJECT ELEMENTS.

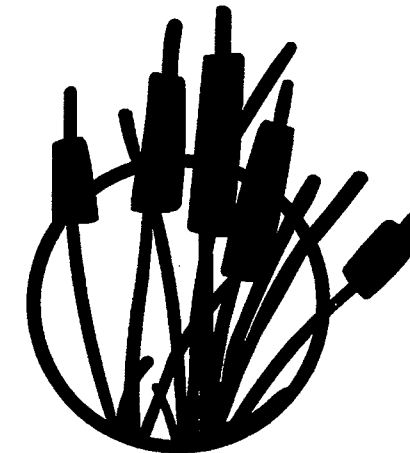
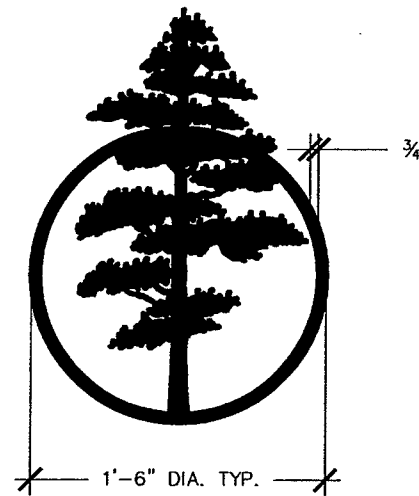
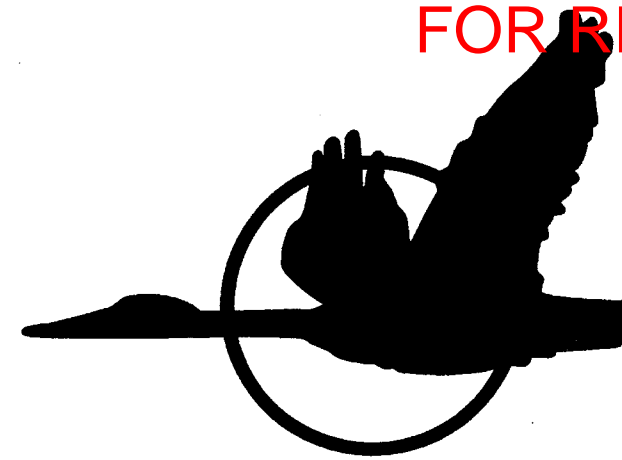
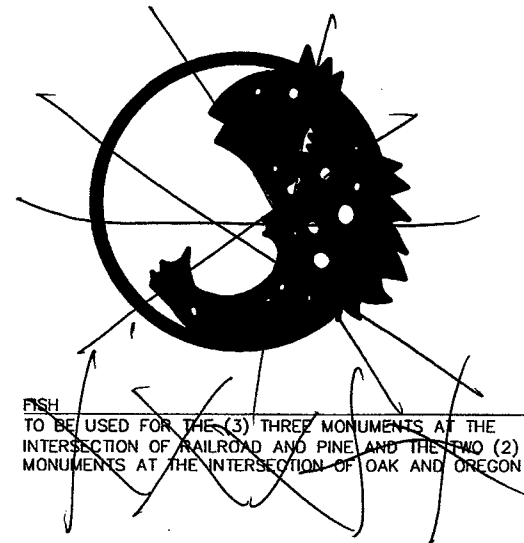
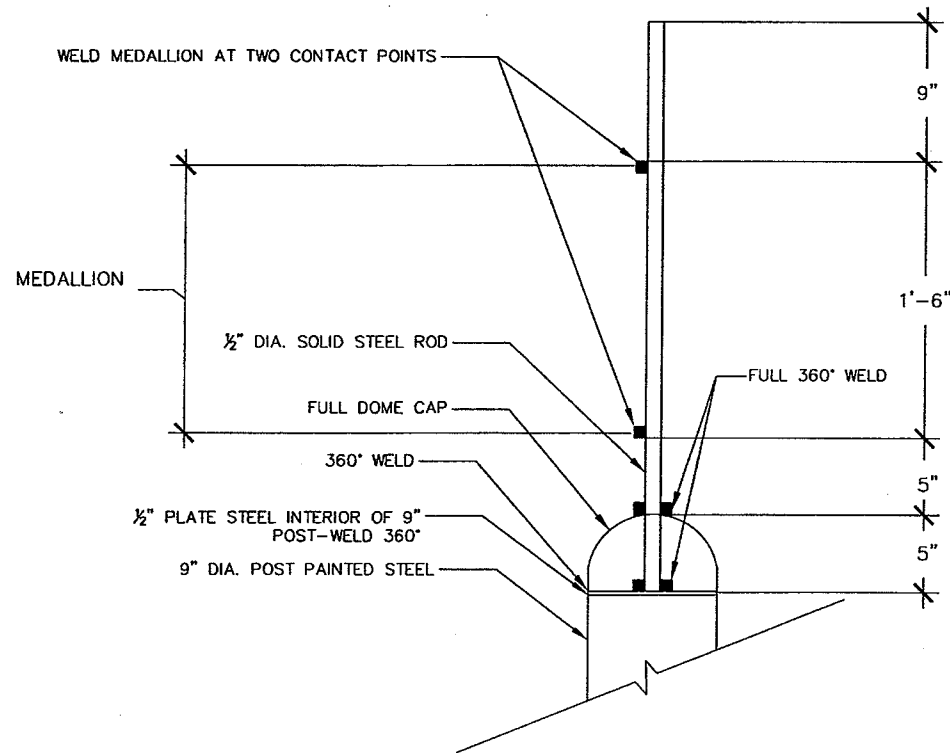

1 MEDALLIONS
UD25 SCALE: NOT TO SCALE

Computer File Information		Sheet Revisions		Sherwood Downtown Streetscape Improvements-Phase A		As Constructed		URBAN DESIGN DETAILS		Project No./Code			
Creation Date:	09/08/04 Initials: DLL	(R-)	/ /			<p>Engineering Department 15527 S. W. Wilamette St. Sherwood, OR 97140 Phone: (503) 925-2305 FAX: (503) 625-0679</p>	<p>Carter Burgess</p> <p>707 17th St., Suite 2300 Denver, CO 80202 Phone: (303) 820-5240 FAX: (303) 820-2402</p>	No Revisions:	/ /	<p>Designer: WILENSKY</p> <p>Detailer: HENNINGFELD</p>		Project No./Code	071668.100
Last Modification Date:	08/31/05 Initials: FA	(R-)	/ /					Revised:	/ /	Structure Numbers		City of Sherwood CIP #C-41	
Path:	J:_TRANSPORTATION\071668.100\CAD\UD\SH\TYPICALS\	(R-)	/ /					Void:	/ /	Sheet Subset:		Sheet Number	UD25
Drawing File Name:	_UD25DETAILS.DWG	(R-)	/ /							Subset Sheets:			
Acad Ver.	R16.0s	Scale:	NTS	Units:	English								

FOR REFERENCE ONLY

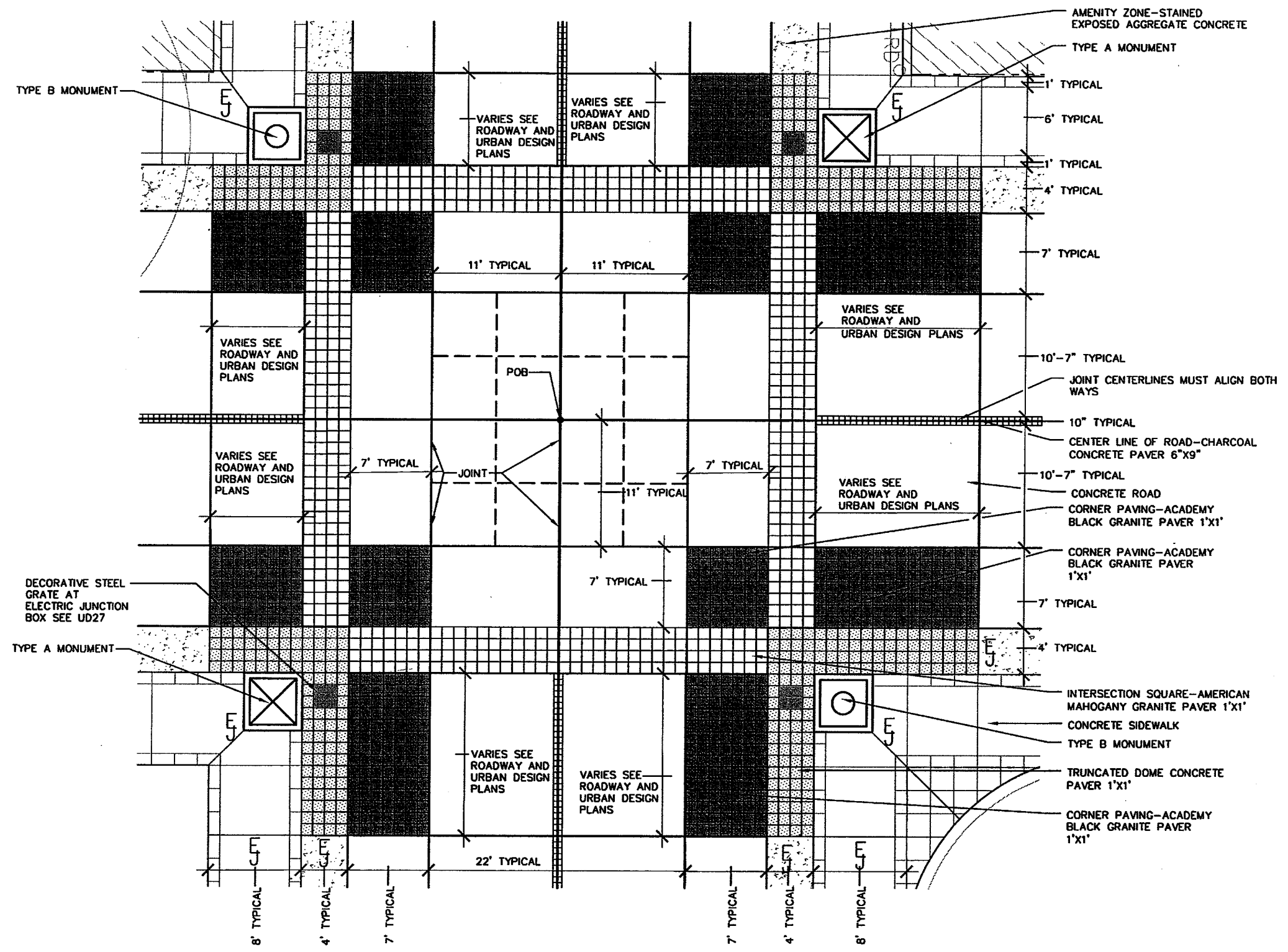

1 TYPICAL INTERSECTION PAVING PATTERN
 UD29 SCALE— NOT TO SCALE

Computer File Information	
Creation Date:	09/08/04 Initials: DMB
Last Modification Date:	06/20/05 Initials: FA
Path:	J:_TRANSPORTATION\071668.100\CAD\UD\TYPICALS\
Drawing File Name:	_UD29DETAILS.DWG
Acad Ver. R16.0s	Scale: 1"=10' Units: English

Sheet Revisions	
(R-)	/ /
(R-)	/ /
(R-)	/ /
(R-)	/ /

Sherwood Downtown Streetscape Improvements—Phase A

Engineering Department
 15527 S. W. Wilamette St.
 Sherwood, OR 97140
 Phone: (503) 925-2305
 FAX: (503) 625-0679

Carter-Burgess

707 17th St., Suite 2300
 Denver, CO 80202
 Phone: (303) 820-5240
 FAX: (303) 820-2402

As Constructed	
No Revisions:	/ /
Revised:	/ /
Void:	/ /

URBAN DESIGN DETAILS	
Designer:	WILENSKY
Detailer:	HENNINGFELD
Structure Numbers:	
Sheet Subset:	
Subset Sheets:	

Project No./Code	
Project No./Code	071668.100
City of Sherwood CIP #C-41	
Sheet Number	UD29

FOR REFERENCE ONLY

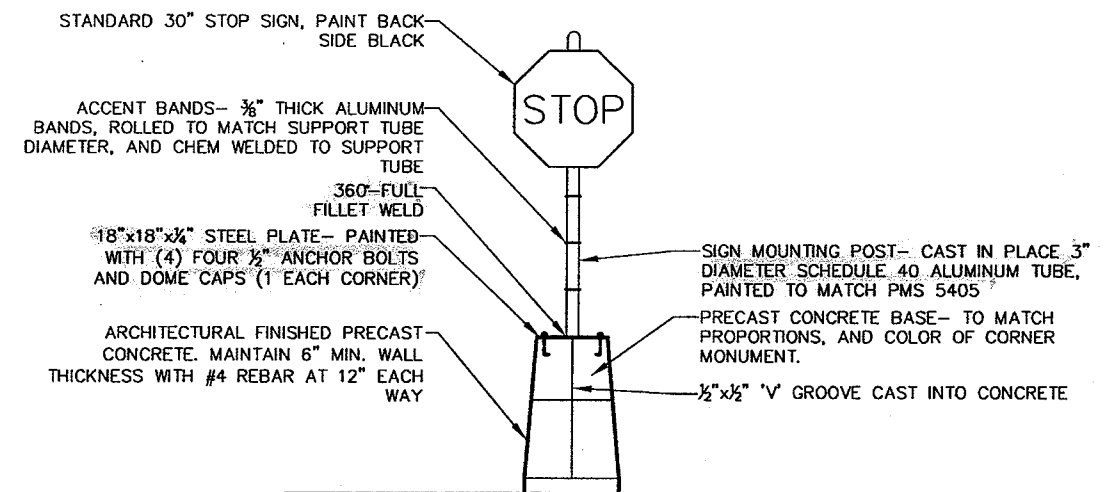
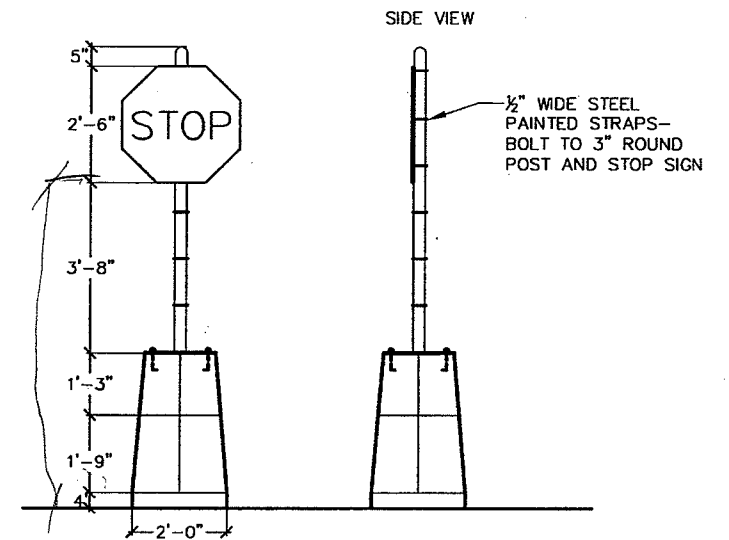
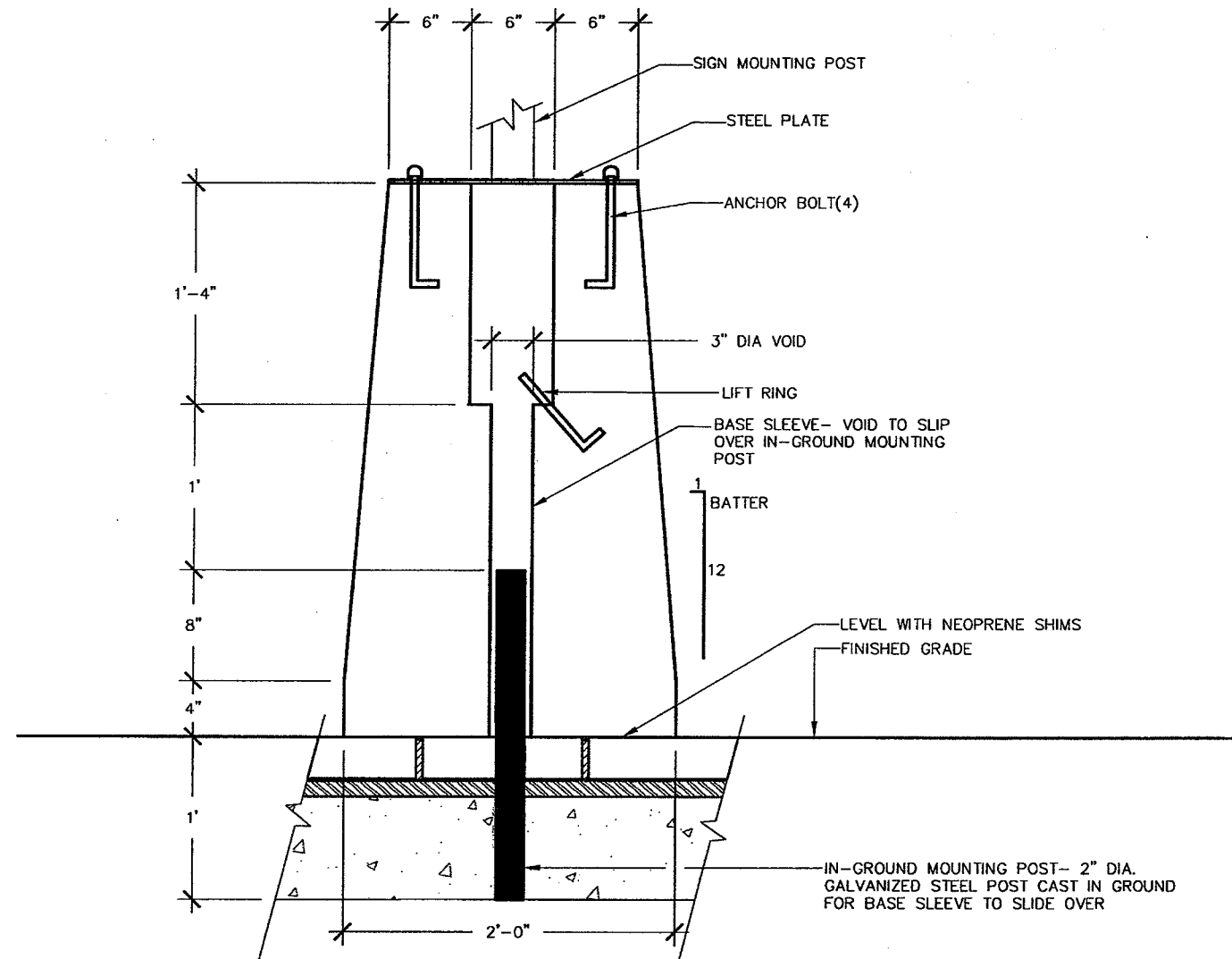

NOTE: 1. SEE SIGNAGE AND STRIPING SHEETS FOR LOCATIONS.
2. BASE SHALL BE CENTERED IN PARKING ZONE.

1 UD34 DOWNTOWN STOP SIGN/BOLLARD
SCALE: NOT TO SCALE

Computer File Information		Sheet Revisions		Sherwood Downtown Streetscape Improvements-Phase A		As Constructed		URBAN DESIGN DETAILS		Project No./Code	
Creation Date:	09/08/04 Initials: DLL	(R-)	/ /				No Revisions:	/ /			071668.100
Last Modification Date:	08/31/05 Initials: FA	(R-)	/ /				Revised:	/ /	Designer:	WILENSKY	City of Sherwood CIP #C-41
Path:	J:_TRANSPORTATION\071668.100\CAD\UD\SHI\TYPICALS\	(R-)	/ /				Void:	/ /	Detailer:	HENNINGFELD	Sheet Number UD34
Drawing File Name:	_UD34DETAILS.DWG	(R-)	/ /						Structure Numbers		
Acad Ver. R16.0s	Scale: NTS Units: English	(R-)	/ /						Sheet Subset:		Subset Sheets:



Carter-Burgess
707 17th St., Suite 2300
Denver, CO 80202
Phone: (303) 820-5240
FAX: (303) 820-2402

Engineering Department 15527 S. W. Wilamette St. Sherwood, OR 97140 Phone: (503) 925-2305 FAX: (503) 625-0679	City of Sherwood Oregon
---	-------------------------

GENERAL NOTES (FOR ALL LIGHTING SHEETS):

- NATIONAL AND LOCAL ELECTRICAL CODES SHALL GOVERN THE MINIMUM STANDARD OF WORK. IN THE EVENT OF A CONFLICT BETWEEN THESE DRAWINGS AND APPLICABLE CODE, THE CODE SHALL PREVAIL AND INSTALLATION SHALL BE MADE IN CONFORMANCE WITH THE CODE. CONTRACTOR SHALL VERIFY ALL EXISTING CONDITIONS PRIOR TO REMOVAL OR INSTALLATION OF LIGHTING EQUIPMENT.
- UNDER ALL CIRCUMSTANCES, MATERIALS, INSTALLATION AND WIRING METHODS SHALL CONFORM TO CURRENT ODOT DESIGN STANDARDS UNLESS SHOWN OTHERWISE IN THIS PLAN SET.
- CONTRACTOR SHALL BE RESPONSIBLE FOR COORDINATION WITH LOCAL ELECTRIC UTILITY CONCERNING TRANSFORMER LOCATIONS AND OTHER UTILITY COORDINATION ITEMS AS REQUIRED. CONTRACTOR SHALL BE RESPONSIBLE FOR COORDINATION WITH OTHER TRADES AS REQUIRED, INCLUDING, BUT NOT LIMITED TO, VERIFYING POINTS OF SERVICE, SCHEDULING UTILITY CONNECTIONS, AND LIGHT POLE/FOUNDATION COMPATIBILITY. CONTRACTOR SHALL FURNISH ADDITIONAL INFORMATION TO LOCAL ELECTRIC UTILITY AS REQUIRED TO FACILITATE THE PROPER INSTALLATION OF THE COMPLETE LIGHTING SYSTEM.
- ALL EXISTING ROAD CROSSINGS SHOWN IN THIS PLAN SET SHALL BE DONE BY DIRECTIONAL BORING, OR AT THE DISCRETION OF THE FIELD ENGINEER. IT IS THE CONTRACTOR'S RESPONSIBILITY TO ENSURE THAT BORING LOCATION AND DEPTH WILL NOT CONFLICT WITH EXISTING UTILITIES OR DAMAGE ROAD SUB-GRADE.
- NOT ALL EXISTING LIGHTING EQUIPMENT MAY BE SHOWN ON THE PLANS. CONTRACTOR SHALL COORDINATE WITH LOCAL UTILITY ON THE REMOVAL OF ANY UTILITY-OWNED ELECTRICAL EQUIPMENT MARKED AS 'TO BE REMOVED'. ADDITIONAL ELECTRICAL DISTRIBUTION EQUIPMENT NOT SPECIFICALLY SHOWN ON THE PLANS MAY BE REMOVED IF THE LIGHTING SYSTEM CHANGES MAKE THEM OBSOLETE AND THE REMOVAL IS APPROVED THE CITY'S REPRESENTATIVE.
- UNLESS OTHERWISE NOTED, THE WORK DESCRIBED ON THE PLANS SHALL INCLUDE PROVIDING ALL LABOR AND MATERIALS NECESSARY FOR COMPLETE AND OPERATIONAL ELECTRICAL SYSTEMS. FURNISH ALL REQUIRED ITEMS WHETHER SUCH ARE SPECIFICALLY SHOWN OR NOT.
- ALL POINTS OF SERVICE SHALL BE VERIFIED IN THE FIELD.
- INFORMATION SHOWN ON THE DRAWINGS IS DIAGRAMMATIC ONLY AND SHALL NOT BE SCALED. OBTAIN AND VERIFY EXACT LOCATIONS, MEASUREMENTS, LEVELS, SPACE REQUIREMENTS, POTENTIAL CONFLICTS AMONG TRADES, ETC. THE CONTRACTOR IS RESPONSIBLE FOR COORDINATING THE WORK OF ALL TRADES AND FOR ADJUSTING THE WORK AS REQUIRED BY THE ACTUAL CONDITIONS OF THE PROJECT. UTILIZE JOINT UTILITY TRENCH WITH OTHER UTILITIES ALONG ROADWAY. REFER TO UTILITY DRAWINGS FOR ADDITIONAL INFORMATION.
- INSTRUCTIONS SUCH AS "PROVIDE..." SHALL MEAN, "CONTRACTOR SHALL BE RESPONSIBLE FOR FURNISHING AND INSTALLING COMPLETE IN EVERY RESPECT."
- MAINTAIN A COMPLETE SET OF ELECTRICAL DRAWINGS AT THE JOB SITE WITH ALL CHANGES OR VARIATIONS IN THE WORK MARKED IN AN OBVIOUS MANNER. A COMPLETE AS-BUILT SET OF DRAWINGS INCORPORATING ALL MARK-UPS OF THE WORK SHALL BE DELIVERED TO THE ENGINEER UPON THE COMPLETION OF THE PROJECT.
- INSTALL ALL EQUIPMENT AND MATERIALS IN ACCORDANCE WITH INFORMATION INDICATED ON THE DRAWINGS AND IN FULL ACCORDANCE WITH MANUFACTURER'S RECOMMENDATIONS.
- PROVIDE ALL BORING, CUTTING, CHANNELING, CHASING, DRILLING, AND OTHER OPERATIONS AS MAY BE REQUIRED FOR THE ELECTRICAL WORK. ALL PATCHING AND FINISHING SHALL BE INCLUDED IN THE ELECTRICAL WORK DONE BY THE CONTRACTOR.
- ALL TEMPORARY POWER AND LIGHTING SHALL COMPLY WITH NEC AND OSHA REQUIREMENTS.
- GUARANTEE ALL MATERIALS, LABOR, WORKMANSHIP AND THE SUCCESSFUL OPERATION OF ALL EQUIPMENT INSTALLED UNDER THIS CONTRACT FOR A PERIOD OF ONE YEAR FROM THE DATE OF FINAL ACCEPTANCE. REPAIR OR REPLACE, AT NO EXPENSE TO THE OWNER, ALL DEFECTS WHICH MAY ARISE DURING THIS TIME DUE TO INFERIOR OR DEFECTIVE MATERIALS, EQUIPMENT OR WORKMANSHIP.
- ALL POWER OUTAGES, WHEN NECESSARY, SHALL BE SCHEDULED IN WRITING 14 DAYS IN ADVANCE WITH THE CITY'S REPRESENTATIVE. POWER SHALL BE INTERRUPTED ONLY AT ENGINEER APPROVED TIMES.
- ALL MATERIALS SHALL BE NEW, SHALL BE SUITABLE FOR THE PURPOSE, AND SHALL BEAR THE UL LABEL. ENCLOSURES SHALL BE SUITABLE FOR THE ENVIRONMENT OF THE INSTALLATION. DAMAGED OR DEFECTIVE MATERIALS SHALL BE REPLACED AT NO COST TO THE PROJECT.
- CONDUITS SHALL BE PROVIDED FOR ALL WIRING AS SHOWN, UNLESS OTHERWISE NOTED. DIRECT BURY CABLE SHALL NOT BE PERMITTED. EMT AND FLEXIBLE METALLIC CONDUIT SHALL BE USED ABOVE GRADE. GALVANIZED RIGID OR PVC CONDUIT SHALL BE USED IN SLABS OR BELOW GRADE. PROVIDE APPROVED COUPLINGS AND CONNECTORS FOR ALL CONNECTIONS. FINAL CONNECTIONS TO MOTORS AND OTHER VIBRATING OR ROTATING EQUIPMENT SHALL BE MADE IN FLEXIBLE METALLIC CONDUIT. CONDUIT SHALL BE ROUTED CONCEALED IN FINISHED SPACES. WHERE USED, EXPOSED CONDUIT SHALL BE ROUTED TO FOLLOW BUILDING LINES AS CLOSELY AS POSSIBLE.
- UPON COMPLETION OF THE WORK, AT A TIME TO BE ACCEPTABLE WITH THE OWNER, THE CONTRACTOR SHALL DEMONSTRATE THE OPERATION OF THE ENTIRE ELECTRICAL INSTALLATION TO THE OWNER. PROVIDE INSTRUCTION MANUALS FOR ALL EQUIPMENT AS APPLICABLE.
- UPON COMPLETION OF THE PROJECT, CLEAN ALL ELECTRICAL EQUIPMENT AND MATERIALS OF ALL FOREIGN MATTER. REMOVE ALL TEMPORARY WIRING, OUTLETS, ETC.

LEGEND

- CORNER MONUMENT WITH TYPE 'EE' 150MH LUMINAIRE AND LED TYPE 'GG' LUMINAIRES. SUBSCRIPT INDICATES CIRCUIT #
- CORNER MONUMENT WITH LED TYPE 'GG' LUMINAIRE ONLY. SUBSCRIPT INDICATES CIRCUIT #
- NEW TYPE 'AA'; 55W INDUCTION LAMP LIGHTING ASSEMBLY WITH 16' POLE AND DECORATIVE ARM. SUBSCRIPT INDICATES CIRCUIT #
- NEW TYPE 'BB'; 55W INDUCTION LAMP LIGHTING ASSEMBLY WITH 16' POLE AND DECORATIVE ARMS. SUBSCRIPT INDICATES CIRCUIT #
- NEW TYPE 'BB' (SAME AS ABOVE EXCEPT W/A POLE MOUNTED DUPLEX RECEPTACLE ON CIR.#1.)
- NEW TYPE 'CC'; 55W INDUCTION LAMP LIGHTING ASSEMBLY WITH 16' POLE AND DECORATIVE ARMS. SUBSCRIPT INDICATES CIRCUIT #
- NEW TYPE 'CC' (SAME AS ABOVE EXCEPT W/A POLE MOUNTED DUPLEX RECEPTACLE ON CIR.#1.)
- NEW TYPE 'DD'; 16' POLE WITH DECORATIVE ARMS AND BANNERS ON (2) SIDES. NO ELECTRICAL REQUIREMENTS
- NEW TYPE 'HH' GROUND MOUNTED SIGNLIGHTER
- NEW TYPE 'FF' WALL MOUNTED 32-WATT COMPACT FLUORESCENT SCNCE
- GFCI DUPLEX RECEPTACLE W/IN-USE WEATHER-PROOF COVER AT TREE GRATE PER CITY SPECS. REFER TO DETAIL 5, UD28.
- (2) 2" SCHEDULE 80 PVC CONDUIT UNDER PAVEMENT TERMINATING IN SPLICE BOXES.
- TRANSFORMER BY LOCAL UTILITY (VERIFY EXACT LOCATION)
- LIGHTING CONTROL CENTER
- 3 #8 THWN, 1 #8 GND IN 1 1/2" PVC CONDUIT IN A MINIMUM 24" TRENCH (UNLESS OTHERWISE NOTED)
- HOMERUN OR CIRCUIT BREAK, NUMBER OF ARROWS INDICATES NUMBER OF CIRCUITS.
- FLUSH-TO-GRADE SPLICE BOX WITH HEAVY DUTY COVER AT THIS LOCATION.
- SPLICE BOX WITH COVER IN 24" SQ. COVERED ENCLOSURE. REFER TO DETAIL 4, UD27.
- IRRIGATION CONTROLLER. REFER TO IRRIGATION DRAWINGS. FIELD VERIFY EXACT LOCATION PRIOR TO ROUGH-IN.

LIGHTING SHEET INDEX:

SHEET	DESCRIPTION:
LE01	GENERAL NOTES & LEGENDS
LE02	LIGHTING PLAN
LE03	LIGHTING PLAN
LE04	LIGHTING PLAN
LE05	LIGHTING PLAN
LE06	LIGHTING PLAN
LE07	LIGHTING PLAN
LE08	LIGHTING PLAN
LE09	LIGHTING PLAN
LE10	LIGHTING PLAN
LE11	LIGHTING PLAN
LE12	LIGHTING PLAN
LE13	LIGHTING PLAN
LE14	LIGHT STANDARD DETAILS
LE15	LIGHT STANDARD DETAILS
LE16	LIGHTING & ELECTRICAL DETAILS
LE17	ELECTRICAL PANEL SCHEDULES
LE18	LCC DETAILS & LUMINAIRE SCHEDULE

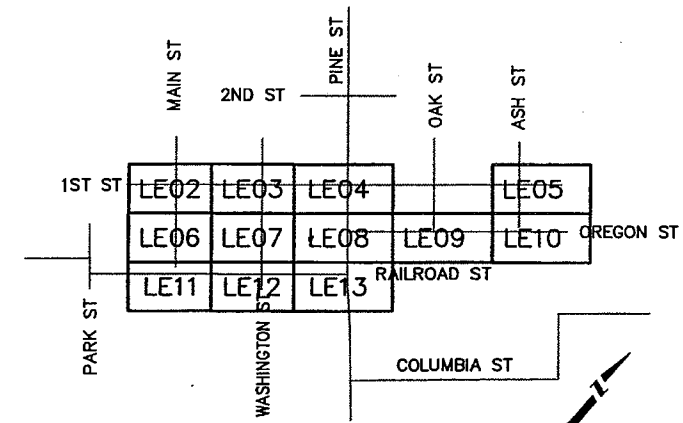

PROJECT KEY MAP:

CLANTON & ASSOCIATES
 LIGHTING DESIGN AND ENGINEERING
 1400 N. W. 11th ST. SUITE 402
 BOULDER, CO 80504
 303-536-7229

Computer File Information		Sheet Revisions		Engineering Department 15327 S. W. Wilamette St. Sherwood, OR 97140 Phone: (503) 925-2305 FAX: (503) 625-0679	Carter-Burgess 707 17th St., Suite 2300 Denver, CO 80202 Phone: (303) 820-5240 FAX: (303) 820-2402	As Constructed		LIGHTING NOTES AND LEGEND		Project No./Code		
Creation Date:	03-24-05 Initials: JE	(R-1)	/ /			No Revisions:	/ /			071668.100		
Last Modification Date:	08-31-05 Initials: GA	(R-2)	/ /			Revised:	/ /	Designer:	GA	Structure	City of Sherwood CIP #C-41	
Path:	E:\SHERWOOD DOWNTOWN\CURRENT\	(R-3)	/ /			Void:	/ /	Detailer:	JE	Numbers	Sheet Number LE01	
Drawing File Name:	LTEBASE.DWG	(R-4)	/ /			Sheet Subset:	LE	Subset Sheets:	01	of 18		
Acad Ver.	R2002 Scale: AS NOTED Units: English	(R-5)	/ /									

FOR REFERENCE ONLY

LIGHT POLES THIS SHIT? 7

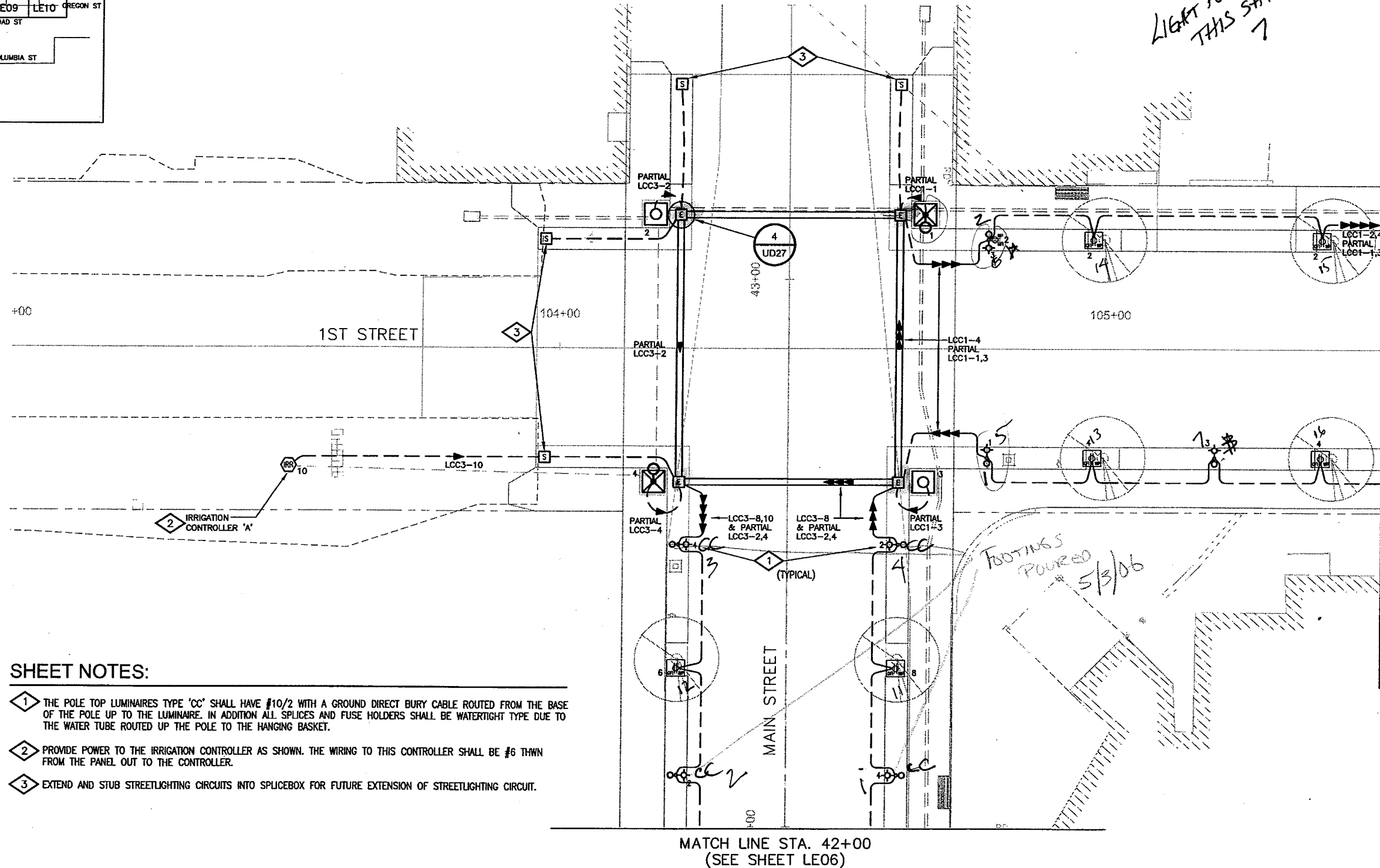
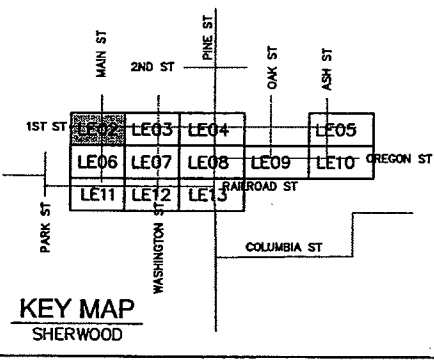

SHEET NOTES:

- 1 THE POLE TOP LUMINAIRES TYPE 'CC' SHALL HAVE #10/2 WITH A GROUND DIRECT BURY CABLE ROUTED FROM THE BASE OF THE POLE UP TO THE LUMINAIRE. IN ADDITION ALL SPLICES AND FUSE HOLDERS SHALL BE WATERTIGHT TYPE DUE TO THE WATER TUBE ROUTED UP THE POLE TO THE HANGING BASKET.
- 2 PROVIDE POWER TO THE IRRIGATION CONTROLLER AS SHOWN. THE WIRING TO THIS CONTROLLER SHALL BE #6 THWN FROM THE PANEL OUT TO THE CONTROLLER.
- 3 EXTEND AND STUB STREETLIGHTING CIRCUITS INTO SPLICEBOX FOR FUTURE EXTENSION OF STREETLIGHTING CIRCUIT.

MATCH LINE STA. 105+50 (SEE SHEET LE03)

MATCH LINE STA. 42+00 (SEE SHEET LE06)

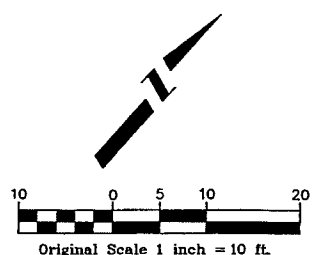

CLANTON & ASSOCIATES
LIGHTING DESIGN AND ENGINEERING
6499 NANTUELO COURT SOUTH STE. 102
BOULDER, CO 80504
303-530-7227

Computer File Information		Sheet Revisions		Sherwood Downtown Streetscape Improvements-Phase A		As Constructed		LIGHTING PLAN		Project No./Code		
Creation Date:	03-24-05	Initials:	JE	/	/	<p>Engineering Department 15527 S. W. Willamette St. Sherwood, OR 97140 Phone: (503) 925-2305 Fax: (503) 625-0679</p> <p>707 17th St., Suite 2300 Denver, CO 80202 Phone: (303) 820-5240 Fax: (303) 820-2402</p>	No Revisions: / /		1ST AND MAIN STREET		071668.100	
Last Modification Date:	08-31-05	Initials:	GA	/	/		Revised: / /		Designer: GA		City of Sherwood CIP #C-41	
Path:	E:\SHERWOOD DOWNTOWN\CURRENT\			/	/		Void: / /		Detailer: JE		Sheet Number	
Drawing File Name:	LITEBASE.DWG			/	/				Sheet Subset: LE		Subset Sheets: 02 of 18	
Acad Ver.:	R2002	Scale:	AS NOTED	/	/						Sheet Number LE02	

FOR REFERENCE ONLY

Light Poles
THIS SHIT.
9

WED,
POLYPOD
3/14/06

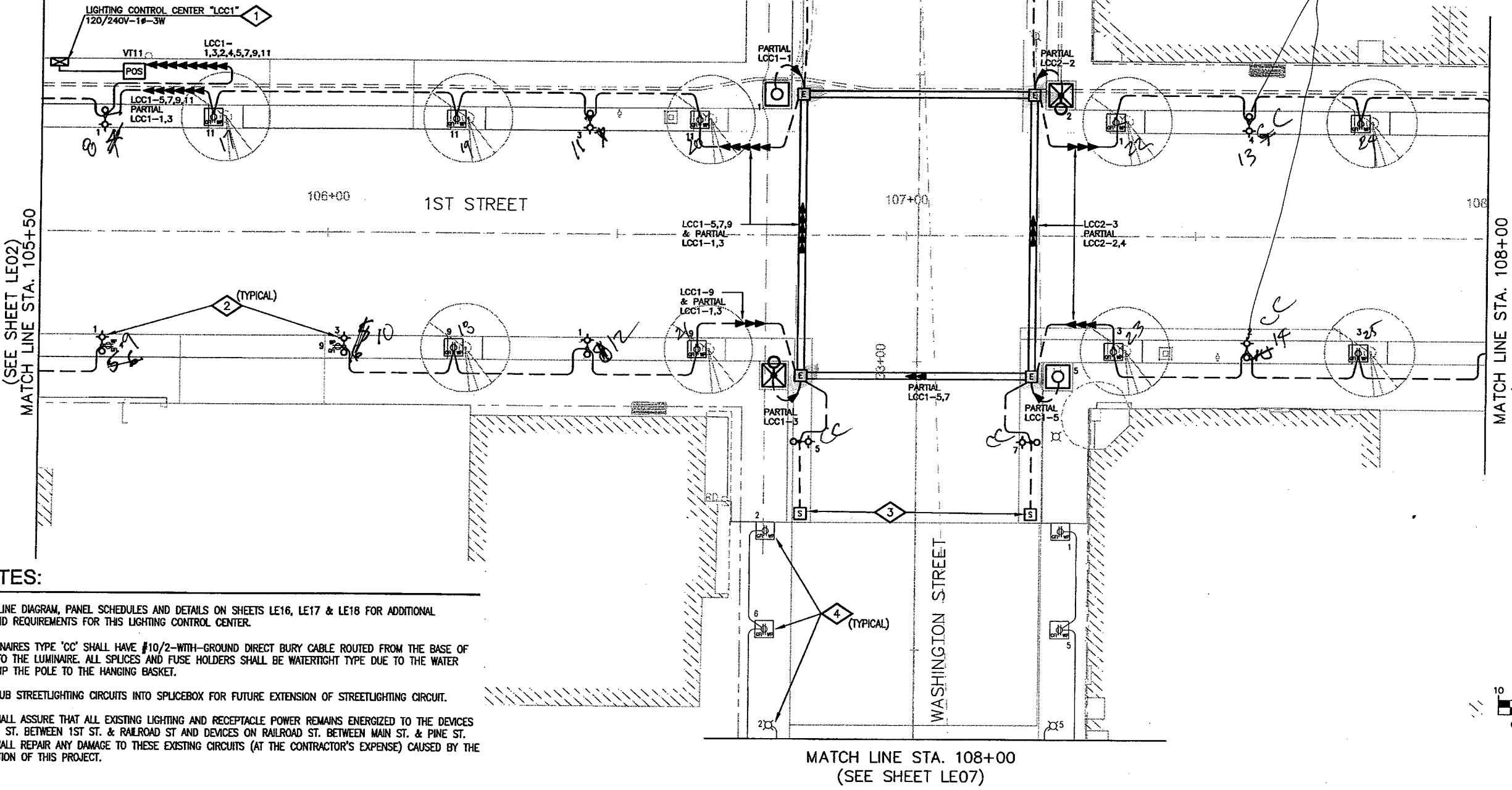
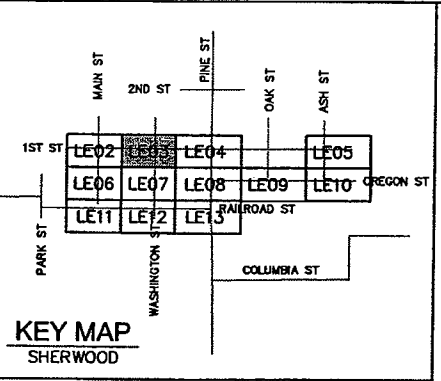

SHEET NOTES:

- 1 SEE THE ONE-LINE DIAGRAM, PANEL SCHEDULES AND DETAILS ON SHEETS LE16, LE17 & LE18 FOR ADDITIONAL INFORMATION AND REQUIREMENTS FOR THIS LIGHTING CONTROL CENTER.
- 2 POLE-TOP LUMINAIRES TYPE 'CC' SHALL HAVE #10/2-WITH-GROUND DIRECT BURY CABLE ROUTED FROM THE BASE OF THE POLE UP TO THE LUMINAIRE. ALL SPLICES AND FUSE HOLDERS SHALL BE WATERTIGHT TYPE DUE TO THE WATER TUBE ROUTED UP THE POLE TO THE HANGING BASKET.
- 3 EXTEND AND STUB STREETLIGHTING CIRCUITS INTO SPLICEBOX FOR FUTURE EXTENSION OF STREETLIGHTING CIRCUIT.
- 4 CONTRACTOR SHALL ASSURE THAT ALL EXISTING LIGHTING AND RECEPTACLE POWER REMAINS ENERGIZED TO THE DEVICES ON WASHINGTON ST. BETWEEN 1ST ST. & RAILROAD ST AND DEVICES ON RAILROAD ST. BETWEEN MAIN ST. & PINE ST. CONTRACTOR SHALL REPAIR ANY DAMAGE TO THESE EXISTING CIRCUITS (AT THE CONTRACTOR'S EXPENSE) CAUSED BY THE NEW CONSTRUCTION OF THIS PROJECT.

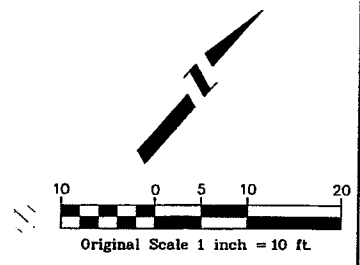

CANTON & ASSOCIATES
LIGHTING DESIGN AND ENGINEERING
4499 NANTUESS COURT, SUITE 102
BOULDER, CO 80504
303-536-7229

Computer File Information		Sheet Revisions		Sherwood Downtown Streetscape Improvements-Phase A		As Constructed		LIGHTING PLAN		Project No./Code			
Creation Date:	03-24-05	Initials:	JE	(R-)	/ /	<p>Engineering Department 15527 S. W. Wilmette St. Sherwood, OR 97140 Phone: (503) 925-2305 FAX: (503) 625-0679</p>	<p>Carter-Burgess</p> <p>707 17th St., Suite 2300 Denver, CO 80202 Phone: (303) 820-5240 FAX: (303) 820-2402</p>	1ST AND WASHINGTON STREET		071668.100			
Last Modification Date:	08-31-05	Initials:	GA	(R-)	/ /			Revised:	/ /	Designer:	GA	Structure	City of Sherwood CIP #C-41
Path:	E:\SHERWOOD DOWNTOWN\CURRENT\			(R-)	/ /			Void:	/ /	Detailer:	JE	Numbers	
Drawing File Name:	LITEBASE.DWG			(R-)	/ /			Sheet Subset:	LE	Sheet Subsets:	03	of 18	
Acad Ver.	R2002	Scale:	AS NOTED	Units:	English						Sheet Number	LE03	

FOR REFERENCE ONLY

LIGHT POLES THIS SHEET. 9

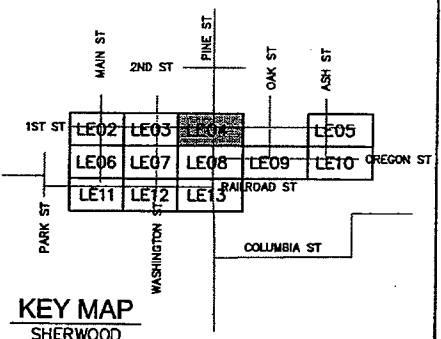

POURED 3/4x6 WED 9

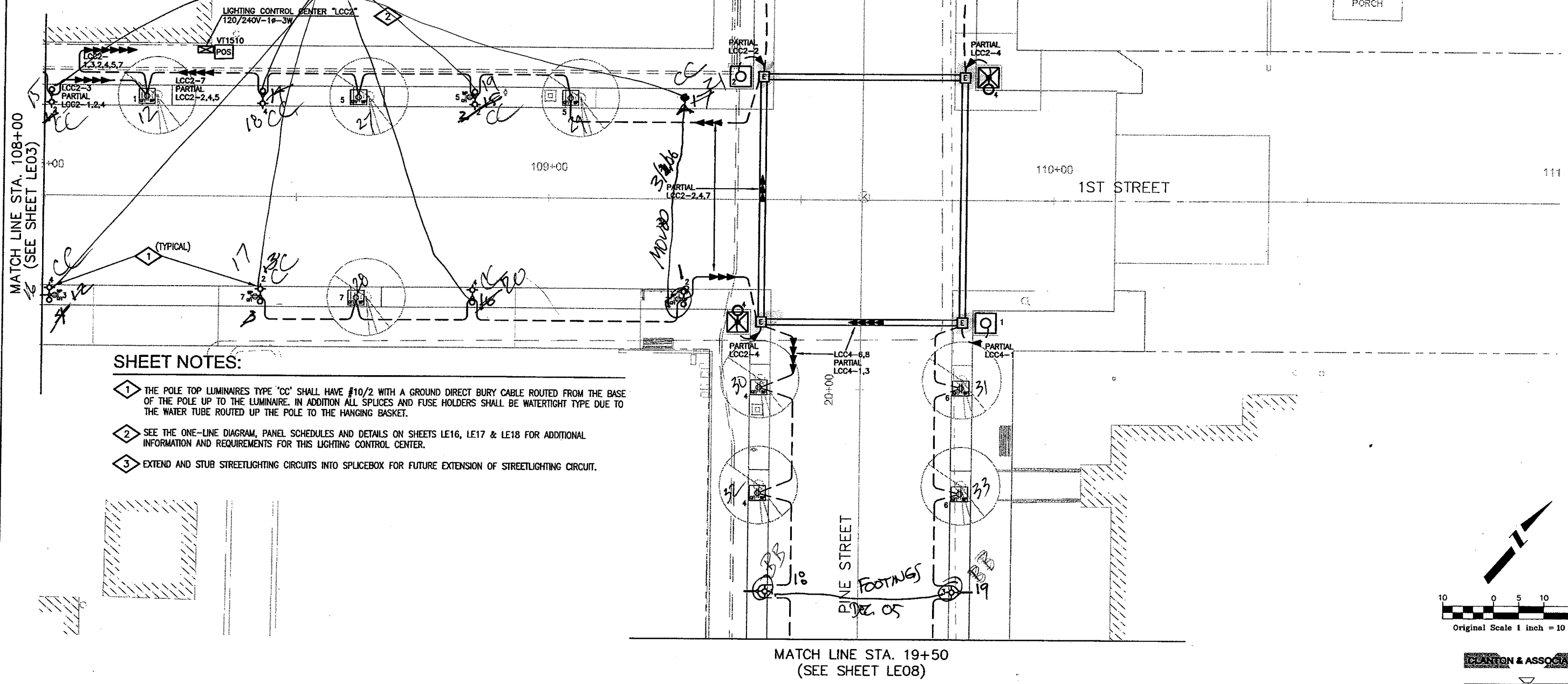

SHEET NOTES:

- 1 THE POLE TOP LUMINAIRE TYPE 'CC' SHALL HAVE #10/2 WITH A GROUND DIRECT BURY CABLE ROUTED FROM THE BASE OF THE POLE UP TO THE LUMINAIRE. IN ADDITION ALL SPLICES AND FUSE HOLDERS SHALL BE WATERTIGHT TYPE DUE TO THE WATER TUBE ROUTED UP THE POLE TO THE HANGING BASKET.
- 2 SEE THE ONE-LINE DIAGRAM, PANEL SCHEDULES AND DETAILS ON SHEETS LE16, LE17 & LE18 FOR ADDITIONAL INFORMATION AND REQUIREMENTS FOR THIS LIGHTING CONTROL CENTER.
- 3 EXTEND AND STUB STREETLIGHTING CIRCUITS INTO SPLICEBOX FOR FUTURE EXTENSION OF STREETLIGHTING CIRCUIT.

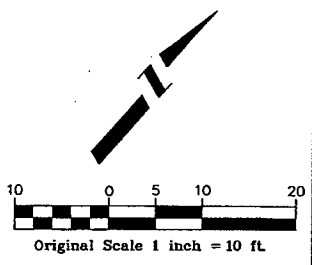
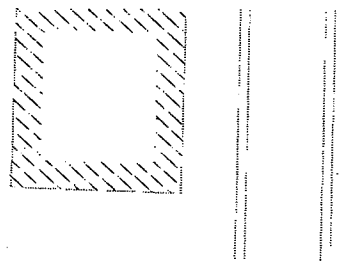

CANTON & ASSOCIATES
LIGHTING DESIGN AND ENGINEERING
4699 PAULUS CREEK SELBY STE. 02
BOULDER, CO 80504
303-530-7229

Computer File Information	
Creation Date:	03-24-05 Initials: JE
Last Modification Date:	08-31-05 Initials: GA
Path:	E:\SHERWOOD DOWNTOWN\CURRENT\
Drawing File Name:	LITEBASE.DWG
Acad Ver. R2002	Scale: AS NOTED Units: English

Sheet Revisions	
(R-)	///
(R-)	///
(R-)	///
(R-)	///
(R-)	///

Sherwood Downtown Streetscape Improvements-Phase A

Engineering Department
15527 S. W. Willamette St.
Sherwood, OR 97140
Phone: (503) 925-2305
FAX: (503) 625-0679

Carter-Burgess

707 17th St., Suite 2300
Denver, CO 80202
Phone: (303) 820-5240
FAX: (303) 820-2402

As Constructed	
No Revisions:	///
Revised:	///
Void:	///

LIGHTING PLAN 1ST AND PINE STREET			
Designer:	GA	Structure	
Detailer:	JE	Numbers	
Sheet Subset:	LE	Subset Sheets:	04 of 18

Project No./Code	
071668.100	
City of Sherwood CIP #C-41	
Sheet Number	LE04

FOR REFERENCE ONLY

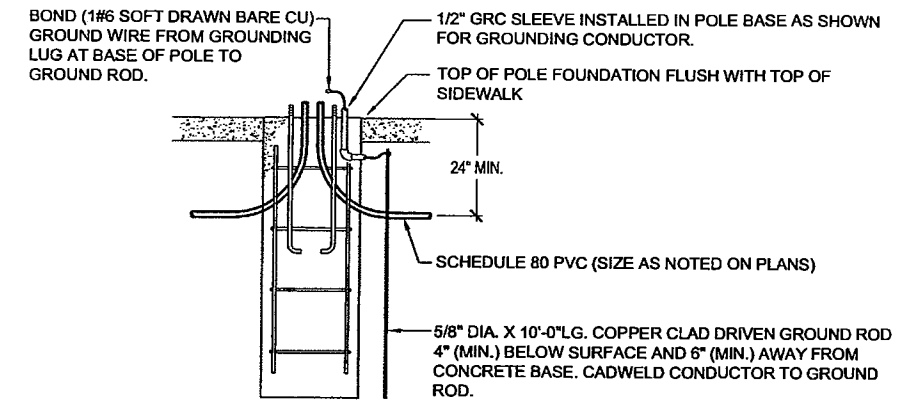

ELEVATION SECTION VIEW

DETAIL NOTES:

1. LIGHT STANDARD FOUNDATION DIMENSIONS AND REINFORCEMENT PER STRUCTURAL ENGINEER STAMPED FOUNDATION DRAWING.
2. DIMENSION FOR ANCHOR BOLT SPACING BY POLE MANUFACTURER.
3. CONTRACTOR SHALL INSTALL A FUSE AND WEATHERPROOF FUSEHOLDER AT EACH POLE BASE.
4. FOUNDATION DETAILS ARE INCLUDED ONLY TO SHOW ELECTRICAL COMPONENTS.
5. CONTRACTOR SHALL ENSURE TOP OF POLE FOUNDATION IS FLUSH WITH TOP OF SIDEWALK.

3 POLE FOUNDATION ELECTRICAL DETAIL LE16 NOT TO SCALE

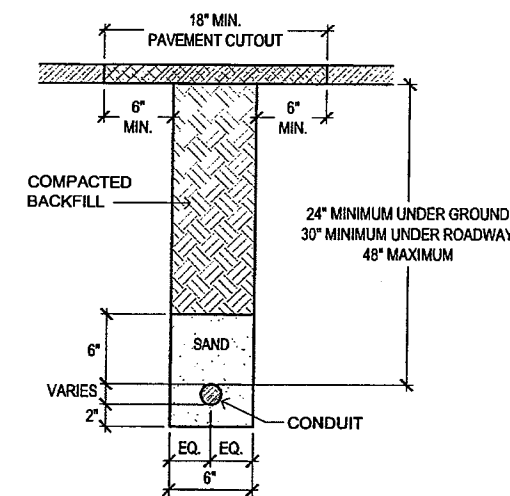

DETAIL NOTES:

1. COORDINATE TRENCHING WITH OTHER UNDERGROUND UTILITIES AND TO USE JOINT TRENCHES WHERE POSSIBLE.
2. COORDINATE IRRIGATION PIPE ROUTING WITH IRRIGATION CONTRACTOR.

2 TYPICAL CONDUIT BURIAL DETAIL (CONDUIT NOT IN JOINT TRENCH) LE16 NOT TO SCALE

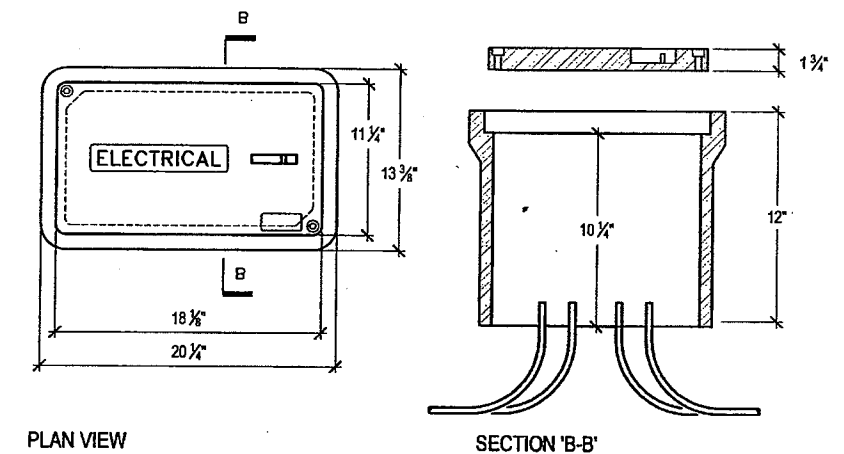

PLAN VIEW

SECTION 'B-B'

SEE PLAN SYMBOL 'S' FOR THE LOCATIONS OF THESE SPLICE BOXES.

SPLICE BOX SHALL BE QUAZITE COMPOSOLITE BOX WITH OPEN BASE #PG1118BA12 AND QUAZITE COMPOSOLITE HEAVY DUTY/TRAFFIC RATED COVER #PG1118HA00 OR APPROVED EQUAL.

1 TYPICAL SPLICE BOX DETAIL LE16 NOT TO SCALE

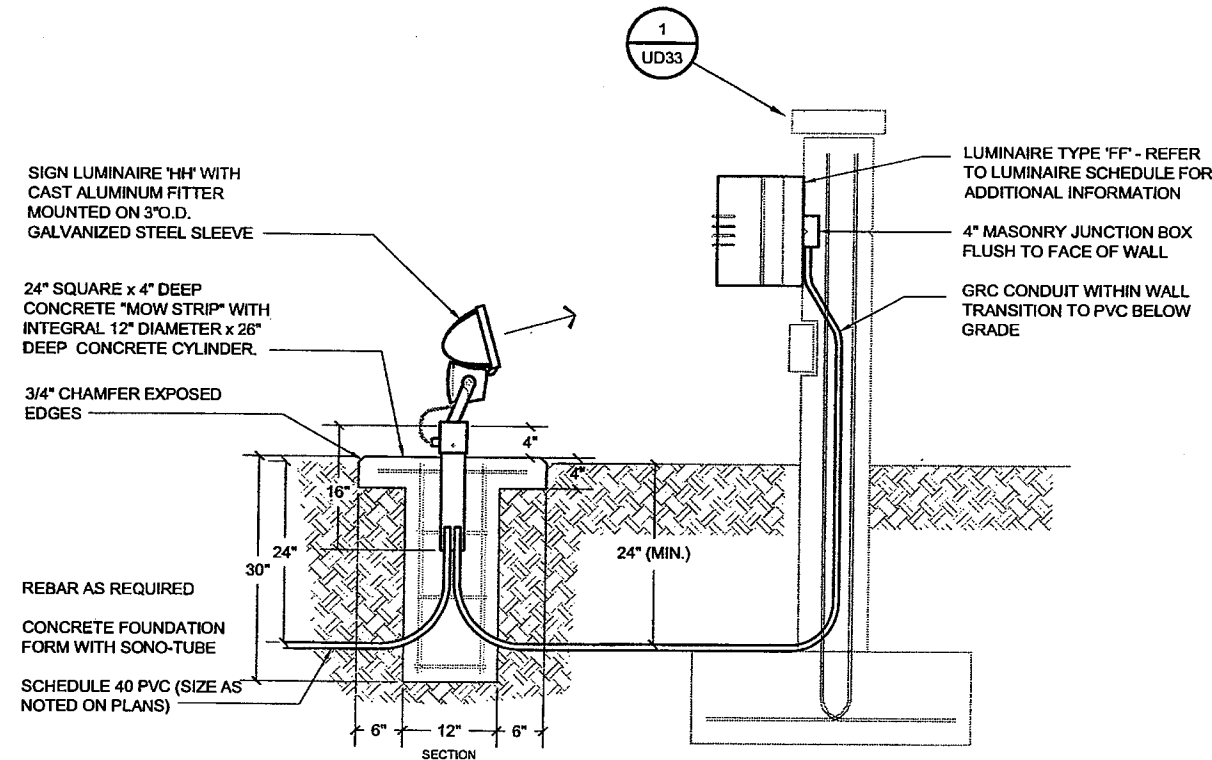

6 DETAIL-TYPE 'FF' & 'HH' AT ENTRY WALL LE16 SCALE: 1"=1'-0"

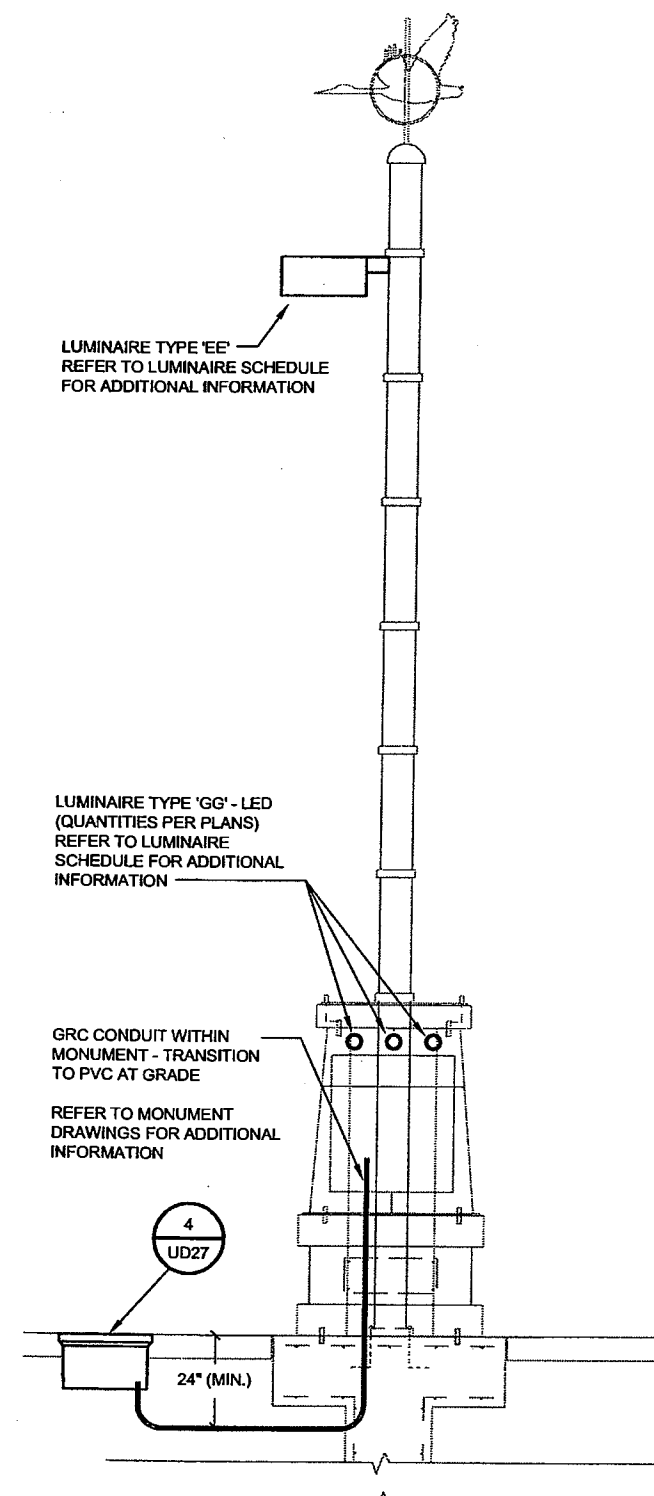

5 MONUMENT ELECTRICAL DETAIL LE16 SCALE: 1/2"=1'-0"

CANTON & ASSOCIATES
LIGHTING DESIGN AND ENGINEERING
1499 NANTUCKET COURT SOUTH STE. 402
BOULDER, CO 80504
303-440-7229

Computer File Information		Sheet Revisions		Sherwood Downtown Streetscape Improvements-Phase A		As Constructed		LIGHTING AND ELECTRICAL DETAILS		Project No./Code	
Creation Date:	03-24-05	Initials:	JE	(R-)	/ /	Engineering Department	15527 S. W. Wilamette St.	15527 S. W. Wilamette St.	GA	Structure	071668.100
Last Modification Date:	08-31-05	Initials:	GA	(R-)	/ /	Sherwood, OR 97140	Phone: (503) 925-2305	Denver, CO 80202	JE	Numbers	City of Sherwood CIP #C-41
Path:	E:\SHERWOOD DOWNTOWN\CURRENT\	(R-)	/ /	(R-)	/ /	Phone: (503) 820-5240	FAX: (503) 625-0679	707 17th St., Suite 2300	LE	Subset Sheets:	16 of 18
Drawing File Name:	LITEBASE.DWG	(R-)	/ /	(R-)	/ /	FAX: (503) 820-2402		Denver, CO 80202			Sheet Number
Acad Ver.	R2002	Scale:	AS NOTED	Units:	English			Phone: (303) 820-5240			LE16
								FAX: (303) 820-2402			

PANEL "LCC1" 120/240 VOLTS 1 Ø 3 W

MINIMUM A.I.C. 10,000 AMPS 100 AMP MAIN

ITEM	SIZE	P	CIR. NO.	LEFT PHASE LOAD		RIGHT PHASE LOAD		CIR. NO.	SIZE	P	ITEM	
				L1	L2	L1	L2					
1st ST. E. of MAIN ST. PED. LTG.	20	1	1	1500		1500		2	20	1	1st ST. E. of MAIN ST. HOLIDAY REC.	
1st ST. E. of MAIN ST. PED. LTG.	20	1	3		825	1500		4	20	1	1st ST. E. of MAIN ST. HOLIDAY REC.	
WASHINGTON S. of 1st ST. PED. LTG.	20	1	5	220		200		6	15	1	IRRIGATION CONTROLLER #4	
WASHINGTON S. of 1st ST. PED. LTG.	20	1	7		60	180		8	15	1	LCC1 MAINT. GFCI RECEPTACLE	
1st ST. E. of MAIN ST. HOLIDAY REC.	20	1	9	1500		200		10	15	1	LCC1 LIGHTING CONTROL	
1st ST. E. of MAIN ST. HOLIDAY REC.	20	1	11		1500			12	20	1	SPARE	
SPACE ONLY								14			SPACE ONLY	
SPACE ONLY								16			SPACE ONLY	
				2380		2385	1900					1680
				4280		4055						1680
				TOTAL CONN. VA								

LOAD	CONNECTED	D.FACT.	EST. KVA	AMPS
LIGHTING	1765VA	1.25	2.21	
RECEPTACLES (1st 10000)	6180VA	1.00	6.18	
RECEPTACLES (REMAINING)		0.50		
MOTOR (LARGEST)		1.25		
MOTORS (REMAINING)		1.00		
ELEC. HEAT/MISC.	400VA	1.00	0.40	
TOTAL ESTIMATED LOAD			8.79	36.6

* VIA LIGHTING CONTACTOR LC11.
 ~ VIA LIGHTING CONTACTOR LC12.

PANEL "LCC4" 120/240 VOLTS 1 Ø 3 W

MINIMUM A.I.C. 10,000 AMPS 100 AMP MAIN

ITEM	SIZE	P	CIR. NO.	LEFT PHASE LOAD		RIGHT PHASE LOAD		CIR. NO.	SIZE	P	ITEM	
				L1	L2	L1	L2					
1st ST. E. of MAIN ST. PED. LTG.	20	1	1	520		1000		2	20	1	1st ST. E. of WASHINGTON ST. HOLIDAY REC.	
1st ST. E. of MAIN ST. PED. LTG.	20	1	3		520	1000		4	20	1	1st ST. E. of WASHINGTON ST. HOLIDAY REC.	
1st ST. E. of WASHINGTON ST. HOLIDAY REC.	20	1	5	1500		1000		6	15	1	1st ST. E. of WASHINGTON ST. HOLIDAY REC.	
1st ST. E. of WASHINGTON ST. HOLIDAY REC.	20	1	7		1500	1000		8	15	1	1st ST. E. of WASHINGTON ST. HOLIDAY REC.	
SPARE	20	1	9			180		10	15	1	LCC4 MAINT. GFCI RECEPTACLE	
SPARE	20	1	11			200		12	20	1	LCC4 LIGHTING CONTROL	
SPACE ONLY								14			SPACE ONLY	
SPACE ONLY								16			SPACE ONLY	
				2020		2020	2180					2200
				4200		4220						2200
				TOTAL CONN. VA								

LOAD	CONNECTED	D.FACT.	EST. KVA	AMPS
LIGHTING	1040VA	1.25	1.30	
RECEPTACLES (1st 10000)	7160VA	1.00	7.16	
RECEPTACLES (REMAINING)		0.50		
MOTOR (LARGEST)		1.25		
MOTORS (REMAINING)		1.00		
ELEC. HEAT/MISC.	200VA	1.00	0.20	
TOTAL ESTIMATED LOAD			8.68	36.2

* VIA LIGHTING CONTACTOR LC41.
 ~ VIA LIGHTING CONTACTOR LC42.

PANEL "LCC2" 120/240 VOLTS 1 Ø 3 W

MINIMUM A.I.C. 10,000 AMPS 100 AMP MAIN

ITEM	SIZE	P	CIR. NO.	LEFT PHASE LOAD		RIGHT PHASE LOAD		CIR. NO.	SIZE	P	ITEM	
				L1	L2	L1	L2					
1st ST. E. of WASHINGTON ST. HOLIDAY REC.	20	1	1	1500		520		2	20	1	1st ST. E. of MAIN ST. PED. LTG.	
1st ST. E. of WASHINGTON ST. HOLIDAY REC.	20	1	3		1500	520		4	20	1	1st ST. E. of MAIN ST. PED. LTG.	
1st ST. E. of WASHINGTON ST. HOLIDAY REC.	20	1	5	1500				6	15	1	SPARE	
1st ST. E. of WASHINGTON ST. HOLIDAY REC.	20	1	7		1500	180		8	15	1	LCC2 MAINT. GFCI RECEPTACLE	
SPARE	20	1	9			200		10	15	1	LCC2 LIGHTING CONTROL	
SPARE	20	1	11					12	20	1	SPARE	
SPACE ONLY								14			SPACE ONLY	
SPACE ONLY								16			SPACE ONLY	
				3000		3000	720					700
				3720		3700						
				TOTAL CONN. VA								

LOAD	CONNECTED	D.FACT.	EST. KVA	AMPS
LIGHTING	1040VA	1.25	1.30	
RECEPTACLES (1st 10000)	6180VA	1.00	6.18	
RECEPTACLES (REMAINING)		0.50		
MOTOR (LARGEST)		1.25		
MOTORS (REMAINING)		1.00		
ELEC. HEAT/MISC.	200VA	1.00	0.20	
TOTAL ESTIMATED LOAD			7.88	32

* VIA LIGHTING CONTACTOR LC21.
 ~ VIA LIGHTING CONTACTOR LC22.

PANEL "LCC5" 120/240 VOLTS 1 Ø 3 W

MINIMUM A.I.C. 10,000 AMPS 100 AMP MAIN

ITEM	SIZE	P	CIR. NO.	LEFT PHASE LOAD		RIGHT PHASE LOAD		CIR. NO.	SIZE	P	ITEM	
				L1	L2	L1	L2					
OREGON ST. E. of PINE ST. PED. LTG.	20	1	1	300		1000		2	20	1	OREGON ST. E. of PINE ST. MEDIAN REC.	
OREGON ST. E. of PINE ST. PED. LTG.	20	1	3		300	1000		4	20	1	OREGON ST. E. of PINE ST. MEDIAN REC.	
SPARE	20	1	5	0		1000		6	20	1	OREGON ST. E. of PINE ST. MEDIAN REC.	
SPARE	20	1	7		0	1000		8	20	1	OREGON ST. E. of PINE ST. MEDIAN REC.	
LCC5 MAINT. GFCI RECEPTACLE	15	1	9	180		500		10	20	1	OREGON ST. E. of PINE ST. MEDIAN REC.	
LCC5 LIGHTING CONTROL	15	1	11		200	500		12	20	1	OREGON ST. E. of PINE ST. MEDIAN REC.	
SPACE ONLY								14			SPACE ONLY	
SPACE ONLY								16			SPACE ONLY	
				480		500	2500					2500
				2980		3000						
				TOTAL CONN. VA								

LOAD	CONNECTED	D.FACT.	EST. KVA	AMPS
LIGHTING	600VA	1.25	0.75	
RECEPTACLES (1st 10000)	5180VA	1.00	5.18	
RECEPTACLES (REMAINING)		0.50		
MOTOR (LARGEST)		1.25		
MOTORS (REMAINING)		1.00		
ELEC. HEAT/MISC.	200VA	1.00	0.20	
TOTAL ESTIMATED LOAD			6.13	25.5

* VIA LIGHTING CONTACTOR LC51.
 ~ VIA LIGHTING CONTACTOR LC52.

PANEL "LCC3" 120/240 VOLTS 1 Ø 3 W

MINIMUM A.I.C. 10,000 AMPS 100 AMP MAIN

ITEM	SIZE	P	CIR. NO.	LEFT PHASE LOAD		RIGHT PHASE LOAD		CIR. NO.	SIZE	P	ITEM	
				L1	L2	L1	L2					
MAIN ST. S. of 1st PED. Holiday REC.	20	1	1	1500		820		2	20	1	MAIN ST. S. of 1st PED. LTG.	
MAIN ST. S. of 1st PED. Holiday REC.	20	1	3		1500	820		4	20	1	MAIN ST. S. of 1st PED. LTG.	
LCC3 MAINT. GFCI RECEPTACLE	15	1	5	180		1500		6	20	1	MAIN ST. S. of 1st PED. Holiday REC.	
LCC3 LIGHTING CONTROL	15	1	7		200	1500		8	20	1	MAIN ST. S. of 1st PED. Holiday REC.	
SPARE	20	1	9			200		10	20	1	IRRIGATION CONTROLLER 'A'	
SPARE	20	1	11					12	20	1	SPARE	
SPACE ONLY								14			SPACE ONLY	
SPACE ONLY								16			SPACE ONLY	
				1680		1700	2520					2320
				4200		4000						
				TOTAL CONN. VA								

LOAD	CONNECTED	D.FACT.	EST. KVA	AMPS
LIGHTING	1640VA	1.25	2.05	
RECEPTACLES (1st 10000)	6180VA	1.00	6.18	
RECEPTACLES (REMAINING)		0.50		
MOTOR (LARGEST)		1.25		
MOTORS (REMAINING)		1.00		
ELEC. HEAT/MISC.	400VA	1.00	0.40	
TOTAL ESTIMATED LOAD			8.63	36

* VIA LIGHTING CONTACTOR LC31.
 ~ VIA LIGHTING CONTACTOR LC32.

PANEL "LCC6" 120/240 VOLTS 1 Ø 3 W

MINIMUM A.I.C. 10,000 AMPS 100 AMP MAIN

ITEM	SIZE	P	CIR. NO.	LEFT PHASE LOAD		RIGHT PHASE LOAD		CIR. NO.	SIZE	P	ITEM	
				L1	L2	L1	L2					
OREGON ST. E. of OAK ST. MEDIAN REC.	20	1	1	1000		500		2	20	1	OREGON ST. E. of OAK ST. PED. LTG.	
OREGON ST. E. of OAK ST. MEDIAN REC.	20	1	3		1000	300		4	20	1	OREGON ST. E. of OAK ST. PED. LTG.	
OREGON ST. E. of OAK ST. MEDIAN REC.	20	1	5	1000		400		6	20	1	MED. SIGN LITS. @ ASP, 1ST & OREGON INTER	
OREGON ST. E. of OAK ST. MEDIAN REC.	20	1	7		1000	400		8	20	1	MONUMENT LITG. N. OF 1ST & OREGON INTER	
LCC6 MAINT. GFCI RECEPTACLE	15	1	9	180		200		10	15	1	IRRIGATION CONTROLLER 'B'	
LCC6 LIGHTING CONTROL	15	1	11		200	200		12	20	1	SPARE	
SPACE ONLY								14			SPACE ONLY	
SPACE ONLY								16			SPACE ONLY	
				2180		2200	1160					1080
				3340		3280						
				TOTAL CONN. VA								

LOAD	CONNECTED	D.FACT.	EST. KVA	AMPS
LIGHTING	2040VA	1.25	2.55	
RECEPTACLES (1st 10000)	4180VA	1.00	4.18	
RECEPTACLES (REMAINING)		0.50		
MOTOR (LARGEST)		1.25		
MOTORS (REMAINING)		1.00		
ELEC. HEAT/MISC.	400VA	1.00	0.40	
TOTAL ESTIMATED LOAD			7.13	29.7

* VIA LIGHTING CONTACTOR LC61.
 ~ VIA LIGHTING CONTACTOR LC62.

QUANTON & ASSOCIATES
 LIGHTING DESIGN AND ENGINEERING
 4699 MARFELS COURT SOUTH STE. 02
 BOULDER, CO 80504
 303-440-7070

Computer File Information

Creation Date:	03-24-05	Initials:	JE
Last Modification Date:	08-31-05	Initials:	GA
Path:	E:\SHERWOOD DOWNTOWN\CURRENT\		
Drawing File Name:	LITBASE.DWG		
Acad Ver.	R2002	Scale:	AS NOTED
Units:	English		

Sheet Revisions

Rev	Description
(R-)	/ /
(R-)	/ /
(R-)	/ /
(R-)	/ /

Sherwood Downtown Streetscape Improvements-Phase A



Engineering Department
 15527 S. W. Willamette St.
 Sherwood, OR 97140
 Phone: (503) 925-2305
 Fax: (503) 625-0679

Carter-Burgess

707 17th St., Suite 2300
 Denver, CO 80202
 Phone: (303) 820-5240
 Fax: (303) 820-2402

As Constructed

No Revisions:	/ /
Revised:	/ /
Void:	/ /

ELECTRICAL PANEL SCHEDULES

Designer:	GA	Structure Numbers:	
Detailer:	JE	Subset Sheets:	17 of 18

Project No./Code

071668.100

City of Sherwood CIP #C-41

Sheet Number LE17

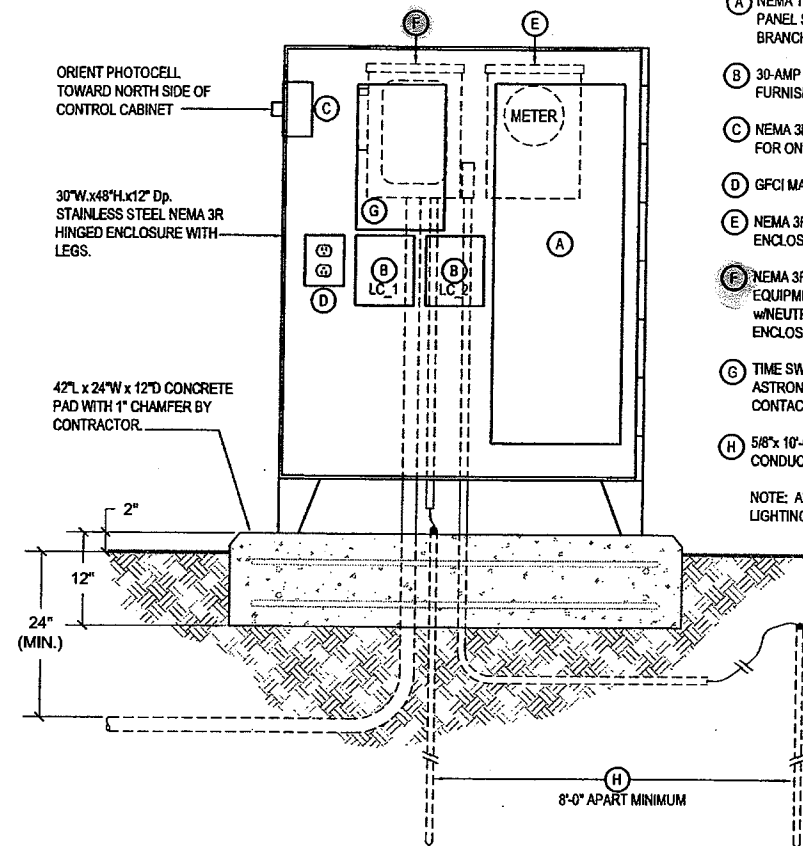

1
LE18 NOT TO SCALE
TYPICAL LIGHTING CONTROL CENTER DETAIL
'LCC1', 'LCC2', 'LCC3', 'LCC4', 'LCC5' & 'LCC6'

COMPONENT LIST

- (A) NEMA 1, 16-POLE 100-AMP MLO 120V/240V 1Ø 3W LOAD CENTER (SEE PANEL SCHEDULE). FURNISH WITH FULL-SIZE GROUND, COVER, AND BRANCH BREAKERS AS LISTED ON THE SCHEDULE.
 - (B) 3Ø-AMP 8-POLE ELECTRICALLY HELD LIGHTING CONTACTOR. FURNISH WITH 120-VOLT COIL. (2) REQUIRED.
 - (C) NEMA 3R 120V PHOTOCELL WITH TWIST-LOCK RECEPTACLE BASE. FOR ON CONTROL OF THE LIGHTING CONTACTORS LC_1 & LC_2.
 - (D) GFCI MAINT. RECEPTACLE IN A 1-GANG BACK BOX WITH COVER.
 - (E) NEMA 3R, 125A, 1Ø METER HOUSING MOUNTED ON BACK SIDE OF ENCLOSURE.
 - (F) NEMA 3R, 60A, 2-POLE FUSED DISCONNECT, UL LISTED FOR SERVICE EQUIPMENT AND FRN FUSES AS SHOWN ON ONE-LINE DIAGRAM w/NEUTRAL & GROUND BARS. MOUNTED ON BACK SIDE OF ENCLOSURE.
 - (G) TIME SWITCH, 2-CHANNEL, 120V CONTROLS, 10A CONTACTS, ASTRONOMICAL TIME CLOCK. FOR OFF CONTROL OF THE LIGHTING CONTACTORS LC_1 & LC_2.
 - (H) 5/8" x 10'-0" Lg. COPPER-CLAD DRIVEN GROUND ROD WITH GROUND CONDUCTOR CADWELDED TO ROD. (2) REQUIRED.
- NOTE: ALL COMPONENTS LISTED SHALL BE INCLUDED IN THE LIGHTING CONTROL CENTER PAY ITEM.

LUMINAIRE SCHEDULE

TYPE	MANUF / MODEL	LAMP	VOLTAGE	FINISH	DESCRIPTION
AA	LUMEC LUM: DMS50-55QL-SCB3M-120-RAL5001 POLE: SPR5D-19-RAL5001 ARM: M20M-1A-RAL5001 REF: LUMEC #LMS35041A	PHILIPS LIGHTING 55W QL (3000K)	120	CUSTOM RAL 5001	PEDESTRIAN LIGHTING ASSEMBLY WITH 5" DIAMETER POLE, DECORATIVE ARM AND LUMINAIRE. FURNISH LUMINAIRE WITH 55-WATT, 3000K INDUCTION LAMP.
BB	LUMEC LUM: DMS50-55QL-SCB3M-120-RAL5001 POLE: SPR5D-19-RAL5001 ARM: M20M-2-RAL5001 REF: LUMEC #LMS35041B	PHILIPS LIGHTING 55W QL (3000K)	120	CUSTOM RAL 5001	PEDESTRIAN LIGHTING ASSEMBLY WITH 5" DIAMETER POLE, DECORATIVE TWIN ARM AND LUMINAIRE. FURNISH LUMINAIRE WITH 55-WATT, 3000K INDUCTION LAMP. COMPLETE ARM ASSEMBLY MUST INCLUDE MOUNTING HARDWARE FOR FUTURE BANNER. BANNER TO BE FURNISHED AS PART OF CONTRACT BUT NOT WITH LIGHT BY LUMEC.
CC	LUMEC LUM: DMS50-55QL-SCB3M-120-RAL5001 POLE: SPR5D-19-RAL5001 ARM: M20M-2-RAL5001 REF: LUMEC #LMS35041C	PHILIPS LIGHTING 55W QL (3000K)	120	CUSTOM RAL 5001	PEDESTRIAN LIGHTING ASSEMBLY WITH 5" DIAMETER POLE, DECORATIVE TWIN ARM AND LUMINAIRE. FURNISH LUMINAIRE WITH 55-WATT, 3000K INDUCTION LAMP. COMPLETE ASSEMBLY MUST INCLUDE MOUNTING HARDWARE FOR FUTURE FLOWER BASKET AND NECESSARY OPENINGS FOR WATER LINE. WATER LINE TUBING TO BE FURNISHED AND INSTALLED BY IRRIGATION CONTRACTOR.
DD	LUMEC POLE: SPR5D-19-RAL5001 ARM: M20M-2-RAL5001 REF: LUMEC #LMS35042A	N/A	N/A	CUSTOM RAL 5001	5" DIAMETER POLE WITH TWIN ARM ASSEMBLY. COMPLETE ASSEMBLY MUST INCLUDE ATTACHMENT HARDWARE FOR BANNERS. BANNERS TO BE FURNISHED AS PART OF CONTRACT BUT NOT WITH LIGHT BY LUMEC. SEE LIGHTING DETAILS FOR ADDITIONAL INFORMATION. VERIFY BANNER DIMENSIONS WITH OWNER PRIOR TO FABRICATION.
EE	GARDCO LUM: CA-17-1-3-150MH-120-SC(RAL5001)	(1) OSRAM SYLVANIA MCP150/C/U/MED/830	120	CUSTOM RAL 5001	150-WATT ROADWAY LUMINAIRE TO BE MOUNTED ON 9-INCH O.D. POLE AT INTERSECTION MONUMENTS. SEE MONUMENT DRAWINGS FOR ADDITIONAL INFORMATION. FURNISH LUMINAIRE WITH PHOSPHOR-COATED, 3000K, CERAMIC METAL HALIDE LAMP AND CWA BALLAST.
FF	ARCHITECTURAL AREA LIGHTING E-SCONCE SERIES ES3-CFX(2/32)-LAG	(2) OSRAM SYLVANIA CF32DT/E/IN/830	120		WALL MOUNTED SCONCE. FURNISH LUMINAIRE WITH (2) COMPACT FLUORESCENT LAMPS AND LUMINOUS ACRYLIC RIBS.
GG	BRUCK LIGHTING ORION ARA 15 135502 / F	LED	120		RECESSED LED LUMINAIRE. FURNISH LUMINAIRE WITH BLUE LED'S, STAINLESS STEEL HOUSING, INTEGRAL POWER SUPPLY AND FROSTED LENS. SEE MONUMENT DRAWINGS FOR ADDITIONAL INFORMATION.
HH	WE-EF LIGHTING FLB440 676-1331/669-9332	(1) OSRAM SYLVANIA CF26DT/E/835	120	RAL 5001	COMPACT FLUORESCENT SIGNLIGHT WITH WIDE BEAM DISTRIBUTION. FURNISH LUMINAIRE WITH LOW-TEMPERATURE STARTING BALLAST AND ACCESSORY CAP FOR 3" O.D. TENON MOUNTING.

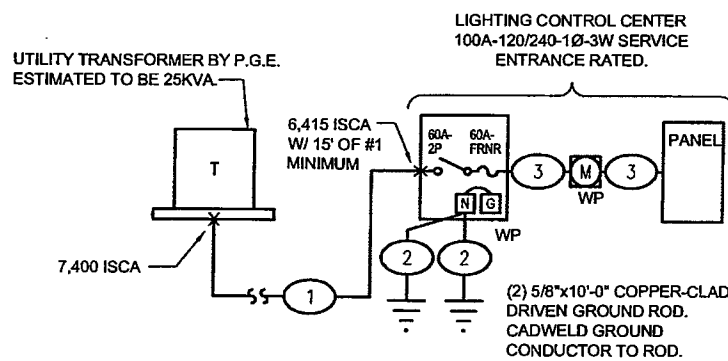

2
LE18 NOT TO SCALE
TYPICAL ONE-LINE DIAGRAM
'LCC1', 'LCC2', 'LCC3', & 'LCC4'

FEEDER SCHEDULE

- 1 (3#1XHHW) 2" PVC CONDUIT
- 2 (1#6 BARE COPPER)
- 3 (3#4THWN & 1#8GND) 1 1/2"



Computer File Information		Sheet Revisions		Sherwood Downtown Streetscape Improvements-Phase A		As Constructed		LCC DETAILS AND LUMINAIRE SCHEDULE		Project No./Code	
Creation Date:	03-24-05 Initials: JE	(R)	/ /	Engineering Department 15527 S. W. Wilamette St. Sherwood, OR 97140 Phone: (503) 925-2305 FAX: (503) 625-0679		No Revisions: / /		Designer: GA Detailer: JE Sheet Subset: LE		071668.100	
Last Modification Date:	08-31-05 Initials: GA	(R)	/ /			Revised: / /				City of Sherwood CIP #C-41	
Path:	E:\SHERWOOD DOWNTOWN\CURRENT\	(R)	/ /			Void: / /				Subset Sheets: 18 of 18	
Drawing File Name:	LITEBASE.DWG	(R)	/ /							Sheet Number LE18	
Acad Ver. R2002	Scale: AS NOTED Units: English	(R)	/ /								

Carter-Burgess

707 17th St., Suite 2300
 Denver, CO 80202
 Phone: (303) 820-5240
 FAX: (303) 820-2402

FOR REFERENCE ONLY

UTILITY CONTACTS

TUALATIN VALLEY WATER DISTRICT	RYAN SMITH	503-848-3057
NORTHWEST NATURAL GAS	BOB KELLER	503-226-4211 EXT. 3046
VERIZON-TELEPHONE	SEAN O'KANE	503-641-4463
COMCAST-CABLE	GERALD BACKHAUS	503-605-4834
PORTLAND GENERAL ELECTRIC-POWER	RALPH REISBECK BRIAN MOORE	503-570-4409 503-570-4406
CITY FIBER OPTIC	BRAD CRAWFORD	503-625-4203
CITY SANITARY SEWER & STORM SEWER	CRAIG SHELDON	503-925-2310

ABBREVIATIONS

D.I.P.	DUCTILE IRON PIPE
B.O.	BLOWOFF
G.V.	GATE VALVE
B.F.V.	BUTTERFLY VALVE
FLG.	FLANGE
M.J.	MECHANICAL JOINT (FITTING)
T.V.W.D.	TUALATIN VALLEY WATER DISTRICT
T.O.P.	TOP OF PIPE
T.B.	THRUST BLOCK

UTILITY NOTES

1. THE UNDERGROUND UTILITIES SHOWN HAVE BEEN LOCATED FROM LOCATE PAINT MARKINGS TIED IN THE FIELD SURVEY AND AS-BUILT DRAWINGS PROVIDED BY UTILITY COMPANIES. THIS SURVEY DOES NOT SHOW ANY PAINT MARKINGS PROVIDED AFTER THE FIELD SURVEY WAS COMPLETED. AS-BUILT DRAWING INFORMATION THAT WAS NOT PROVIDED IS NOT REFLECTED ON THIS SURVEY. AS-BUILT INFORMATION, IF PROVIDED, WAS USED TO IDENTIFY UNDERGROUND PIPE SIZE AND TYPE. IF NO LOCATE PAINT MARKINGS WERE PROVIDED, AS-BUILT INFORMATION WAS USED TO HORIZONTALLY LOCATE THE UNDERGROUND UTILITIES. THIS SURVEY MAKES NO GUARANTEES THAT THE UNDERGROUND UTILITIES SHOWN COMPRISE OF ALL SUCH UTILITIES IN THE AREA. THE UNDERGROUND UTILITIES SHOWN MAY NOT BE IN THE EXACT LOCATION AS NOTED ON THIS SURVEY, BUT ARE LOCATED AS ACCURATELY AS POSSIBLE FROM THE INFORMATION PROVIDED. MANHOLES OTHER THAN SANITARY AND STORM SEWER WERE IDENTIFIED BY MANHOLE LIDS AND MAY NOT BE LABELED CORRECTLY. UTILITY LOCATIONS SHOULD BE VERIFIED BY OREGON UTILITIES NOTIFICATION CENTER IMMEDIATELY PRIOR TO ANY EXCAVATION.
 2. THE CONTRACTOR SHALL CONSTRUCT TRENCHES, VAULTS, AND PEDESTALS AT THE LOCATIONS SHOWN ON THE PLANS. DEVIATIONS FROM THESE LOCATIONS REQUIRES APPROVAL OF THE ENGINEER.
 3. JOINT TRENCHES SHALL BE MADE TO ACCOMMODATE THE MINIMUM RADIUS REQUIRED FOR CONDUIT INSTALLATION. THE MINIMUM RADIUS IS NOT REPRESENTED ON THESE SCHEMATIC DRAWINGS. THE CONTRACTOR SHALL VERIFY THAT MINIMUM RADIUS REQUIREMENTS ARE MET PRIOR TO PLACING VAULTS.
 4. THE CONTRACTOR SHALL PROTECT EXISTING UTILITIES BY USING EVERY REASONABLE MEANS, INCLUDING FIELD LOCATION OF THE UTILITY. REPAIR OF DAMAGE TO THE EXISTING UTILITIES DURING CONSTRUCTION SHALL BE THE RESPONSIBILITY OF THE CONTRACTOR.
 5. EXISTING POWER POLES AND LINES DESIGNATED FOR REMOVAL ON THE "DM" SHEETS WILL BE REMOVED BY THE APPROPRIATE UTILITY AGENCY. CONTRACTOR SHALL COORDINATE WITH AGENCIES FOR REMOVAL OF THESE ELEMENTS.
 6. RESETS AND ADJUSTMENTS ARE SHOWN ON "DM" SHEETS.
 7. EXISTING UTILITIES SHOWN ON THE PLANS ARE PER SURFACE LOCATIONS AND AS BUILT DRAWINGS. THE CONTRACTOR SHALL VERIFY THE EXACT LOCATIONS AND ELEVATIONS OF ALL EXISTING UTILITIES PRIOR TO CONSTRUCTION TO AVOID POTENTIAL CONFLICTS.
- EXCAVATOR(S) MUST COMPLY WITH O.R.S. 757.542 THROUGH 757.562. EXCAVATOR(S) SHALL NOTIFY OREGON UTILITY NOTIFICATION CENTER FOR LINE LOCATIONS AT LEAST TWO, BUT NOT MORE THAN TEN, BUSINESS DAYS PRIOR TO START OF WORK. DAMAGE TO UTILITIES SHALL BE CORRECTED AT THE CONTRACTOR'S EXPENSE.
OREGON UTILITY NOTIFICATION CENTER-PH. 1-800-332-2344.
- COORDINATE UTILITY RELOCATIONS WITH PGE FOR POWER, VERIZON FOR TELEPHONE, NW NATURAL GAS, COMCAST FOR CABLE, TUALATIN VALLEY WATER DISTRICT FOR WATER, AND THE CITY OF SHERWOOD FOR SANITARY, STORM SEWER, AND CITY FIBER OPTIC.
8. STATIONS, OFFSETS AND ELEVATIONS AS CALLED OUT ON THE PLANS ARE TO THE CENTER OF VAULT OR PEDESTAL AT FINISHED GRADE.

SANITARY SEWER NOTES

1. CONTRACTOR SHALL FOLLOW THE "GENERAL SPECIFICATIONS FOR SANITARY SEWER AND STORM SYSTEMS", CLEAN WATER SERVICES, MARCH 2004 OR UPDATED, AND CITY OF SHERWOOD STANDARD CONSTRUCTION DRAWINGS.
2. STATIONS AND OFFSETS ARE TO CENTER OF MANHOLE.

WATER LINE NOTES

1. TUALATIN VALLEY WATER DISTRICT WATER SYSTEM STANDARDS (REVISED 3-20-02) AND SPECIFICATIONS THEREIN CONTROL WATER LINE CONSTRUCTION ON THIS PROJECT.
2. 2" BLOWOFFS SHALL BE INSTALLED FOR TESTING PURPOSES AS INDICATED ON THE PLANS AND REMOVED AFTER TESTING IS COMPLETE. INSTALLATION AND REMOVAL OF THESE BLOWOFFS SHALL NOT BE PAID FOR SEPARATELY, BUT SHALL BE INCLUDED IN THE WORK.
3. UNLESS OTHERWISE NOTED ON THE PLANS MINIMUM DEPTH OF COVER TO TOP OF WATER LINE PIPE SHALL BE 3 FEET.
4. DEFLECT JOINTS AS NECESSARY PER T.V.W.D. STANDARDS TO MAINTAIN MINIMUM CLEARANCE FOR EXISTING UTILITIES.
5. PROVIDE MINIMUM 18" VERTICAL CLEARANCE BETWEEN WATER LINE AND ALL OTHER CROSSING UTILITIES UNLESS OTHERWISE NOTED ON THE PLANS.
6. ALL ELEVATIONS STATED ON THE WATER LINE PLANS ARE TO THE TOP OF PIPE (T.O.P.) UNLESS OTHERWISE NOTED.

PROPOSED UTILITY FEATURES

— — — — —	UTILITY CONDUIT
— W — — — —	WATER LINE
⊗	GATE VALVE
⊕	BUTTERFLY VALVE
⊕	FITTING WITH THRUST BLOCK
⊕	REDUCER
⊕	FIRE HYDRANT
— SS — — — —	SANITARY SEWER
●	MANHOLE
○	CLEANOUT
— — — — —	STORM SEWER
■	PGE - 504
■	PGE - 577
□	PGE - 1730-26
■	CITY FIBER OPTIC - 233
■	COMCAST - SPH 1730
○	COMCAST - SPH 920

Computer File Information		Sheet Revisions		Sherwood Downtown Streetscape Improvements-Phase A		As Constructed		UTILITY GENERAL NOTES AND LEGEND		Project No./Code					
Creation Date:	09/08/04	Initials:	DLL	(R-)	/ /	 Engineering Department 15527 S. W. Willamette St. Sherwood, OR 97140 Phone: (503) 925-2305 FAX: (503) 625-0679	Carter Burgess 707 17th St., Suite 2300 Denver, CO 80202 Phone: (303) 820-5240 FAX: (303) 820-2402	No Revisions:	/ /	Designer:	Lockhart	Structure		Project No./Code	071668.100
Last Modification Date:	09/01/05	Initials:	FA	(R-)	/ /			Revised:	/ /	Detailer:	Lockhart	Numbers		City of Sherwood CIP #C-41	
Path:	J:_TRANSPORTATION\071668.100\CAD\CIV\SHI\UTILITY\			(R-)	/ /			Void:	/ /	Sheet Subset:		Subset Sheets:		Sheet Number	U00
Drawing File Name:	UTGEN01.DWG			(R-)	/ /										
Acad Ver.	R16.0s	Scale:	NTS	Units:	English										

FOR REFERENCE ONLY

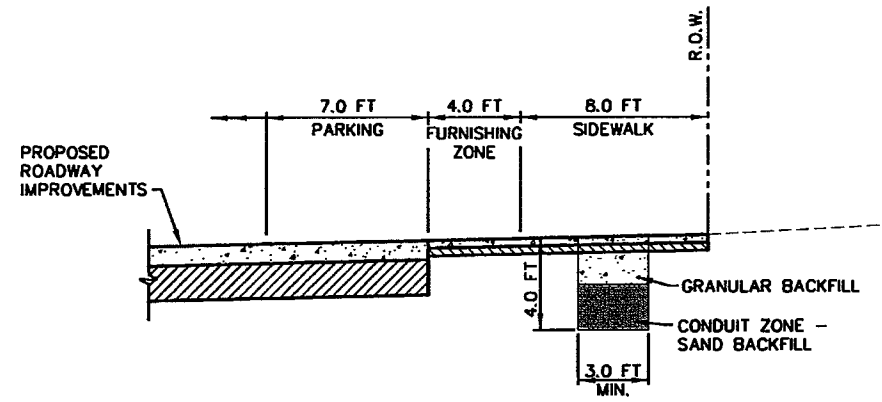

MISC. UTILITIES TRENCH LOCATION WITHIN SIDEWALK

TYPICAL SECTION
THIS SECTION IS SCHEMATIC AND FOR INFORMATIONAL PURPOSES.
NTS

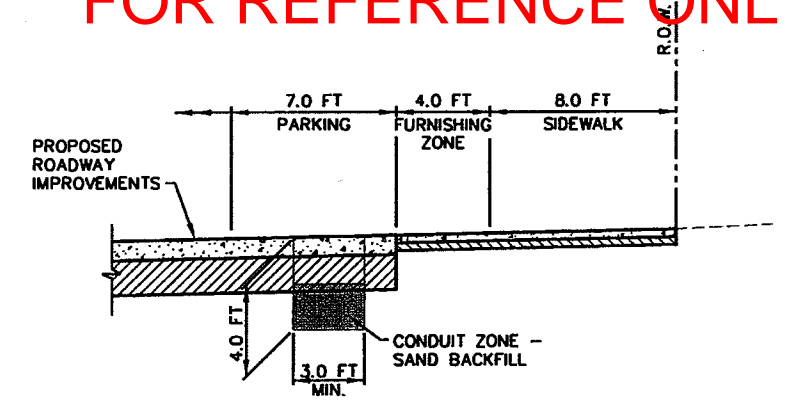

MISC. UTILITIES TRENCH LOCATION WITHIN ROADWAY

TYPICAL SECTION
THIS SECTION IS SCHEMATIC AND FOR INFORMATIONAL PURPOSES.
NTS

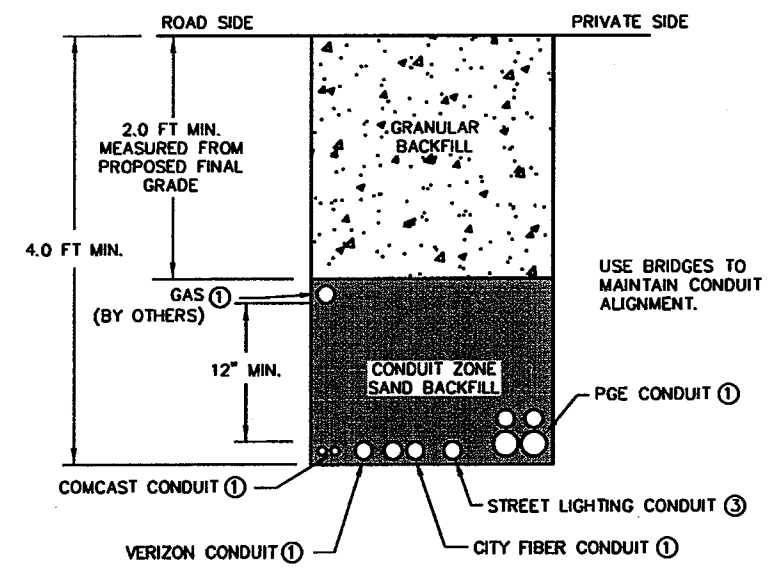

MISC. UTILITIES JOINT TRENCH

TYPICAL SECTION
THIS SECTION IS SCHEMATIC AND FOR INFORMATIONAL PURPOSES.
NTS

- NOTE: ① UTILITIES IN JOINT TRENCH VARY BY PROJECT AREA. SEE PLANS FOR LOCATIONS AND SIZES OF CONDUIT FOR EACH UTILITY.
② CONDUIT SIZE VARIES, SEE PLANS FOR LOCATIONS.
③ SEE LIGHTING PLANS FOR SIZE AND LOCATIONS.

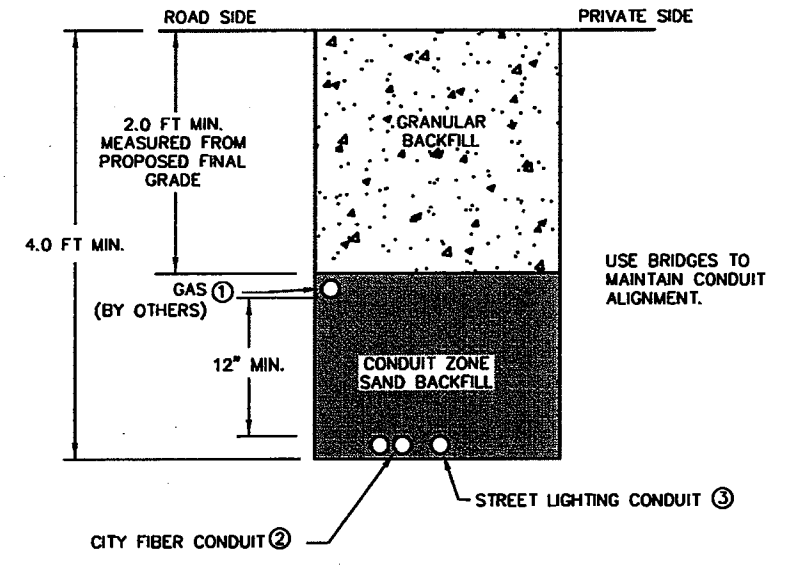

CITY FIBER OPTIC & LIGHTING TRENCH

TYPICAL SECTION
THIS SECTION IS SCHEMATIC AND FOR INFORMATIONAL PURPOSES.
NTS

Computer File Information		Sheet Revisions		Sherwood Downtown Streetscape Improvements-Phase A		As Constructed		UTILITY TRENCH DETAILS		Project No./Code				
Creation Date:	09/08/04 Initials: DLL	(R-)	/ /		Engineering Department 15527 S. W. Wilkomette St. Sherwood, OR 97140 Phone: (503) 925-2305 FAX: (503) 625-0679	Carter=Burgess 707 17th St., Suite 2300 Denver, CO 80202 Phone: (303) 620-5240 FAX: (303) 620-2402	No Revisions:	/ /	071668.100					
Last Modification Date:	09/08/05 Initials: KI	(R-)	/ /				Revised:	/ /	Designer:	Lockhart	Structure		City of Sherwood CIP #C-41	
Path:	J:_TRANSPORTATION\071668.100\CAD\CIV\SHI\UTILITY\	(R-)	/ /				Void:	/ /	Detailer:	Lockhart	Numbers		Sheet Number	U00A
Drawing File Name:	UT_TYPSECTIONS_01ADD1.DWG	(R-)	/ /				Sheet Subset:		Sheet Subset:		Subset Sheets:			
Acad Ver. R16.0s	Scale: NTS Units: English	(R-)	/ /											

FOR REFERENCE ONLY

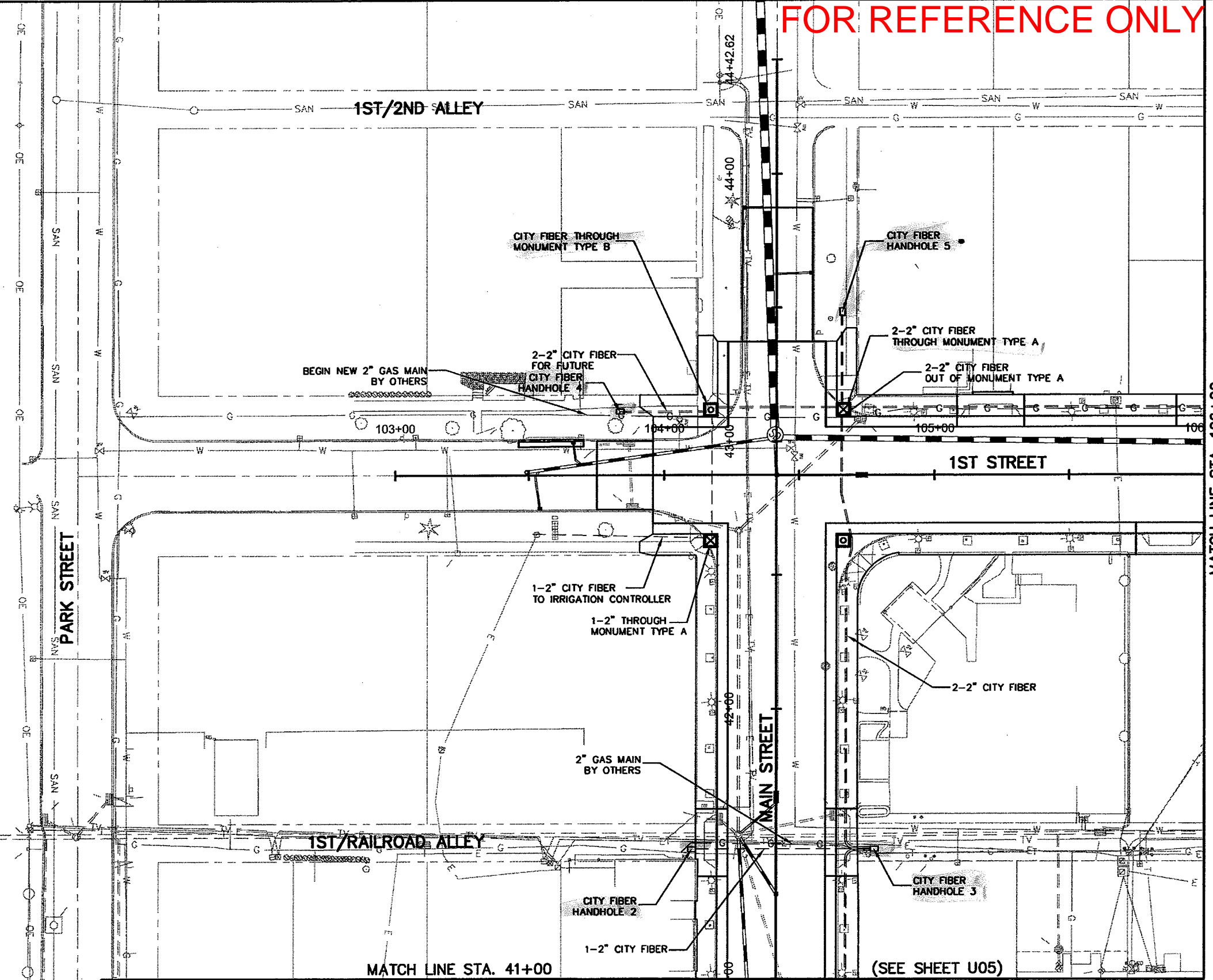
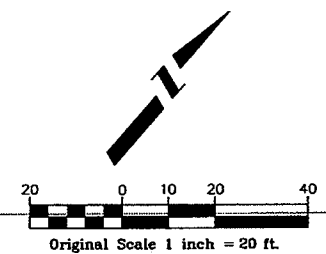
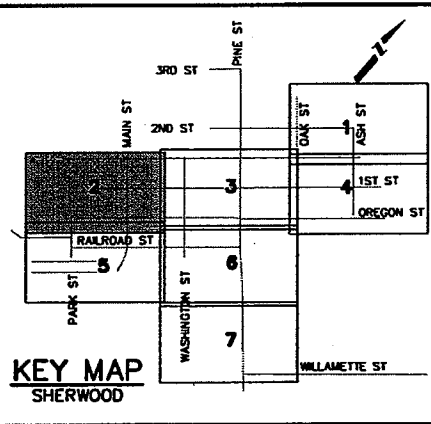

VAULT/PEDESTAL	TYPE	STATION	OFFSET	ELEVATION
CITY FIBER # 2	1730-26	41+47.91	31.49' LT	192.5
CITY FIBER # 3	1730-26	41+48.03	36.0' RT	193.0
CITY FIBER # 4	1730-26	103+83.65	23.9' LT	194.5
CITY FIBER # 5	1730-26	43+48.44	24.1' RT	194.6

MATCH LINE STA. 106+00
(SEE SHEET U03)

(SEE SHEET U05)

Computer File Information		Sheet Revisions		Sherwood Downtown Streetscape Improvements-Phase A		As Constructed		UTILITY RELOCATION PLAN		Project No./Code	
Creation Date:	Initials:	(R-)	/ /		Carter-Burgess Engineering Department 15527 S. W. Wilamette St. Sherwood, OR 97140 Phone: (503) 925-2305 FAX: (503) 625-0679	No Revisions: / /		Designer: LG		071668.100	
Last Modification Date:	Initials:	(R-)	/ /			Revised: / /		Detailer: DB		City of Sherwood CIP #C-41	
Path:		(R-)	/ /			Void: / /		Sheet Subset:		Structure Numbers	
Drawing File Name:		(R-)	/ /					Subset Sheets:		Sheet Number	
Acad Ver. R16.0s	Scale:	Units:	English							U02	

FOR REFERENCE ONLY

VAULT/PEDESTAL	TYPE	STATION	OFFSET	ELEVATION
CITY FIBER # 6	233	18+95.93	87.3' LT	196.1
CITY FIBER # 7	233	509+44.28	31.6' LT	197.7
CITY FIBER # 8	1730-26	33+75.64	24.3' RT	196.5
CITY FIBER # 9	1730-26	21+08.92	26.0' LT	195.8
COMCAST # 1	920	510+11.14	31.7' LT	197.5
COMCAST # 2	920	33+75.35	25.3' LT	196.3
PGE # 1	660	19+13.51	26.4' LT	196.1
PGE # 1A	233	18+95.65	69.0' LT	196.1
PGE # 2	1730-26	509+44.28	31.6' LT	197.8
PGE # 3	577	509+70.69	27.1' LT	197.6
PGE # 4	1730-26	510+67.00	30.5' LT	197.5
PGE # 5		510+90.12	31.3' LT	
VERIZON #1		509+29.98	3.7' RT	197.3

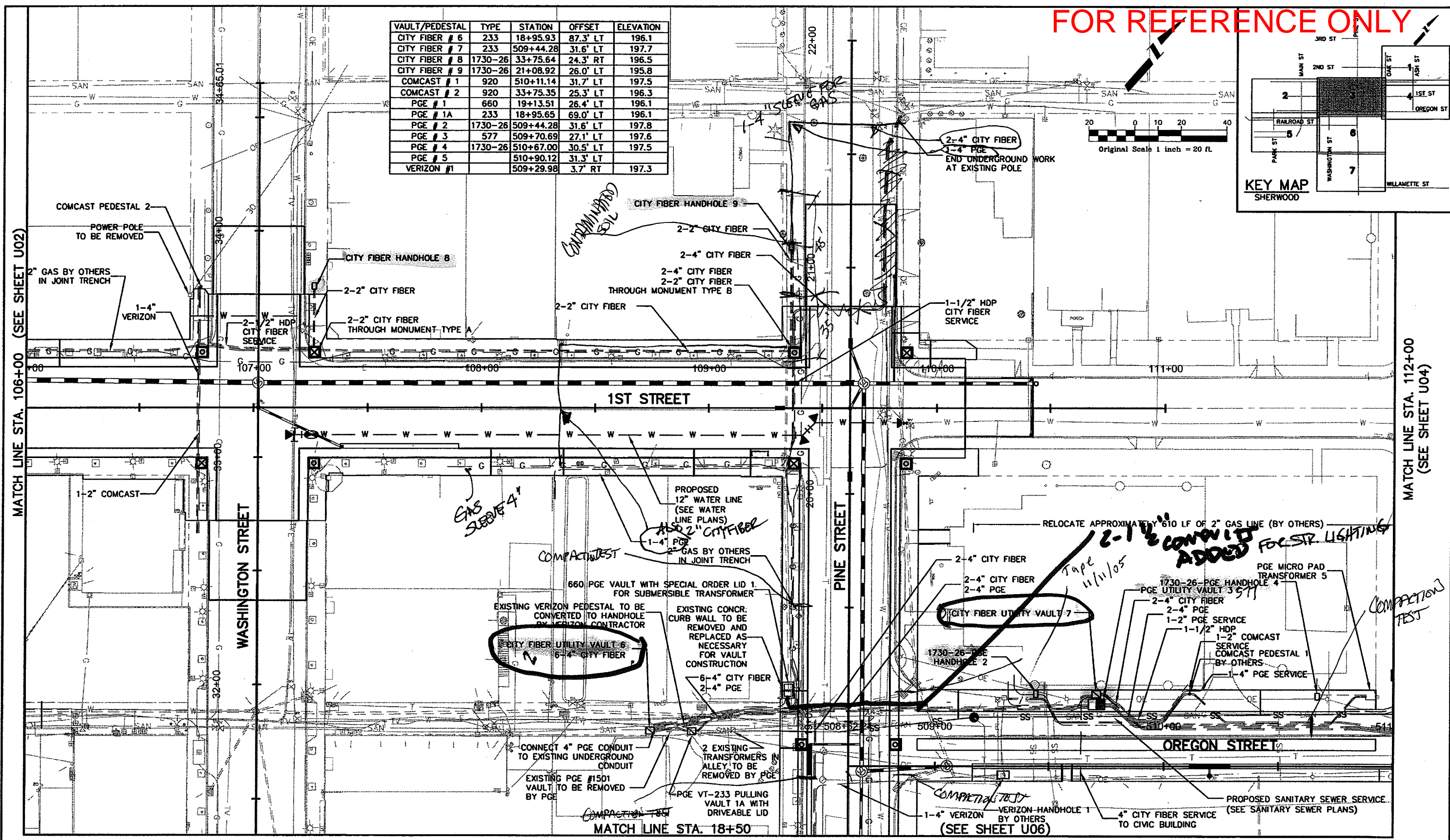
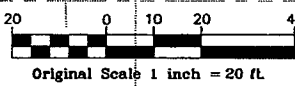
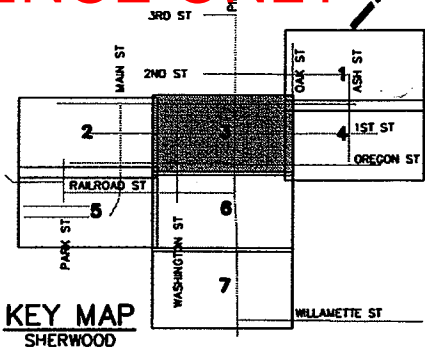

Computer File Information	
Creation Date:	Initials:
Last Modification Date: 09/08/05	Initials: KI
Path: J:\TRANSPORTATION\071668.100\CAD\CIV\SH\UTILITY\	
Drawing File Name: UTPLO2ADD1.DWG	
Acad Ver. R16.0s	Scale: Units: English

Sheet Revisions	
(R-)	/ /
(R-)	/ /
(R-)	/ /
(R-)	/ /
(R-)	/ /

Sherwood Downtown Streetscape Improvements-Phase A

Engineering Department
15527 S. W. Willamette St.
Sherwood, OR 97140
Phone: (503) 925-2305
Fax: (503) 625-0679

Carter-Burgess

707 17th St., Suite 2300
Denver, CO 80202
Phone: (303) 820-5240
Fax: (303) 820-2402

As Constructed	
No Revisions:	/ /
Revised:	/ /
Void:	/ /

UTILITY RELOCATION PLAN		
Designer: LG	Structure Numbers	
Detailer: DB	Subset Sheets:	

Project No./Code	
071668.100	
City of Sherwood CIP #C-41	
Sheet Number	U03