

CEDAR CREEK GREENWAY FENCE IMPROVEMENTS

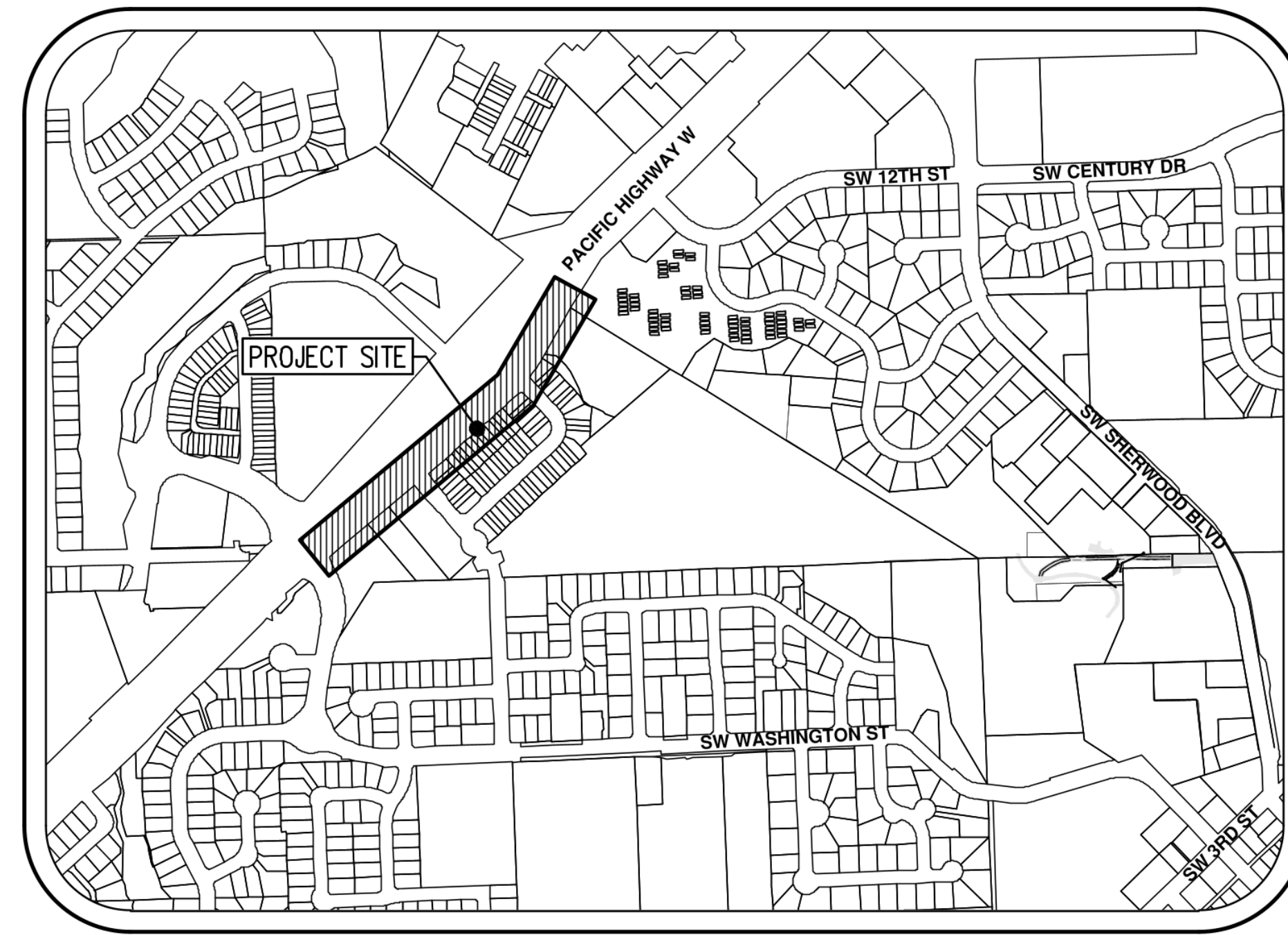

VICINITY MAP
N.T.S.

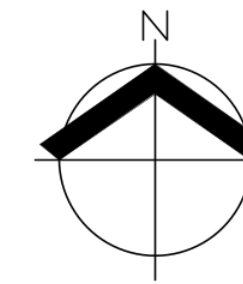

AS-BUILT PLAN LEGEND

CONSTRUCTION LEGEND

- Retaining Wall
- - - Cut Line
- Fill Line
- - - - - Anchor Mesh Wall
- - - - - Mat Stone Embankment
- - - - - Aggregate Shoulder
- Edge of Asphalt Concrete
- Chain Link Fence
- ||| Orange Plastic Mesh Fence

PROJECT TEAM



OWNER

CITY OF SHERWOOD
22560 SW PINE ST,
SHERWOOD, OR 97140
CONTACT: JASON WATERS

ENGINEERING LANDSCAPE ARCHITECTURE



AKS ENGINEERING & FORESTRY, LLC.
12965 SW HERMAN ROAD SUITE 100
TUALATIN, OR 97062
CONTACT: AUSTIN COLE, PE
PHONE: 503.563.6151
FAX: 503.563.6152

SHEET INDEX

- C000 COVER SHEET WITH VICINITY MAP, SITE MAP, & LEGEND
- C001 GENERAL CONSTRUCTION NOTES
- C100 SITE PLAN
- C101 SITE PLAN
- C102 SITE PLAN
- C500 DETAILS
- L100 LANDSCAPE PLAN
- L101 LANDSCAPE PLAN

PROJECT PURPOSE

INSTALL BARRIER AND CHAIN LINK FENCE AND LANDSCAPING ALONG THE EXISTING CEDAR CREEK TRAIL.

VERTICAL DATUM

NAVD88 PER AS-BUILT PLANS PREPARED BY OTHERS

EXISTING LAND USE

THE SUBJECT PROPERTY CONSISTS OF AN ASPHALT TRAIL.

PROJECT LOCATION

CEDAR CREEK TRAIL NORTHWEST OF SW ALEXANDER LANE AND SOUTHWEST OF OR-99W IN SHERWOOD, OR.

LAT: 45°21'43" N

LONG: 122°51'15" W

PROPERTY DESCRIPTION

PUBLIC RIGHT-OF-WAY, LOCATED IN THE SOUTHEAST 1/4 OF SECTION 30, TOWNSHIP 2 SOUTH, RANGE 1 WEST, WILLAMETTE MERIDIAN, CITY OF SHERWOOD, WASHINGTON COUNTY, OREGON. WASHINGTON COUNTY TAX ASSESSORS MAP 2S130DC

ATTENTION EXCAVATORS:

OREGON LAW REQUIRES YOU TO FOLLOW RULES ADOPTED BY THE OREGON UTILITY NOTIFICATION CENTER. THOSE RULES ARE SET FORTH IN OAR 952-001-0010 THROUGH OAR 952-001-0090. YOU MAY OBTAIN COPIES OF THESE RULES FROM THE CENTER BY CALLING 503-232-1987. IF YOU HAVE ANY QUESTIONS ABOUT THE RULES, YOU MAY CONTACT THE CENTER. YOU MUST NOTIFY THE CENTER AT LEAST TWO BUSINESS DAYS BUT NOT MORE THAN TEN BUSINESS DAYS, BEFORE COMMENCING AN EXCAVATION. CALL 503-246-8699.



Know what's below.
Call before you dig.

AKS
ENGINEERING & FORESTRY, LLC
12965 SW HERMAN RD SUITE 100
TUALATIN, OR 97062
503.563.6151
WWW.AKS-ENG.COM

ENGINEERING - SURVEYING - NATURAL RESOURCES
FORESTRY - PLANNING - LANDSCAPE ARCHITECTURE

CEDAR CREEK GREENWAY
FENCE IMPROVEMENTS
SHERWOOD OREGON
WASHINGTON COUNTY ASSESSOR'S TAX MAP 2S130DC
PUBLIC RIGHT-OF-WAY

COVER SHEET WITH
VICINITY MAP, SITE MAP, &
LEGEND

DESIGNED BY: AMC
DRAWN BY: JAM
MANAGED BY: AMC
CHECKED BY: AMC

DATE: 04/15/2024

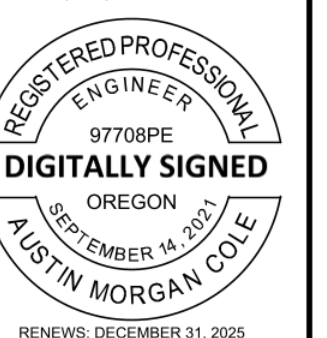

RENEWS: DECEMBER 31, 2025

REVISIONS

JOB NUMBER
9965

SHEET
C000

GENERAL CIVIL NOTES

- 1. CONTRACTOR MUST BE LICENSED BY THE STATE OF OREGON AND SHALL PROCURE, PAY ALL COSTS FOR, AND CONFORM TO ALL CONSTRUCTION PERMITS REQUIRED BY THE CITY OF SHERWOOD, WASHINGTON COUNTY, AND ODOT.
2. OWNER TO PAY ALL PROJECT PERMIT COSTS, INCLUDING BUT NOT LIMITED TO UTILITY TAPPING, TV, AND CHLORINATION COSTS. THE CONTRACTOR SHALL COORDINATE WITH THE GOVERNING JURISDICTION TO DETERMINE APPROPRIATE FEES AND PROVIDE THE OWNER WITH 48 HOURS NOTICE PRIOR TO THE REQUIRED PAYMENT OF FEES OR COSTS.
3. OREGON LAW REQUIRES YOU TO FOLLOW RULES ADOPTED BY THE OREGON UTILITY NOTIFICATION CENTER. THOSE RULES ARE SET FORTH IN OAR 952-001-0010 THROUGH OAR 952-001-0090. THE TELEPHONE NUMBER FOR THE OREGON UTILITY NOTIFICATION CENTER IS (800) 332-2344 OR 811.
4. CONTRACTOR TO NOTIFY CITY, COUNTY, ODOT, AKS PROJECT ENGINEER, AND ALL UTILITY COMPANIES A MINIMUM OF 5 BUSINESS DAYS PRIOR TO START OF CONSTRUCTION AND COMPLY WITH ALL OTHER NOTIFICATION REQUIREMENTS OF AGENCIES WITH JURISDICTION OVER THE WORK. CONTRACTOR SHALL PROCURE A RIGHT-OF-ENTRY PERMIT FROM ODOT STATE HIGHWAY DIVISION FOR ALL WORK WITHIN THE STATE RIGHT-OF-WAY AND CONFORM TO ALL CONDITIONS OF THE PERMIT.
5. CONTRACTOR SHALL PROCURE A RIGHT-OF-ENTRY PERMIT FROM WASHINGTON COUNTY FOR ALL WORK WITHIN THE COUNTY RIGHT-OF-WAY AND CONFORM TO ALL CONDITIONS OF THE PERMIT.
6. CONTRACTOR SHALL PROVIDE ALL BONDS AND INSURANCE REQUIRED BY PUBLIC AND/OR PRIVATE AGENCIES HAVING JURISDICTION. WHERE REQUIRED BY PUBLIC AND/OR PRIVATE AGENCIES HAVING JURISDICTION, THE CONTRACTOR SHALL SUBMIT A SUITABLE MAINTENANCE BOND PRIOR TO FINAL PAYMENT.
7. PRIOR TO BEGINNING WORK, THE CONTRACTOR SHALL COORDINATE A PRE-CONSTRUCTION MEETING BETWEEN THE ENGINEER, OWNER'S REPRESENTATIVE, MAJOR SUBCONTRACTORS, AND PERMITTING AGENCIES. THE CONTRACTOR SHALL PROVIDE THE FOLLOWING ITEMS TO THE OWNER'S REPRESENTATIVE AND ENGINEER.
a. LIST OF SUBCONTRACTORS
b. PROJECT SCHEDULE
c. TRAFFIC CONTROL PLAN
d. EMERGENCY CONTACT NAME AND PHONE NUMBER
8. IT IS THE RESPONSIBILITY OF THE CONTRACTOR TO REVIEW ALL OF THE DOCUMENTS AND PLANS ASSOCIATED WITH THE PROJECT WORK SCOPE PRIOR TO THE INITIATION OF CONSTRUCTION. SHOULD THE CONTRACTOR FIND A CONFLICT WITH THE DOCUMENTS/PLANS RELATIVE TO THE SPECIFICATIONS OR THE APPLICABLE CODES, IT IS THE CONTRACTOR'S RESPONSIBILITY TO NOTIFY THE OWNER'S REPRESENTATIVE IN WRITING PRIOR TO THE START OF CONSTRUCTION. FAILURE BY THE CONTRACTOR TO NOTIFY THE OWNER'S REPRESENTATIVE SHALL CONSTITUTE ACCEPTANCE OF FULL RESPONSIBILITY BY THE CONTRACTOR TO COMPLETE THE SCOPE OF WORK AS DEFINED BY THE DOCUMENTS/PLANS IN FULL COMPLIANCE WITH LOCAL, STATE, AND FEDERAL REGULATIONS AND CODES.
9. ALL MATERIALS AND WORKMANSHIP SHALL CONFORM TO THE APPROVED PLANS AND THE APPLICABLE PROVISIONS OF THE APPROVING AGENCIES' CONSTRUCTION STANDARDS, THE MOST RECENT EDITION OF THE OREGON PLUMBING SPECIALTY CODE (OPSC) AND ANY OREGON SUPPLEMENTS, THE MOST RECENT EDITION OF THE INTERNATIONAL BUILDING CODE (IBC) AND ANY OREGON SUPPLEMENTS, APWA STANDARDS, OREGON HEALTH DIVISION (OHD), NATIONAL FIRE PROTECTION ASSOCIATION (NFPA), OREGON WATER RESOURCES DEPARTMENT (OWRD), AND THE DEPARTMENT OF ENVIRONMENTAL QUALITY (DEQ) WHEREIN EACH HAS JURISDICTION.
10. CONTRACTOR SHALL AT ALL TIMES ABIDE BY APPLICABLE SAFETY RULES OF OSHA, IN PARTICULAR THOSE REGULATIONS PERTAINING TO ADEQUATE SHORING AND TRENCH PROTECTION FOR WORKERS.
11. CONSTRUCTION OF ALL PUBLIC FACILITIES SHALL BE DONE WITHIN THE HOURS PERMITTED BY THE GOVERNING JURISDICTION.
12. THE CONTRACTOR SHALL PERFORM ALL WORK NECESSARY TO COMPLETE THE PROJECT IN ACCORDANCE WITH THE APPROVED CONSTRUCTION DRAWINGS INCLUDING SUCH INCIDENTALS AS MAY BE NECESSARY TO MEET APPLICABLE AGENCY REQUIREMENTS AND PROVIDE A COMPLETED PROJECT.
13. ALL DIMENSIONS SHOWN ON THE PLANS SHALL BE FIELD VERIFIED BY THE CONTRACTOR PRIOR TO THE START OF CONSTRUCTION. DIMENSIONS SHOWN ON THE DRAWINGS ARE FOR HORIZONTAL CONTROL ONLY. CONTRACTOR SHALL REVIEW AND COORDINATE THE BUILDING LAYOUT BY CAREFUL REVIEW OF THE SITE PLAN AND LATEST ARCHITECTURAL PLANS (INCLUDING, BUT NOT LIMITED TO, STRUCTURAL, MECHANICAL, ELECTRICAL, PLUMBING, AND FIRE SUPPRESSION PLAN, WHERE APPLICABLE). CONTRACTOR SHALL IMMEDIATELY NOTIFY THE OWNER'S REPRESENTATIVE AND ARCHITECT OF ANY DISCREPANCIES.
14. ANY INSPECTION BY THE CITY, COUNTY, ODOT, AKS, OWNER'S REPRESENTATIVE, OR OTHER AGENCIES SHALL NOT, IN ANY WAY, RELIEVE THE CONTRACTOR FROM ANY OBLIGATION TO PERFORM THE WORK IN STRICT COMPLIANCE WITH THE CONTRACT DOCUMENTS, APPLICABLE CODES, AND AGENCY REQUIREMENTS.
15. IF THE CONTRACTOR DEVIATES FROM THE APPROVED PLANS, INCLUDING THESE NOTES, WITHOUT FIRST OBTAINING THE PRIOR WRITTEN AUTHORIZATION OF THE ENGINEER FOR SUCH DEVIATIONS, CONTRACTOR SHALL BE SOLELY RESPONSIBLE FOR THE PAYMENT OF ALL COSTS INCURRED IN CORRECTING ANY WORK DONE WHICH DEVIATES FROM THE PLANS.
16. AKS HAS NOT BEEN RETAINED OR COMPENSATED TO PROVIDE DESIGN AND CONSTRUCTION REVIEW SERVICES RELATING TO THE CONTRACTOR'S SAFETY PRECAUTIONS, MEANS AND METHODS, TECHNIQUES, SEQUENCES, OR PROCEDURES REQUIRED FOR THE CONTRACTOR TO PERFORM WORK REQUIRED. AKS IS NOT A SAFETY INSPECTION COMPANY.

- 18. CONTRACTOR SHALL MAINTAIN ONE (1) COMPLETE SET OF APPROVED PLANS ON THE CONSTRUCTION SITE AT ALL TIMES WHEREON THEY WILL RECORD ALL APPROVED DEVIATIONS IN CONSTRUCTION FROM THE APPROVED DRAWINGS, AS WELL AS LOCATIONS AND DEPTHS OF ALL EXISTING UTILITIES ENCOUNTERED. THESE FIELD RECORD DRAWINGS SHALL BE KEPT UP TO DATE AT ALL TIMES AND SHALL BE AVAILABLE FOR INSPECTION BY THE CITY OR OWNER'S REPRESENTATIVE UPON REQUEST.
19. UPON COMPLETION OF CONSTRUCTION OF ALL NEW FACILITIES, CONTRACTOR SHALL SUBMIT A CLEAN SET OF FIELD RECORD DRAWINGS CONTAINING ALL AS-BUILT INFORMATION TO THE OWNER'S REPRESENTATIVE. ALL INFORMATION SHOWN ON THE CONTRACTOR'S FIELD RECORD DRAWINGS SHALL BE SUBJECT TO VERIFICATION. IF SIGNIFICANT ERRORS OR DEVIATIONS ARE NOTED, AN AS-BUILT SURVEY PREPARED AND STAMPED BY A REGISTERED PROFESSIONAL LAND SURVEYOR SHALL BE COMPLETED AT THE CONTRACTOR'S EXPENSE.
20. THE CONTRACTOR SHALL INSTALL AND MAINTAIN ALL EROSION CONTROL MEASURES IN ACCORDANCE WITH THE CURRENT DEQ EROSION AND SEDIMENT CONTROL MANUAL AND EROSION CONTROL STANDARDS OF THE LOCAL JURISDICTION.
21. THE WORK AREA AND APPROACH ROAD(S) SHALL BE MAINTAINED BY THE CONTRACTOR IN A CLEAN AND SANITARY CONDITION, FREE FROM OBSTRUCTIONS, DEBRIS, AND TRASH AT ALL TIMES.
22. ELEVATIONS SHOWN ON THE DRAWINGS USE THE NAVD83 DATUM PER AS-BUILT PLANS PREPARED BY OTHERS.
23. THESE PLANS ASSUME AKS ENGINEERING & FORESTRY, LLC WILL BE RETAINED TO PROVIDE CONSTRUCTION STAKING SERVICES (TO INCLUDE OBSERVATION AND SURVEY CONSTRUCTION LAYOUT) DURING CONSTRUCTION OF ALL IMPROVEMENTS. SUFFICIENT OBSERVATION AND CONSULTATION SERVICES BY THE DESIGN ENGINEER IS NECESSARY TO ENSURE CONSTRUCTION IS CONSISTENT WITH THE INTENT OF THESE PLANS AND ANY CHANGES THAT ARE DETERMINED NECESSARY DURING CONSTRUCTION. AKS DOES NOT ACCEPT ANY RESPONSIBILITY OR LIABILITY FOR ITEMS CONSTRUCTED IMPROPERLY BASED ON MISINTERPRETATIONS OF ITEMS SHOWN ON THESE PLANS.
24. THE CONTRACTOR SHALL COORDINATE WITH THE SURVEYOR RETAINED BY THE OWNER OR RETAIN AND PAY FOR THE SERVICES OF A REGISTERED CIVIL ENGINEER AND/OR LAND SURVEYOR LICENSED IN THE STATE OF OREGON TO ESTABLISH CONSTRUCTION CONTROL AND PERFORM INITIAL CONSTRUCTION SURVEYS TO ESTABLISH THE LINES AND GRADES OF IMPROVEMENTS AS INDICATED ON THE DRAWINGS. STAKING FOR BUILDINGS, STRUCTURES, CURBS, GRAVITY DRAINAGE PIPES/STRUCTURES AND OTHER CRITICAL IMPROVEMENTS SHALL BE COMPLETED USING EQUIPMENT ACCURATE TO 0.04 FEET HORIZONTALLY AND 0.02 FEET VERTICALLY, OR BETTER (USE OF GPS EQUIPMENT FOR CONSTRUCTION STAKING OF THESE IMPROVEMENTS IS NOT ALLOWED).
25. CONTRACTOR SHALL CONDUCT CONSTRUCTION ACTIVITIES IN SUCH A MANNER AS TO ENSURE MINIMUM INTERFERENCE WITH THE CONTINUED USE OF THE FACILITY BY THE COMMUNITY OR NEIGHBORS. CONTRACTOR SHALL CONTACT AND DISCUSS PLANNED CONSTRUCTION ACTIVITIES AND TIMING WITH THE OWNER AT LEAST 48 HOURS PRIOR TO STARTING WORK. CONTRACTOR SHALL COOPERATE AND ACCOMMODATE OWNER'S REQUESTS TO THE MAXIMUM EXTENT POSSIBLE.
26. CONSTRUCTION ACTIVITIES, EQUIPMENT, VEHICLES, AND MATERIALS SHALL BE PLACED IN AREAS MINIMIZING INCONVENIENCE TO THE FACILITIES' NORMAL OPERATIONS AND SHALL BE COORDINATED WITH THE OWNER OR OWNER'S REPRESENTATIVE PRIOR TO THE START OF WORK.
27. THE CONTRACTOR SHALL BE RESPONSIBLE FOR MANAGING CONSTRUCTION ACTIVITIES TO ENSURE THAT PUBLIC STREETS AND RIGHT-OF-WAYS ARE KEPT CLEAN OF MUD, DUST OR DEBRIS. DUST ABATEMENT SHALL BE MAINTAINED BY ADEQUATE WATERING OF THE SITE BY THE CONTRACTOR.
28. PRIOR TO FINAL ACCEPTANCE AND PAYMENT, THE CONTRACTOR SHALL CLEAN THE PROJECT SITE AND ADJACENT AREAS OF ANY DEBRIS, DISCARDED MATERIAL, OR OTHER ITEMS DEPOSITED BY THE CONTRACTOR'S PERSONNEL DURING THE PERFORMANCE OF THE WORK.
29. SETTLEMENT OR CRACKING OF FINISHED SURFACES WITHIN THE WARRANTY PERIOD SHALL BE CONSIDERED A FAILURE OF THE FINISHED SURFACE AND/OR SUBGRADE. CONTRACTOR SHALL REPAIR IN A MANNER ACCEPTABLE TO THE ENGINEER, OWNER'S REPRESENTATIVE, AND/OR APPLICABLE JURISDICTION.
30. ELECTRONIC FILES ARE NOT CONSTRUCTION DOCUMENTS. DIFFERENCES MAY EXIST BETWEEN ELECTRONIC FILES AND CORRESPONDING HARD-COPY CONSTRUCTION DOCUMENTS. CONSTRUCTION SHALL BE BASED ON THE STAMPED HARD-COPY DESIGN DRAWINGS AND TECHNICAL SPECIFICATIONS PRODUCED BY AKS. IN THE EVENT THAT A CONFLICT ARISES BETWEEN THE SIGNED OR SEALED HARD-COPY CONSTRUCTION DOCUMENTS AND OR TECHNICAL SPECIFICATIONS PREPARED BY AKS, AND THE ELECTRONIC FILES, THE SIGNED OR SEALED HARD-COPY CONSTRUCTION DOCUMENTS SHALL GOVERN. THE CONTRACTOR IS RESPONSIBLE FOR DETERMINING IF ANY CONFLICTS EXIST. USE OF THE ELECTRONIC FILES DOES NOT RELIEVE YOU OF YOUR DUTY TO FULLY COMPLY WITH THE CONTRACT DOCUMENTS INCLUDING, AND WITHOUT LIMITATION, THE NEED TO CHECK, CONFIRM AND COORDINATE ALL DIMENSIONS AND DETAILS, TAKE FIELD MEASUREMENTS, VERIFY FIELD CONDITIONS, AND COORDINATE YOUR WORK WITH THAT OF OTHER CONTRACTORS FOR THE PROJECT. NO REVISIONS SHALL BE MADE TO THE DESIGN WITHOUT THE EXPRESS WRITTEN CONSENT OF THE DESIGN ENGINEER WHOSE STAMP IS ON THE HARD-COPY DESIGN DRAWINGS AND TECHNICAL SPECIFICATIONS.

TRAFFIC CONTROL

- 31. CONTRACTOR SHALL ERECT AND MAINTAIN BARRICADES, WARNING SIGNS, AND TRAFFIC CONES PER CITY, COUNTY AND/OR ODOT REQUIREMENTS IN ACCORDANCE WITH THE MANUAL ON UNIFORM TRAFFIC CONTROL DEVICES (MUTCD) INCLUDING OREGON AMENDMENTS AND LOCAL JURISDICTIONAL REQUIREMENTS. ACCESS TO DRIVEWAYS SHALL BE MAINTAINED AT ALL TIMES. ALL TRAFFIC CONTROL MEASURES SHALL BE APPROVED AND IN PLACE PRIOR TO ANY CONSTRUCTION ACTIVITY.

- 32. PRIOR TO ANY WORK IN THE EXISTING PUBLIC RIGHT-OF-WAY, CONTRACTOR SHALL SUBMIT A FINAL TRAFFIC CONTROL PLAN TO THE CITY, COUNTY, AND/OR ODOT FOR REVIEW AND ISSUANCE OF A LANE CLOSURE OR WORK IN RIGHT-OF-WAY PERMIT.

TESTING AND INSPECTIONS

- 33. THE CONTRACTOR SHALL BE RESPONSIBLE TO ENSURE THAT ALL REQUIRED OR NECESSARY INSPECTIONS ARE COMPLETED BY AUTHORIZED INSPECTORS PRIOR TO PROCEEDING WITH SUBSEQUENT WORK WHICH COVERS OR THAT IS DEPENDENT ON THE WORK TO BE INSPECTED. FAILURE TO OBTAIN NECESSARY INSPECTION(S) AND APPROVAL(S) SHALL RESULT IN ALL PROBLEMS ARISING FROM UNINSPECTED WORK.
34. THE CONTRACTOR IS RESPONSIBLE FOR OBTAINING ALL NECESSARY INSPECTIONS OR NECESSARY OBSERVATIONS FOR ALL WORK PERFORMED INCLUDING ANY RE-TESTING THAT MAY BE REQUIRED TO MEET SPECIFICATION. THE CONTRACTOR SHALL PERFORM PRE-TESTS PRIOR TO SCHEDULING TESTS THAT MUST BE WITNESSED. TESTING MUST BE PERFORMED BY AN APPROVED THIRD-PARTY INDEPENDENT TESTING LABORATORY RETAINED BY THE CONTRACTOR. CONTRACTOR IS SOLELY RESPONSIBLE FOR SCHEDULING TESTING. ALL TESTING MUST BE COMPLETED PRIOR TO PERFORMING SUBSEQUENT WORK. A COPY OF ALL TESTING RESULTS MUST BE PROVIDED TO THE OWNER'S REPRESENTATIVE IMMEDIATELY UPON COMPLETION OF THE TEST. COSTS FOR ANY RE-TESTING IS THE RESPONSIBILITY OF THE CONTRACTOR.
35. CONTRACTOR SHALL COORDINATE AND SCHEDULE ALL EARTHWORK, SUBGRADE APPROVALS, TRENCH BACKFILL, COMPACTION TESTS, AND OTHER GEOTECHNICAL RELATED ITEMS WITH THE PROJECT GEOTECHNICAL ENGINEER, AND/OR THIRD-PARTY INDEPENDENT TESTING LABORATORY AS APPLICABLE FOR THE PROJECT.
36. THE FOLLOWING TESTING IS THE MINIMUM REQUIRED FOR THE PROJECT.
SUBGRADE 1 TEST/4000 S.F./LIFT (4 TESTS MINIMUM)
ENGINEERED FILLS 1 TEST/4000 S.F./LIFT (4 TESTS MINIMUM)
BASE ROCK 1 TEST/4000 S.F./LIFT (4 TESTS MINIMUM)
ASPHALT 1 TEST/6000 S.F./LIFT (4 TESTS MINIMUM)
CONCRETE SLUMP & AIR 1 SET OF CYLINDERS/100 C.Y. OF CONCRETE POURED PER DAY. SLUMP AND AIR TESTS REQUIRED ON SAME LOAD AS CYLINDERS.
SPECIAL INSPECTIONS AS REQUIRED BY IBC.
37. IN ADDITION TO IN-PLACE DENSITY TESTING, THE SUBGRADE AND BASE ROCK SHALL BE PROOF-ROLLED WITH A LOADED 10-YARD DUMP TRUCK PROVIDED BY THE CONTRACTOR. BASE ROCK PROOF-ROLL SHALL TAKE PLACE IMMEDIATELY PRIOR TO (WITHIN 24 HOURS OF) PAVING AND SHALL BE WITNESSED BY THE OWNER'S REPRESENTATIVE. LOCATION AND PATTERN OF PROOF-ROLL TO BE AS DIRECTED BY OWNER'S REPRESENTATIVE OR APPROVING AGENCY.
38. ALL ENGINEERED FILLS REQUIRE AN APPROVED INDEPENDENT TESTING LABORATORY RETAINED BY THE CONTRACTOR, TO PROVIDE WRITTEN CERTIFICATION STAMPED BY AN OREGON REGISTERED PROFESSIONAL ENGINEER STATING THAT THE SUBGRADE WAS PREPARED AND ALL ENGINEERED FILLS WERE PLACED IN ACCORDANCE WITH THE CONSTRUCTION DRAWINGS AND CONTRACT DOCUMENTS.

EXISTING CONDITIONS

- 39. DESIGN BACKGROUNDS ARE AS-BUILT PLANS BY OTHERS. WE DO NOT GUARANTEE THE ACCURACY OR THE COMPLETENESS OF SUCH RECORDS. ADDITIONAL UTILITIES MAY EXIST WITHIN THE WORK AREA. CONTRACTOR SHALL FIELD VERIFY LOCATIONS AND SIZES OF ALL EXISTING UTILITIES PRIOR TO CONSTRUCTION.
40. ANY UTILITIES LOCATED IN THE FIELD THAT THE CONTRACTOR DISRUPTS OR DAMAGES SHALL BE PROMPTLY REPAIRED TO NEW CONDITION. IF REQUIRED, CONTRACTOR SHALL INSTALL SUITABLE TEMPORARY SERVICE UNTIL REPAIR CAN BE COMPLETED. THE COST OF THE REPAIR OR TEMPORARY SERVICE SHALL BE BORNE BY THE CONTRACTOR.
41. NOTIFY THE OWNER AND OWNER'S REPRESENTATIVE IMMEDIATELY OF ALL UTILITIES EXPOSED. UNIDENTIFIED UTILITIES SHALL NOT BE DISRUPTED OR CUT UNTIL OWNER OR OWNER'S REPRESENTATIVE HAS APPROVED THE CUT OR DISRUPTION.
42. THE CONTRACTOR SHALL BE RESPONSIBLE FOR LOCATING AND MARKING ALL EXISTING SURVEY MONUMENTS OF RECORD (INCLUDING BUT NOT LIMITED TO PROPERTY AND STREET MONUMENTS) PRIOR TO CONSTRUCTION. IF ANY SURVEY MONUMENTS ARE REMOVED, DISTURBED OR DESTROYED DURING CONSTRUCTION OF THE PROJECT, THE CONTRACTOR SHALL RETAIN AND PAY FOR THE SERVICES OF A REGISTERED PROFESSIONAL SURVEYOR LICENSED IN THE STATE OF OREGON TO REFERENCE AND REPLACE ALL SUCH MONUMENTS PRIOR TO SUBSTANTIAL COMPLETION OF THE PROJECT. THE MONUMENTS SHALL BE REPLACED WITHIN A MAXIMUM OF 90 DAYS, AND THE COUNTY SURVEYOR SHALL BE NOTIFIED IN WRITING AS REQUIRED BY PER ORS 209.150.

- 43. CONTRACTOR SHALL FIELD VERIFY LOCATION AND DEPTH OF ALL EXISTING UTILITIES WHERE NEW FACILITIES CROSS. ALL UTILITY CROSSINGS SHOWN ON THE DRAWINGS SHALL BE POTHOLED USING HAND TOOLS OR OTHER NON-INVASIVE METHODS PRIOR TO EXCAVATING OR BORING. CONTRACTOR SHALL BE RESPONSIBLE FOR EXPOSING POTENTIAL UTILITY CONFLICTS FAR ENOUGH AHEAD OF CONSTRUCTION TO MAKE NECESSARY GRADE OR ALIGNMENT MODIFICATIONS WITHOUT DELAYING THE WORK. IF GRADE OR ALIGNMENT MODIFICATION IS NECESSARY, CONTRACTOR SHALL NOTIFY THE ENGINEER, AND THE ENGINEER OR THE OWNER'S REPRESENTATIVE SHALL OBTAIN APPROVAL FROM THE CITY PRIOR TO CONSTRUCTION.
44. ALL FACILITIES SHALL BE MAINTAINED IN-PLACE BY THE CONTRACTOR UNLESS OTHERWISE SHOWN OR DIRECTED. CONTRACTOR SHALL TAKE ALL PRECAUTIONS NECESSARY TO SUPPORT, MAINTAIN, OR OTHERWISE PROTECT EXISTING UTILITIES AND OTHER FACILITIES AT ALL TIMES DURING CONSTRUCTION. CONTRACTOR TO LEAVE EXISTING FACILITIES IN AN EQUAL OR BETTER THAN-ORIGINAL CONDITION TO THE SATISFACTION OF THE ENGINEER, APPROVING AGENCY, AND OWNER'S REPRESENTATIVE.
45. UTILITIES OR INTERFERING PORTIONS OF UTILITIES THAT ARE ABANDONED IN PLACE SHALL BE REMOVED BY THE CONTRACTOR TO THE EXTENT NECESSARY TO ACCOMPLISH THE WORK. AFTER VERIFYING THE UTILITIES ARE TO BE ABANDONED, THE CONTRACTOR SHALL CLOSE ALL REMAINING OPENINGS WITH CONCRETE PLUGS THAT HAVE A MINIMUM LENGTH EQUAL TO TWO TIMES THE DIAMETER OF THE ABANDONED PIPE.
46. CONTRACTOR SHALL REMOVE ALL EXISTING SIGNS, MAILBOXES, FENCES, LANDSCAPING, ETC., AS REQUIRED TO AVOID DAMAGE DURING CONSTRUCTION AND REPLACE THEM TO EXISTING OR BETTER CONDITION.
47. IF DRAIN/FIELD TILES, SPRINGS, OR GROUNDWATER ARE ENCOUNTERED DURING CONSTRUCTION, THE CONTRACTOR SHALL NOTIFY THE ENGINEER AND OWNER'S REPRESENTATIVE OF THE CONDITIONS FOUND AND COORDINATE THE ACTIVITIES IN A MANNER THAT WILL ALLOW TIME TO REVIEW THE SITUATION AND PREPARE A PLAN TO PROPERLY MITIGATE THE WATER ENCOUNTERED. DRAIN/FIELD TILES, WHERE FOUND DURING CONSTRUCTION, SHALL BE CONNECTED TO NEW STORM LINES. DRAIN/FIELD TILE OPENINGS DOWNSTREAM OF WHERE THE TILE WAS CONNECTED TO THE STORM LINE SHALL BE PLUGGED WITH CONCRETE WITH A MINIMUM LENGTH EQUAL TO TWO TIMES THE DIAMETER OF THE ABANDONED TILE.
48. ANY SEPTIC TANKS ENCOUNTERED DURING CONSTRUCTION SHALL BE PUMPED OUT AND ABANDONED OR REMOVED IN ACCORDANCE WITH COUNTY SANITARIAN REQUIREMENTS.
49. ANY WELLS ENCOUNTERED SHALL BE ABANDONED PER THE STATE OF OREGON WATER RESOURCES DEPARTMENT REQUIREMENTS.
50. ANY FUEL TANKS ENCOUNTERED SHALL BE REMOVED AND DISPOSED OF PER THE STATE OF OREGON DEQ REQUIREMENTS. BACKFILL WITH COMPACTED GRANULAR MATERIAL.
51. CONTRACTOR SHALL COORDINATE AND PAY ALL COSTS ASSOCIATED WITH REMOVING OR ABANDONING ANY SEPTIC TANKS, WELLS (INCLUDING BOREHOLE PIEZOMETERS), AND FUEL TANKS ENCOUNTERED AS PER REGULATING AGENCY REQUIREMENTS. WHEN SHOWN ON THE DRAWINGS, THESE STRUCTURES SHALL BE REMOVED OR ABANDONED AT THE CONTRACTOR'S EXPENSE. WHEN NOT SHOWN ON THE DRAWINGS, THE CONTRACTOR SHALL NOTIFY THE OWNER'S REPRESENTATIVE IMMEDIATELY UPON DISCOVERY OF ANY SEPTIC TANKS, WELLS, OR FUEL TANKS, AND OBTAIN APPROVAL FROM THE OWNER'S REPRESENTATIVE PRIOR TO PROCEEDING WITH THE WORK. THE CONTRACTOR SHALL PROVIDE THE OWNER WITH A DETAILED COST BREAKDOWN OF ALL WORK RELATED TO REMOVING OR ABANDONING SAID STRUCTURES. THE CONTRACTOR WILL BE REBURSED ON A TIME & MATERIALS BASIS OR AT A NEGOTIATED PRICE AS AGREED.
52. PRIOR TO CONNECTING TO EXISTING WATER, SEWER, OR STORM STUBS/LATERALS, CONTRACTOR SHALL CLEAN AND TV THE EXISTING PIPE, SUBMIT TV INSPECTION VIDEO AND REPORT TO ENGINEER AND/OR JURISDICTION FOR REVIEW TO CONFIRM PIPE IS IN ACCEPTABLE CONDITION FOR REUSE.

CLEARING, GRADING, AND PAVING

- 53. GRADING, COMPACTION, FILLS, ROCK, AND PAVING SHALL CONFORM TO CITY OF SHERWOOD, WASHINGTON COUNTY, OR ODOT STANDARD CONSTRUCTION SPECIFICATIONS FOR WORK WITHIN PUBLIC RIGHT-OF-WAY OR EASEMENTS.
54. PRIVATE GRADING, ROCK, AND PAVING TO CONFORM TO OREGON STANDARD SPECIFICATIONS FOR CONSTRUCTION (OSSC/ODOT/APWA) AND IBC, CURRENT EDITIONS.
55. CLEAR AND GRUB WITHIN WORK LIMITS ALL SURFACE VEGETATION, TREES, STUMPS, BRUSH, ROOTS, ETC. DO NOT DAMAGE OR REMOVE TREES EXCEPT AS APPROVED BY THE OWNER'S REPRESENTATIVE OR AS SHOWN ON THE DRAWINGS. PROTECT ALL ROOTS TWO INCHES IN DIAMETER OR LARGER.
56. STRIP WORK LIMITS, REMOVING ALL ORGANIC MATTER, WHICH CANNOT BE COMPACTED INTO A STABLE MASS. ALL TREES, BRUSH, AND DEBRIS ASSOCIATED WITH CLEARING, STRIPPING OR GRADING SHALL BE REMOVED AND DISPOSED OF OFF-SITE.
57. IMMEDIATELY FOLLOWING STRIPPING AND GRADING OPERATIONS, COMPACT SUBGRADE TO 95% OF THE MAXIMUM DRY DENSITY PER AASHTO T-99 TEST METHOD (STANDARD PROCTOR) PER CITY OF SHERWOOD DESIGN STANDARDS. SUBGRADE MUST BE INSPECTED AND APPROVED BY THE OWNER'S AUTHORIZED REPRESENTATIVE AND WRITTEN COMPACTION TEST RESULTS FROM AN INDEPENDENT TESTING LABORATORY MUST BE RECEIVED BEFORE PLACING EMBANKMENTS, ENGINEERED FILLS, OR FINE GRADING FOR BASE ROCK.
58. ALL FILLS SHALL BE ENGINEERED EXCEPT FOR FILLS LESS THAN 18-INCHES IN DEPTH WHICH ARE LOCATED OUTSIDE THE PUBLIC RIGHT-OF-WAY, BUILDING PADS, PARKING LOTS, OR OTHER AREAS TO BE IMPROVED. ENGINEERED FILLS SHALL BE CONSTRUCTED WITH MAXIMUM 8 INCH LIFTS (LOOSE MEASURE) OVER APPROVED SUBGRADE. EACH LIFT SHALL BE COMPACTED TO 95% OF THE MAXIMUM DRY DENSITY PER AASHTO T-180 TEST METHOD (MODIFIED PROCTOR).

- 59. AREAS TO RECEIVE ENGINEERED OR STRUCTURAL FILL SHALL BE PREPARED BY REMOVING ALL ORGANIC AND UNSUITABLE MATERIALS AND PROOF-ROLLING. MATERIAL IN SOFT SPOTS WITHIN AREAS TO BE IMPROVED SHALL BE REMOVED TO THE DEPTH REQUIRED (AS DIRECTED BY THE OWNER'S REPRESENTATIVE) TO PROVIDE A FIRM FOUNDATION AND SHALL BE REPLACED WITH SUITABLE COMPACTED BACKFILL.
60. GRANULAR BASE ROCK SHALL MEET OREGON STATE HIGHWAY DIVISION (OSHD) SPECIFICATIONS PER CITY OF SHERWOOD DESIGN STANDARDS. COMPACT BASE ROCK TO 95% OF THE MAXIMUM DRY DENSITY PER AASHTO T-180 TEST METHOD (MODIFIED PROCTOR) OR OSHD TM-106. WRITTEN BASE ROCK COMPACTION TEST RESULTS FROM AN INDEPENDENT TESTING LABORATORY MUST BE RECEIVED BY THE OWNER'S AUTHORIZED REPRESENTATIVE BEFORE PLACING AC PAVEMENT.
61. ALL EXISTING OR CONSTRUCTED MANHOLES, CLEANOUTS, MONUMENT BOXES, GAS VALVES, WATER VALVES AND SIMILAR STRUCTURES SHALL BE ADJUSTED TO MATCH FINISH GRADE OF THE PAVEMENT, SIDEWALK, LANDSCAPED AREA OR MEDIAN STRIP WHEREIN THEY LIE. VERIFY THAT ALL VALVE BOXES AND RISERS ARE CLEAN AND CENTERED OVER THE OPERATING NUT.
62. FINISHED RIM ELEVATIONS OF MANHOLES SHOWN WITHIN PAVEMENT ARE APPROXIMATE AND SHALL MATCH FINAL FINISHED PAVEMENT GRADES. RIM ELEVATIONS OUTSIDE OF PAVEMENT SHALL BE SET 3 INCHES ABOVE FINISHED GRADE, UNLESS OTHERWISE DIRECTED OR SHOWN ON THE DRAWINGS.
63. NO CUT OR FILL SLOPES SHALL BE CONSTRUCTED STEEPER THAN 2 FEET HORIZONTAL TO 1 FOOT VERTICAL (2H:1V) UNLESS OTHERWISE SHOWN ON THE DRAWINGS AND APPROVED BY THE GEOTECHNICAL ENGINEER FOR THE PROJECT.
64. ALL PLANTER AREAS AND OPEN SPACE SHALL BE BACKFILLED WITH APPROVED TOPSOIL IN CONFORMANCE WITH THE LANDSCAPE PLAN FOR THE PROJECT. STRIPPING MATERIALS SHALL NOT BE USED FOR BACKFILL, UNLESS APPROVED IN WRITING BY THE OWNER'S REPRESENTATIVE.

AKS DRAWING FILE: C000 COVER & NOTES.DWG | LAYOUT: C001

AKS ENGINEERING & FORESTRY, LLC
12045 SW HERMAN RD. STE 100
TUALATIN, OR 97062
503.653.6151
WWW.AKS-ENG.COM
ENGINEERING - SURVEYING - NATURAL RESOURCES
FORESTRY - PLANNING - LANDSCAPE ARCHITECTURE

CEDAR CREEK GREENWAY
FENCE IMPROVEMENTS
SHERWOOD OREGON
WASHINGTON COUNTY ASSESSOR'S TAX MAP 251300C
PUBLIC RIGHT-OF-WAY

GENERAL CIVIL
CONSTRUCTION NOTES

DESIGNED BY: AMC
DRAWN BY: JAM
MANAGED BY: AMC
CHECKED BY: AMC
DATE: 04/15/2024
REGISTERED PROFESSIONAL ENGINEER
97708PE
DIGITALLY SIGNED
OREGON
SEPTEMBER 14, 2016
AUSTIN MORGAN COLE
REVIEWS: DECEMBER 31, 2025

JOB NUMBER
9965
SHEET
C001

KEYED NOTES:

1. INSTALL ±25 LF OF 7' TALL PREFABRICATED BARRIER FENCE PER MANUFACTURER'S RECOMMENDATIONS. EXTEND SOUND FENCE BEHIND EXISTING CEDAR PLANK FENCE, OVERLAP 2 LF MINIMUM.
2. INSTALL ±114 LF OF 7' TALL PREFABRICATED BARRIER FENCE PER MANUFACTURER'S RECOMMENDATIONS.
3. REMOVE EXISTING ODOT YARD FENCE AND INSTALL ±146 LF OF 7' TALL PREFABRICATED BARRIER FENCE PER MANUFACTURER'S RECOMMENDATIONS.
4. INSTALL ±354 (TOTAL) LF OF 8' TALL PREFABRICATED BARRIER FENCE PER MANUFACTURER'S RECOMMENDATIONS.
5. GRIND AND REMOVE EXISTING STUMP. PRESERVE SURROUNDING PATHWAY, LANDSCAPING, FENCE, ETC.
6. SEE LANDSCAPE PLAN FOR PLANTINGS AND LANDSCAPE RESTORATION.
7. REMOVE AND RELOCATE EXISTING STREET TREES FOR MAINTENANCE ACCESS.
8. REGRADE AREA ABOVE OUTFALL TO PROVIDE MINIMUM ±6' WIDE AREA FOR MAINTENANCE ACCESS. MATCH EXISTING AT 2:1 MAX.
9. INSTALL ±270 (TOTAL) LF OF CHAIN LINK FENCE (TYPE CL-4) ALONG EXISTING PATH PER ODOT STANDARD DRAWING R0815/CS00. MATCH EXISTING COLOR AND STYLE. ATTACH NEW CHAIN LINK FENCE TO EXISTING CHAIN LINK FENCE POST USING STEEL WIRE CLIPS.
10. INSTALL STRAW WATTLES PER CWS DRAWING NO. 880/CS00. ESC MEASURES MUST BE IN PLACE AND FUNCTIONAL PRIOR TO COMMENCEMENT OF CONSTRUCTION ACTIVITIES.
11. END CHAIN LINK FENCE
- P. CONTRACTOR TO PROTECT AT ALL TIMES THROUGHOUT DEMOLITION AND CONSTRUCTION. ANY DAMAGE SHALL BE REPAIRED AT CONTRACTOR'S EXPENSE.

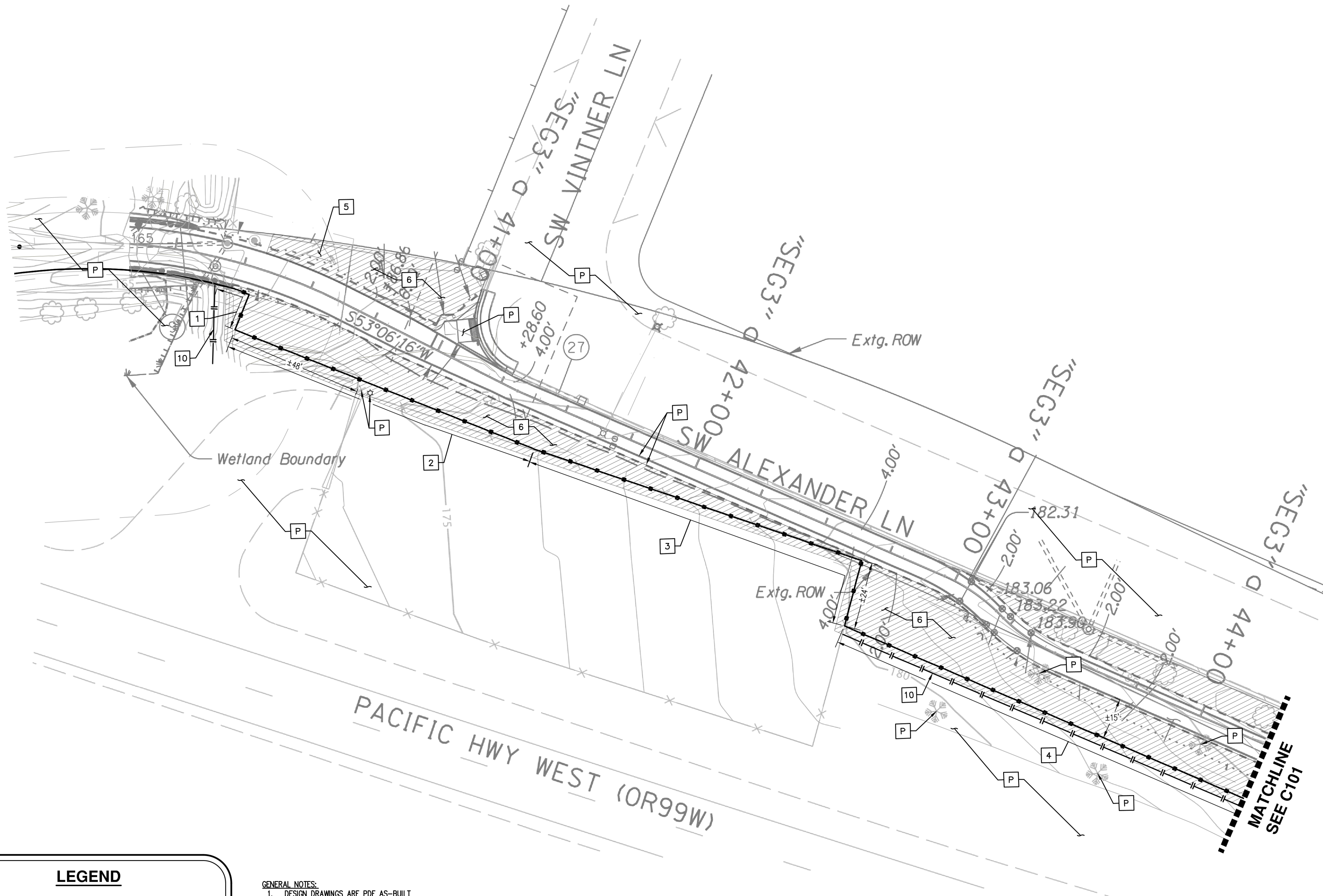

LEGEND

- STRAW WATTLES
- PREFABRICATED SOUND FENCE
- CHAIN LINK FENCE
- RESTORE LANDSCAPING

GENERAL NOTES:

1. DESIGN DRAWINGS ARE PDF AS-BUILT PLANS PREPARED BY OTHERS.
2. IF SIGNIFICANT ROOTS ARE ENCOUNTERED DURING FENCE POST INSTALLATION, THE FENCE POSTS SHALL BE SHIFTED SO AS TO AVOID TREE ROOTS.
3. ALL DIMENSIONS ARE TO EDGE OF AC PATHWAY UNLESS SPECIFIED OTHERWISE.

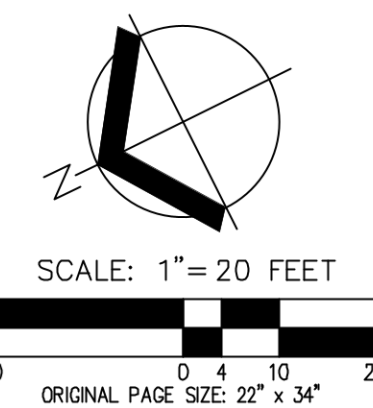

AKS DRAWING FILE: 9965_FENCE.DWG | LAYOUT: C007

SITE PLAN

DESIGNED BY: AMC
 DRAWN BY: JAM
 MANAGED BY: AMC
 CHECKED BY: AMC

DATE: 04/15/2024



REVISIONS

JOB NUMBER
9965

SHEET
C100

KEYED NOTES:

1. INSTALL ±25 LF OF 7' TALL PREFABRICATED BARRIER FENCE PER MANUFACTURER'S RECOMMENDATIONS. EXTEND SOUND FENCE BEHIND EXISTING CEDAR PLANK FENCE, OVERLAP 2 LF MINIMUM.
 2. INSTALL ±114 LF OF 7' TALL PREFABRICATED BARRIER FENCE PER MANUFACTURER'S RECOMMENDATIONS.
 3. REMOVE EXISTING ODOT YARD FENCE AND INSTALL ±146 LF OF 7' TALL PREFABRICATED BARRIER FENCE PER MANUFACTURER'S RECOMMENDATIONS.
 4. INSTALL ±354 (TOTAL) LF OF 8' TALL PREFABRICATED BARRIER FENCE PER MANUFACTURER'S RECOMMENDATIONS.
 5. GRIND AND REMOVE EXISTING STUMP. PRESERVE SURROUNDING PATHWAY, LANDSCAPING, FENCE, ETC.
 6. SEE LANDSCAPE PLAN FOR PLANTINGS AND LANDSCAPE RESTORATION.
 7. REMOVE AND RELOCATE EXISTING STREET TREES FOR MAINTENANCE ACCESS.
 8. REGRADE AREA ABOVE OUTFALL TO PROVIDE MINIMUM ±8' WIDE AREA FOR MAINTENANCE ACCESS. MATCH EXISTING AT 2:1 MAX.
 9. INSTALL ±270 (TOTAL) LF OF CHAIN LINK FENCE (TYPE CL-4) ALONG EXISTING PATH PER ODOT STANDARD DRAWING R0815/CS00. MATCH EXISTING COLOR AND STYLE. ATTACH NEW CHAIN LINK FENCE TO EXISTING CHAIN LINK FENCE POST USING STEEL WIRE CLIPS.
 10. INSTALL STRAW WATTLES PER CWS DRAWING NO. 880/CS00. ESC MEASURES MUST BE IN PLACE AND FUNCTIONAL PRIOR TO COMMENCEMENT OF CONSTRUCTION ACTIVITIES.
 11. END CHAIN LINK FENCE
- P. CONTRACTOR TO PROTECT AT ALL TIMES THROUGHOUT DEMOLITION AND CONSTRUCTION. ANY DAMAGE SHALL BE REPAIRED AT CONTRACTOR'S EXPENSE.

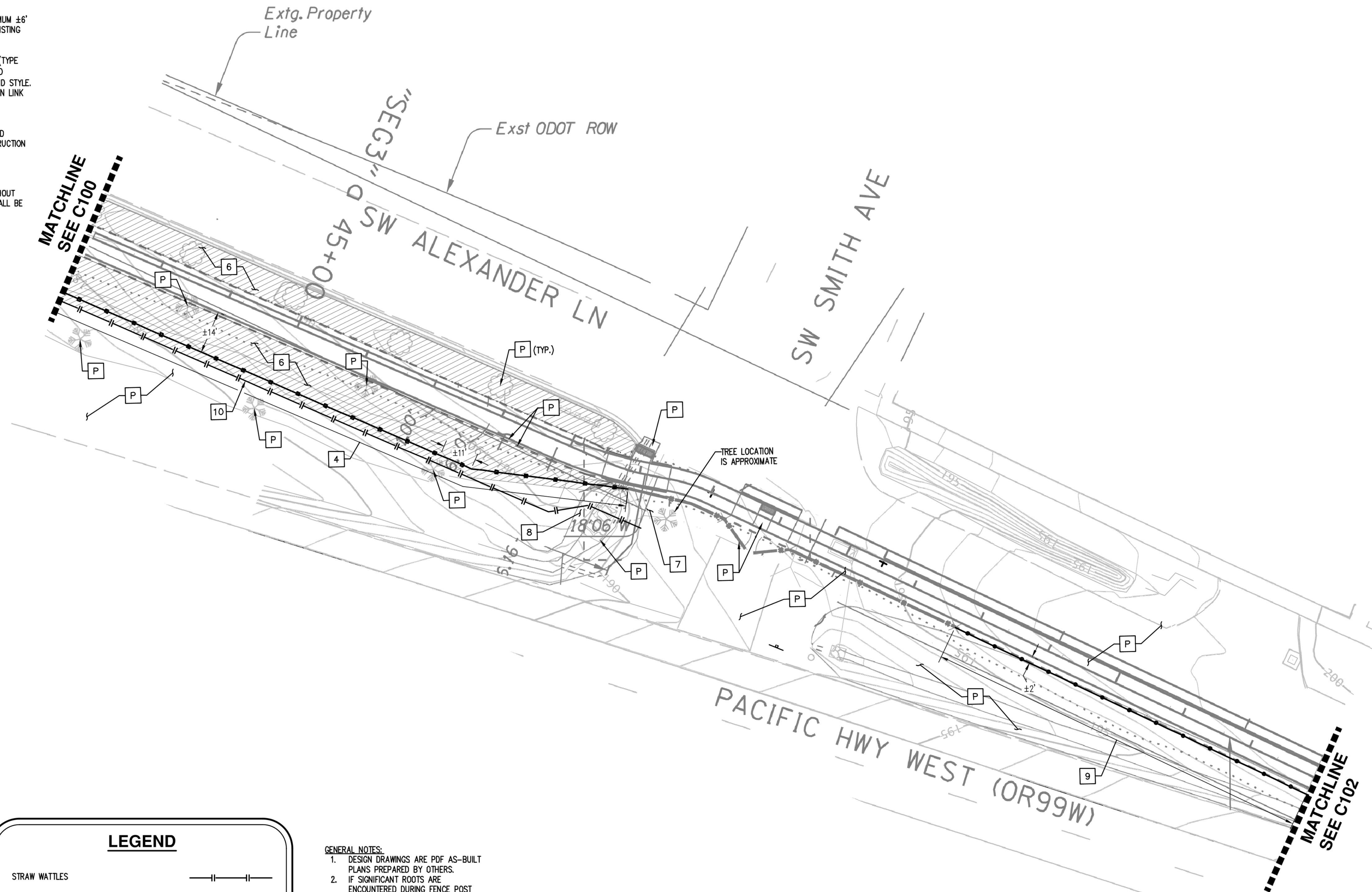

LEGEND

- STRAW WATTLES
- PREFABRICATED SOUND FENCE
- CHAIN LINK FENCE
- RESTORE LANDSCAPING

GENERAL NOTES:

1. DESIGN DRAWINGS ARE PDF AS-BUILT PLANS PREPARED BY OTHERS.
2. IF SIGNIFICANT ROOTS ARE ENCOUNTERED DURING FENCE POST INSTALLATION, THE FENCE POSTS SHALL BE SHIFTED SO AS TO AVOID TREE ROOTS.
3. ALL DIMENSIONS ARE TO EDGE OF AC PATHWAY UNLESS SPECIFIED OTHERWISE.

AKS DRAWING FILE: 9965_FENCE.DWG | LAYOUT: C101

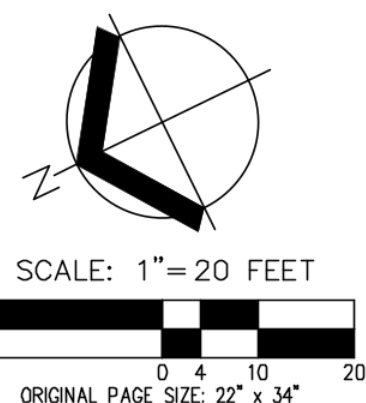

AKS
 AKS ENGINEERING & FORESTRY, LLC
 12065 SW HERMAN RD. STE 100
 TUALATIN, OR 97062
 503.563.6151
 WWW.AKS-ENG.COM

ENGINEERING · SURVEYING · NATURAL RESOURCES
 FORESTRY · PLANNING · LANDSCAPE ARCHITECTURE

**CEDAR CREEK GREENWAY
 FENCE IMPROVEMENTS
 SHERWOOD OREGON**
WASHINGTON COUNTY ASSESSOR'S TAX MAP 251300C
 PUBLIC RIGHT-OF-WAY

SITE PLAN

DESIGNED BY: AMC
 DRAWN BY: JAM
 MANAGED BY: AMC
 CHECKED BY: AMC

DATE: 04/15/2024



REVISIONS

JOB NUMBER
9965

SHEET
C101

KEYED NOTES:

1. INSTALL ±25 LF OF 7' TALL PREFABRICATED BARRIER FENCE PER MANUFACTURER'S RECOMMENDATIONS. EXTEND SOUND FENCE BEHIND EXISTING CEDAR PLANK FENCE, OVERLAP 2 LF MINIMUM.
 2. INSTALL ±114 LF OF 7' TALL PREFABRICATED BARRIER FENCE PER MANUFACTURER'S RECOMMENDATIONS.
 3. REMOVE EXISTING ODOT YARD FENCE AND INSTALL ±146 LF OF 7' TALL PREFABRICATED BARRIER FENCE PER MANUFACTURER'S RECOMMENDATIONS.
 4. INSTALL ±354 (TOTAL) LF OF 8' TALL PREFABRICATED BARRIER FENCE PER MANUFACTURER'S RECOMMENDATIONS.
 5. GRIND AND REMOVE EXISTING STUMP. PRESERVE SURROUNDING PATHWAY, LANDSCAPING, FENCE, ETC.
 6. SEE LANDSCAPE PLAN FOR PLANTINGS AND LANDSCAPE RESTORATION.
 7. REMOVE AND RELOCATE EXISTING STREET TREES FOR MAINTENANCE ACCESS.
 8. REGRADE AREA ABOVE OUTFALL TO PROVIDE MINIMUM ±8' WIDE AREA FOR MAINTENANCE ACCESS. MATCH EXISTING AT 2:1 MAX.
 9. INSTALL ±270 (TOTAL) LF OF CHAIN LINK FENCE (TYPE CL-4) ALONG EXISTING PATH PER ODOT STANDARD DRAWING R0815/CS00. MATCH EXISTING COLOR AND STYLE. ATTACH NEW CHAIN LINK FENCE TO EXISTING CHAIN LINK FENCE POST USING STEEL WIRE CLIPS.
 10. INSTALL STRAW WATTLES PER CWS DRAWING NO. 880/CS00. ESC MEASURES MUST BE IN PLACE AND FUNCTIONAL PRIOR TO COMMENCEMENT OF CONSTRUCTION ACTIVITIES.
 11. END CHAIN LINK FENCE
- P. CONTRACTOR TO PROTECT AT ALL TIMES THROUGHOUT DEMOLITION AND CONSTRUCTION. ANY DAMAGE SHALL BE REPAIRED AT CONTRACTOR'S EXPENSE.

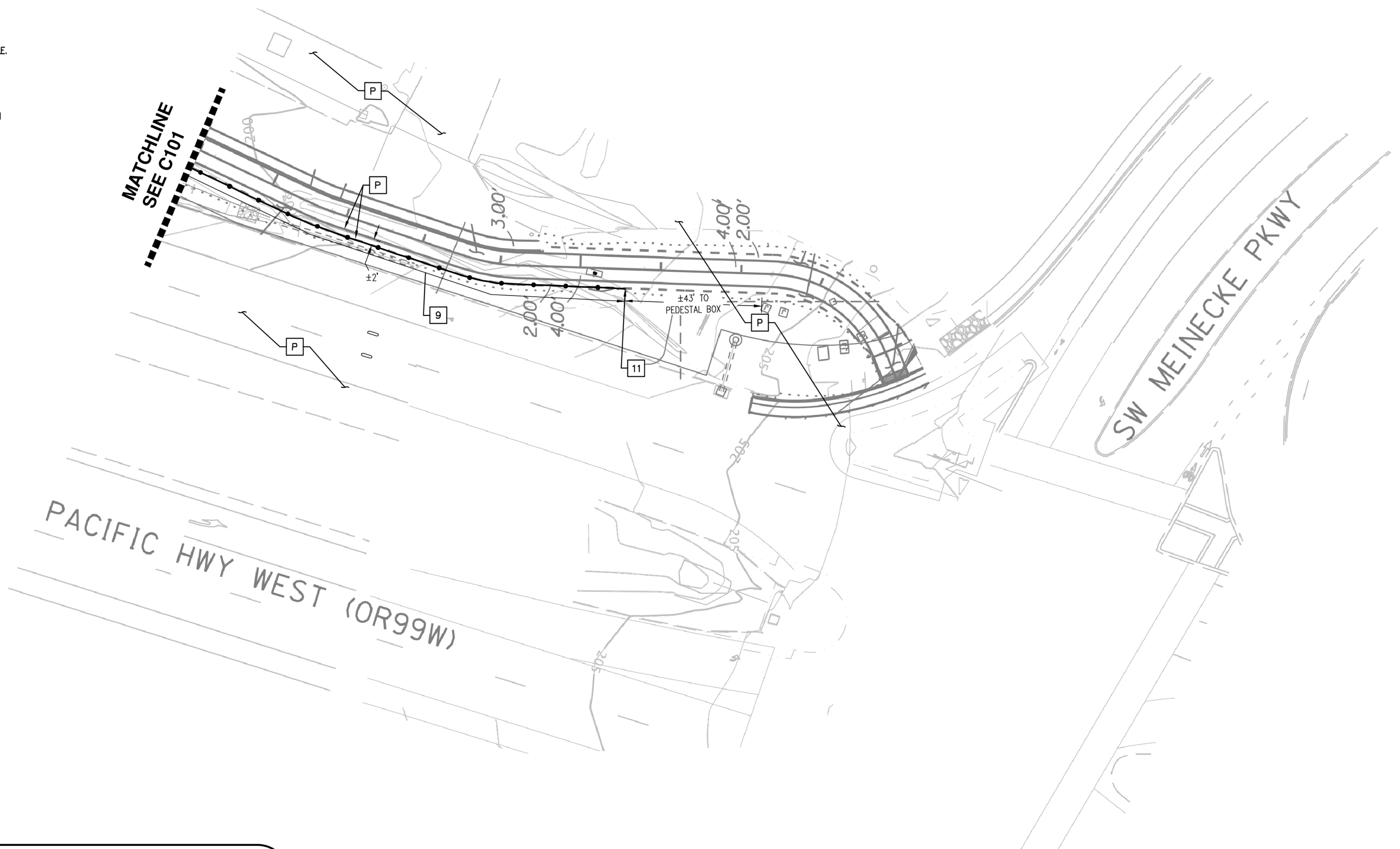

LEGEND

- STRAW WATTLES
- PREFABRICATED SOUND FENCE
- CHAIN LINK FENCE
- RESTORE LANDSCAPING

GENERAL NOTES:

1. DESIGN DRAWINGS ARE PDF AS-BUILT PLANS PREPARED BY OTHERS.
2. IF SIGNIFICANT ROOTS ARE ENCOUNTERED DURING FENCE POST INSTALLATION, THE FENCE POSTS SHALL BE SHIFTED SO AS TO AVOID TREE ROOTS.
3. ALL DIMENSIONS ARE TO EDGE OF AC PATHWAY UNLESS SPECIFIED OTHERWISE.

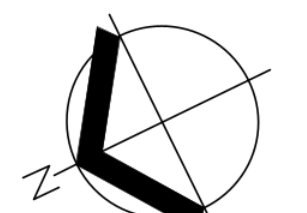

SCALE: 1" = 20 FEET
 ORIGINAL PAGE SIZE: 22" x 34"

AKS DRAWING FILE: 9965_FENCE.DWG | LAYOUT: C009

AKS
 AKS ENGINEERING & FORESTRY, LLC
 12065 SW HERMAN RD. STE 100
 TUALATIN, OR 97062
 503.563.6151
 WWW.AKS-ENG.COM

ENGINEERING · SURVEYING · NATURAL RESOURCES
 FORESTRY · PLANNING · LANDSCAPE ARCHITECTURE

**CEDAR CREEK GREENWAY
 FENCE IMPROVEMENTS**
 SHERWOOD OREGON
WASHINGTON COUNTY ASSESSOR'S TAX MAP 251300C
 PUBLIC RIGHT-OF-WAY

SITE PLAN

DESIGNED BY: AMC
 DRAWN BY: JAM
 MANAGED BY: AMC
 CHECKED BY: AMC

DATE: 04/15/2024



REVISIONS

JOB NUMBER
9965

SHEET
C102

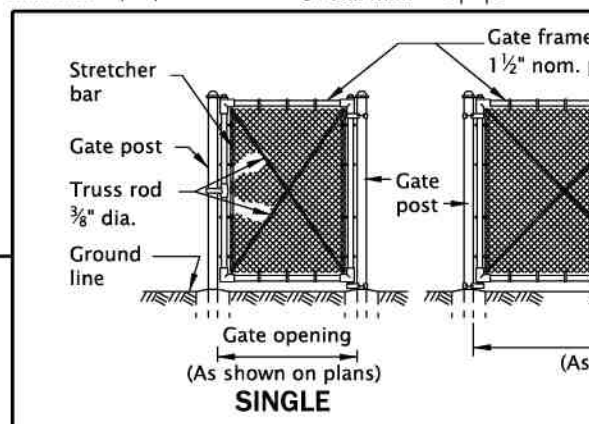
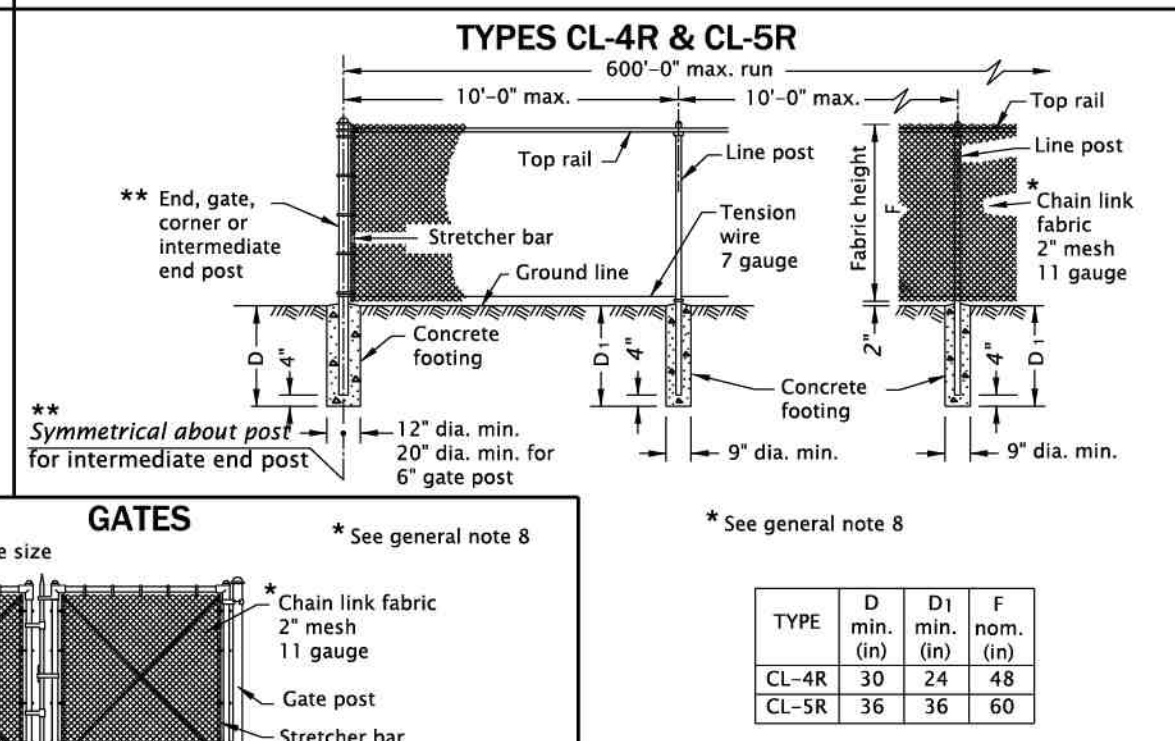
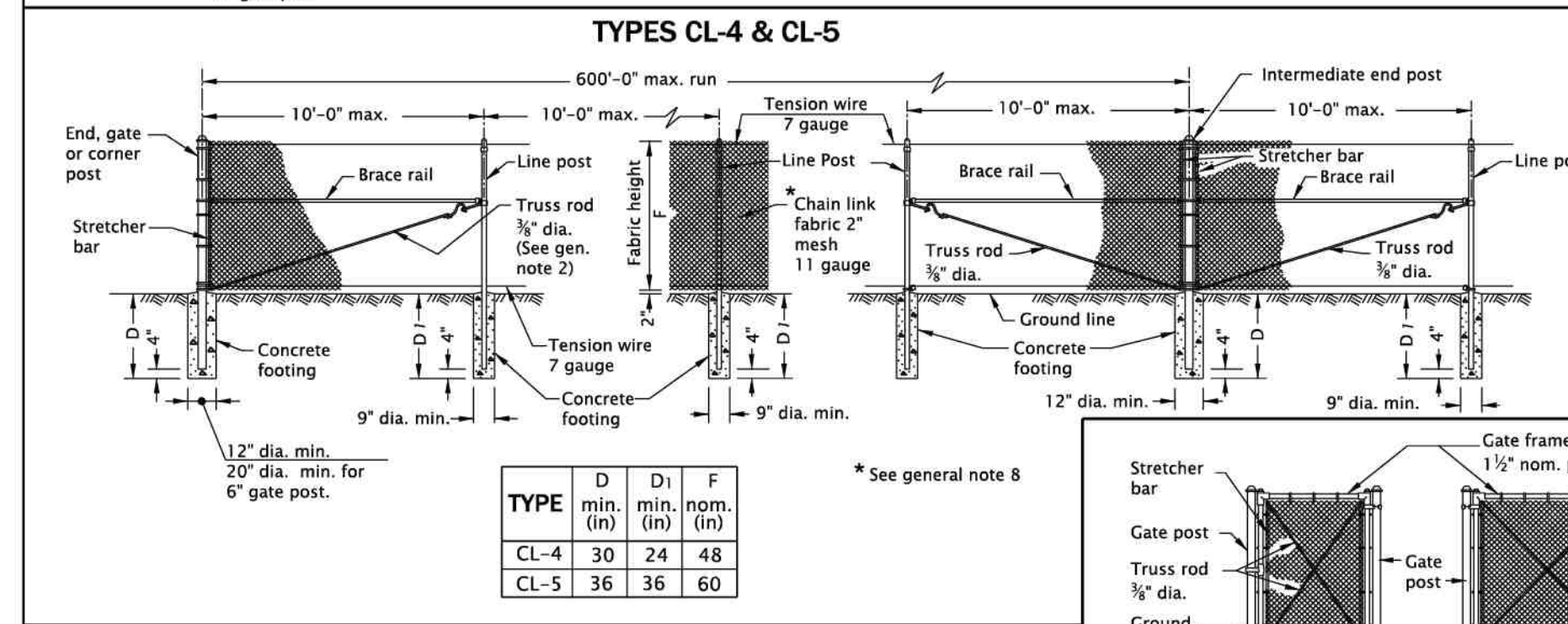
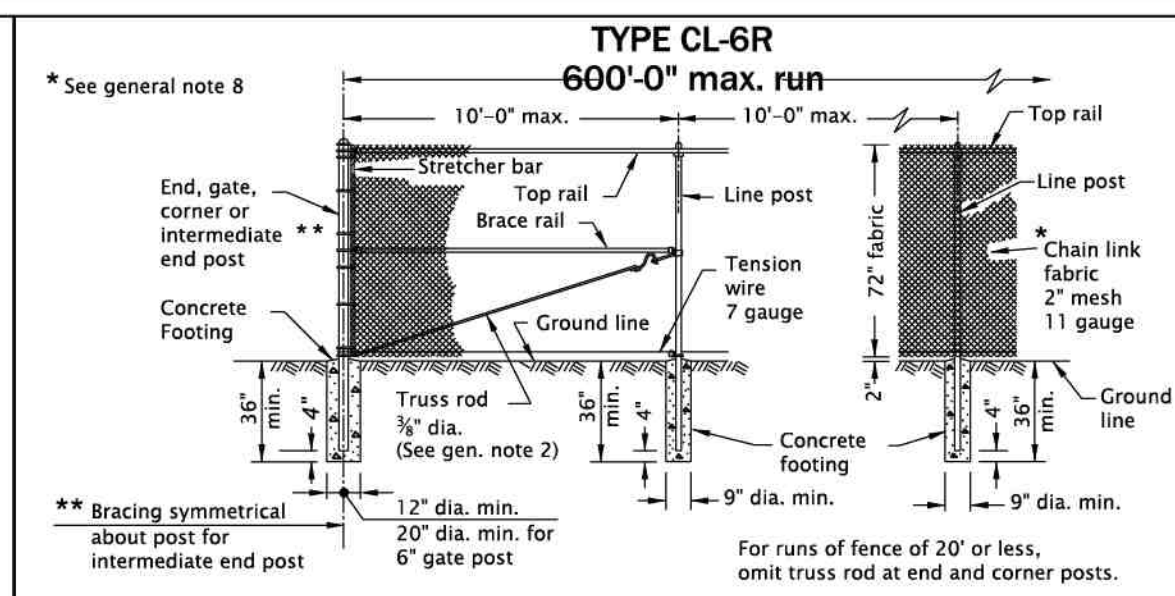
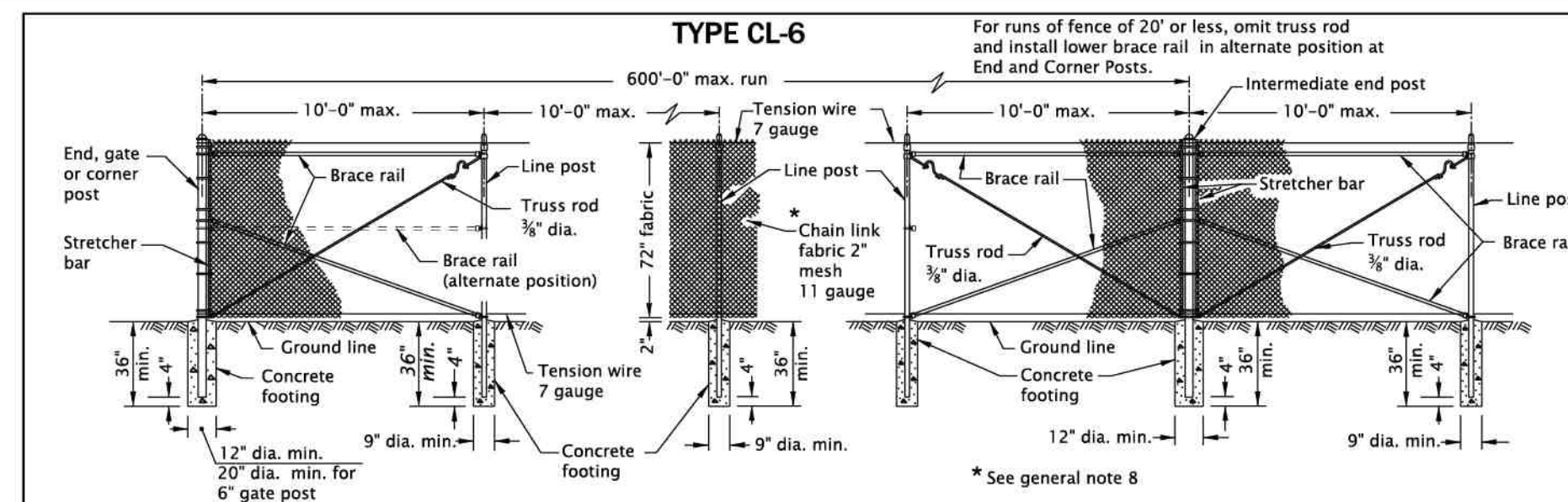

TYPE	D min. (in)	D1 min. (in)	F nom. (in)
CL-4	30	24	48
CL-5	36	36	60

TABLE 1

TYPE	MEMBER									
	BRACE AND TOP RAILS		LINE POSTS		END, CORNER & INTERMEDIATE END POST		GATE OPENING (ft)		GATE POSTS	
	TUBULAR	TUBULAR	TUBULAR	H-SECTION	TUBULAR	TUBULAR	SINGLE GATE	DOUBLE GATE	Fence Industry (in)	Norm. Dia. (in)
CL-4 & CL-4R	1 1/2"	1 1/2"	1 1/2"	1 1/2" x 1 1/2"	2 1/2"	2"	Up thru 6	Up thru 12	2 1/2"	2 1/2"
CL-5 & CL-5R	1 1/2"	1 1/2"	1 1/2"	1 1/2" x 1 1/2"	2 1/2"	2"	7 thru 13	13 thru 26	4"	3 1/2"
CL-6 & CL-6R	1 1/2"	2"	2"	2 1/2" x 2"	4.10"	2 1/2"	14 thru 18	27 thru 36	6"	6"

NOTE: For CL-6, CL-6R, CL-8, CL-8R, CL-10 & CL-10R, the hardware is minimum and does not include slat wind loading.

GENERAL NOTES FOR ALL DETAILS ON THIS SHEET:

- Do not use top rail where fence can be struck by an errant vehicle.
- Fittings shown are illustrative of use and not specific as to design.
- Gate posts on each side of a gate opening to be the same size. At a double gate installation with unequal width gates, size of both posts to be as indicated for a single gate installation of the wider gate width.
- For cross sectional dimensions of members, see Table 1.
- Posts and rails with sections not shown that meet the requirements of AASHTO M 81 are acceptable alternates. See ODOT's OPL for acceptable alternates.
- All concrete shall be commercial grade concrete.
- All chain link fabric top and bottom selvage shall be knuckled finish.
- Chain link fabric for the fence to be installed with pickets shall be 9 gauge wire woven in 3 1/2" by 5 1/2" diamond mesh.
- See project plans for details not shown.
- Add fence grounding as required.

The selection and use of this Standard Drawing, while designed in accordance with generally accepted engineering principles and practices, is the sole responsibility of the user and should not be used without first consulting a Registered Professional Engineer.

All materials shall be in accordance with the current Oregon Standard Specifications.

OREGON STANDARD DRAWINGS

CHAIN LINK FENCE

2021

DATE	REVISION	DESCRIPTION

CALC. BOOK NO. N/A SDR DATE 13-JAN-2020 RD815

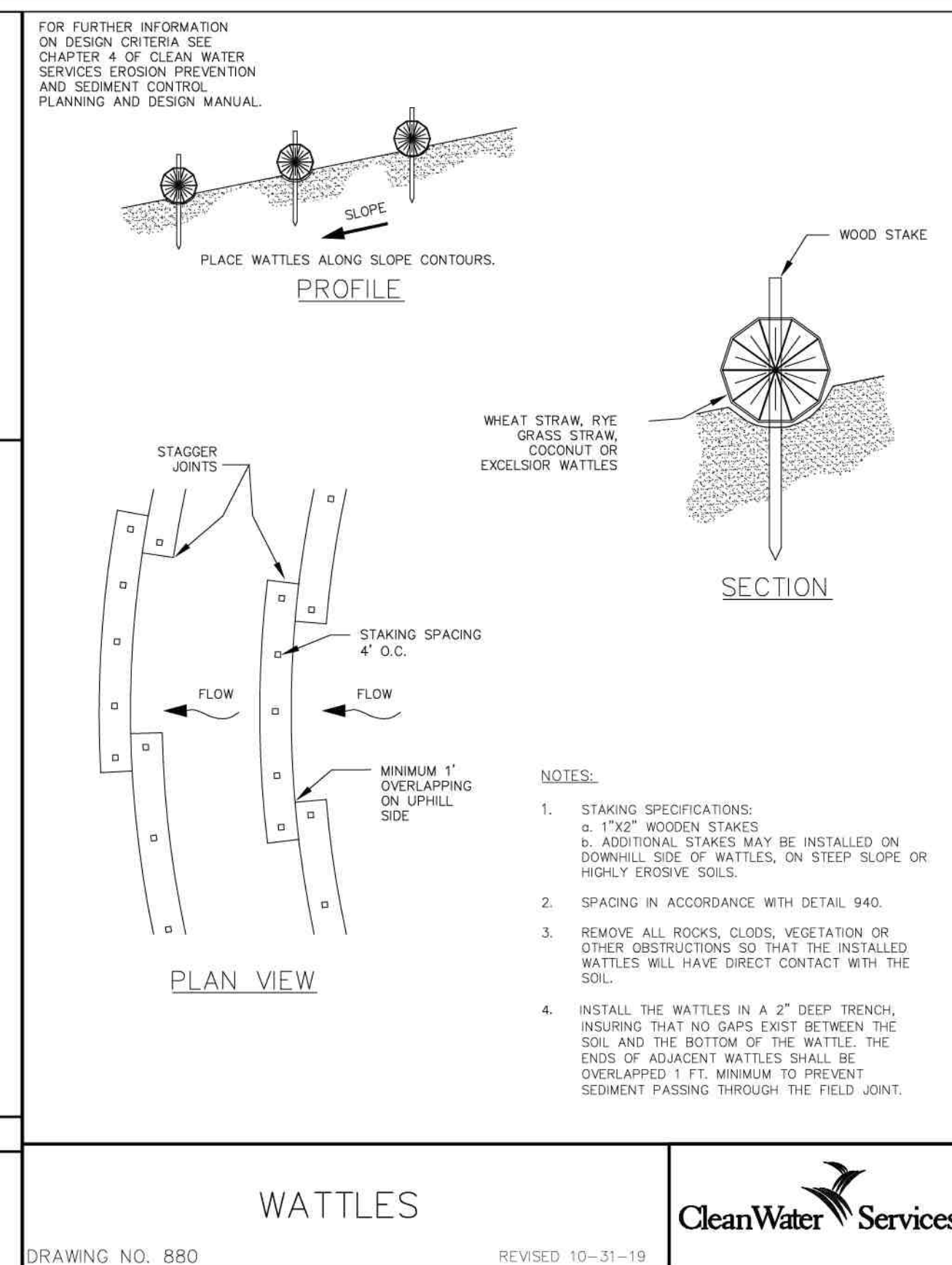

FOR FURTHER INFORMATION ON DESIGN CRITERIA SEE CHAPTER 4 OF CLEAN WATER SERVICES EROSION PREVENTION AND SEDIMENT CONTROL PLANNING AND DESIGN MANUAL.

PLACE WATTLES ALONG SLOPE CONTOURS.

PROFILE

SECTION

PLAN VIEW

STAGGER JOINTS

STAKING SPACING 4' O.C.

MINIMUM 1" OVERLAPPING ON UPHILL SIDE

WHEAT STRAW, RYE GRASS STRAW, COCONUT OR EXCELSIOR WATTLES

WOOD STAKE

NOTES:

- STAKING SPECIFICATIONS: a. 1"x2" WOODEN STAKES b. ADDITIONAL STAKES MAY BE INSTALLED ON DOWNHILL SIDE OF WATTLES, ON STEEP SLOPE OR HIGHLY ERODIVE SOILS.
- SPACING IN ACCORDANCE WITH DETAIL 940.
- REMOVE ALL ROCKS, CLDS, VEGETATION OR OTHER OBSTRUCTIONS SO THAT THE INSTALLED WATTLES WILL HAVE DIRECT CONTACT WITH THE SOIL.
- INSTALL THE WATTLES IN A 2" DEEP TRENCH, INSURING THAT NO GAPS EXIST BETWEEN THE SOIL AND THE BOTTOM OF THE WATTLE. THE ENDS OF ADJACENT WATTLES SHALL BE OVERLAPPED 1 FT. MINIMUM TO PREVENT SEDIMENT PASSING THROUGH THE FIELD JOINT.



AESTHETIC BARRIER FENCE REFERENCE IMAGE #1
NTS



AESTHETIC BARRIER FENCE REFERENCE IMAGE #2
NTS



AESTHETIC BARRIER FENCE REFERENCE IMAGE #3
NTS

AKS DRAWING FILE: 9965 DETAILS.DWG | LAYOUT: C500

AKS
AKS ENGINEERING & FORESTRY, LLC
12965 SW HERMAN RD. STE 100
TUALATIN, OR 97062
503.563.6151
WWW.AKS-ENG.COM

**CEDAR CREEK GREENWAY
FENCE IMPROVEMENTS**

SHERWOOD OREGON

ENGINEERING · SURVEYING · NATURAL RESOURCES
FORESTRY · PLANNING · LANDSCAPE ARCHITECTURE

WASHINGTON COUNTY ASSESSOR'S TAX MAP 251300C
PUBLIC RIGHT-OF-WAY

DETAILS

DESIGNED BY: AMC
DRAWN BY: JAM
MANAGED BY: AMC
CHECKED BY: AMC
DATE: 04/15/2024

REGISTERED PROFESSIONAL ENGINEER
97708PE
DIGITALLY SIGNED
SEPTEMBER 14, 2024
AUSTIN MORGAN COLE
RENEWS: DECEMBER 31, 2025

JOB NUMBER
9965

SHEET
C500

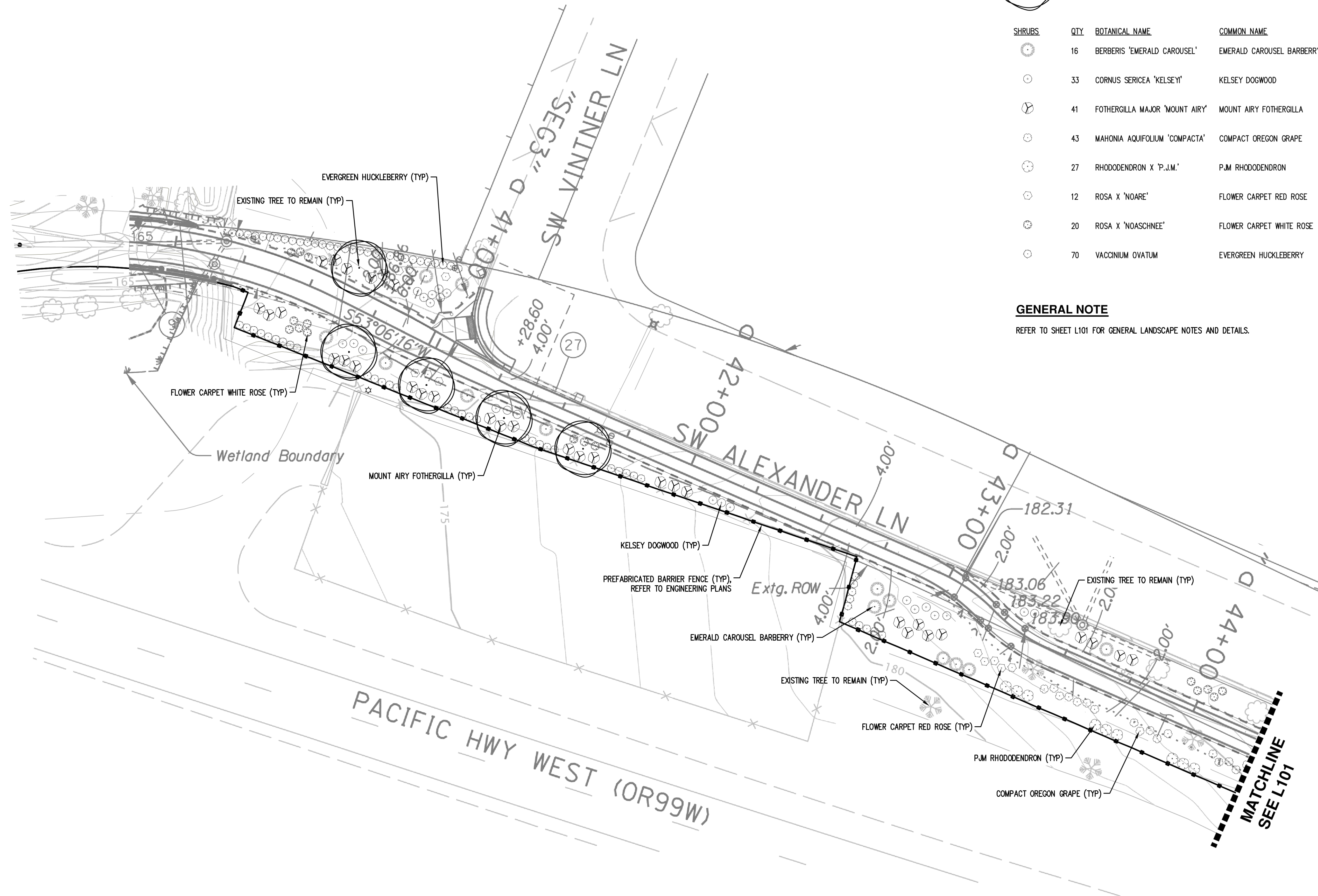

PLANT SCHEDULE

TREES	QTY	BOTANICAL NAME	COMMON NAME	SIZE/CONTAINER	SPACING
	5	EXISTING TREE TO REMAIN			AS SHOWN
SHRUBS	QTY	BOTANICAL NAME	COMMON NAME	SIZE/CONTAINER	SPACING
	16	BERBERIS 'EMERALD CAROUSEL'	EMERALD CAROUSEL BARBERRY	5 GAL CONT.	60" o.c.
	33	CORNUS SERICEA 'KELSEY'	KELSEY DOGWOOD	5 GAL CONT.	36" o.c.
	41	FOTHERGILLA MAJOR 'MOUNT AIRY'	MOUNT AIRY FOTHERGILLA	5 GAL CONT.	48" o.c.
	43	MAHONIA AQUIFOLIUM 'COMPACTA'	COMPACT OREGON GRAPE	3 GAL CONT.	36" o.c.
	27	RHODODENDRON X 'P.J.M.'	P.J.M. RHODODENDRON	5 GAL CONT.	48" o.c.
	12	ROSA X 'NOARE'	FLOWER CARPET RED ROSE	3 GAL CONT.	36" o.c.
	20	ROSA X 'NOASCHNEE'	FLOWER CARPET WHITE ROSE	3 GAL CONT.	36" o.c.
	70	VACCINIUM OVATUM	EVERGREEN HUCKLEBERRY	5 GAL CONT.	36" o.c.

GENERAL NOTE
REFER TO SHEET L101 FOR GENERAL LANDSCAPE NOTES AND DETAILS.

DESIGNED BY:	TEB
DRAWN BY:	TEB
MANAGED BY:	AMC
CHECKED BY:	AMC

DATE: 04/15/2024

REGISTERED
1025
DIGITALLY SIGNED
TIMOTHY E. BAUER
OREGON
11/01/19
LANDSCAPE ARCHITECT

REVISIONS

JOB NUMBER
9965

SHEET
L100

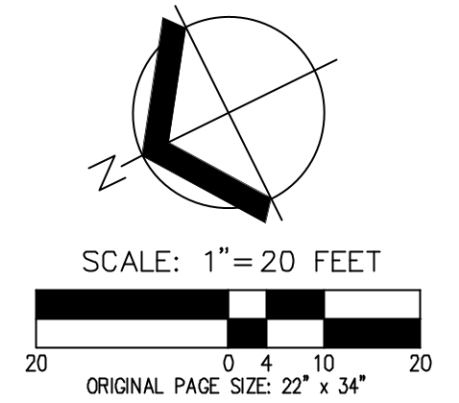

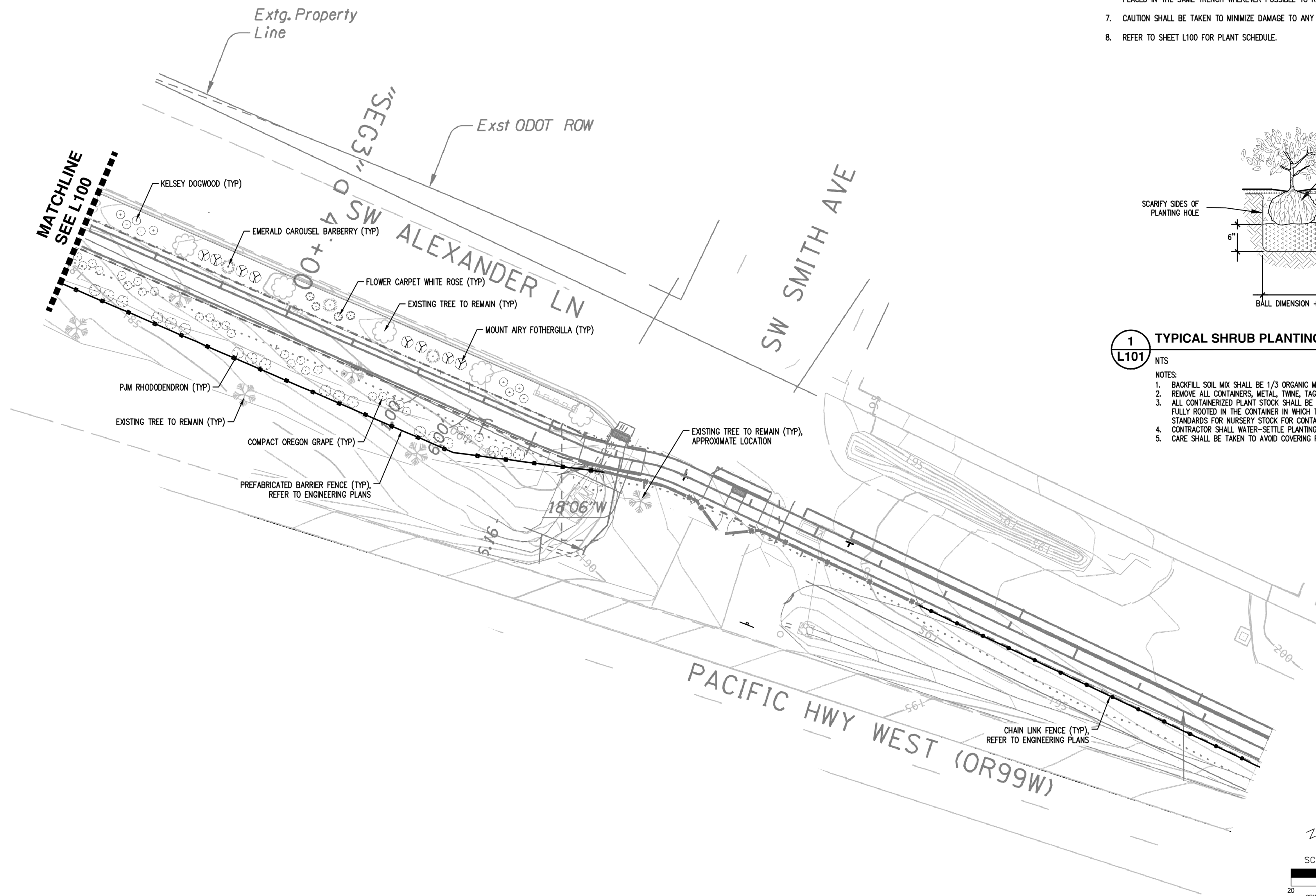

GENERAL LANDSCAPE NOTES

- CONTRACTOR IS RESPONSIBLE FOR VERIFYING PLANT QUANTITIES. IF DISCREPANCIES OCCUR, DESIGN INTENT PREVAILS OVER QUANTITIES LISTED.
- PLANT SPECIES, SIZES, LOCATIONS, QUANTITIES, AND OTHER PLAN CHANGES MAY BE SUBSTITUTED OR REVISED PRIOR TO FINAL SUBMITTAL DUE TO SITE CONDITIONS AND PLANT AVAILABILITY WHERE ALLOWED BY SHERWOOD DESIGN STANDARDS.
- SOIL PREPARATION: ALL TREE, SHRUB, AND GROUND COVER AREAS SHALL HAVE A MINIMUM OF 12" OF CLEAN TOPSOIL, PLUS AN ADDITIONAL 24" OF NON-COMPACTED SUBSOIL AVAILABLE. EXISTING NATIVE SOIL OR STOCKPILED TOPSOIL STRIPPING MAY BE USED. TOPSOIL SHALL BE RICH DARK BROWN IN COLOR AND VOID OF ROOTS, PLANTS, WEED SEEDS, SOIL, STONES, CLAY LUMPS, ALKALI SALTS, DEBRIS, AND OTHER EXTRANEOUS MATERIALS HARMFUL TO PLANT GROWTH. FINISH GRADE OF NEW PLANTING AREAS SHALL SEAMLESSLY MEET FINISH GRADE OF EXISTING LANDSCAPE AREAS TO REMAIN AND AS SHOWN ON GRADING PLANS. TOPSOIL SHALL BE PLACED AND WORKED IN FRIABLE (WORKABLE) CONDITION. BACKFILL ALL PLANTING HOLES WITH 1/3 ORGANIC MATERIALS, 1/3 TOPSOIL, AND 1/3 SANDY LOAM.
- MULCH: APPLY 3" DEEP MEDIUM GRIND OR SHREDDED DARK HEMLOCK OR FIR MULCH AROUND ALL PLANTINGS. DO NOT COVER FOLIAGE OR ROOT CROWNS OF PLANTS WITH BARK MULCH. TREES AND OTHER PLANTS SHALL BE SET TO ACCOMMODATE MULCH APPLICATION WITHOUT BURYING ROOT CROWNS.
- IRRIGATION: LANDSCAPE CONTRACTOR SHALL BE RESPONSIBLE FOR PROVIDING AND INSTALLING A PERMANENT, UNDERGROUND 'DESIGN-BUILD' IRRIGATION SYSTEM TO WATER ALL NEW PLANTING BED AREAS. COORDINATE POINT-OF-CONNECTION (POC), CITY APPROVED DOUBLE-CHECK VALVE ASSEMBLY, AND SLEEVING LOCATIONS WITH GENERAL CONTRACTOR AND CITY PRIOR TO INSTALLATION OF HARD SURFACING (SIDEWALKS, ROADWAYS, ETC.).
- IRRIGATION LINES, VALVES, AND HEADS ARE TO BE PLACED NO CLOSER THAN 10' (MINIMUM) FROM TREES TO REMAIN. IRRIGATION LINES TO BE PLACED IN THE SAME TRENCH WHEREVER POSSIBLE TO REDUCE TRENCHING. GROUP CONTROL VALVE BOXES WHERE POSSIBLE.
- CAUTION SHALL BE TAKEN TO MINIMIZE DAMAGE TO ANY TREE ROOTS. HAND DIG AROUND ANY ROOTS 1-INCH OR LARGER.
- REFER TO SHEET L100 FOR PLANT SCHEDULE.

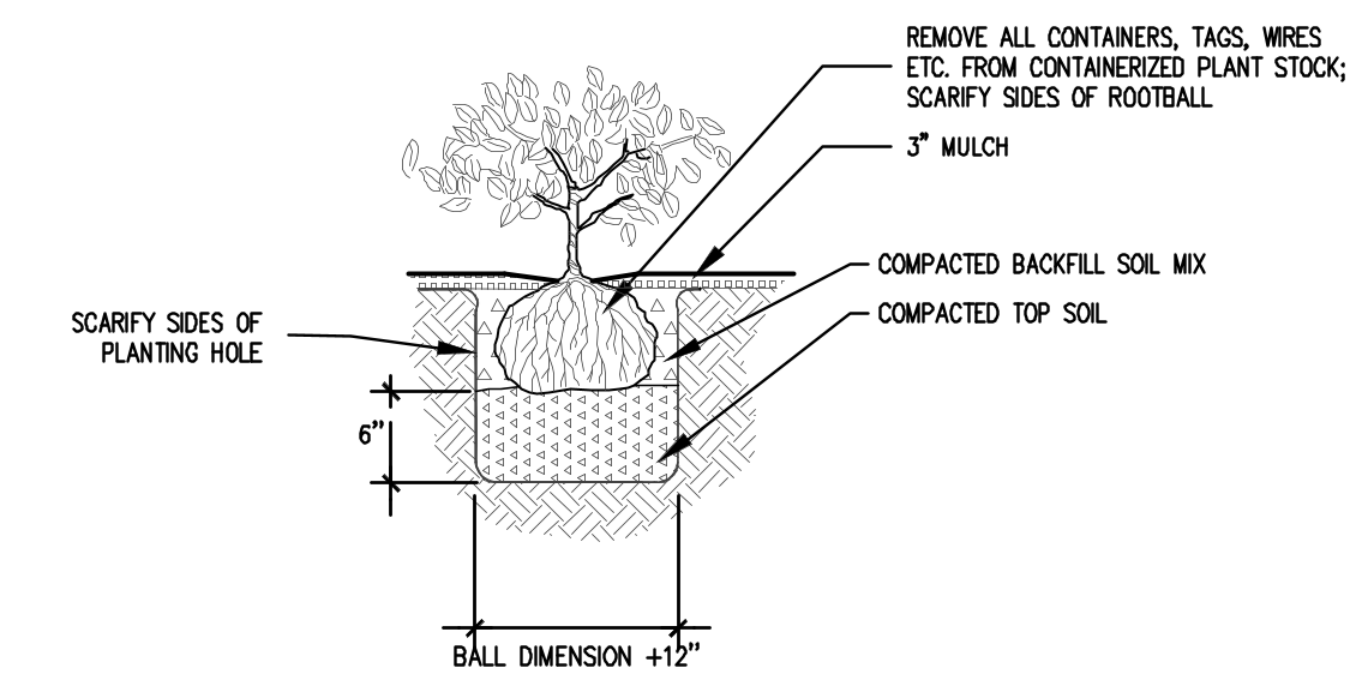

1 TYPICAL SHRUB PLANTING DETAIL

- 1**
L101
- NTS
- NOTES:
- BACKFILL SOIL MIX SHALL BE 1/3 ORGANIC MATERIALS, 1/3 TOPSOIL, AND 1/3 SANDY LOAM.
 - REMOVE ALL CONTAINERS, METAL, TWINE, TAGS, AND OTHER NON-BIODEGRADABLE MATERIALS PRIOR TO PLANTING.
 - ALL CONTAINERIZED PLANT STOCK SHALL BE VIGOROUS, FREE OF DISEASE AND PESTS, EVENLY FORMED, AND BE FULLY ROOTED IN THE CONTAINER IN WHICH THEY ARE DELIVERED. ALL PLANTS SHALL FOLLOW ANSI Z60.1 STANDARDS FOR NURSERY STOCK FOR CONTAINER SIZE, HEIGHT, ETC.
 - CONTRACTOR SHALL WATER-SETTLE PLANTING HOLES TO REMOVE AIR POCKETS PRIOR TO SPREADING MULCH.
 - CARE SHALL BE TAKEN TO AVOID COVERING ROOT CROWN OR FOLIAGE OF PLANTS WITH BARK MULCH.

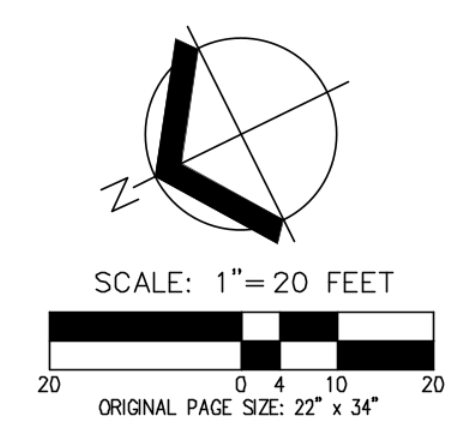

DESIGNED BY:	TEB
DRAWN BY:	TEB
MANAGED BY:	AMC
CHECKED BY:	AMC



REVISIONS

JOB NUMBER	9965
SHEET	L101