

CEDAR CREEK GREENWAY FENCE IMPROVEMENTS

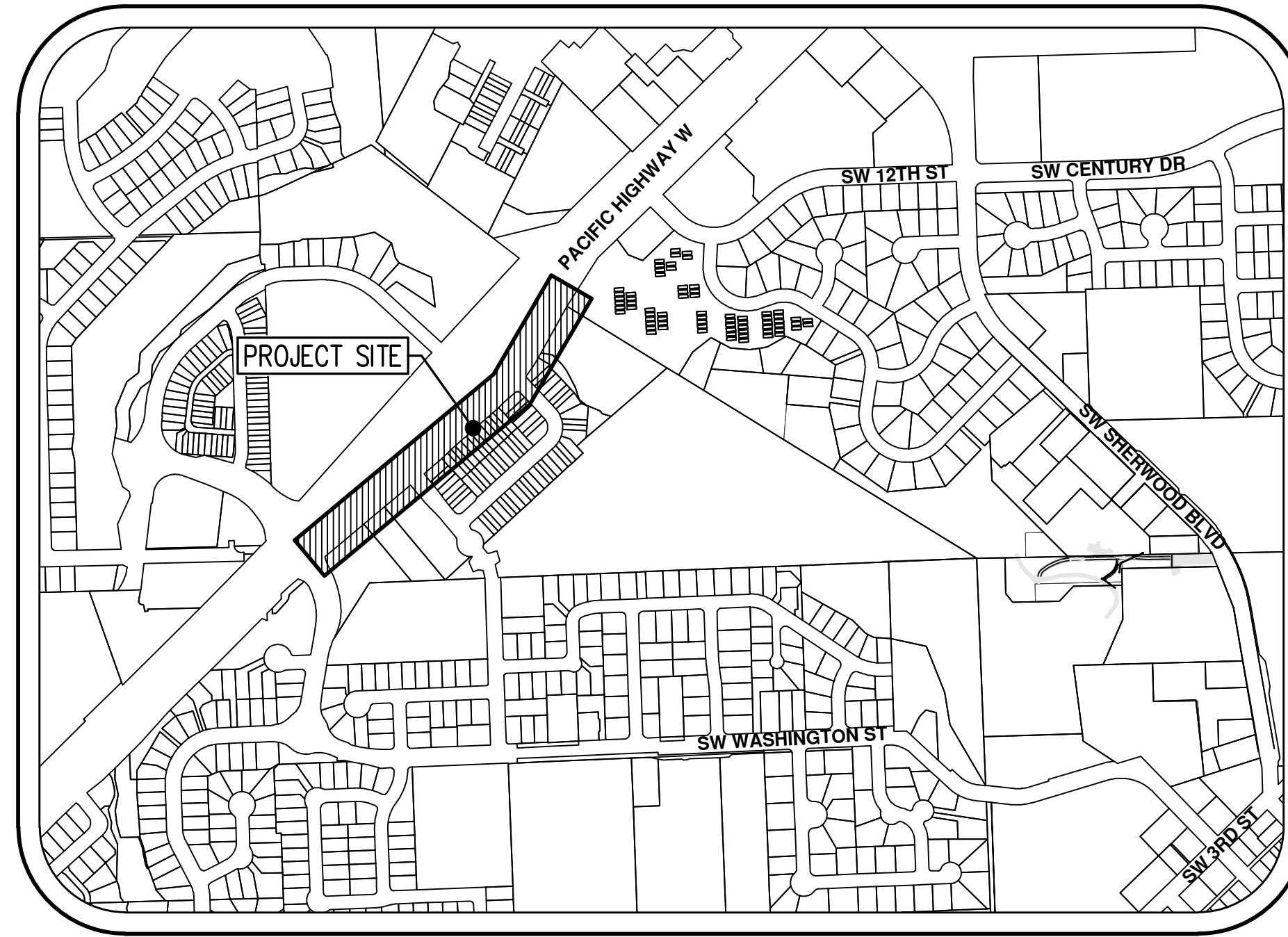

VICINITY MAP
N.T.S.

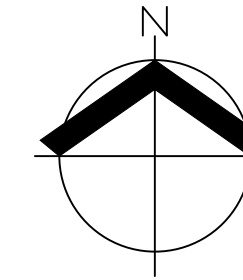

AS-BUILT PLAN LEGEND

CONSTRUCTION LEGEND

- Retaining Wall
- Cut Line
- Fill Line
- Anchor Mesh Wall
- Mat Stone Embankment
- Aggregate Shoulder
- Edge of Asphalt Concrete
- Chain Link Fence
- Orange Plastic Mesh Fence

PROJECT TEAM



OWNER

CITY OF SHERWOOD
22560 SW PINE ST,
SHERWOOD, OR 97140
CONTACT: JASON WATERS

ENGINEERING LANDSCAPE ARCHITECTURE

AKS ENGINEERING & FORESTRY, LLC.
12965 SW HERMAN ROAD SUITE 100
TUALATIN, OR 97062
CONTACT: AUSTIN COLE, PE
PHONE: 503.563.6151
FAX: 503.563.6152

SHEET INDEX

- C000 COVER SHEET WITH VICINITY MAP, SITE MAP, & LEGEND
- C001 GENERAL CONSTRUCTION NOTES
- C100 SITE PLAN
- C101 SITE PLAN
- C102 SITE PLAN
- C500 DETAILS
- L100 LANDSCAPE PLAN
- L101 LANDSCAPE PLAN

PROJECT PURPOSE

INSTALL SOUND AND CHAIN LINK FENCE AND LANDSCAPING ALONG THE EXISTING CEDAR CREEK TRAIL.

VERTICAL DATUM

NAVD88 PER AS-BUILT PLANS PREPARED BY OTHERS

EXISTING LAND USE

THE SUBJECT PROPERTY CONSISTS OF AN ASPHALT TRAIL.

PROJECT LOCATION

CEDAR CREEK TRAIL NORTHWEST OF SW ALEXANDER LANE AND SOUTHWEST OF OR-99W IN SHERWOOD, OR.

LAT: 45°21'43" N

LONG: 122°51'15" W

PROPERTY DESCRIPTION

PUBLIC RIGHT-OF-WAY, LOCATED IN THE SOUTHEAST 1/4 OF SECTION 30, TOWNSHIP 2 SOUTH, RANGE 1 WEST, WILLAMETTE MERIDIAN, CITY OF SHERWOOD, WASHINGTON COUNTY, OREGON. WASHINGTON COUNTY TAX ASSESSORS MAP 2S130DC

ATTENTION EXCAVATORS:

OREGON LAW REQUIRES YOU TO FOLLOW RULES ADOPTED BY THE OREGON UTILITY NOTIFICATION CENTER. THOSE RULES ARE SET FORTH IN OAR 952-001-0010 THROUGH OAR 952-001-0090. YOU MAY OBTAIN COPIES OF THESE RULES FROM THE CENTER BY CALLING 503-232-1987. IF YOU HAVE ANY QUESTIONS ABOUT THE RULES, YOU MAY CONTACT THE CENTER. YOU MUST NOTIFY THE CENTER AT LEAST TWO BUSINESS DAYS BUT NOT MORE THAN TEN BUSINESS DAYS, BEFORE COMMENCING AN EXCAVATION. CALL 503-246-6699.



Know what's below.
Call before you dig.

AKS
ENGINEERING & FORESTRY, LLC
12965 SW HERMAN RD. SUITE 100
TUALATIN, OR 97062
503.563.6151
WWW.AKS-ENG.COM

ENGINEERING - SURVEYING - NATURAL RESOURCES
FORESTRY - PLANNING - LANDSCAPE ARCHITECTURE

CEDAR CREEK GREENWAY
FENCE IMPROVEMENTS
SHERWOOD
OREGON
WASHINGTON COUNTY ASSESSOR'S TAX MAP 2S130DC
PUBLIC RIGHT-OF-WAY

COVER SHEET WITH
VICINITY MAP, SITE MAP, &
LEGEND

DESIGNED BY: AMC
DRAWN BY: JAM
MANAGED BY: AMC
CHECKED BY: AMC

DATE: 2/13/2024

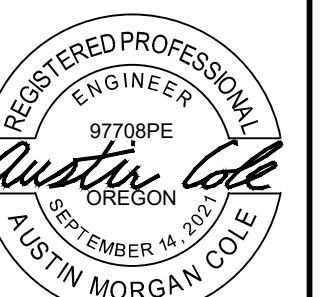

RENEWS: DECEMBER 31, 2023

REVISIONS

JOB NUMBER
9965

SHEET
C000

GENERAL CIVIL NOTES

- 1. CONTRACTOR MUST BE LICENSED BY THE STATE OF OREGON AND SHALL PROCURE, PAY ALL COSTS FOR, AND CONFORM TO ALL CONSTRUCTION PERMITS REQUIRED BY THE CITY OF SHERWOOD, WASHINGTON COUNTY, AND ODOT.
2. OWNER TO PAY ALL PROJECT PERMIT COSTS, INCLUDING BUT NOT LIMITED TO UTILITY TAPPING, TV, AND CHLORINATION COSTS.
3. OREGON LAW REQUIRES YOU TO FOLLOW RULES ADOPTED BY THE OREGON UTILITY NOTIFICATION CENTER.
4. CONTRACTOR TO NOTIFY CITY, COUNTY, ODOT, AKS PROJECT ENGINEER, AND ALL UTILITY COMPANIES A MINIMUM OF 5 BUSINESS DAYS PRIOR TO START OF CONSTRUCTION AND COMPLY WITH ALL OTHER NOTIFICATION REQUIREMENTS OF AGENCIES WITH JURISDICTION OVER THE WORK.
5. CONTRACTOR SHALL PROCURE A RIGHT-OF-ENTRY PERMIT FROM WASHINGTON COUNTY FOR ALL WORK WITHIN THE COUNTY RIGHT-OF-WAY AND CONFORM TO ALL CONDITIONS OF THE PERMIT.
6. CONTRACTOR SHALL PROVIDE ALL BONDS AND INSURANCE REQUIRED BY PUBLIC AND/OR PRIVATE AGENCIES HAVING JURISDICTION.
7. PRIOR TO BEGINNING WORK, THE CONTRACTOR SHALL COORDINATE A PRE-CONSTRUCTION MEETING BETWEEN THE ENGINEER, OWNER'S REPRESENTATIVE, MAJOR SUBCONTRACTORS, AND PERMITTING AGENCIES.
8. IT IS THE RESPONSIBILITY OF THE CONTRACTOR TO REVIEW ALL OF THE DOCUMENTS AND PLANS ASSOCIATED WITH THE PROJECT WORK SCOPE PRIOR TO THE INITIATION OF CONSTRUCTION.
9. SHOULD THE CONTRACTOR FIND A CONFLICT WITH THE DOCUMENTS/PLANS RELATIVE TO THE SPECIFICATIONS OR THE APPLICABLE CODES, IT IS THE CONTRACTOR'S RESPONSIBILITY TO NOTIFY THE OWNER'S REPRESENTATIVE IN WRITING PRIOR TO THE START OF CONSTRUCTION.
10. ALL MATERIALS AND WORKMANSHIP SHALL CONFORM TO THE APPROVED PLANS AND THE APPLICABLE PROVISIONS OF THE APPROVING AGENCIES' CONSTRUCTION STANDARDS.
11. CONTRACTOR SHALL AT ALL TIMES ABIDE BY APPLICABLE SAFETY RULES OF OSHA, IN PARTICULAR THOSE REGULATIONS PERTAINING TO ADEQUATE SHORING AND TRENCH PROTECTION FOR WORKERS.
12. CONSTRUCTION OF ALL PUBLIC FACILITIES SHALL BE DONE WITHIN THE HOURS PERMITTED BY THE GOVERNING JURISDICTION.
13. THE CONTRACTOR SHALL PERFORM ALL WORK NECESSARY TO COMPLETE THE PROJECT IN ACCORDANCE WITH THE APPROVED CONSTRUCTION DRAWINGS INCLUDING SUCH INCIDENTALS AS MAY BE NECESSARY TO MEET APPLICABLE AGENCY REQUIREMENTS AND PROVIDE A COMPLETED PROJECT.
14. ALL DIMENSIONS SHOWN ON THE PLANS SHALL BE FIELD VERIFIED BY THE CONTRACTOR PRIOR TO THE START OF CONSTRUCTION.
15. ANY INSPECTION BY THE CITY, COUNTY, ODOT, AKS, OWNER'S REPRESENTATIVE, OR OTHER AGENCIES SHALL NOT, IN ANY WAY, RELIEVE THE CONTRACTOR FROM ANY OBLIGATION TO PERFORM THE WORK IN STRICT COMPLIANCE WITH THE CONTRACT DOCUMENTS, APPLICABLE CODES, AND AGENCY REQUIREMENTS.
16. IF THE CONTRACTOR DEVIATES FROM THE APPROVED PLANS, INCLUDING THESE NOTES, WITHOUT FIRST OBTAINING THE PRIOR WRITTEN AUTHORIZATION OF THE ENGINEER FOR SUCH DEVIATIONS, CONTRACTOR SHALL BE SOLELY RESPONSIBLE FOR THE PAYMENT OF ALL COSTS INCURRED IN CORRECTING ANY WORK DONE WHICH DEVIATES FROM THE PLANS.
17. AKS HAS NOT BEEN RETAINED OR COMPENSATED TO PROVIDE DESIGN AND CONSTRUCTION REVIEW SERVICES RELATING TO THE CONTRACTOR'S SAFETY PRECAUTIONS, MEANS AND METHODS, TECHNIQUES, SEQUENCES, OR PROCEDURES REQUIRED FOR THE CONTRACTOR TO PERFORM WORK REQUIRED. AKS IS NOT A SAFETY INSPECTION COMPANY.

- 18. CONTRACTOR SHALL MAINTAIN ONE (1) COMPLETE SET OF APPROVED PLANS ON THE CONSTRUCTION SITE AT ALL TIMES WHEREIN THEY WILL RECORD ALL APPROVED DEVIATIONS IN CONSTRUCTION FROM THE APPROVED DRAWINGS.
19. UPON COMPLETION OF CONSTRUCTION OF ALL NEW FACILITIES, CONTRACTOR SHALL SUBMIT A CLEAN SET OF FIELD RECORD DRAWINGS CONTAINING ALL AS-BUILT INFORMATION TO THE OWNER'S REPRESENTATIVE.
20. THE CONTRACTOR SHALL INSTALL AND MAINTAIN ALL EROSION CONTROL MEASURES IN ACCORDANCE WITH THE CURRENT DEQ EROSION AND SEDIMENT CONTROL MANUAL AND EROSION CONTROL STANDARDS OF THE LOCAL JURISDICTION.
21. THE WORK AREA AND APPROACH ROAD(S) SHALL BE MAINTAINED BY THE CONTRACTOR IN A CLEAN AND SANITARY CONDITION, FREE FROM OBSTRUCTIONS, DEBRIS, AND TRASH AT ALL TIMES.
22. ELEVATIONS SHOWN ON THE DRAWINGS USE THE NAVD88 DATUM PER AS-BUILT PLANS PREPARED BY OTHERS.
23. THESE PLANS ASSUME AKS ENGINEERING & FORESTRY, LLC WILL BE RETAINED TO PROVIDE CONSTRUCTION STAKING SERVICES (TO INCLUDE OBSERVATION AND SURVEY CONSTRUCTION LAYOUT) DURING CONSTRUCTION OF ALL IMPROVEMENTS.
24. THE CONTRACTOR SHALL COORDINATE WITH THE SURVEYOR RETAINED BY THE OWNER OR RETAIN AND PAY FOR THE SERVICES OF A REGISTERED CIVIL ENGINEER AND/OR LAND SURVEYOR LICENSED IN THE STATE OF OREGON TO ESTABLISH CONSTRUCTION CONTROL AND PERFORM INITIAL CONSTRUCTION SURVEYS TO ESTABLISH THE LINES AND GRADES OF IMPROVEMENTS AS INDICATED ON THE DRAWINGS.
25. CONTRACTOR SHALL CONDUCT CONSTRUCTION ACTIVITIES IN SUCH A MANNER AS TO ENSURE MINIMUM INTERFERENCE WITH THE CONTINUED USE OF THE FACILITY BY THE COMMUNITY OR NEIGHBORS.
26. CONSTRUCTION ACTIVITIES, EQUIPMENT, VEHICLES, AND MATERIALS SHALL BE PLACED IN AREAS MINIMIZING INCONVENIENCE TO THE FACILITIES' NORMAL OPERATIONS AND SHALL BE COORDINATED WITH THE OWNER OR OWNER'S REPRESENTATIVE PRIOR TO THE START OF WORK.
27. THE CONTRACTOR SHALL BE RESPONSIBLE FOR MANAGING CONSTRUCTION ACTIVITIES TO ENSURE THAT PUBLIC STREETS AND RIGHT-OF-WAYS ARE KEPT CLEAN OF MUD, DUST OR DEBRIS.
28. PRIOR TO FINAL ACCEPTANCE AND PAYMENT, THE CONTRACTOR SHALL CLEAN THE PROJECT SITE AND ADJACENT AREAS OF ANY DEBRIS, DISCARDED MATERIAL, OR OTHER ITEMS DEPOSITED BY THE CONTRACTOR'S PERSONNEL DURING THE PERFORMANCE OF THE WORK.
29. SETTLEMENT OR CRACKING OF FINISHED SURFACES WITHIN THE WARRANTY PERIOD SHALL BE CONSIDERED A FAILURE OF THE FINISHED SURFACE AND/OR SUBGRADE.
30. ELECTRONIC FILES ARE NOT CONSTRUCTION DOCUMENTS. DIFFERENCES MAY EXIST BETWEEN ELECTRONIC FILES AND CORRESPONDING HARD-COPY CONSTRUCTION DOCUMENTS.
31. CONTRACTOR SHALL ERECT AND MAINTAIN BARRICADES, WARNING SIGNS, AND TRAFFIC CONES PER CITY, COUNTY AND/OR ODOT REQUIREMENTS IN ACCORDANCE WITH THE MANUAL ON UNIFORM TRAFFIC CONTROL DEVICES (MUTCD) INCLUDING OREGON AMENDMENTS AND LOCAL JURISDICTIONAL REQUIREMENTS. ACCESS TO DRIVEWAYS SHALL BE MAINTAINED AT ALL TIMES. ALL TRAFFIC CONTROL MEASURES SHALL BE APPROVED AND IN PLACE PRIOR TO ANY CONSTRUCTION ACTIVITY.

TRAFFIC CONTROL

32. PRIOR TO ANY WORK IN THE EXISTING PUBLIC RIGHT-OF-WAY, CONTRACTOR SHALL SUBMIT A FINAL TRAFFIC CONTROL PLAN TO THE CITY, COUNTY, AND/OR ODOT FOR REVIEW AND ISSUANCE OF A LANE CLOSURE OR WORK IN RIGHT-OF-WAY PERMIT.

TESTING AND INSPECTIONS

- 33. THE CONTRACTOR SHALL BE RESPONSIBLE TO ENSURE THAT ALL REQUIRED OR NECESSARY INSPECTIONS ARE COMPLETED BY AUTHORIZED INSPECTORS PRIOR TO PROCEEDING WITH SUBSEQUENT WORK WHICH COVERS OR THAT IS DEPENDENT ON THE WORK TO BE INSPECTED.
34. THE CONTRACTOR IS RESPONSIBLE FOR OBTAINING ALL NECESSARY INSPECTIONS OR NECESSARY OBSERVATIONS FOR ALL WORK PERFORMED INCLUDING ANY RE-TESTING THAT MAY BE REQUIRED TO MEET SPECIFICATION.
35. CONTRACTOR SHALL COORDINATE AND SCHEDULE ALL EARTHWORK, SUBGRADE APPROVALS, TRENCH BACKFILL, COMPACTION TESTS, AND OTHER GEOTECHNICAL RELATED ITEMS WITH THE PROJECT GEOTECHNICAL ENGINEER.
36. THE FOLLOWING TESTING IS THE MINIMUM REQUIRED FOR THE PROJECT.
SUBGRADE 1 TEST/4000 S.F./LIFT (4 TESTS MINIMUM)
ENGINEERED FILLS 1 TEST/4000 S.F./LIFT (4 TESTS MINIMUM)
BASE ROCK 1 TEST/4000 S.F./LIFT (4 TESTS MINIMUM)
ASPHALT 1 TEST/6000 S.F./LIFT (4 TESTS MINIMUM)
CONCRETE SLUMP & AIR 1 SET OF CYLINDERS/100 C.Y. OF CONCRETE POURED PER DAY. SLUMP AND AIR TESTS REQUIRED ON SAME LOAD AS CYLINDERS.
SPECIAL INSPECTIONS AS REQUIRED BY IBC.

- 37. IN ADDITION TO IN-PLACE DENSITY TESTING, THE SUBGRADE AND BASE ROCK SHALL BE PROOF-ROLLED WITH A LOADED 10-YARD DUMP TRUCK PROVIDED BY THE CONTRACTOR.
38. ALL ENGINEERED FILLS REQUIRE AN APPROVED INDEPENDENT TESTING LABORATORY RETAINED BY THE CONTRACTOR.
39. DESIGN BACKGROUNDS ARE AS-BUILT PLANS BY OTHERS. WE DO NOT GUARANTEE THE ACCURACY OR THE COMPLETENESS OF SUCH RECORDS.
40. ANY UTILITIES LOCATED IN THE FIELD THAT THE CONTRACTOR DISRUPTS OR DAMAGES SHALL BE PROMPTLY REPAIRED TO NEW CONDITION.
41. NOTIFY THE OWNER AND OWNER'S REPRESENTATIVE IMMEDIATELY OF ALL UTILITIES EXPOSED.
42. THE CONTRACTOR SHALL BE RESPONSIBLE FOR LOCATING AND MARKING ALL EXISTING SURVEY MONUMENTS OF RECORD (INCLUDING BUT NOT LIMITED TO PROPERTY AND STREET MONUMENTS) PRIOR TO CONSTRUCTION.

EXISTING CONDITIONS

- 39. DESIGN BACKGROUNDS ARE AS-BUILT PLANS BY OTHERS. WE DO NOT GUARANTEE THE ACCURACY OR THE COMPLETENESS OF SUCH RECORDS.
40. ANY UTILITIES LOCATED IN THE FIELD THAT THE CONTRACTOR DISRUPTS OR DAMAGES SHALL BE PROMPTLY REPAIRED TO NEW CONDITION.
41. NOTIFY THE OWNER AND OWNER'S REPRESENTATIVE IMMEDIATELY OF ALL UTILITIES EXPOSED.
42. THE CONTRACTOR SHALL BE RESPONSIBLE FOR LOCATING AND MARKING ALL EXISTING SURVEY MONUMENTS OF RECORD (INCLUDING BUT NOT LIMITED TO PROPERTY AND STREET MONUMENTS) PRIOR TO CONSTRUCTION.

- 43. CONTRACTOR SHALL FIELD VERIFY LOCATION AND DEPTH OF ALL EXISTING UTILITIES WHERE NEW FACILITIES CROSS.
44. ALL FACILITIES SHALL BE MAINTAINED IN-PLACE BY THE CONTRACTOR UNLESS OTHERWISE SHOWN OR DIRECTED.
45. UTILITIES OR INTERFERING PORTIONS OF UTILITIES THAT ARE ABANDONED IN PLACE SHALL BE REMOVED BY THE CONTRACTOR TO THE EXTENT NECESSARY TO ACCOMPLISH THE WORK.
46. CONTRACTOR SHALL REMOVE ALL EXISTING SIGNS, MAILBOXES, FENCES, LANDSCAPING, ETC., AS REQUIRED TO AVOID DAMAGE DURING CONSTRUCTION AND REPLACE THEM TO EXISTING OR BETTER CONDITION.
47. IF DRAIN/FIELD TILES, SPRINGS, OR GROUNDWATER ARE ENCOUNTERED DURING CONSTRUCTION, THE CONTRACTOR SHALL NOTIFY THE ENGINEER AND OWNER'S REPRESENTATIVE.
48. ANY SEPTIC TANKS ENCOUNTERED DURING CONSTRUCTION SHALL BE PUMPED OUT AND ABANDONED OR REMOVED IN ACCORDANCE WITH COUNTY SANITARIAN REQUIREMENTS.
49. ANY WELLS ENCOUNTERED SHALL BE ABANDONED PER THE STATE OF OREGON WATER RESOURCES DEPARTMENT REQUIREMENTS.
50. ANY FUEL TANKS ENCOUNTERED SHALL BE REMOVED AND DISPOSED OF PER THE STATE OF OREGON DEQ REQUIREMENTS.
51. CONTRACTOR SHALL COORDINATE AND PAY ALL COSTS ASSOCIATED WITH REMOVING OR ABANDONING ANY SEPTIC TANKS, WELLS (INCLUDING BOREHOLE PIEZOMETERS), AND FUEL TANKS ENCOUNTERED AS PER REGULATING AGENCY REQUIREMENTS.
52. PRIOR TO CONNECTING TO EXISTING WATER, SEWER, OR STORM STUBS/LATERALS, CONTRACTOR SHALL CLEAN AND TV THE EXISTING PIPE, SUBMIT TV INSPECTION VIDEO AND REPORT TO ENGINEER AND/OR JURISDICTION FOR REVIEW TO CONFIRM PIPE IS IN ACCEPTABLE CONDITION FOR REUSE.

CLEARING, GRADING, AND PAVING

- 53. GRADING, COMPACTION, FILLS, ROCK, AND PAVING SHALL CONFORM TO CITY OF SHERWOOD, WASHINGTON COUNTY, OR ODOT STANDARD CONSTRUCTION SPECIFICATIONS FOR WORK WITHIN PUBLIC RIGHT-OF-WAY OR EASEMENTS.
54. PRIVATE GRADING, ROCK, AND PAVING TO CONFORM TO OREGON STANDARD SPECIFICATIONS FOR CONSTRUCTION (OSSC/ODOT/APWA) AND IBC, CURRENT EDITIONS.
55. CLEAR AND GRUB WITHIN WORK LIMITS ALL SURFACE VEGETATION, TREES, STUMPS, BRUSH, ROOTS, ETC.
56. STRIP WORK LIMITS, REMOVING ALL ORGANIC MATTER, WHICH CANNOT BE COMPACTED INTO A STABLE MASS.
57. IMMEDIATELY FOLLOWING STRIPPING AND GRADING OPERATIONS, COMPACT SUBGRADE TO 95% OF THE MAXIMUM DRY DENSITY PER AASHTO T-99 TEST METHOD (STANDARD PROCTOR) PER CITY OF SHERWOOD DESIGN STANDARDS.
58. ALL FILLS SHALL BE ENGINEERED EXCEPT FOR FILLS LESS THAN 18-INCHES IN DEPTH WHICH ARE LOCATED OUTSIDE THE PUBLIC RIGHT-OF-WAY, BUILDING PADS, PARKING LOTS, OR OTHER AREAS TO BE IMPROVED.

- 59. AREAS TO RECEIVE ENGINEERED OR STRUCTURAL FILL SHALL BE PREPARED BY REMOVING ALL ORGANIC AND UNSUITABLE MATERIALS AND PROOF-ROLLING.
60. GRANULAR BASE ROCK SHALL MEET OREGON STATE HIGHWAY DIVISION (OSHD) SPECIFICATIONS PER CITY OF SHERWOOD DESIGN STANDARDS.
61. ALL EXISTING OR CONSTRUCTED MANHOLES, CLEANOUTS, MONUMENT BOXES, GAS VALVES, WATER VALVES AND SIMILAR STRUCTURES SHALL BE ADJUSTED TO MATCH FINISH GRADE OF THE PAVEMENT.
62. FINISHED RIM ELEVATIONS OF MANHOLES SHOWN WITHIN PAVEMENT ARE APPROXIMATE AND SHALL MATCH FINAL FINISHED PAVEMENT GRADES.
63. NO CUT OR FILL SLOPES SHALL BE CONSTRUCTED STEEPER THAN 2 FEET HORIZONTAL TO 1 FOOT VERTICAL (2H:1V) UNLESS OTHERWISE SHOWN ON THE DRAWINGS AND APPROVED BY THE GEOTECHNICAL ENGINEER FOR THE PROJECT.
64. ALL PLANTER AREAS AND OPEN SPACE SHALL BE BACKFILLED WITH APPROVED TOPSOIL IN CONFORMANCE WITH THE LANDSCAPE PLAN FOR THE PROJECT.

AKS DRAWING FILE: C000 COVER & NOTES.DWG | LAYOUT: C001



CEDAR CREEK GREENWAY FENCE IMPROVEMENTS SHERWOOD OREGON

GENERAL CIVIL CONSTRUCTION NOTES

DESIGNED BY: AMC
DRAWN BY: JAM
MANAGED BY: AMC
CHECKED BY: AMC
DATE: 2/13/2024
REGISTERED PROFESSIONAL ENGINEER 97708PE
AUSTIN MORGAN COLE
REVISIONS

JOB NUMBER 9965
SHEET C001

KEYED NOTES:

1. INSTALL ±25 LF OF 7' TALL PREFABRICATED SOUND FENCE PER MANUFACTURER'S RECOMMENDATIONS. EXTEND SOUND FENCE BEHIND EXISTING CEDAR PLANK FENCE, OVERLAP 2 LF MINIMUM.
 2. INSTALL ±114 LF OF 7' TALL PREFABRICATED SOUND FENCE PER MANUFACTURER'S RECOMMENDATIONS.
 3. REMOVE EXISTING ODOT YARD FENCE AND INSTALL ±146 LF OF 7' TALL PREFABRICATED SOUND FENCE PER MANUFACTURER'S RECOMMENDATIONS.
 4. INSTALL ±354 (TOTAL) LF OF 8' TALL PREFABRICATED SOUND FENCE PER MANUFACTURER'S RECOMMENDATIONS.
 5. GRIND AND REMOVE EXISTING STUMP. PRESERVE SURROUNDING PATHWAY, LANDSCAPING, FENCE, ETC.
 6. SEE LANDSCAPE PLAN FOR PLANTINGS AND LANDSCAPE RESTORATION.
 7. REMOVE AND RELOCATE EXISTING STREET TREES FOR MAINTENANCE ACCESS.
 8. REGRADE AREA ABOVE OUTFALL TO PROVIDE MINIMUM ±6' WIDE AREA FOR MAINTENANCE ACCESS. MATCH EXISTING AT 2:1 MAX.
 9. INSTALL ±270 (TOTAL) LF OF CHAIN LINK FENCE (TYPE CL-4) ALONG EXISTING PATH PER ODOT STANDARD DRAWING R0815/CS00. MATCH EXISTING COLOR AND STYLE. ATTACH NEW CHAIN LINK FENCE TO EXISTING CHAIN LINK FENCE POST USING STEEL WIRE CLIPS.
 10. INSTALL STRAW WATTLES PER CWS DRAWING NO. 880/CS00. ESC MEASURES MUST BE IN PLACE AND FUNCTIONAL PRIOR TO COMMENCEMENT OF CONSTRUCTION ACTIVITIES.
 11. END CHAIN LINK FENCE
- P. CONTRACTOR TO PROTECT AT ALL TIMES THROUGHOUT DEMOLITION AND CONSTRUCTION. ANY DAMAGE SHALL BE REPAIRED AT CONTRACTOR'S EXPENSE.

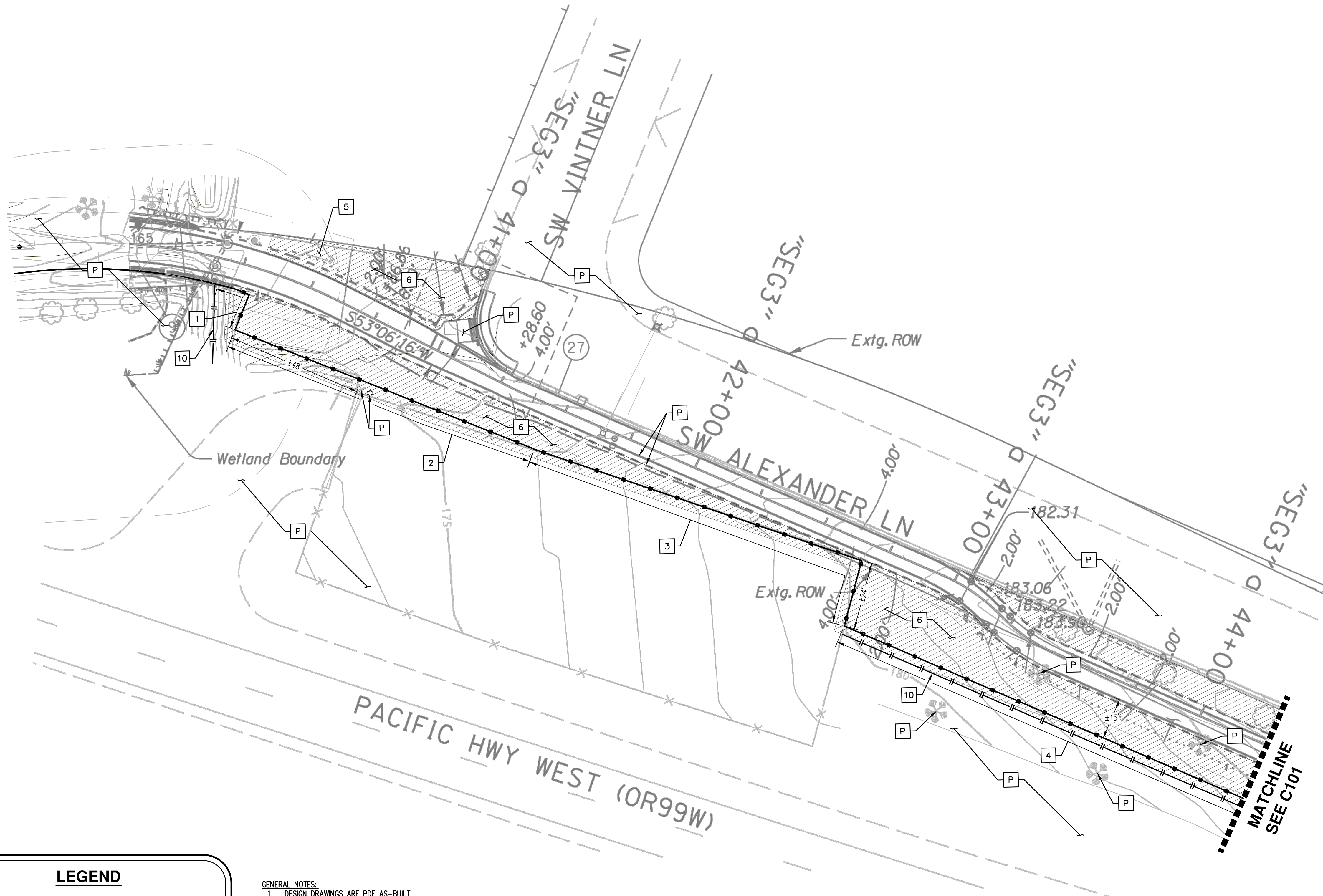

LEGEND

- STRAW WATTLES
- PREFABRICATED SOUND FENCE
- CHAIN LINK FENCE
- RESTORE LANDSCAPING

GENERAL NOTES:

1. DESIGN DRAWINGS ARE PDF AS-BUILT PLANS PREPARED BY OTHERS.
2. IF SIGNIFICANT ROOTS ARE ENCOUNTERED DURING FENCE POST INSTALLATION, THE FENCE POSTS SHALL BE SHIFTED SO AS TO AVOID TREE ROOTS.
3. ALL DIMENSIONS ARE TO EDGE OF AC PATHWAY UNLESS SPECIFIED OTHERWISE.

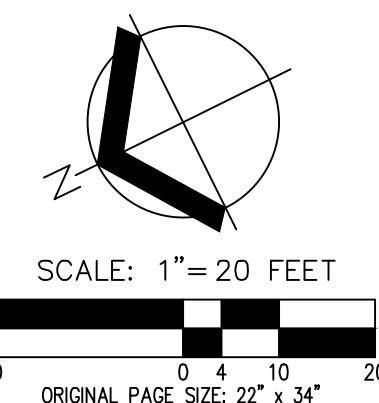

AKS DRAWING FILE: 9965_FENCE.DWG | LAYOUT: C007

SITE PLAN

DESIGNED BY: AMC
 DRAWN BY: JAM
 MANAGED BY: AMC
 CHECKED BY: AMC

DATE: 2/13/2024



REVISIONS

JOB NUMBER
9965

SHEET
C100

KEYED NOTES:

1. INSTALL ±25 LF OF 7' TALL PREFABRICATED SOUND FENCE PER MANUFACTURER'S RECOMMENDATIONS. EXTEND SOUND FENCE BEHIND EXISTING CEDAR PLANK FENCE, OVERLAP 2 LF MINIMUM.
 2. INSTALL ±114 LF OF 7' TALL PREFABRICATED SOUND FENCE PER MANUFACTURER'S RECOMMENDATIONS.
 3. REMOVE EXISTING ODOT YARD FENCE AND INSTALL ±146 LF OF 7' TALL PREFABRICATED SOUND FENCE PER MANUFACTURER'S RECOMMENDATIONS.
 4. INSTALL ±354 (TOTAL) LF OF 8' TALL PREFABRICATED SOUND FENCE PER MANUFACTURER'S RECOMMENDATIONS.
 5. GRIND AND REMOVE EXISTING STUMP. PRESERVE SURROUNDING PATHWAY, LANDSCAPING, FENCE, ETC.
 6. SEE LANDSCAPE PLAN FOR PLANTINGS AND LANDSCAPE RESTORATION.
 7. REMOVE AND RELOCATE EXISTING STREET TREES FOR MAINTENANCE ACCESS.
 8. REGRADE AREA ABOVE OUTFALL TO PROVIDE MINIMUM ±6' WIDE AREA FOR MAINTENANCE ACCESS. MATCH EXISTING AT 2:1 MAX.
 9. INSTALL ±270 (TOTAL) LF OF CHAIN LINK FENCE (TYPE CL-4) ALONG EXISTING PATH PER ODOT STANDARD DRAWING R0815/CS00. MATCH EXISTING COLOR AND STYLE. ATTACH NEW CHAIN LINK FENCE TO EXISTING CHAIN LINK FENCE POST USING STEEL WIRE CLIPS.
 10. INSTALL STRAW WATTLES PER CWS DRAWING NO. 880/CS00. ESC MEASURES MUST BE IN PLACE AND FUNCTIONAL PRIOR TO COMMENCEMENT OF CONSTRUCTION ACTIVITIES.
 11. END CHAIN LINK FENCE
- P. CONTRACTOR TO PROTECT AT ALL TIMES THROUGHOUT DEMOLITION AND CONSTRUCTION. ANY DAMAGE SHALL BE REPAIRED AT CONTRACTOR'S EXPENSE.

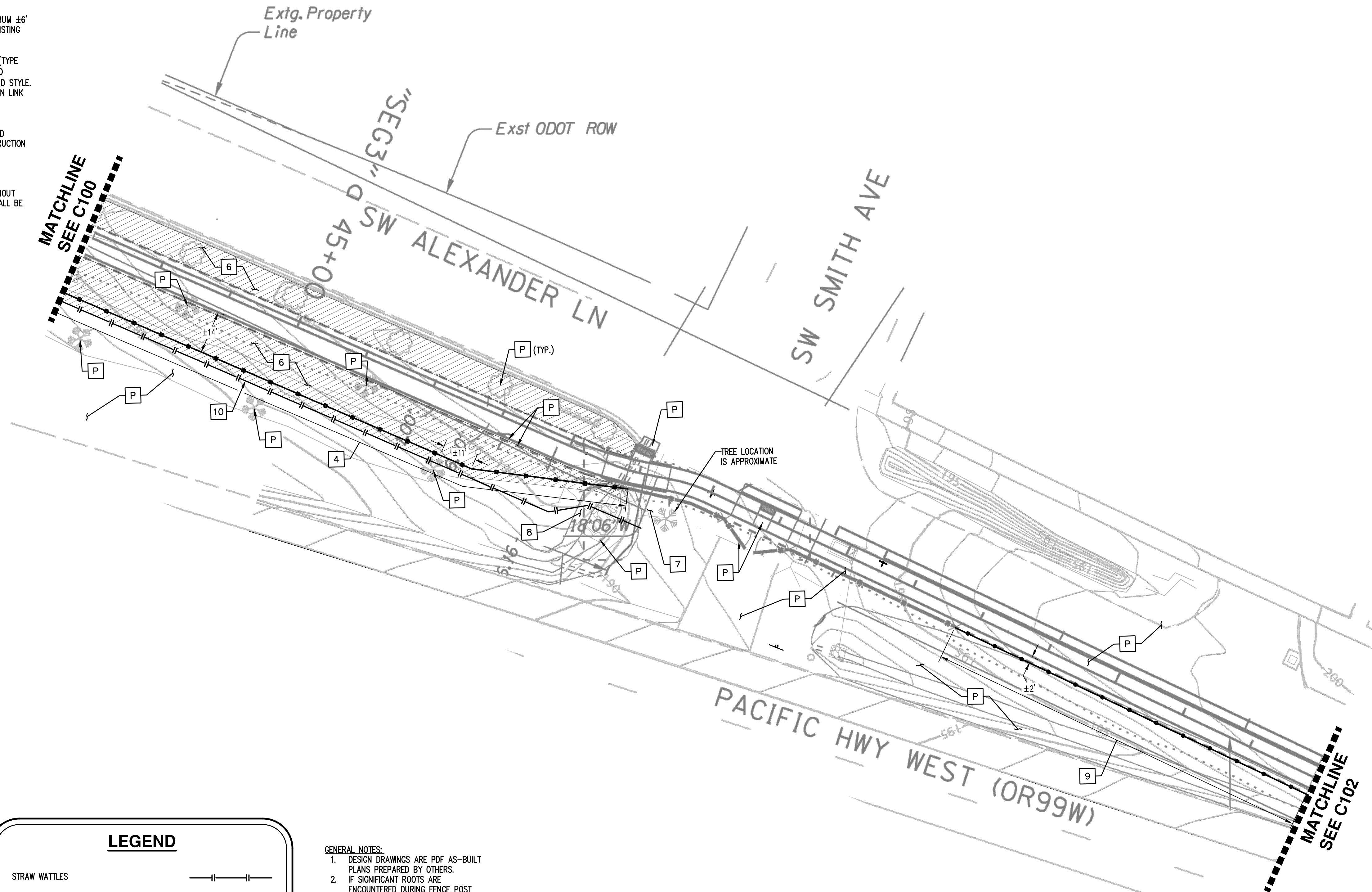

LEGEND

STRAW WATTLES	
PREFABRICATED SOUND FENCE	
CHAIN LINK FENCE	
RESTORE LANDSCAPING	

- GENERAL NOTES:**
1. DESIGN DRAWINGS ARE PDF AS-BUILT PLANS PREPARED BY OTHERS.
 2. IF SIGNIFICANT ROOTS ARE ENCOUNTERED DURING FENCE POST INSTALLATION, THE FENCE POSTS SHALL BE SHIFTED SO AS TO AVOID TREE ROOTS.
 3. ALL DIMENSIONS ARE TO EDGE OF AC PATHWAY UNLESS SPECIFIED OTHERWISE.

AKS DRAWING FILE: 9965_FENCE.DWG | LAYOUT: C101

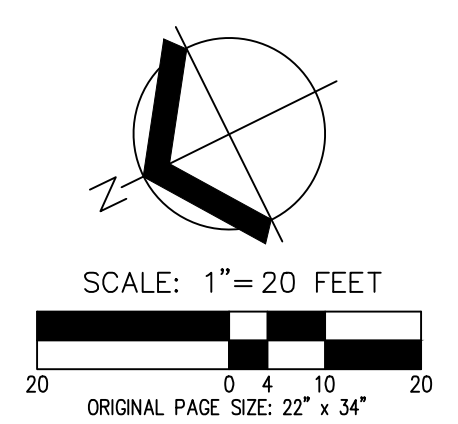

AKS
 AKS ENGINEERING & FORESTRY, LLC
 12065 SW HERMAN RD. STE 100
 TUALATIN, OR 97062
 503.563.6151
 WWW.AKS-ENG.COM

**CEDAR CREEK GREENWAY
 FENCE IMPROVEMENTS
 SHERWOOD OREGON**
 WASHINGTON COUNTY ASSESSOR'S TAX MAP 251300C
 FORESTRY · PLANNING · LANDSCAPE ARCHITECTURE
 ENGINEERING · SURVEYING · NATURAL RESOURCES

SITE PLAN

DESIGNED BY: AMC
 DRAWN BY: JAM
 MANAGED BY: AMC
 CHECKED BY: AMC
 DATE: 2/13/2024



REVISIONS

JOB NUMBER
9965

SHEET
C101

KEYED NOTES:

1. INSTALL ±25 LF OF 7' TALL PREFABRICATED SOUND FENCE PER MANUFACTURER'S RECOMMENDATIONS. EXTEND SOUND FENCE BEHIND EXISTING CEDAR PLANK FENCE, OVERLAP 2 LF MINIMUM.
 2. INSTALL ±114 LF OF 7' TALL PREFABRICATED SOUND FENCE PER MANUFACTURER'S RECOMMENDATIONS.
 3. REMOVE EXISTING ODOT YARD FENCE AND INSTALL ±146 LF OF 7' TALL PREFABRICATED SOUND FENCE PER MANUFACTURER'S RECOMMENDATIONS.
 4. INSTALL ±354 (TOTAL) LF OF 8' TALL PREFABRICATED SOUND FENCE PER MANUFACTURER'S RECOMMENDATIONS.
 5. GRIND AND REMOVE EXISTING STUMP. PRESERVE SURROUNDING PATHWAY, LANDSCAPING, FENCE, ETC.
 6. SEE LANDSCAPE PLAN FOR PLANTINGS AND LANDSCAPE RESTORATION.
 7. REMOVE AND RELOCATE EXISTING STREET TREES FOR MAINTENANCE ACCESS.
 8. REGRADE AREA ABOVE OUTFALL TO PROVIDE MINIMUM ±6' WIDE AREA FOR MAINTENANCE ACCESS. MATCH EXISTING AT 2:1 MAX.
 9. INSTALL ±270 (TOTAL) LF OF CHAIN LINK FENCE (TYPE CL-4) ALONG EXISTING PATH PER ODOT STANDARD DRAWING R0815/CS00. MATCH EXISTING COLOR AND STYLE. ATTACH NEW CHAIN LINK FENCE TO EXISTING CHAIN LINK FENCE POST USING STEEL WIRE CLIPS.
 10. INSTALL STRAW WATTLES PER CWS DRAWING NO. 880/CS00. ESC MEASURES MUST BE IN PLACE AND FUNCTIONAL PRIOR TO COMMENCEMENT OF CONSTRUCTION ACTIVITIES.
 11. END CHAIN LINK FENCE
- P. CONTRACTOR TO PROTECT AT ALL TIMES THROUGHOUT DEMOLITION AND CONSTRUCTION. ANY DAMAGE SHALL BE REPAIRED AT CONTRACTOR'S EXPENSE.

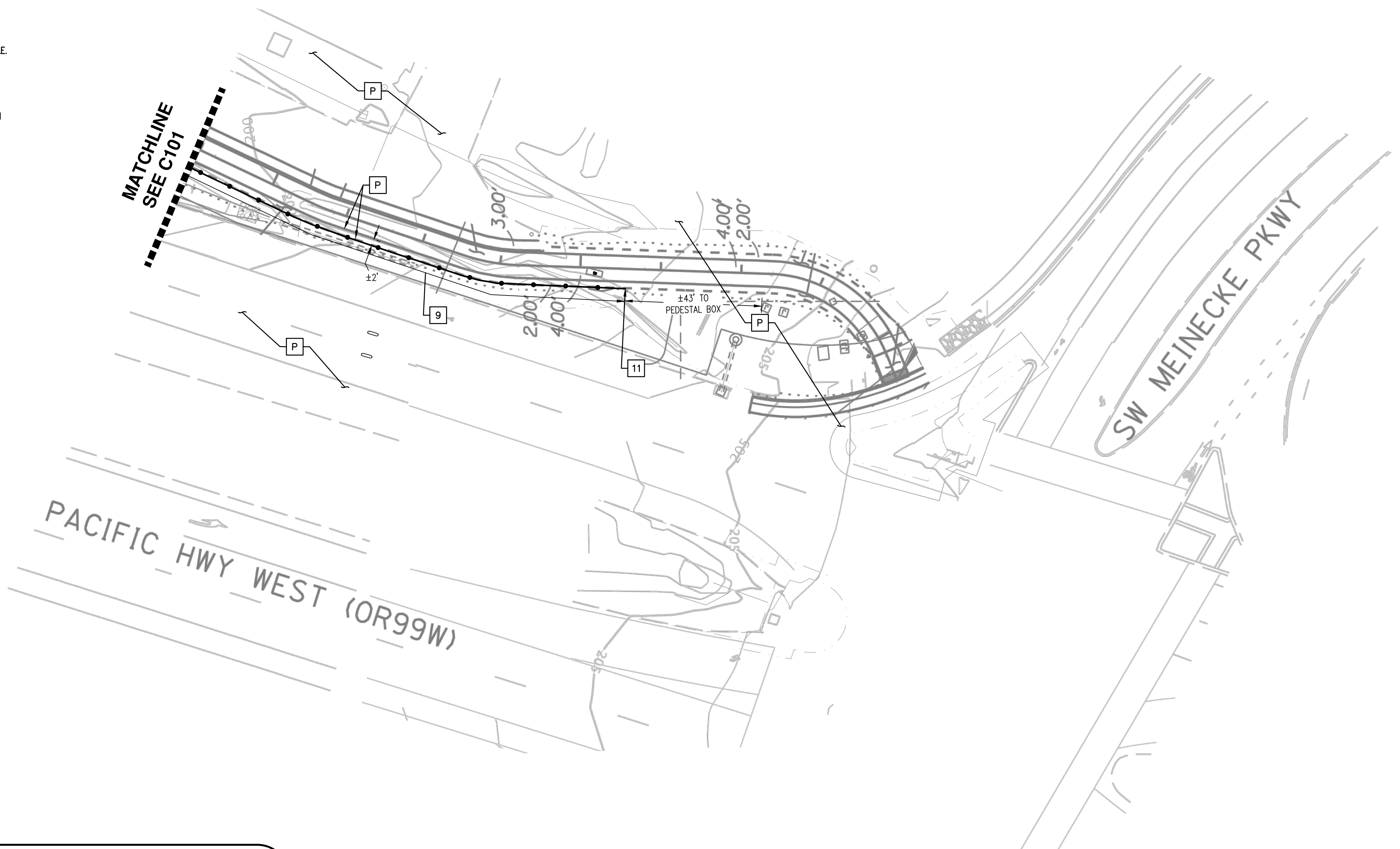

LEGEND

- STRAW WATTLES
- PREFABRICATED SOUND FENCE
- CHAIN LINK FENCE
- RESTORE LANDSCAPING

GENERAL NOTES:

1. DESIGN DRAWINGS ARE PDF AS-BUILT PLANS PREPARED BY OTHERS.
2. IF SIGNIFICANT ROOTS ARE ENCOUNTERED DURING FENCE POST INSTALLATION, THE FENCE POSTS SHALL BE SHIFTED SO AS TO AVOID TREE ROOTS.
3. ALL DIMENSIONS ARE TO EDGE OF AC PATHWAY UNLESS SPECIFIED OTHERWISE.

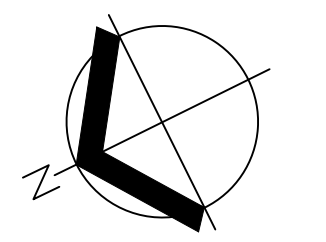

SCALE: 1" = 20 FEET
 ORIGINAL PAGE SIZE: 22" x 34"

AKS DRAWING FILE: 9965_FENCE.DWG | LAYOUT: C009

AKS
 AKS ENGINEERING & FORESTRY, LLC
 12065 SW HERMAN RD. STE 100
 TUALATIN, OR 97062
 503.563.6151
 WWW.AKS-ENG.COM

ENGINEERING · SURVEYING · NATURAL RESOURCES
 FORESTRY · PLANNING · LANDSCAPE ARCHITECTURE

**CEDAR CREEK GREENWAY
 FENCE IMPROVEMENTS**
 SHERWOOD OREGON
WASHINGTON COUNTY ASSESSOR'S TAX MAP 251300C
 PUBLIC RIGHT-OF-WAY

SITE PLAN

DESIGNED BY: AMC
 DRAWN BY: JAM
 MANAGED BY: AMC
 CHECKED BY: AMC

DATE: 2/13/2024



REVISIONS

JOB NUMBER
9965

SHEET

C102

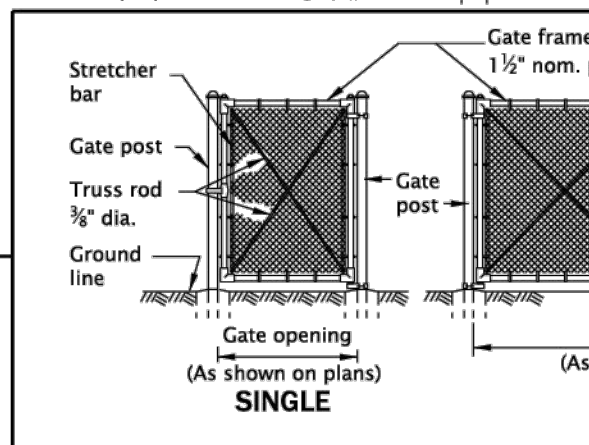
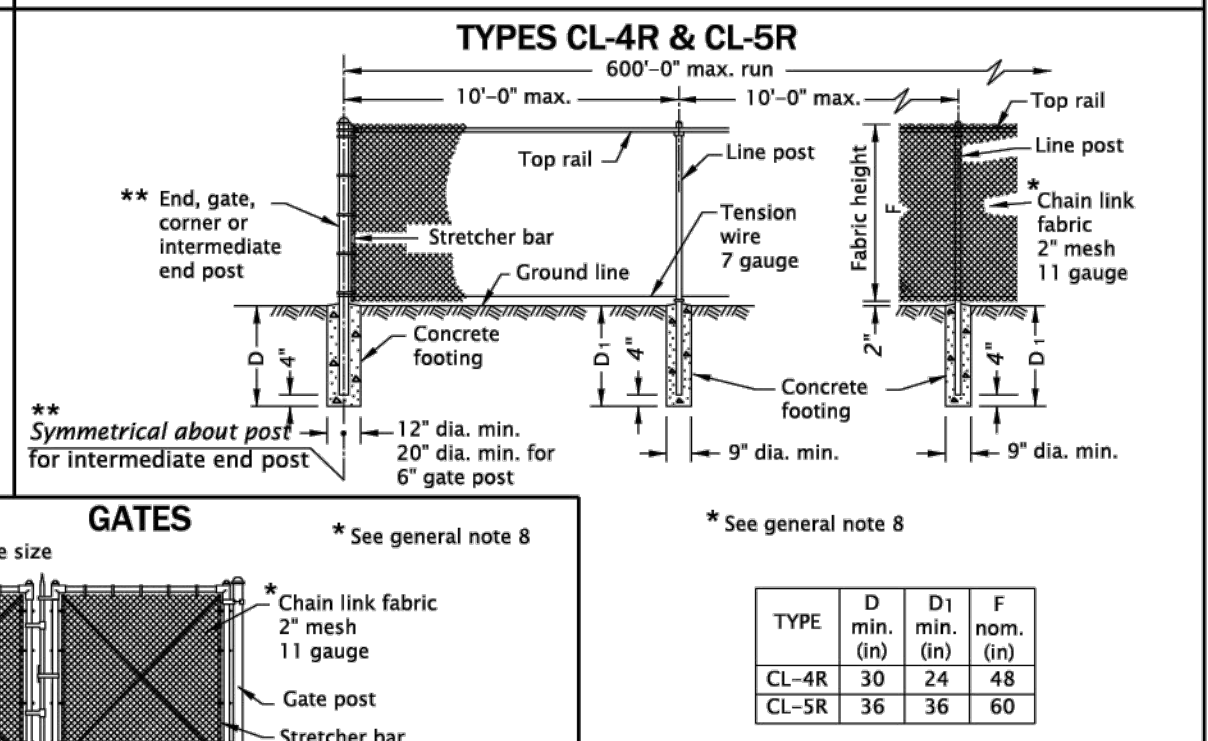
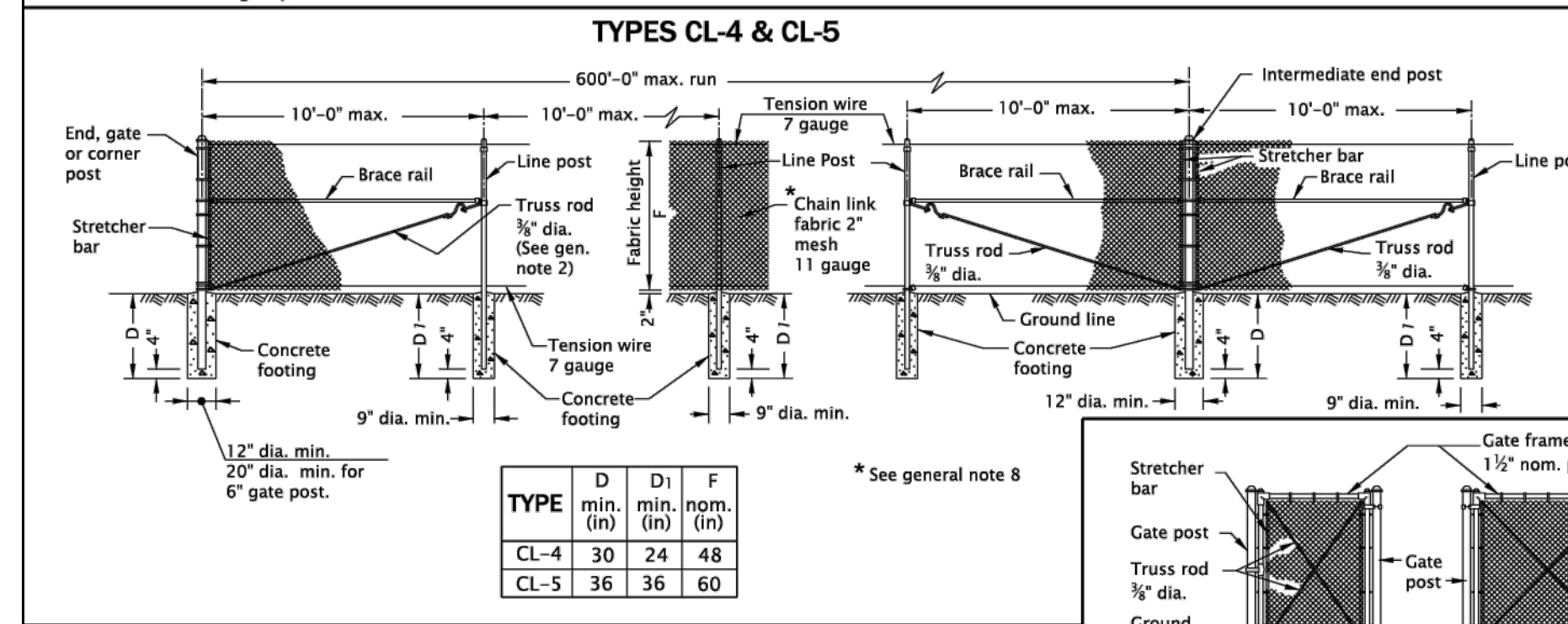
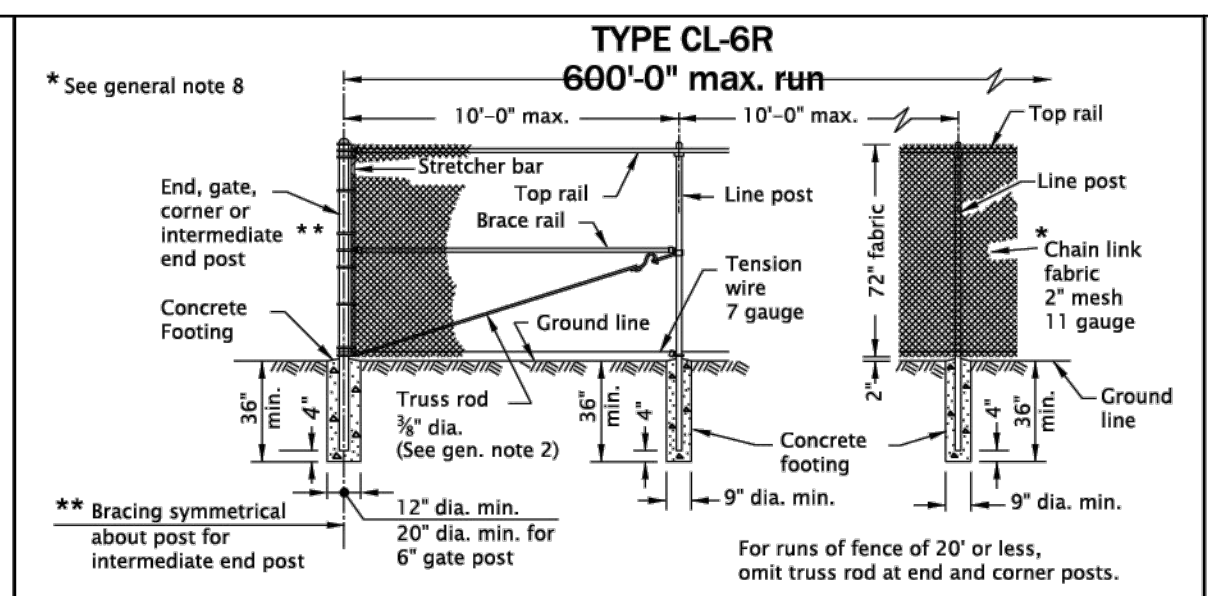
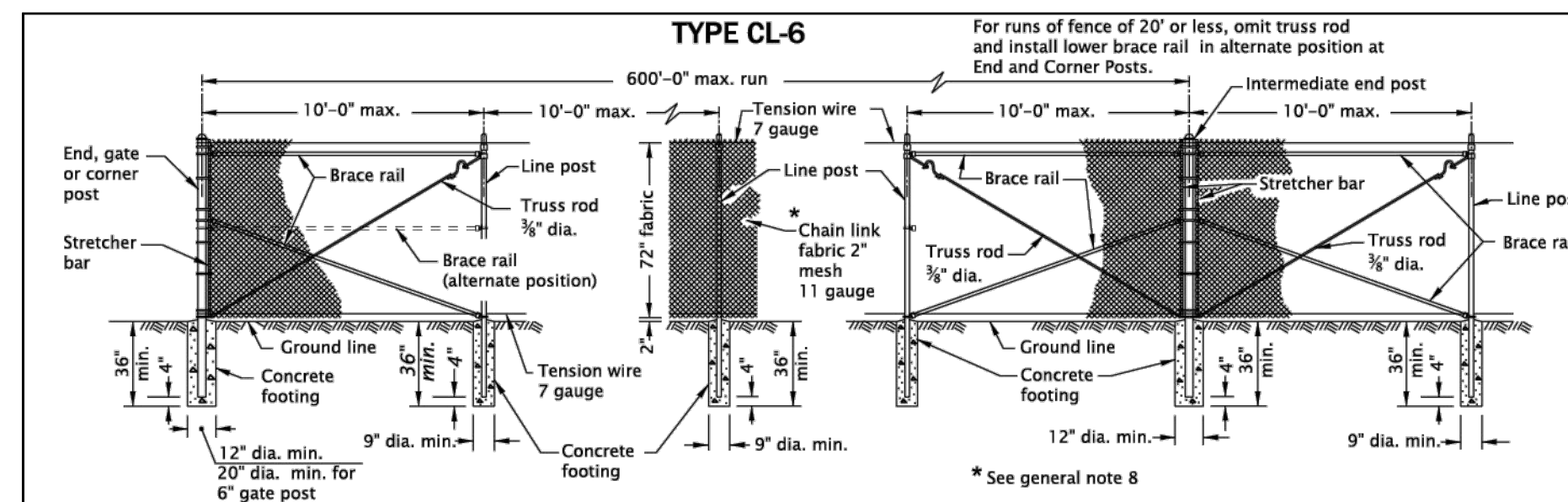

TYPE	D min. (in)	D1 min. (in)	F nom. (in)
CL-4	30	24	48
CL-5	36	36	60

TABLE 1

TYPE	MEMBER									
	BRACE AND TOP RAILS		LINE POSTS		END, CORNER & INTERMEDIATE END POST		GATE OPENING (ft)		GATE POSTS	
	TUBULAR	TUBULAR	TUBULAR	H-SECTION	TUBULAR	TUBULAR	SINGLE GATE	DOUBLE GATE	Fence Industry (in)	Norm. Dia. (in)
CL-4 & CL-4R	1 1/2	1 1/2	1 1/2	1 1/2 x 1 1/2	2 1/2	2	Up thru 6	Up thru 12	2 1/2	2 1/2
CL-5 & CL-5R	1 1/2	1 1/2	1 1/2	1 1/2 x 1 1/2	2 1/2	2	7 thru 13	13 thru 26	4	3 1/2
CL-6 & CL-6R	1 1/2	1 1/2	2	2 1/2 x 2	4.10	2 1/2	14 thru 18	27 thru 36	6 1/2	6

NOTE: For CL-6, CL-6R, CL-8, CL-8R, CL-10 & CL-10R, the hardware is minimum and does not include slat wind loading.

GENERAL NOTES FOR ALL DETAILS ON THIS SHEET:

- Do not use top rail where fence can be struck by an errant vehicle.
- Fittings shown are illustrative of use and not specific as to design.
- Gate posts on each side of a gate opening to be the same size. At a double gate installation with unequal width gates, size of both posts to be as indicated for a single gate installation of the wider gate width.
- For cross sectional dimensions of members, see Table 1.
- Posts and rails with sections not shown that meet the requirements of AASHTO M181 are acceptable alternates. See ODOT's OPL for acceptable alternates.
- All concrete shall be commercial grade concrete.
- All chain link fabric top and bottom selvage shall be knuckled finish.
- Chain link fabric for the fence to be installed with pickets shall be 9 gauge wire woven in 3 1/2" by 5 1/2" diamond mesh.
- See project plans for details not shown.
- Add fence grounding as required.

OREGON STANDARD DRAWINGS

CHAIN LINK FENCE

2021

DATE: _____ REVISION: _____ DESCRIPTION: _____

CALC. BOOK NO. _____ N/A _____ SDR DATE: 13-JAN-2020 **RD815**

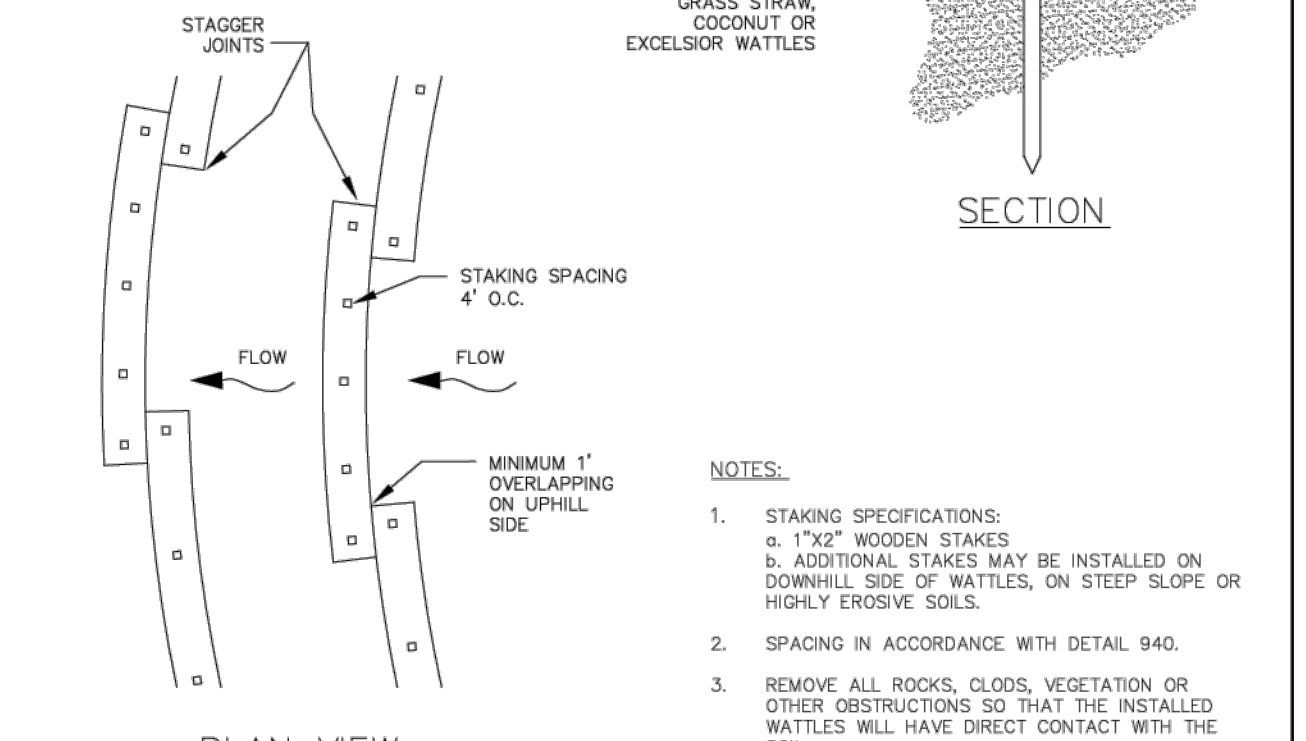
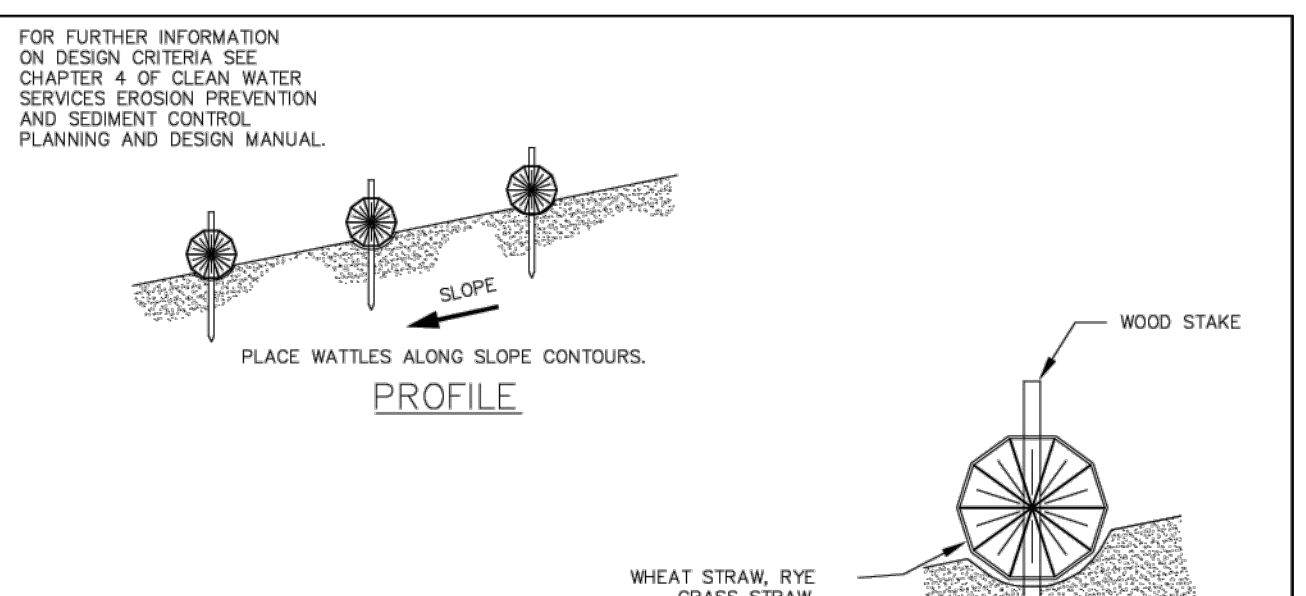

NOTES:

- STAKING SPECIFICATIONS:
 - 1"x2" WOODEN STAKES
 - ADDITIONAL STAKES MAY BE INSTALLED ON DOWNHILL SIDE OF WATTLES, ON STEEP SLOPE OR HIGHLY ERODIVE SOILS.
- SPACING IN ACCORDANCE WITH DETAIL 940.
- REMOVE ALL ROCKS, CLODS, VEGETATION OR OTHER OBSTRUCTIONS SO THAT THE INSTALLED WATTLES WILL HAVE DIRECT CONTACT WITH THE SOIL.
- INSTALL THE WATTLES IN A 2" DEEP TRENCH, INSURING THAT NO GAPS EXIST BETWEEN THE SOIL AND THE BOTTOM OF THE WATTLE. THE ENDS OF ADJACENT WATTLES SHALL BE OVERLAPPED 1 FT. MINIMUM TO PREVENT SEDIMENT PASSING THROUGH THE FIELD JOINT.

WATTLES

DRAWING NO. 880 REVISED 10-31-19

CleanWater Services



SOUND WALL REFERENCE IMAGE #1
NTS



SOUND WALL REFERENCE IMAGE #2
NTS



SOUND WALL REFERENCE IMAGE #3
NTS

AKS DRAWING FILE: 9965 DETAILS.DWG | LAYOUT: C500

AKS
AKS ENGINEERING & FORESTRY, LLC
12065 SW HERMAN RD. STE 100
TUALATIN, OR 97062
503.563.6151
WWW.AKS-ENG.COM

**CEDAR CREEK GREENWAY
FENCE IMPROVEMENTS**

SHERWOOD OREGON

ENGINEERING - SURVEYING - NATURAL RESOURCES
FORESTRY - PLANNING - LANDSCAPE ARCHITECTURE

WASHINGTON COUNTY ASSESSOR'S TAX MAP 25130DC
PUBLIC RIGHT-OF-WAY

DETAILS

DESIGNED BY: AMC
DRAWN BY: JAM
MANAGED BY: AMC
CHECKED BY: AMC
DATE: 2/13/2024

REGISTERED PROFESSIONAL ENGINEER
97708PE
Austin Cole
SEPTEMBER 14, 2015
AUSTIN MORGAN COLE
RENEWS: DECEMBER 31, 2023

REVISIONS

JOB NUMBER
9965

SHEET
C500

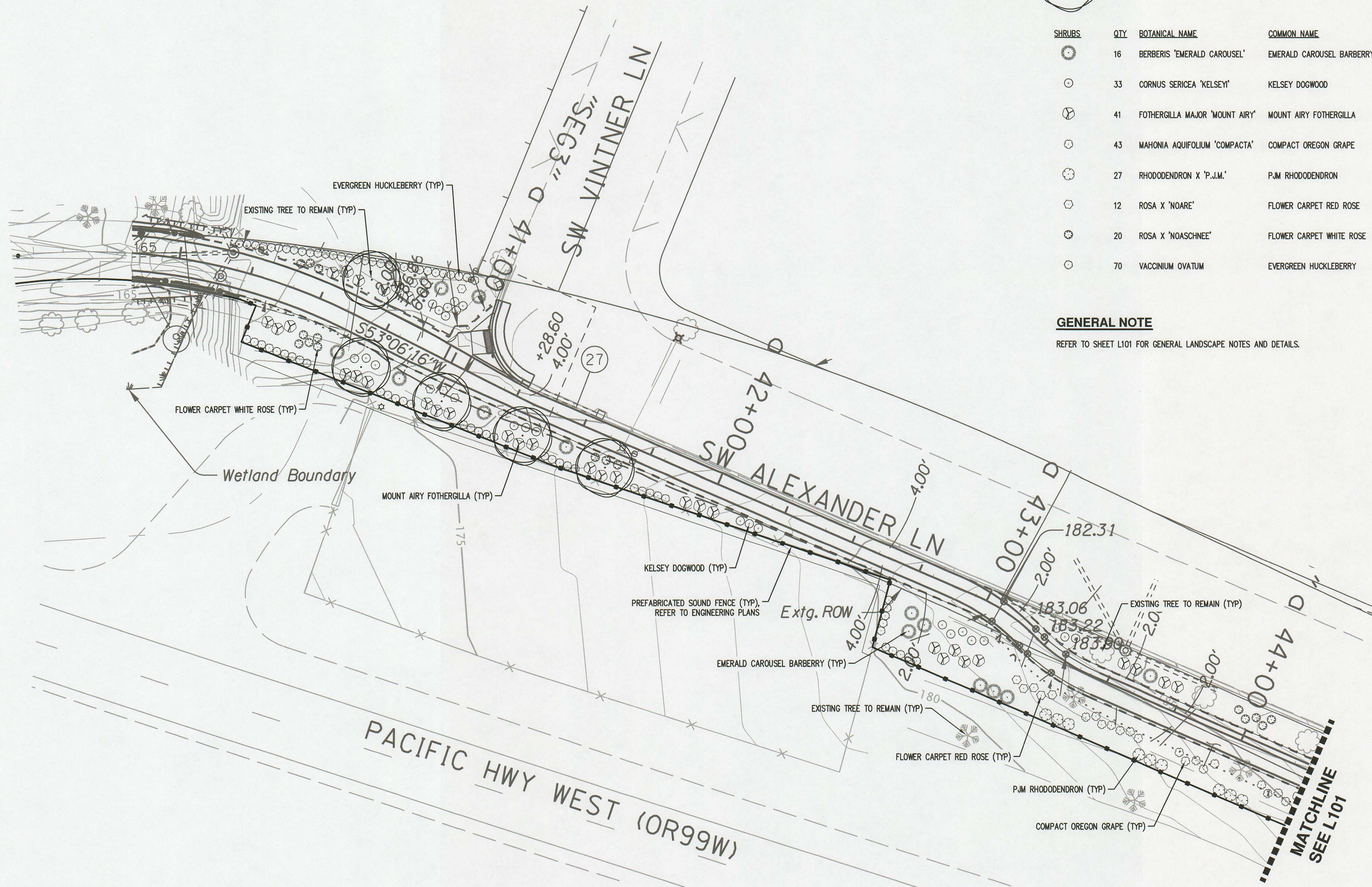

PLANT SCHEDULE

TREES	QTY	BOTANICAL NAME	COMMON NAME	SIZE/CONTAINER	SPACING
	5	EXISTING TREE TO REMAIN			AS SHOWN

SHRUBS	QTY	BOTANICAL NAME	COMMON NAME	SIZE/CONTAINER	SPACING
	16	BERBERIS 'EMERALD CAROUSEL'	EMERALD CAROUSEL BARBERRY	5 GAL. CONT.	60" o.c.
	33	CORNUS SERICEA 'KELSEY'	KELSEY DOGWOOD	5 GAL. CONT.	36" o.c.
	41	FOTHERGILLA MAJOR 'MOUNT AIRY'	MOUNT AIRY FOTHERGILLA	5 GAL. CONT.	48" o.c.
	43	MAHONIA AQUIFOLIUM 'COMPACTA'	COMPACT OREGON GRAPE	3 GAL. CONT.	36" o.c.
	27	RHODODENDRON X 'P.J.M.'	P.J.M. RHODODENDRON	5 GAL. CONT.	48" o.c.
	12	ROSA X 'NOARE'	FLOWER CARPET RED ROSE	3 GAL. CONT.	36" o.c.
	20	ROSA X 'NOASCHNEE'	FLOWER CARPET WHITE ROSE	3 GAL. CONT.	36" o.c.
	70	VACCINIUM OVATUM	EVERGREEN HUCKLEBERRY	5 GAL. CONT.	36" o.c.

GENERAL NOTE
REFER TO SHEET L101 FOR GENERAL LANDSCAPE NOTES AND DETAILS.

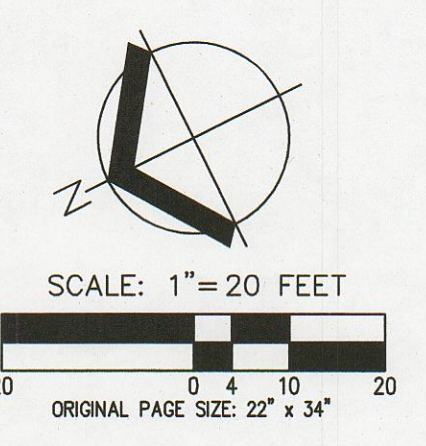

DESIGNED BY: TEB
DRAWN BY: TEB
MANAGED BY: AMC
CHECKED BY: AMC

DATE: 2/13/2024
REGISTERED
2025
TIMOTHY D. BAUER
OREGON
11/01/19
LANDSCAPE ARCHITECT

REVISIONS
JOB NUMBER
9965
SHEET
L100

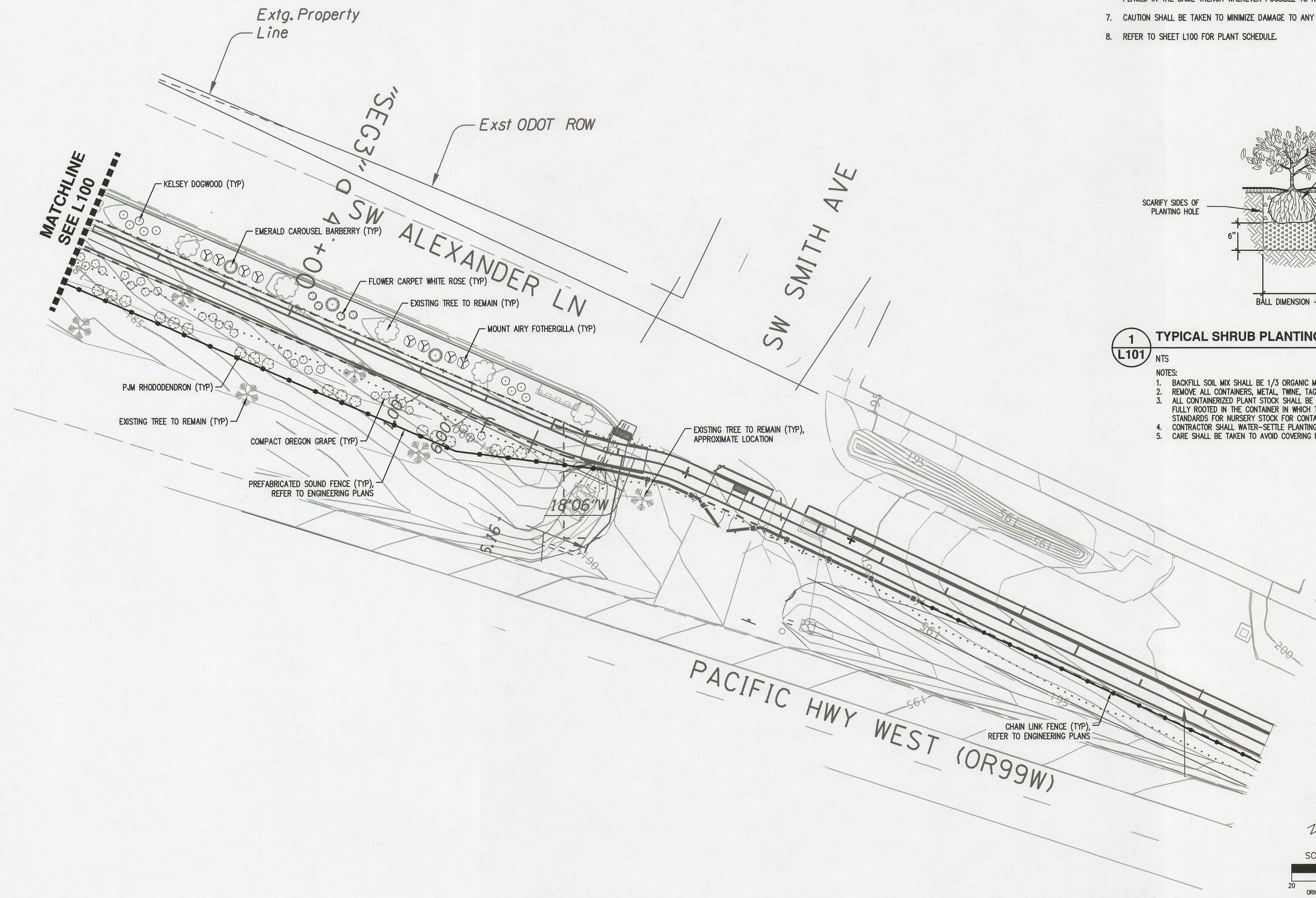

GENERAL LANDSCAPE NOTES

- CONTRACTOR IS RESPONSIBLE FOR VERIFYING PLANT QUANTITIES. IF DISCREPANCIES OCCUR, DESIGN INTENT PREVAILS OVER QUANTITIES LISTED.
- PLANT SPECIES, SIZES, LOCATIONS, QUANTITIES, AND OTHER PLAN CHANGES MAY BE SUBSTITUTED OR REVISED PRIOR TO FINAL SUBMITTAL DUE TO SITE CONDITIONS AND PLANT AVAILABILITY WHERE ALLOWED BY SHERWOOD DESIGN STANDARDS.
- SOIL PREPARATION: ALL TREE, SHRUB, AND GROUND COVER AREAS SHALL HAVE A MINIMUM OF 12" OF CLEAN TOPSOIL, PLUS AN ADDITIONAL 24" OF NON-COMPACTED SUBSOIL AVAILABLE. EXISTING NATIVE SOIL OR STOCKPILED TOPSOIL STRIPPING MAY BE USED. TOPSOIL SHALL BE RICH DARK BROWN IN COLOR AND VOID OF ROOTS, PLANTS, WEED SEEDS, SOIL, STONES, CLAY LUMPS, ALKALI SALTS, DEBRIS, AND OTHER EXTRANEUS MATERIALS HARMFUL TO PLANT GROWTH. FINISH GRADE OF NEW PLANTING AREAS SHALL SEAMLESSLY MEET FINISH GRADE OF EXISTING LANDSCAPE AREAS TO REMAIN AND AS SHOWN ON GRADING PLANS. TOPSOIL SHALL BE PLACED AND WORKED IN FRABLE (WORKABLE) CONDITION. BACKFILL ALL PLANTING HOLES WITH 1/3 ORGANIC MATERIALS, 1/3 TOPSOIL, AND 1/3 SANDY LOAM.
- MULCH: APPLY 3" DEEP MEDIUM GRIND OR SHREDDED DARK HEMLOCK OR FIR MULCH AROUND ALL PLANTINGS. DO NOT COVER FOLIAGE OR ROOT CROWNS OF PLANTS WITH BARK MULCH. TREES AND OTHER PLANTS SHALL BE SET TO ACCOMMODATE MULCH APPLICATION WITHOUT BURYING ROOT CROWNS.
- IRRIGATION: LANDSCAPE CONTRACTOR SHALL BE RESPONSIBLE FOR PROVIDING AND INSTALLING A PERMANENT, UNDERGROUND 'DESIGN-BUILD' IRRIGATION SYSTEM TO WATER ALL NEW PLANTING BED AREAS. COORDINATE POINT-OF-CONNECTION (POC), CITY APPROVED DOUBLE-CHECK VALVE ASSEMBLY, AND SLEEVING LOCATIONS WITH GENERAL CONTRACTOR AND CITY PRIOR TO INSTALLATION OF HARD SURFACING (SIDEWALKS, ROADWAYS, ETC.).
- IRRIGATION LINES, VALVES, AND HEADS ARE TO BE PLACED NO CLOSER THAN 10' (MINIMUM) FROM TREES TO REMAIN. IRRIGATION LINES TO BE PLACED IN THE SAME TRENCH WHEREVER POSSIBLE TO REDUCE TRENCHING. GROUP CONTROL VALVE BOXES WHERE POSSIBLE.
- CAUTION SHALL BE TAKEN TO MINIMIZE DAMAGE TO ANY TREE ROOTS. HAND DIG AROUND ANY ROOTS 1-INCH OR LARGER.
- REFER TO SHEET L100 FOR PLANT SCHEDULE.

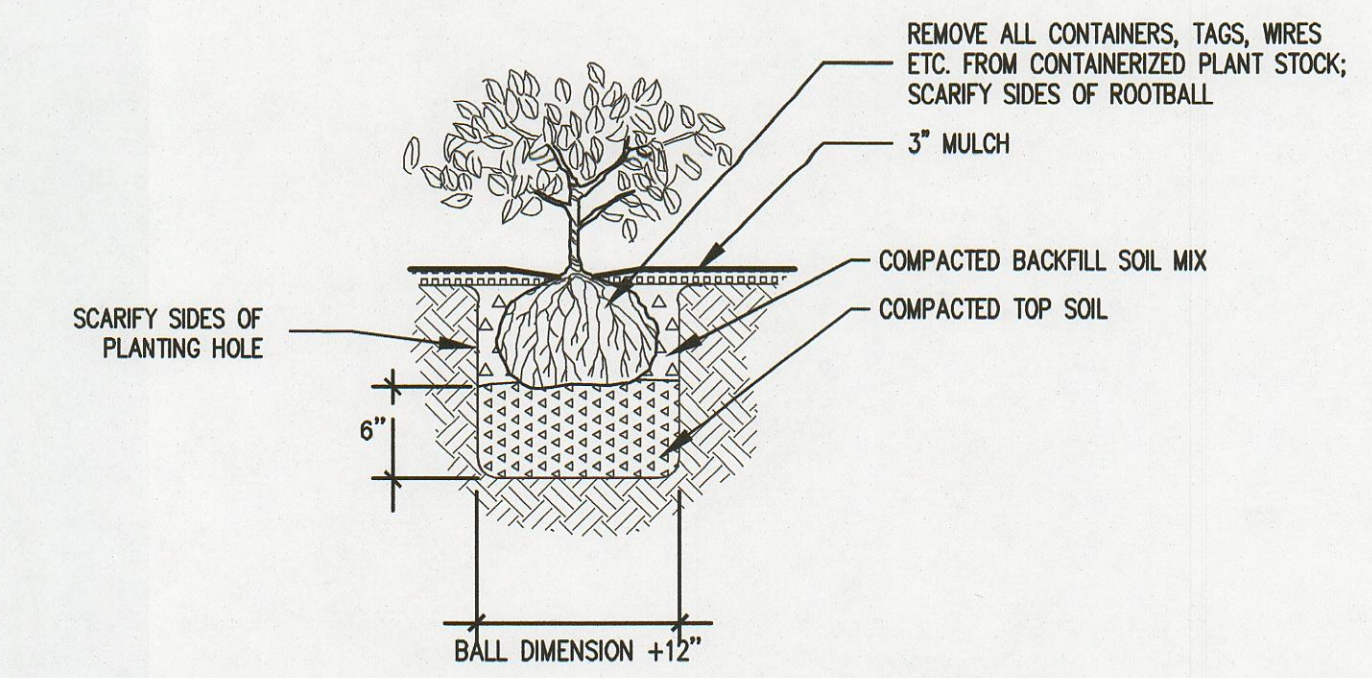

1 TYPICAL SHRUB PLANTING DETAIL

- NTS
- NOTES:
- BACKFILL SOIL MIX SHALL BE 1/3 ORGANIC MATERIALS, 1/3 TOPSOIL, AND 1/3 SANDY LOAM.
 - REMOVE ALL CONTAINERS, METAL, TWINE, TAGS, AND OTHER NON-BIODEGRADABLE MATERIALS PRIOR TO PLANTING.
 - ALL CONTAINERIZED PLANT STOCK SHALL BE VIGOROUS, FREE OF DISEASE AND PESTS, EVENLY FORMED, AND BE FULLY ROOTED IN THE CONTAINER IN WHICH THEY ARE DELIVERED. ALL PLANTS SHALL FOLLOW ANSI Z60.1 STANDARDS FOR NURSERY STOCK FOR CONTAINER SIZE, HEIGHT, ETC.
 - CONTRACTOR SHALL WATER-SETTLE PLANTING HOLES TO REMOVE AIR POCKETS PRIOR TO SPREADING MULCH.
 - CARE SHALL BE TAKEN TO AVOID COVERING ROOT CROWN OR FOLIAGE OF PLANTS WITH BARK MULCH.

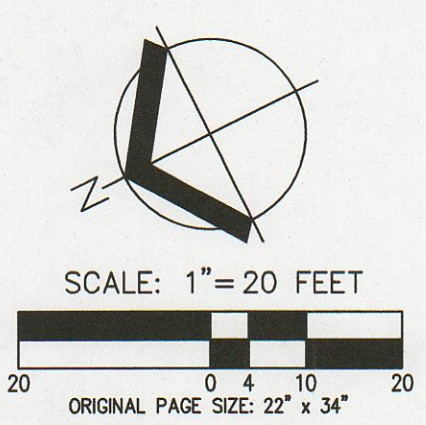

DESIGNED BY:	TEB
DRAWN BY:	TEB
MANAGED BY:	AMC
CHECKED BY:	AMC
DATE:	2/13/2024

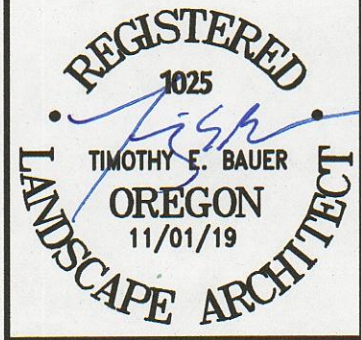

REVISIONS	
JOB NUMBER	9965
SHEET	L101