

CITY OF SHERWOOD

SUNSET PAVEMENT OVERLAY (PINEHURST - RICHEN PARK)

JULY 2020

(BID DOCUMENT VOLUME 2 OF 2 - CONTRACT DRAWINGS)

PROJECT LOCATION:
SW SUNSET BOULEVARD BETWEEN
SW PINEHURST DRIVE AND SW RICHEN PARK TERRACE

DEVELOPER/OWNER:
CITY OF SHERWOOD
22560 SW PINE ST
SHERWOOD, OREGON 97140
CONTACT: CRAIG CHRISTENSEN, P.E.
PH. 503-925-2301
CHRISTENSEN@SHERWOODOREGON.GOV

SHEET INDEX:

1. COVER SHEET
2. GENERAL NOTES
3. SW SUNSET BLVD - PLAN VIEW
4. CITY OF SHERWOOD DETAIL

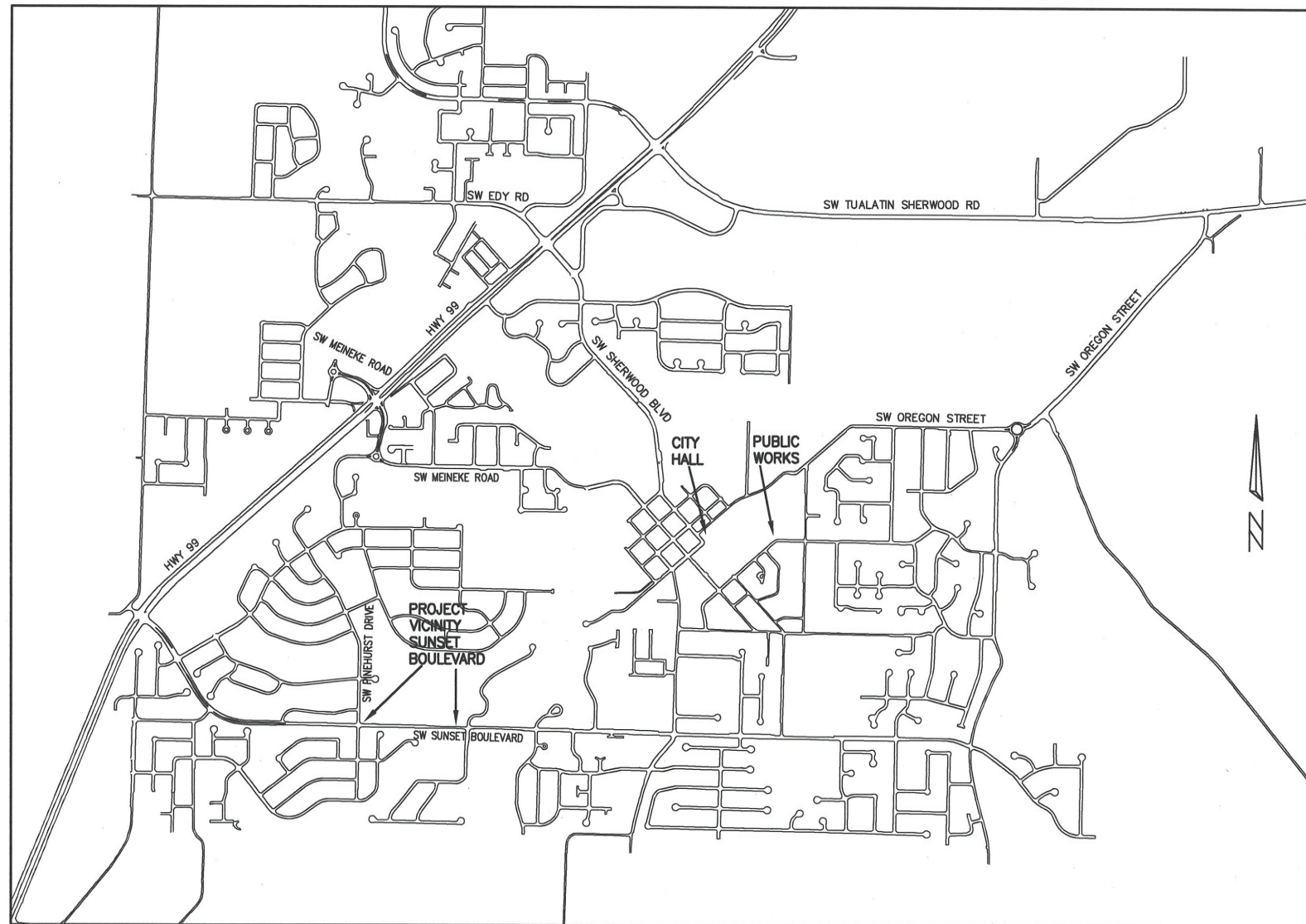

VICINITY MAP
NOT TO SCALE

THIS DESIGN COMPLIES WITH ORS 92.044 (7) IN THAT NO UTILITY INFRASTRUCTURE IS DESIGNED TO BE WITHIN ONE (1) FOOT OF A SURVEY MONUMENT LOCATION SHOWN ON A SUBDIVISION OR PARTITION PLAT. NO DESIGN EXCEPTIONS NOR FINAL FIELD LOCATION CHANGES SHALL BE PERMITTED IF THAT CHANGE WOULD CAUSE ANY UTILITY INFRASTRUCTURE TO BE PLACED WITHIN THE PROHIBITED AREA.

ATTENTION EXCAVATORS: OREGON LAW REQUIRES YOU TO FOLLOW RULES ADOPTED BY THE OREGON UTILITY NOTIFICATION CENTER. THOSE RULES ARE SET FORTH IN OAR 952-011-0010 THROUGH OAR 952-001-0090. YOU MAY OBTAIN COPIES OF THESE RULES FROM THE CENTER BY CALLING (503) 232-1987. IF YOU HAVE ANY QUESTIONS ABOUT THE RULES, YOU MAY CONTACT THE CENTER. YOU MUST NOTIFY THE CENTER AT LEAST 2 BUSINESS DAYS, BEFORE COMMENCING ANY EXCAVATION. CALL (503) 246-6699.

INSPECTOR INFORMATION:

CITY OF SHERWOOD: DAN RAVEN (503) 925-2305
CONTACT INSPECTOR 48 HOURS PRIOR TO CONSTRUCTION.

SURVEY INFORMATION:

HORIZONTAL:
AERIAL TOPOGRAPHIC MAP (2004) AND VISUAL OBSERVATION.
VERTICAL:
AERIAL TOPOGRAPHIC MAP (2004)

COVER SHEET

SUNSET PAVEMENT OVERLAY
(PINEHURST - RICHEN PARK)

LOCATED IN SECTIONS 31D, T2S, R1W, W.M. IN THE
CITY OF SHERWOOD, WASHINGTON COUNTY,
STATE OF OREGON

CITY OF SHERWOOD
ENGINEERING DEPARTMENT
22560 SW PINE STREET
SHERWOOD, OREGON 97140

PHONE: (503) 925-2309
FAX: (503) 625-0629
E-MAIL: engineering@sherwoodoregon.gov

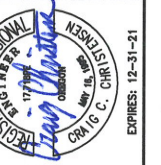

7-2-20

DESIGNED BY:	CCC
DRAWN BY:	CCC
CHECKED BY:	RS
FULL SIZE SCALE:	AS NOTED
DATE:	JULY, 2020
SUNSET_SHEETS.DWG	

NO.	DESCRIPTION

JOB NO.	
SHEET NO.	1
	4

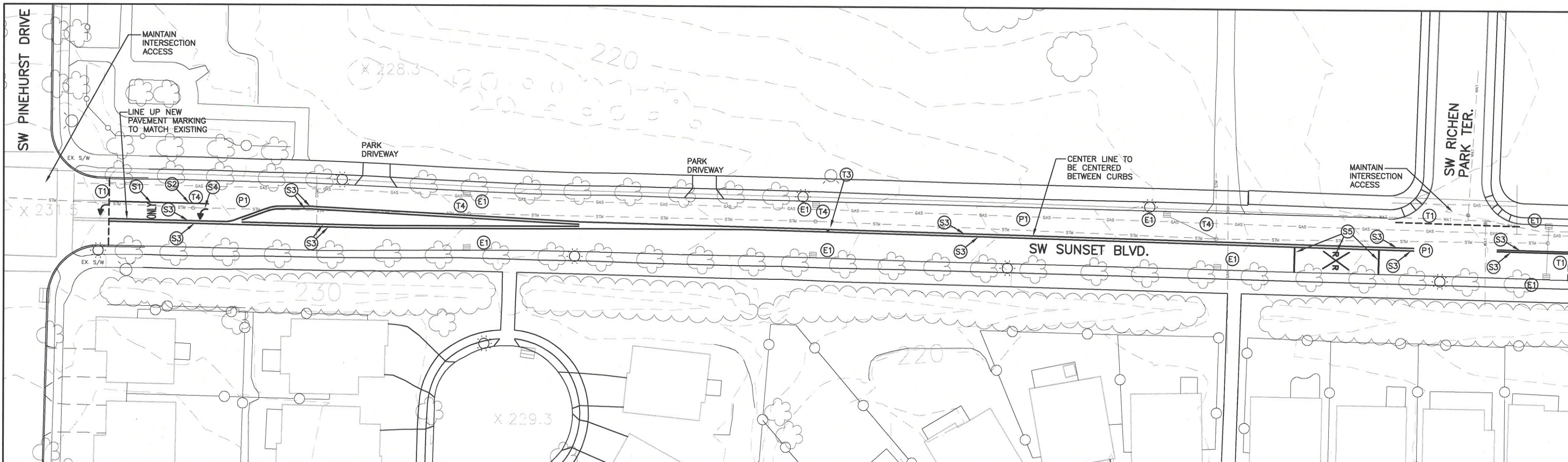

SW SUNSET BOULEVARD
(WEST PLAN VIEW)

SUNSET PAVEMENT OVERLAY
(PINEHURST - RICHEN PARK)

LOCATED IN SECTIONS 31D, T2S, R1W, W.M. IN THE
CITY OF SHERWOOD, WASHINGTON COUNTY,
STATE OF OREGON

STRIPING KEY NOTES

- (S1) INSTALL WHITE THERMOPLASTIC "ONLY"
- (S2) INSTALL WHITE THERMOPLASTIC LINE (8" WIDTH)
- (S3) INSTALL YELLOW THERMOPLASTIC LINE (4" WIDTH)
- (S4) INSTALL WHITE THERMOPLASTIC LEFT TURN ARROW
- (S5) INSTALL WHITE THERMOPLASTIC RAILROAD CROSSING SYMBOL WITH PAVEMENT BARS

STREET KEY NOTES

- (T1) SAWCUT (2" DEPTH) - CONFIRM LOCATION WITH INSPECTOR
- (T2) EXISTING SURVEY MONUMENT TO REMAIN - DO NOT DISTURB - ANY SURVEY MONUMENTS DISTURBED BY THE CONTRACTOR SHALL BE RE-ESTABLISHED AT THE CONTRACTOR'S EXPENSE
- (T3) INSTALL BLUE REFLECTIVE MARKERS ON CENTERLINE AT FIRE HYDRANTS
- (T4) ADJUST EXISTING MANHOLE FRAME TO MATCH NEW ASPHALT SURFACE BY REPLACING CONCRETE GRADE RINGS. NO CAST IRON RISER RINGS ALLOWED.

PAVING KEY NOTES

- (P1) AREA OF 2" ASPHALT GRIND WITH VARYING DEPTH OVERLAY (2" AT GUTTER, 3" AT CROWN)

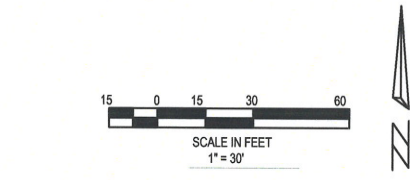

EROSION CONTROL KEY NOTES

- (E1) INSTALL SILT SACK IN CATCH BASIN AND BIOBAGS IN FRONT OF CURB OPENING.

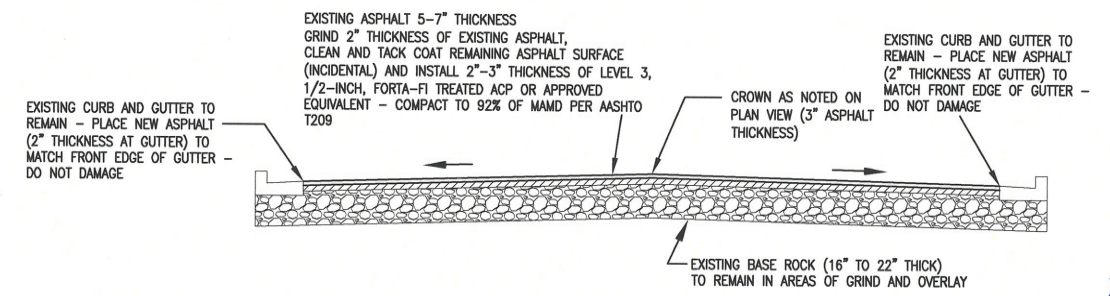

TYPICAL GRIND AND INLAY STREET SECTION
NOT TO SCALE

NOTE: ASPHALT TO BE 3" AT CROWN OF STREET TO INCREASE CROSS SLOPE

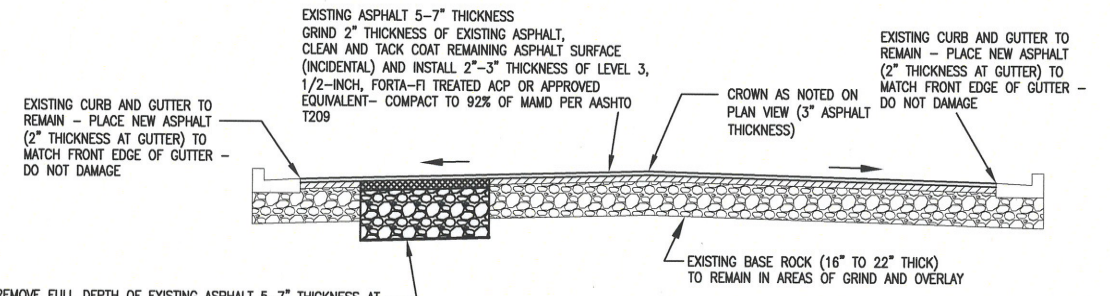

TYPICAL STREET RECONSTRUCTION SECTION
NOT TO SCALE

NOTE: CONTACT INSPECTOR AFTER ASPHALT GRINDING TO DETERMINE IF THERE ARE AREAS THAT NEED FULL DEPTH RECONSTRUCTION.

CITY OF SHERWOOD
ENGINEERING DEPARTMENT
22560 SW PINE STREET
SHERWOOD, OREGON 97140

PHONE: (503) 925-2309
FAX: (503) 925-0629
E-MAIL: engineering@sherwoodoregon.gov

7-21-20

REGISTERED PROFESSIONAL ENGINEER
No. 17796
C. C. CHIRIE
EXPIRES: 12-31-21

DESIGNED BY:	CCC
DRAWN BY:	CCC
CHECKED BY:	RS
FULL SIZE SCALE:	1"=30'
DATE:	JULY, 2020
SUNSET_SHEETS.DWG	

JOB NO.	
SHEET NO.	3
OF	4

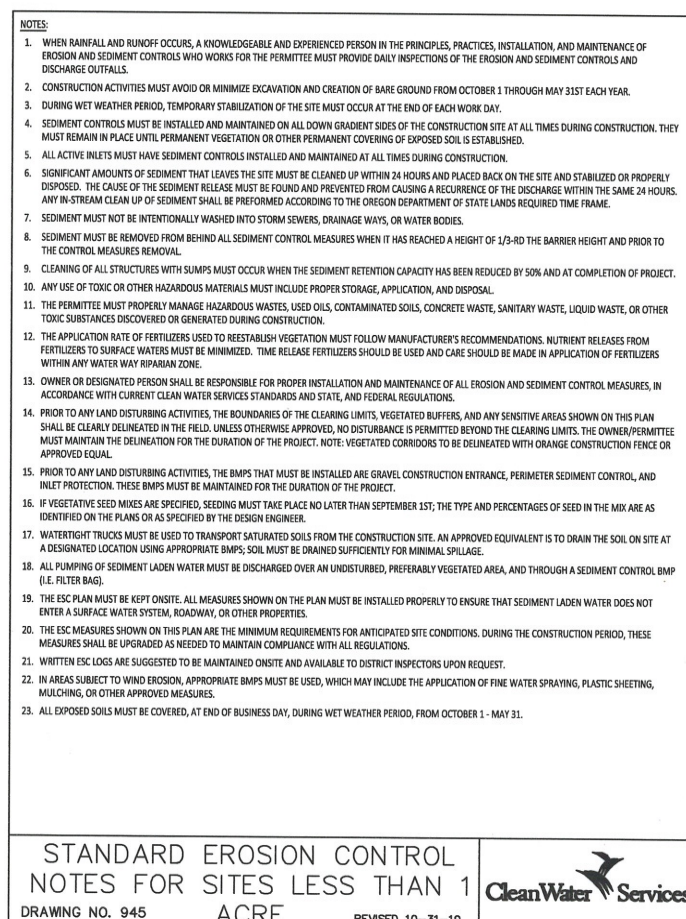
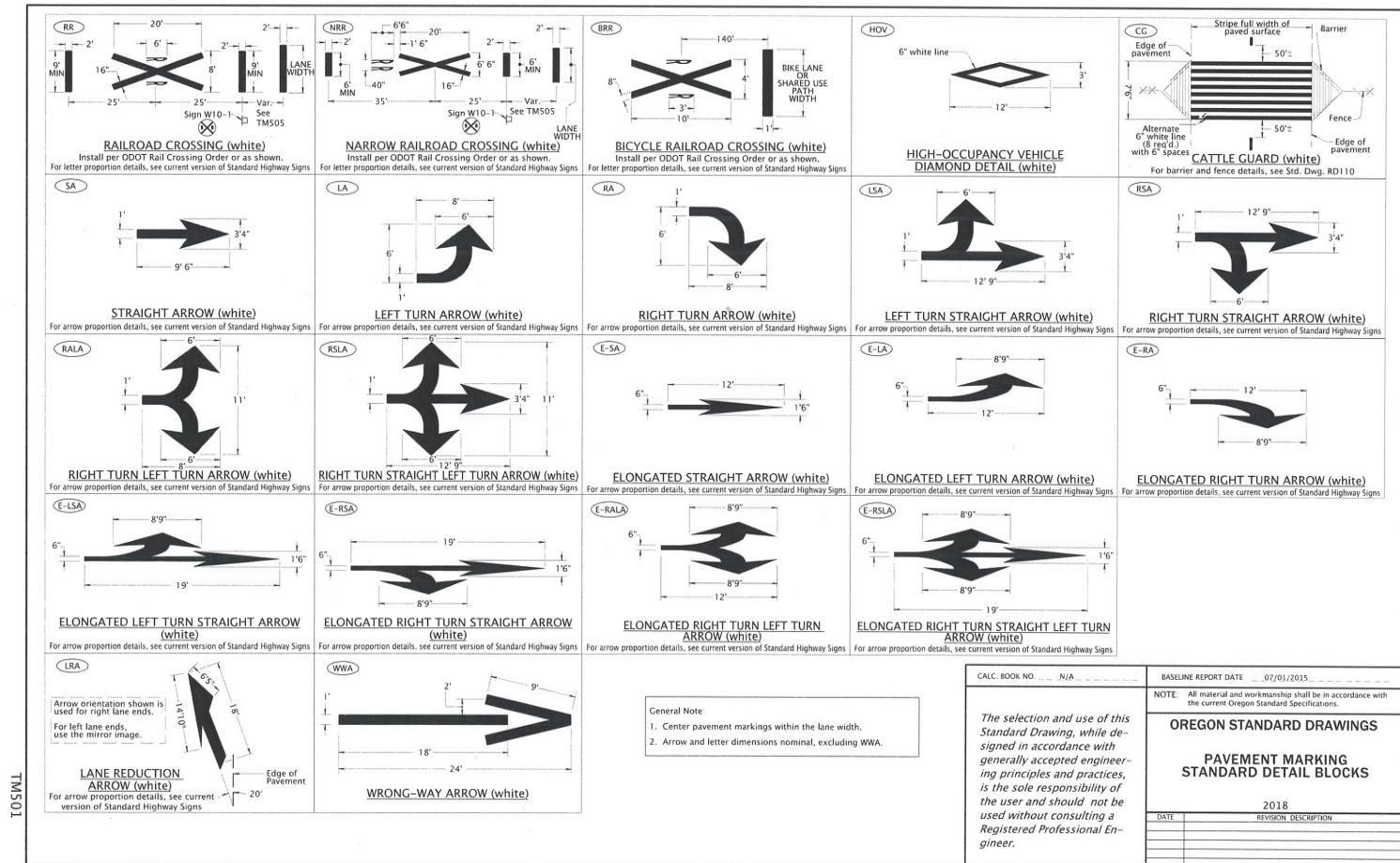
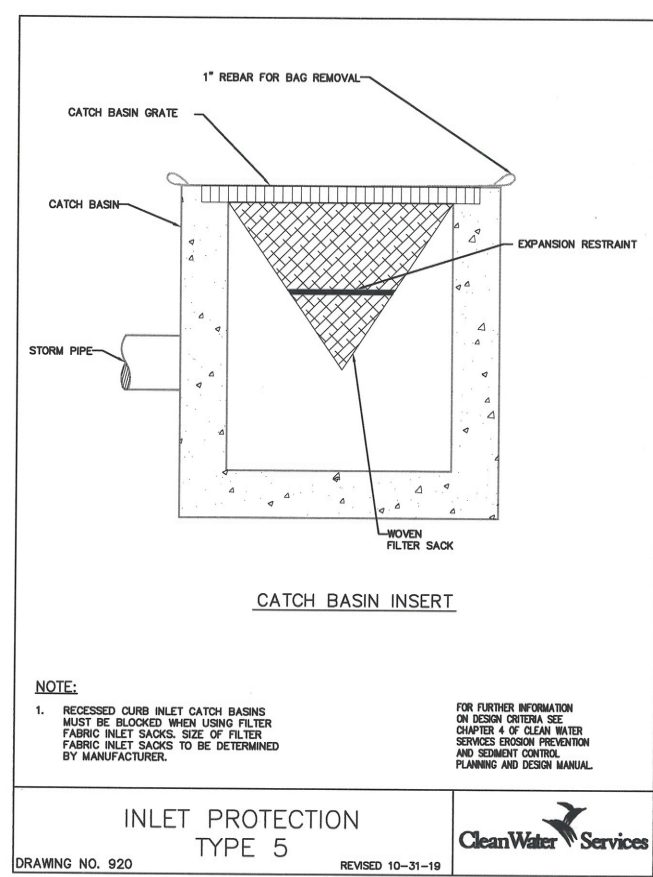
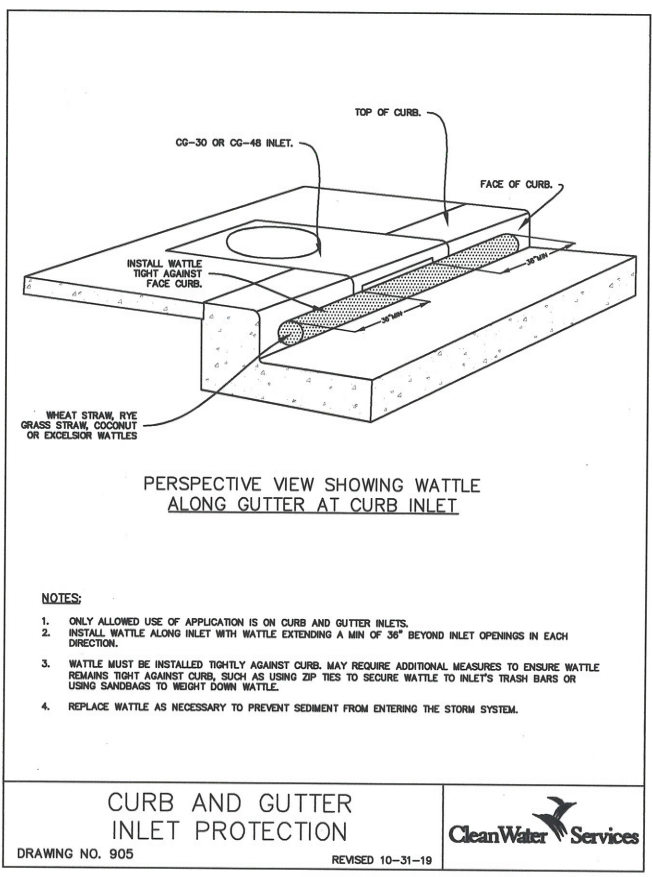
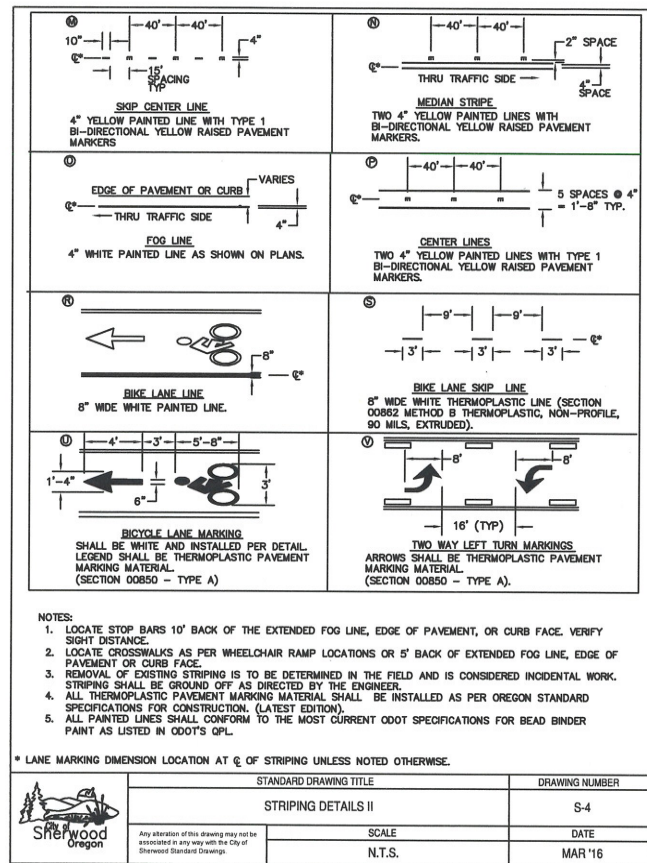
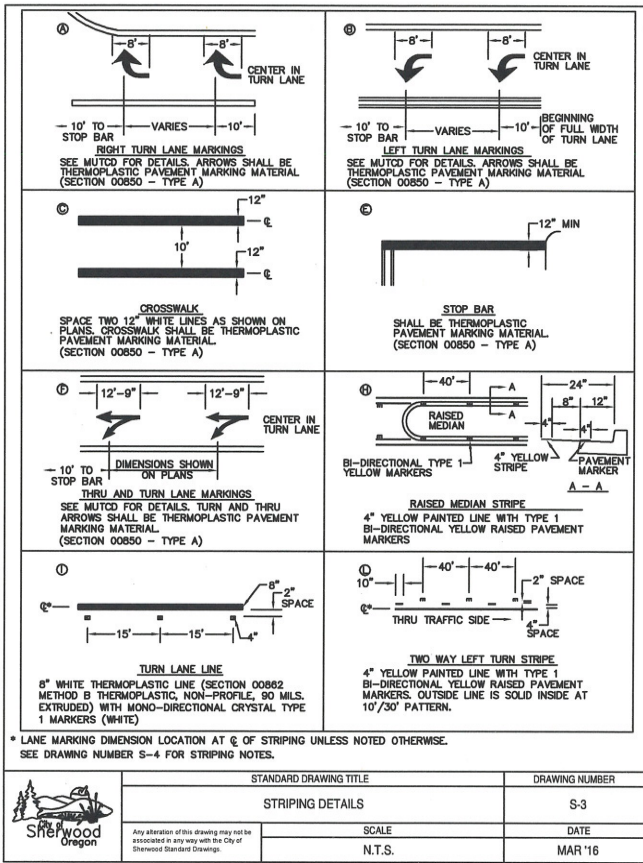

CITY OF SHERWOOD DETAILS

SUNSET PAVEMENT OVERLAY (PINEHURST - RICHEN PARK)

LOCATED IN SECTIONS 31D, T2S, R1W, W.M. IN THE CITY OF SHERWOOD, WASHINGTON COUNTY, STATE OF OREGON

CITY OF SHERWOOD ENGINEERING DEPARTMENT
22560 SW PINE STREET
SHERWOOD, OREGON 97140
PHONE: (503) 925-2309
FAX: (503) 925-0629
E-MAIL: engineering@sherwoodoregon.gov

EXPIRES: 12-31-21

DESIGNED BY: CCC
DRAWN BY: CCC
CHECKED BY: RS
FULL SIZE SCALE: AS NOTED
DATE: JULY, 2020
SUNSET SHEETS

REVISIONS

JOB NO.

SHEET NO. 4

4